

TERMINATIONS SMA

UP TO **26.5 GHz**
1 WATT



MODELS: TSXXXM, TSXXXMC, TSXXXF, TSXXXFC

SPECIFICATIONS:

Electrical:

Frequency Range _____ DC – 26.5 GHz
 Standard Freq. Values ____ 6, 12.4, 18 & 26.5 GHz
 VSWR
 DC – 4 GHz _____ 1.05:1 Max.
 4 – 8 GHz _____ 1.10:1 Max.
 8 – 12.4 GHz _____ 1.15:1 Max.
 12.4 – 18 GHz _____ 1.20:1 Max.
 18 – 26.5 GHz _____ 1.35:1 Max.
 Impedance _____ 50 Ohms
 Input Power _____ 1 Watt Avg. @ +25°C
 Derated Linearly to 0 Watts @ +125°C
 Peak Power _____ 1kW Max.
 (5uSec Pulse, .05% Duty Cycle)
 Temperature Coefficient _____ ±250 ppm/°C
 Operating Temp Range _____ -65°C to +125°C

Mechanical:

SMA Connectors _____ Passivated Stainless Steel**
 Mates with MIL-STD-348
 Conductors _____ Gold Plated Beryllium Copper
 Bead Chain _____ Passivated Stainless Steel

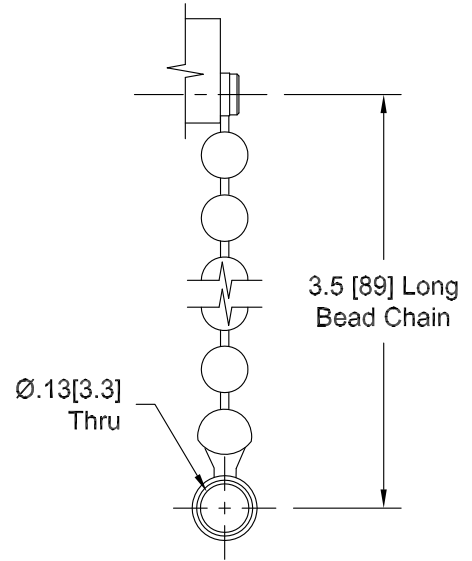

CHAIN DETAIL

** For Gold Plated Connectors add /AU to the Model Number

Model Number: **TSXXXM**
SMA Male Connector

Model Number: **TSXXXF**
SMA Female Connector

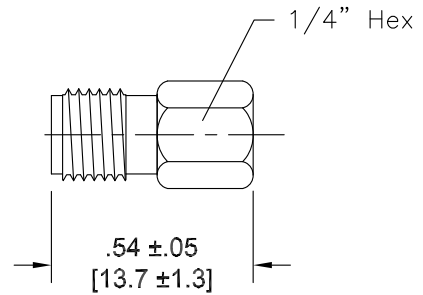
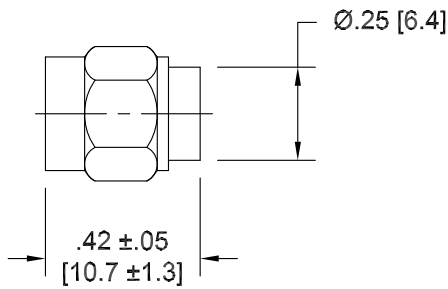

HOW TO ORDER:

Model Number: **TSXXXYZ/FF**

Frequency Range

060 = DC – 6 GHz
 120 = DC – 12.4 GHz
 180 = DC – 18 GHz
 260 = DC – 26.5 GHz

Finish

= Passivated Conn.
 /AU = Gold Plated Conn.

Style

= No Chain
 C = Chain Included

Connector Config.

M = Male
 F = Female

Ordering Examples:

Model Number: **TS180MC**
DC – 18 GHz; SMA Male; Chain Included

Model Number: **TS060F/AU**
DC – 6 GHz; SMA Female; No Chain; Gold Plate

Model Number: **TS260M**
DC – 26.5 GHz; SMA Male; No Chain

Note: Dimensions in Brackets are Expressed in Millimeters and are for Reference Only.
 Design specifications are subject to change without notice.
 Contact factory for technical specifications before purchasing or use.

X-ON Electronics

Largest Supplier of Electrical and Electronic Components

Click to view similar products for [RF Connectors / Coaxial Connectors](#) category:

Click to view products by [Api Technologies](#) manufacturer:

Other Similar products are found below :

[8915-1511-000](#) [89674-0827](#) [6001-7071-019](#) [6002-7051-003](#) [6002-7551-202](#) [6059674-1](#) [619550-1](#) [630059-000](#) [M39030/3-01N](#) [6500-7071-046](#) [6769](#) [CX050L2AQ](#) [7002-1541-010](#) [7002-1542-011](#) [7004-1512-000](#) [7009-1511-004](#) [7010-1511-000](#) [7029-1511-060](#) [7101-1541-010](#) [7101-1571-002](#) [7145-1521-002](#) [7203-1571-003](#) [7209-1511-011](#) [7210-1511-015](#) [7210-1511-019](#) [73137-5015](#) [73216-2241](#) [73404-2300](#) [7405-1521-005](#) [7405-1521-802](#) [8527](#) [8547](#) [FS11V](#) [877931](#) [8808-1511-001](#) [9049-9513-000](#) [9074-9513-000](#) [9101-9573-002](#) [910A205F](#) [9130-9573-002](#) [PL11SC-026](#) [PL375-33](#) [PL40-5](#) [PL74C-221](#) [PL75MC-217](#) [PL803-7](#) [1200690078](#) [1-201144-1](#) [R107003010W](#) [R110A172100](#)