

3

CABLE LENGTH TABLE
FINISHED LENGTH ± 2% TOTAL

MARK	PART NO	REV	'L'
	3004-304-1M	B	1M (3.3 FT)
	3004-304-3M	B	3M (9.84 FT)
	3004-304-5M	B	5M (16.4 FT)
	3004-304-10M	B	10M (32.8 FT)

APPLIED MOTION PRODUCTS
3004-304-3M B

LABEL DETAIL B

REVISIONS

REV	DESCRIPTION	DATE	APPROVED
A	INITIAL RELEASE ECO 7263	8/24/15	J KORDIK
B	REVISE RoHS NOTE - ECO 7451	6/13/16	J KORDIK

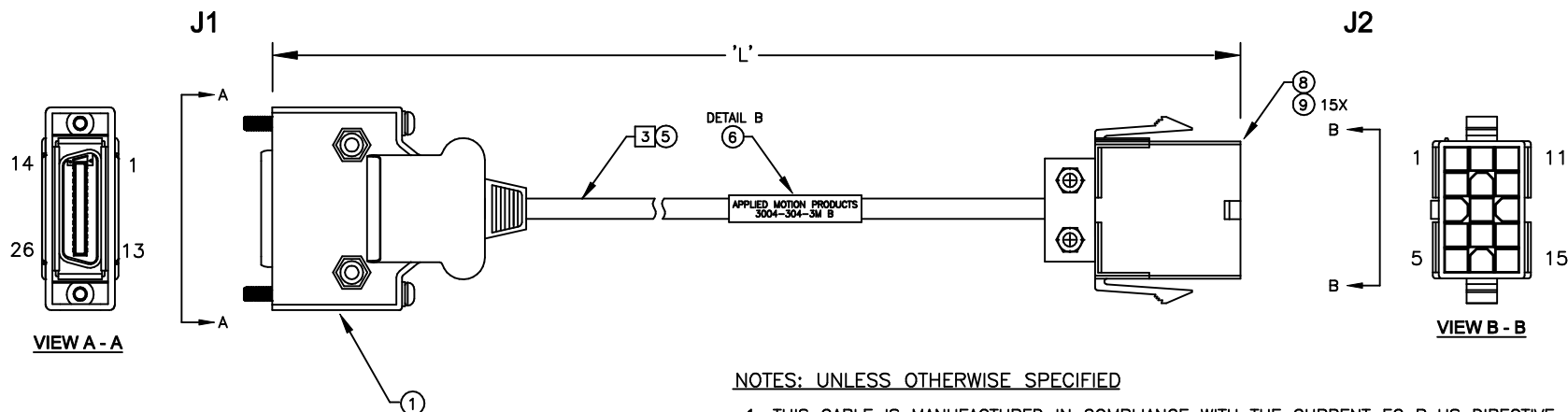

NOTES: UNLESS OTHERWISE SPECIFIED

1. THIS CABLE IS MANUFACTURED IN COMPLIANCE WITH THE CURRENT EC RoHS DIRECTIVE.
2. THIS CABLE INTENDED FOR USE WITH J-SERIES SERVO MOTORS AND SV200 SERIES SERVO DRIVES.
- 3 FOR CABLES LONGER THAN THESE, USE RAW CABLE 666-2121.
4. STRAIN RELIEF AT CONNECTORS WILL VARY.

CABLE CONNECTIONS

J1	J2	SIGNAL	WIRE COLOR
11	1	+5V	RED
24	2	GND	BLK
4	3	U+	BRN
6	4	U-	BRN/BLK
17	5	V+	GRY
19	6	V-	GRY/BLK
5	7	W+	WHT
7	8	W-	WHT/BLK
1	9	A+	BLU/BLK
14	10	A-	BLU
2	11	B+	GRN
15	12	B-	GRN/BLK
3	13	Z+	YEL
16	14	Z-	YEL/BLK
-	15	DRAIN	SHIELD

BILL OF MATERIALS

ITEM	PART NUMBER	DESCRIPTION	QTY	UOM	MFR
1	3-2232346-1	CONNECTOR, SCSi 26 POSITION	1	EA	TYCO OR EQUIV.
2					
3					
4					
3	5	666-2121 OR EQUIV. CABLE, 7 PAIRS 28 AWG, SHIELDED, PVC JACKET	A/R		UL 2574 OR EQUIV.
6	DAT-35-292-1	LABEL, 1.875" X 3.167"	1	EA	BRADY OR EQUIV.
7					
8	172163-1	HOUSING, CONNECTOR	1	EA	AMP
9	770834-1	TERMINALS, CRIMP	15	EA	AMP

TOLERANCES

DECIMALS: MM (INCH)
 X.XXX = ±0.013 (.005)
 X.XX = ±0.25 (.01)
 X.X = ±2.5 (0.1)
 ANGLES:
 MACH. = ±.5°
 CHAM. = ±5°

THIRD ANGLE PROJECTION

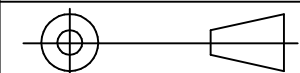

APPROVALS	DATE
DRAWN <i>R.JONEZ</i>	8/3/15
CHECKED	
APPROVED	



ENCODER CABLE,
J-SERIES SERVO MOTORS

B DWG NO. 3004-304-XXX REV B

X-ON Electronics

Largest Supplier of Electrical and Electronic Components

Click to view similar products for [Specialised Cables category](#):

Click to view products by [Applied Motion manufacturer](#):

Other Similar products are found below :

[603PT6](#) [603SS6L](#) [604PT6](#) [604SS6](#) [706000D02F200](#) [910640](#) [1200740077](#) [1200740114](#) [AC172](#) [ACL-SSI-4](#) [R88ACAKA0015SRE](#)
[R88ACAWL005SDE](#) [R88ACRGD0R3C](#) [1300150047](#) [1300660036](#) [1302262116](#) [1300150149](#) [1300220020](#) [1300220104](#) [1300220119](#)
[1301240492](#) [1301810221](#) [1365323-1](#) [1613055](#) [176P12](#) [1971465-2](#) [20240400003](#) [20240400013](#) [2085828-1](#) [20886510030](#) [2-22733-8](#) [22733-](#)
[8](#) [CB-5PSBC-RS](#) [CB-704EC-RS](#) [CB-BATACC-RS](#) [CB-JST3PSW-RS](#) [CB-M12COM-R10](#) [25AC84](#) [25AK84X](#) [25AU25](#) [25FN82](#) [3011-03](#)
[AC118](#) [ACL-HHS-1M\(CAT5E\)](#) [SSL009PC2DC012N](#) [FC2A-KC6C](#) [2085828-2](#) [20886510150](#) [CCS-FCB-5](#) [CCSFCBF2](#)