

DELPHI PACKARD ELECTRIC SYSTEMS  
WARREN, OHIO 44486

DWG STATUS				REVISION HISTORY				AUTH		
DATE	STG	REV	CHG	N/P	ZONE	DATE	BY	CHK	APVD	LEG
17JAO2	R	003	-	-						
MATERIAL SPEC WAS PAGES						217Z51				

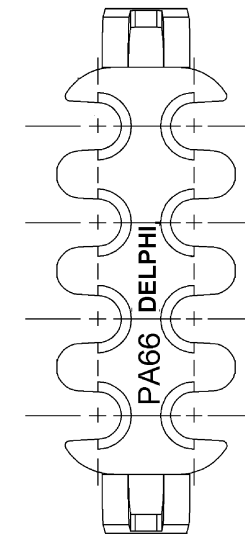
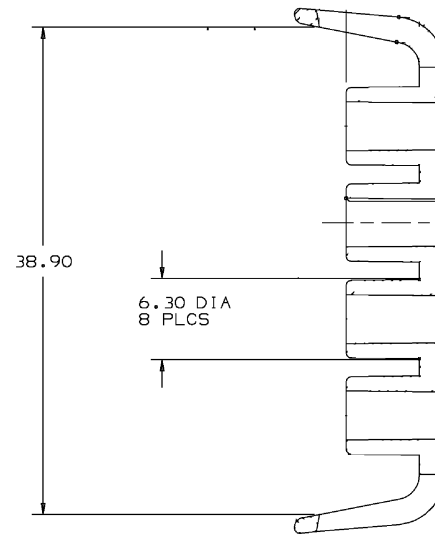
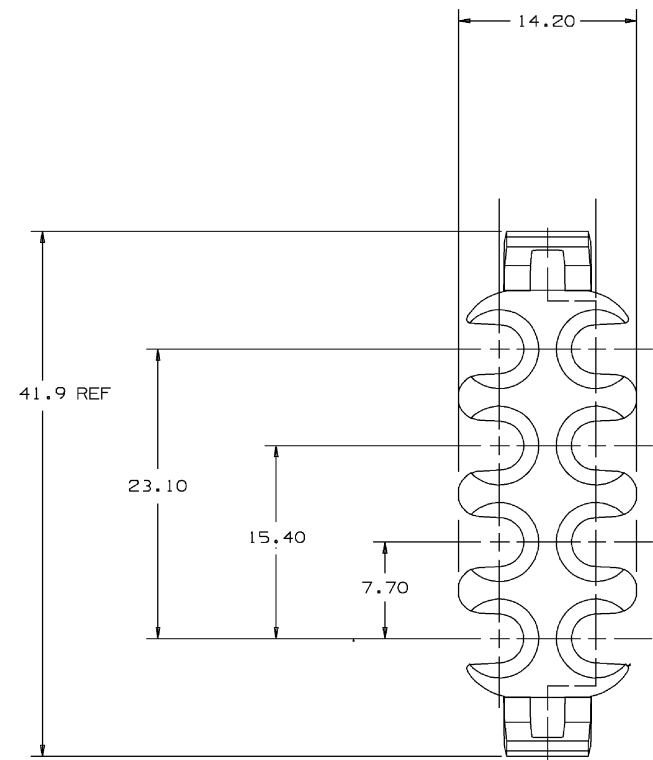
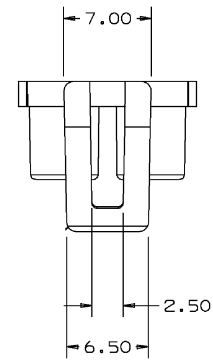

- NOTES**
- ALL RADII 0.40, UNLESS OTHERWISE INDICATED.
  - DIMENSIONS ARE TO FACE OF VIEW SHOWN, UNLESS OTHERWISE INDICATED.
  - 1\* DRAFT ON ALL INSIDE AND OUTSIDE SURFACES, UNLESS OTHERWISE INDICATED.
  - THIS PART IS TO MATE WITH CONNECTOR 12146509.
  - THIS PART IS NOT CONTROLLED FOR AUTOMATIC FEEDING.
  - MATERIAL RECYCLING CODE >PA66< PER SAE J1344. (2.3)X(0.1) RAISED CHARACTERS AS SHOWN TO BE LOCATED ON ANY EXTERIOR SURFACE. OPTIONAL CONSTRUCTION TO BE NO MATERIAL RECYCLING CODE.
  - (2.3)X(0.1) RAISED DELPHI CORPORATE BRAND TO BE LOCATED ON ANY EXTERIOR SURFACE, PREFERABLY VISIBLE AT FINAL ASSEMBLY. OPTIONAL CONSTRUCTION TO BE "PED" OR NO LOGO.

<b>DELPHI</b> Automotive Systems		TOLERANCES UNLESS OTHERWISE SPECIFIED: DIMENSIONS: ONE PLACE 1.0% ANGLES: 0.2°	
MATERIAL SPEC M3592008-PA66 HS IM BLU		SUBSTANCES OF CONCERN AND RECYCLED CONTENT PER DELPHI - A 10949001	
CODE NUMBER 6900		DWG DATE 03AP92	SCALE 4:1
DC SPEC		STYLE	
PART GEOMETRY 2D PLANAR		UNLESS OTHERWISE SPECIFIED: THIS DOCUMENT IS IN ACCORDANCE WITH ASME Y14.5M - 1994 AS AMENDED BY THE 0M GLOBAL DIMENSIONING AND TOLERANCING HANDBOOK - 1997. ALL GEOMETRIC TOLERANCES AND RELATED DATUMS APPLY. RULE #1 (PERFECT FORM AT MMC) DOES NOT APPLY WHEN RELATIONSHIP BETWEEN FEATURES IS ESTABLISHED BY ORIENTATION OR LOCATION TOLERANCES. SEPARATE POSITION CALLOUTS MAY BE GAGED SEPARATELY REGARDLESS OF DATUM REFERENCES.	
DO NOT SCALE		REFERENCE	
METRIC UNLESS OTHERWISE SPECIFIED ALL DIMENSIONS ARE IN MILLIMETERS		DR T DIETERLE	DATE
CHANGE RESTRICTED NO MANUAL CHANGES		APV01 T STEELE	18AP93
		APV02 T STEELE	18AP93
		APV03 G PENNYWELL	05MY93
		APV04	
		APV05	
DRAWING NAME TPA M/P 280			
SHEET NUMBER 1 OF 1	DRAWING NUMBER 12146443	DWG STATUS R 003	SIZE A0

## X-ON Electronics

Largest Supplier of Electrical and Electronic Components

*Click to view similar products for [Automotive Connectors](#) category:*

*Click to view products by [APTIV](#) manufacturer:*

Other Similar products are found below :

[003-018-000](#) [60403001](#) [60993906-B](#) [629515004020001](#) [M902-2131](#) [M902-2161](#) [72.330.1035.1](#) [73.353.4028.0](#) [F119300-B](#) [F166900](#)  
[F258300-B](#) [F358300-B](#) [F407400](#) [F444110](#) [F487000](#) [F509500B-B](#) [827153-1](#) [8N1515-32-24P](#) [9-1326729-8](#) [925474-1](#) [928905-1](#) [964562-4](#)  
[968782-1](#) [GT17SA-8DS-HU](#) [98891-1012](#) [98947-1016](#) [12004475-L](#) [12010290](#) [12010309-B](#) [12015454](#) [12020219-B](#) [12020308](#) [12041318-B](#)  
[12052225-L](#) [12052466](#) [12059125](#) [12064869](#) [12004327-B](#) [12010503-B](#) [12015308](#) [12015384](#) [12015909](#) [1-21030-1](#) [12041254](#) [12041318](#)  
[12047946-B](#) [12047957](#) [12047957-L](#) [12059473](#) [12066261](#)