

SYMBOL DEFINITION		MISSING SYMBOLS	
A DIMENSION WITHOUT AN INSPECTION REPORT SYMBOL DOES NOT REQUIRE INSPECTION. IT MAY BE CONTROLLED ON THE INDIVIDUAL COMPONENT DRAWING.	TOTAL NO OF INSPECTIONS REQUIRED	NO MISSING SYMBOL NUMBER	
	10		
	LAST NO. USED		
	10		

DWS STATUS					REVISION HISTORY			AUTH		DR		APVD	
DATE	STG	REV	N/P	CHG	ZONE								
23JL99	R	01	-	-		ALL PARTS - REDRAWN TO PD			193526	DAA	OMC	06	
10DE08	R	02	-	-		12160637, 12160638, 12160639, 12160640 & 12160642 - ADDED TYPE 102 VIEW			407016	RHO	HAD	RHO	M
09AU12	R	03	-	-		ALL PARTS - UPDATED MAT'L CALLOUT			419194	KYT	JVM	MAA	

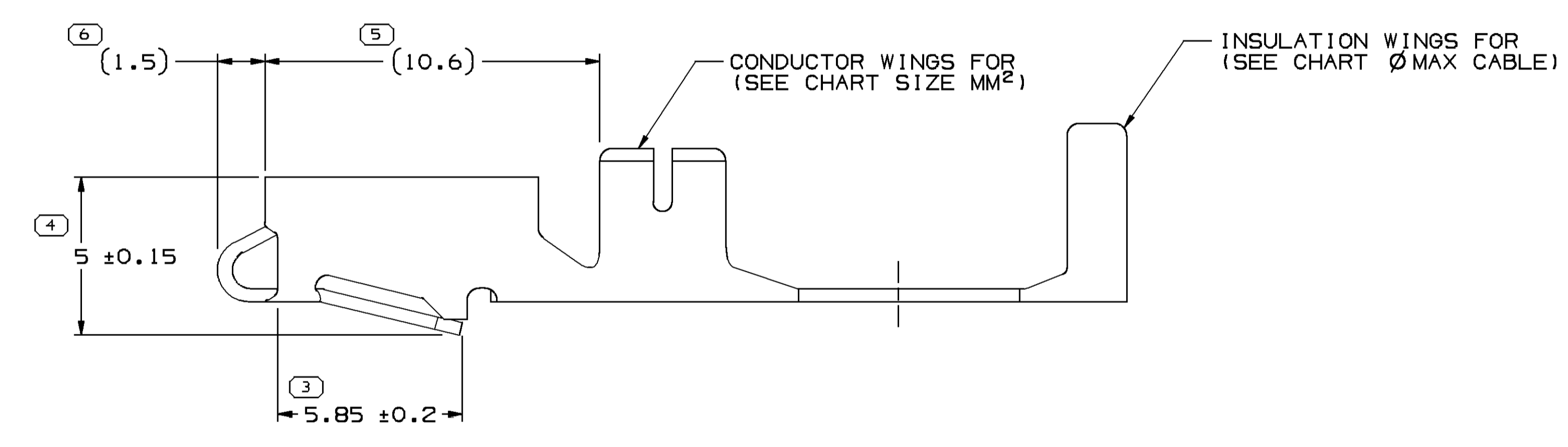

TYPE 101

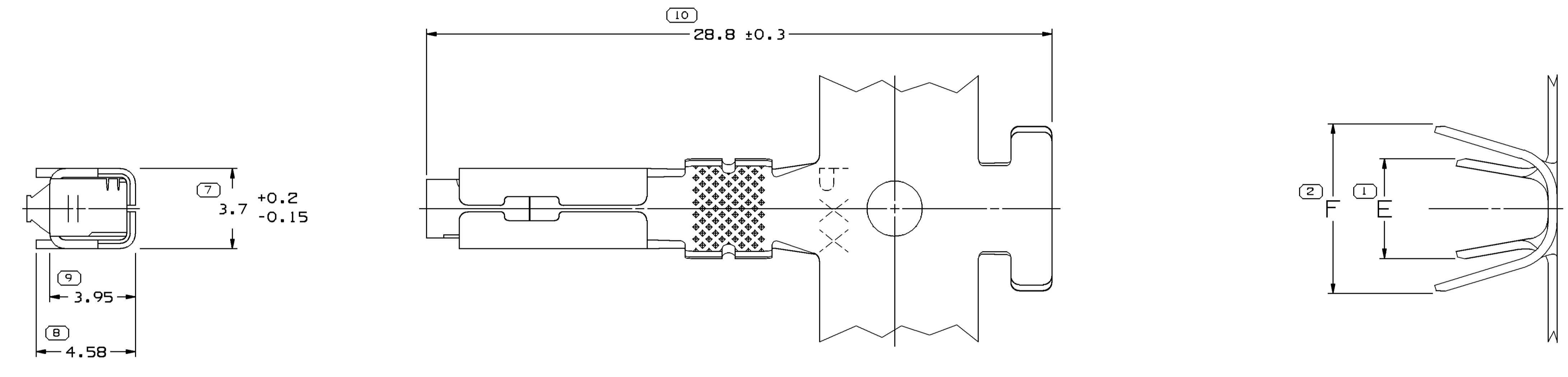
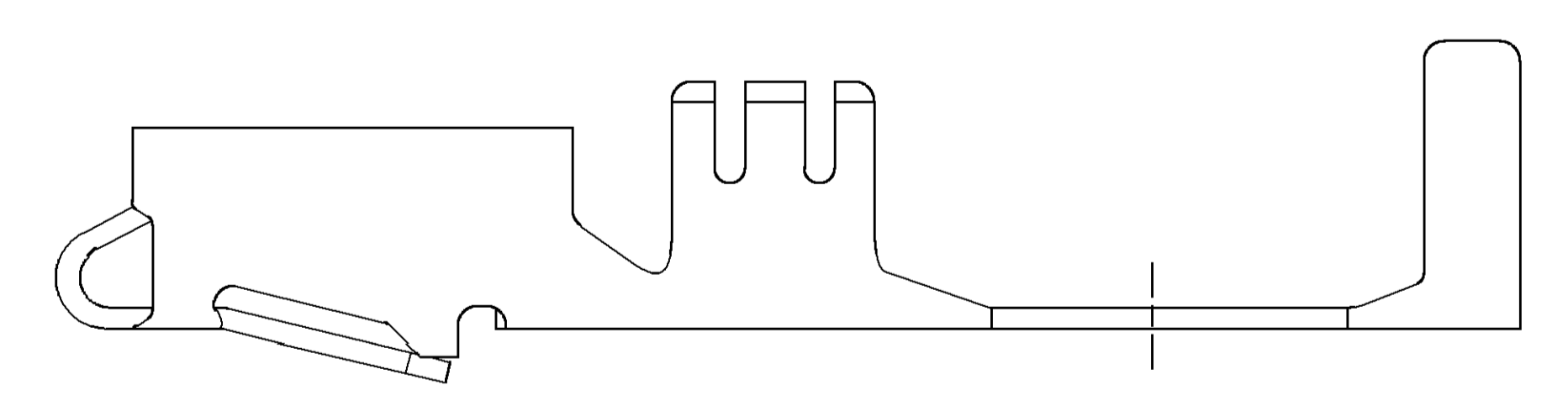

TYPE 102
SAME AS TYPE 101
EXCEPT AS SHOWN

- NOTES
- UNLESS OTHERWISE SPECIFIED AND/OR INDICATED: DIMENSIONS ARE TO FACE OF VIEW SHOWN AND AUTOMATICALLY ROUNDED BY COMPUTER FOR INSPECTION. (SEE MATH MODEL FOR PRECISE DIMENSIONS.) FOR ALL OTHER DIMENSIONS NOT SHOWN BUT REQUIRED FOR TOOL BUILD, SEE MATH MODEL FOR PRECISE TOOL PATH DATA.
 - REFERENCE MATING COMPONENTS OR EQUIVALENT: TERMINAL MINI FUSE 12092075.
 - RECOMMENDED MATING BLADE - 0.835 ± 0.035 THICKNESS 2.8 ± 0.1 WIDTH, 7 LENGTH.
 - MAXIMUM CURRENT CAPACITY IS 25 AMPS.
 - MAXIMUM MINI FUSE TO BE USED IS 20 AMPS FUSE.
 - DO NOT PROBE, TEST OR OTHERWISE CONTACT THE INTERIOR REGION (THE SPRING OR ANY MOVING PART) OF THIS TERMINAL. SEVERE DAMAGE CAN OCCUR, COMPROMISING THE PERFORMANCE OF THE ELECTRICAL INTERFACE.

PART NO	REV N/P	MAT'L SIZE	MAT'L SPEC	PART NO	REV N/P	MAT'L SPEC	SIZE (MM²)	ID	CABLE	DIA	TYPE	E ± 0.4	F ± 0.4
12160642	A3		TIN PLATED COPPER ALLOY	12160641	A2		TWO 0.35	222	TWO 2.1 MAX	102	27 ± 0.2	5.3	
12160640	A3		TIN PLATED COPPER ALLOY	12160639	A3		TWO 0.5	220	2.2 - 1.7	102	3.5	5.8	
12160637	A3		TIN PLATED COPPER ALLOY	12160636	A2		0.5 - 0.35	21	2.19 - 1.47	102	2.4 ± 0.2	3.8 ± 0.2	
12160635	A2		TIN PLATED COPPER ALLOY	12160634	A2		1 - 0.8	17	2.64 - 1.96	102	2.9 ± 0.2	4.6	
			UNPLATED				3 - 2	13	3.65 - 2.5	101	4	5.6	
			PLATED				5	10	4.48 - 3.72	101	4.6	7.6	

LINE DRAWN THROUGH PART NUMBER INDICATES THAT PHYSICAL PARTS ARE NOT AVAILABLE FOR ORDERING.

PART NUMBERS THAT DO NOT HAVE A LINE PRESENT INDICATE THAT PHYSICAL PARTS ARE AVAILABLE FOR ORDERING.

CONTACT DELPHI SALES TO ASSURE AVAILABILITY OF PARTS.

DWG TYPE: PART DRAWING

STYLE: ID

UNLESS OTHERWISE SPECIFIED THIS DOCUMENT IS IN ACCORDANCE WITH ASME Y14.5M-1994 AS MODIFIED BY THE 3D DIMENSIONING AND TOLERANCING ADDENDUM-2001. SEPARATE PATTERNS OF FEATURES MAY BE SHOWN SEPARATELY, REGARDLESS OF DIMENSIONAL REFERENCES.

ALL DIMENSIONS ARE IN MILLIMETERS

REFERENCE:

THIRD ANGLE PROJECTION

DO NOT SCALE

USE MATH DATA

ANGULAR TOLERANCE ± 0.2°

DELPHI
DELPHI PACKARD ELECTRICAL/ELECTRONIC ARCHITECTURE
WARREN, OH
COPYRIGHT 1994 DELPHI CORPORATION AND/OR ITS AFFILIATES. ALL RIGHTS RESERVED.
THIS DRAWING IS THE PROPERTY OF DELPHI CORPORATION. THE REPRODUCTION, DISTRIBUTION AND UTILIZATION OF THIS DOCUMENT OR ITS RELATED CAD DATA, AS WELL AS COMMUNICATION OF ANY CONTENT TO OTHERS, WITHOUT EXPRESS AUTHORIZATION IS PROHIBITED.

DATE: 12AP94

OR: DEN ELLWOOD

APV01 DEN ELLWOOD 12AP94

APV02 DEN ELLWOOD 12AP94

APV03 DEN ELLWOOD 12AP94

APV04

SUBSTANCES OF CONCERN AND RECYCLED CONTENT PER DELPHI (044900)

MATERIAL SEE CHART

DRAWING NAME: TAXI TERM F/W/P 280 TANG

DRAWING NUMBER: 12160668

SIZE: A0

SCALE: 8:1

FRAME NO: 1 OF 1

SHEET NO: 1 OF 3

STG: R

REV: 03

X-ON Electronics

Largest Supplier of Electrical and Electronic Components

Click to view similar products for [Automotive Connectors](#) category:

Click to view products by [APTIV](#) manufacturer:

Other Similar products are found below :

[003-018-000](#) [60403001](#) [60993906-B](#) [629515004020001](#) [M902-2131](#) [M902-2161](#) [72.330.1035.1](#) [73.353.4028.0](#) [F119300-B](#) [F166900](#)
[F258300-B](#) [F358300-B](#) [F407400](#) [F444110](#) [F487000](#) [F509500B-B](#) [827153-1](#) [8N1515-32-24P](#) [9-1326729-8](#) [925474-1](#) [928905-1](#) [964562-4](#)
[968782-1](#) [GT17SA-8DS-HU](#) [98891-1012](#) [98947-1016](#) [12004475-L](#) [12010290](#) [12010309-B](#) [12015454](#) [12020219-B](#) [12020308](#) [12041318-B](#)
[12052225-L](#) [12052466](#) [12059125](#) [12064869](#) [12004327-B](#) [12010503-B](#) [12015308](#) [12015384](#) [12015909](#) [1-21030-1](#) [12041254](#) [12041318](#)
[12047946-B](#) [12047957](#) [12047957-L](#) [12059473](#) [12066261](#)