

SECTION A-A

SECTION B-B

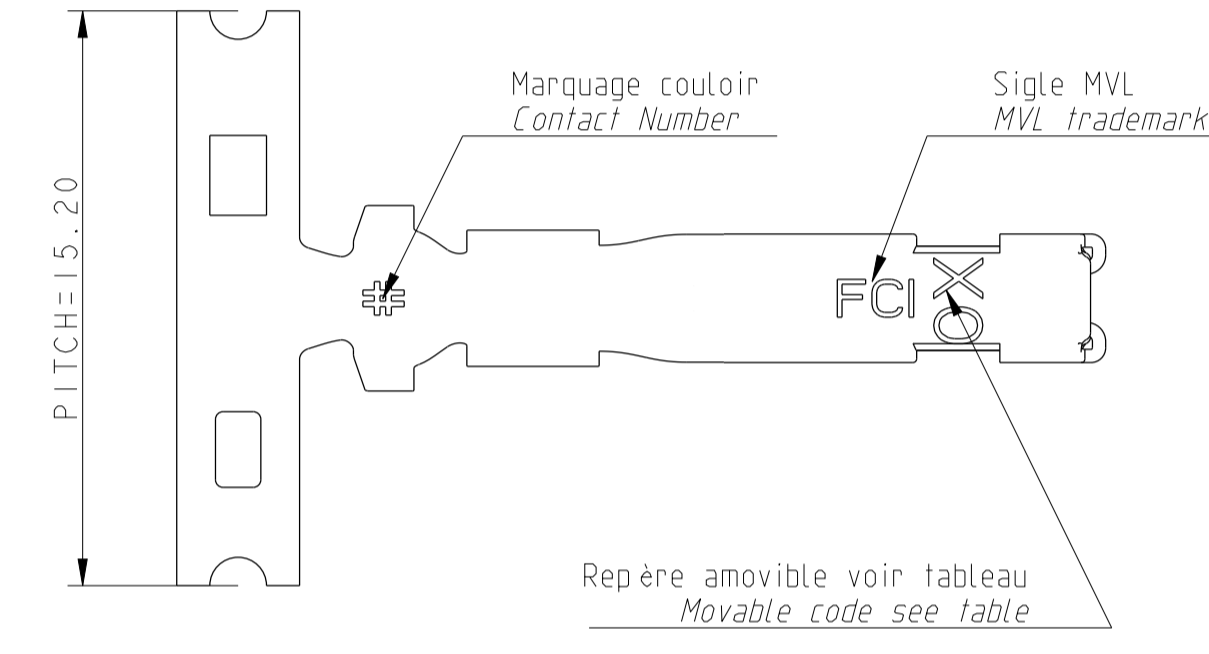

autre forme de bande porteuse et marquage
other shape for carrier strip and mark

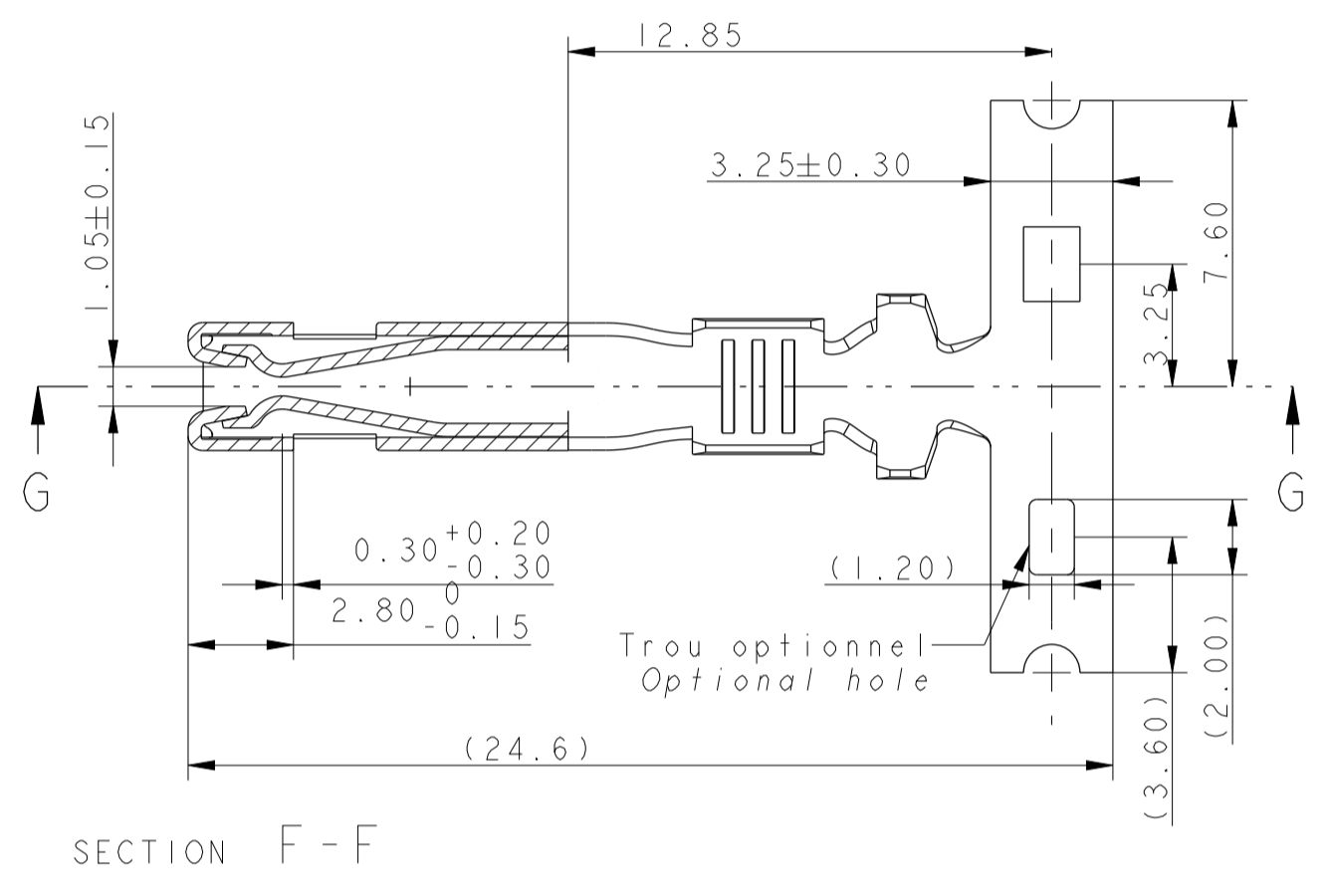
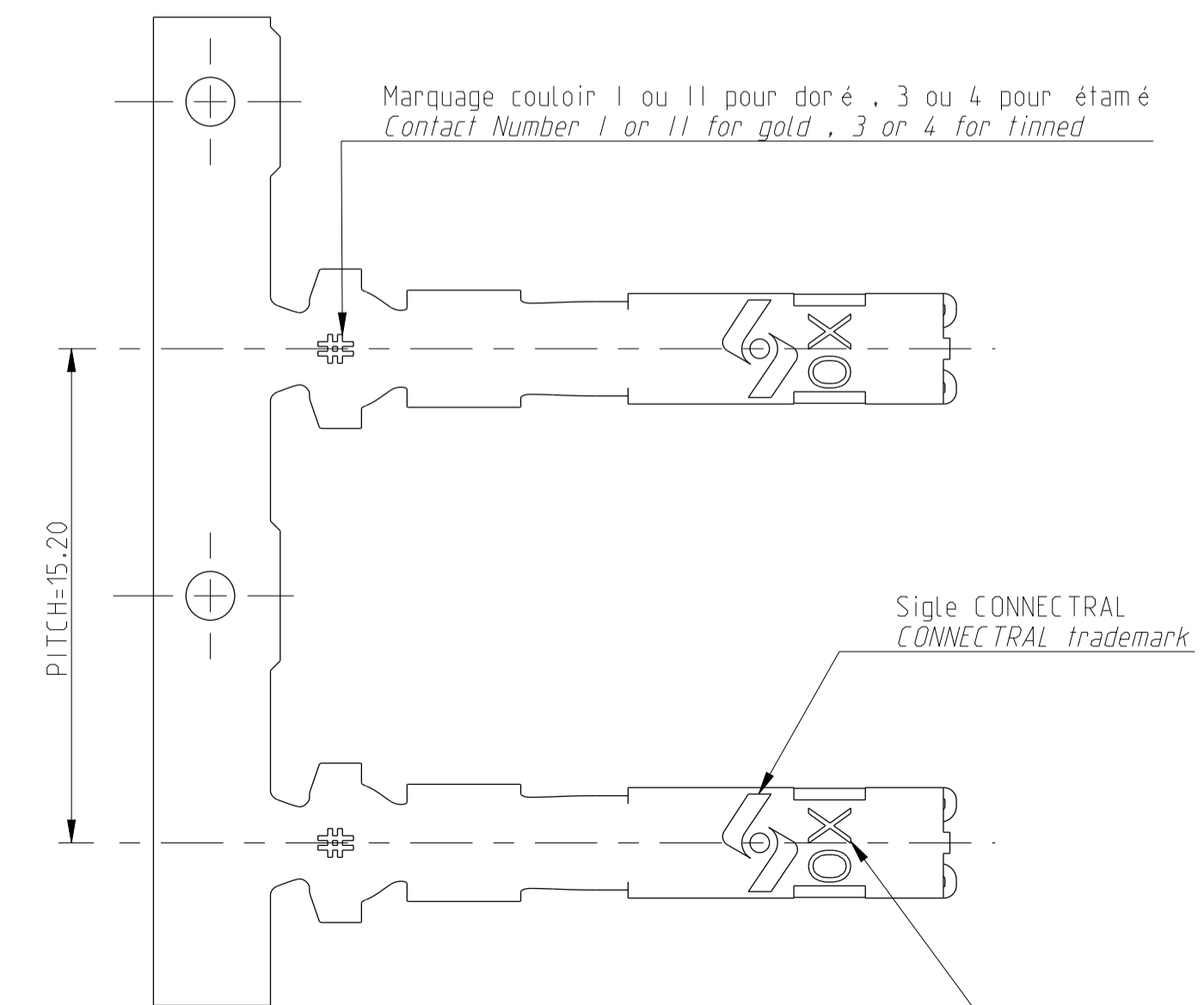
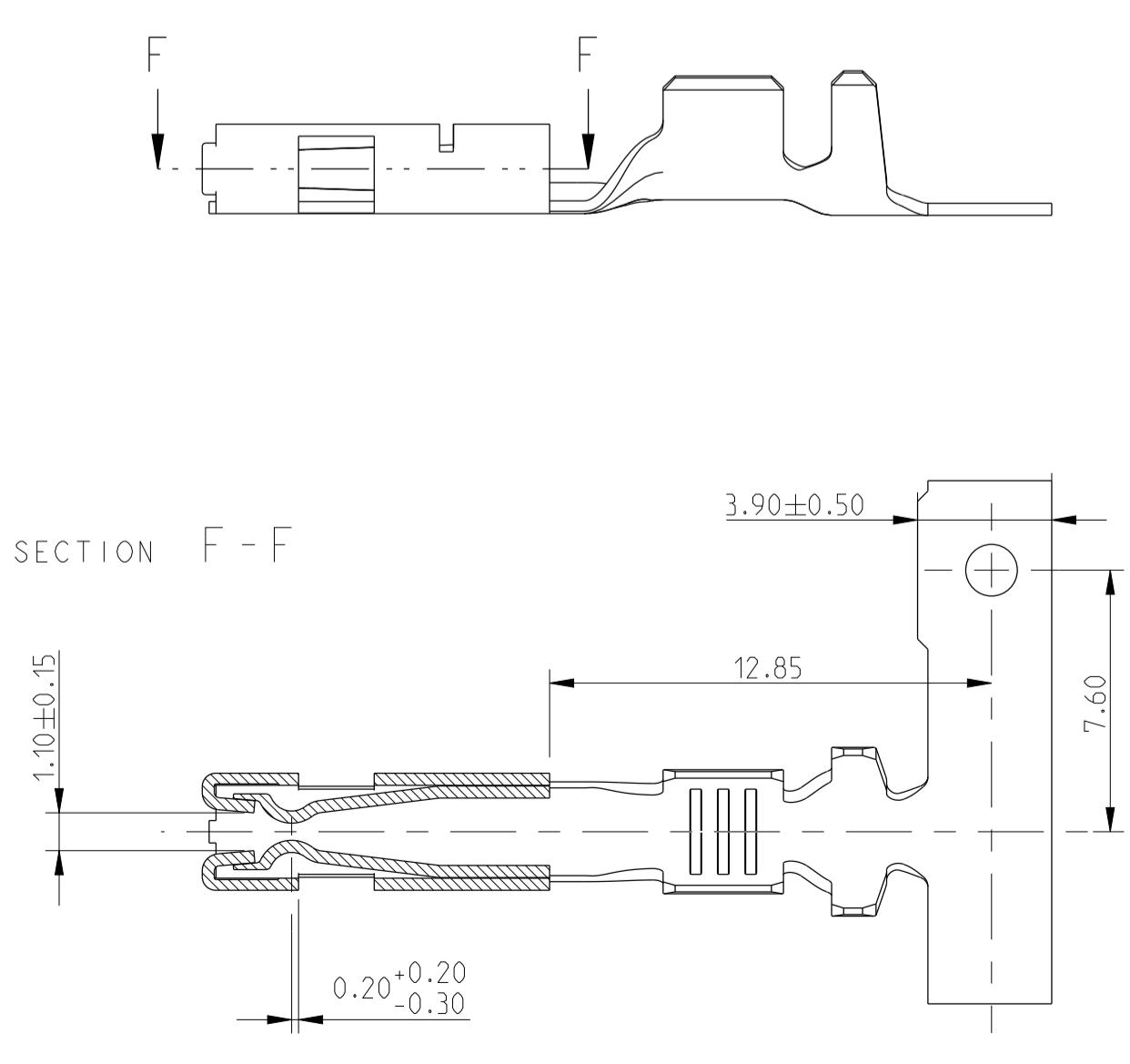

Repère amovible "10 ou 20" sauf 211CC2SXX30 / XX40 / XX42
Movable code "10 or 20" except 211CC2SXX30 / XX40 / XX42

Etat / State	Références / Part Number												Matiere / Material	Classe / Class	Marquage / Mark				
	MVL	Rev.	DELPHI	Rev.	MVL	Rev.	DELPHI	Rev.	MVL	Rev.	DELPHI	Rev.							
Pré-étamé / Pre-tinned					211CC2S1110	C	15368651	01					211CC2S2110	C	15368652	01	Cu Mg I	125*	10
Pré-étamé / Pre-tinned	211CC2S1120	C	10738188	01					211CC2S2120	C	10726212	01					Cu Mg I	125*	20
Post-doré / Post-gilded 1.27µ int	211CC2S1230	E	10738192	01					211CC2S2230	E	10757258	01					Cu Mg I	125*	
Post-doré / Post-gilded 1.27µ int	211CC2S1240	E	15324136	01					211CC2S2240	E	10865153	01					Cu Mg I	125*	Au
Post-doré / Post-gilded 1.27µ int	211CC2S1242	E	10756894	01													Cu Mg I	125*	

Section / Gauge	0.35 to 0.75				1 to 2			
∅ Isolant / Insulation	1.3 to 2.1				2.1 to 2.7			
A	2.6		2.7		3.6		3.1	
B	2.6		2.6		3.6		3.3	
C±0.10	0.6				0.8			
D±0.30	4.05		2.65		4.9		4.00	
E	3.50		2.80		4.2		3.30	
F±0.10	1.2		0.85		1.35		1.20	
K	0.6		0.25		0.4		0.25	
L	0.00				-0.05			

Reference		Pitch of strip = 15.20 65 terminals per meter					
MVL	DELPHI	Area	Ni (µm)	Sn		Thickness Au (µm)	
			B	C		nominal	mini
211 CC 2S X 2 30	-	A	1 MIN	0.5 MIN		1.52	1.27
211 CC 2S X 2 40	-		3 MAX	3 MAX			
211 CC 2S 1 2 42	10756894						

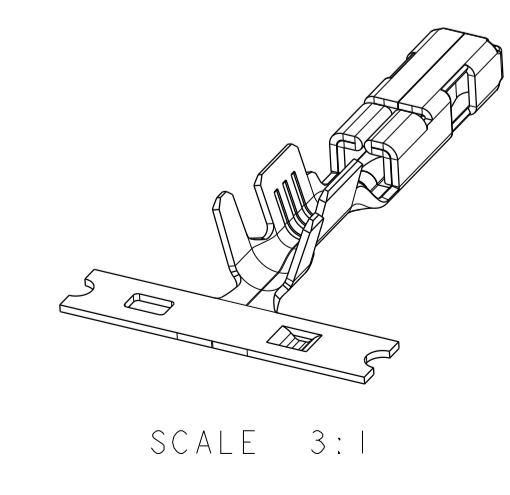
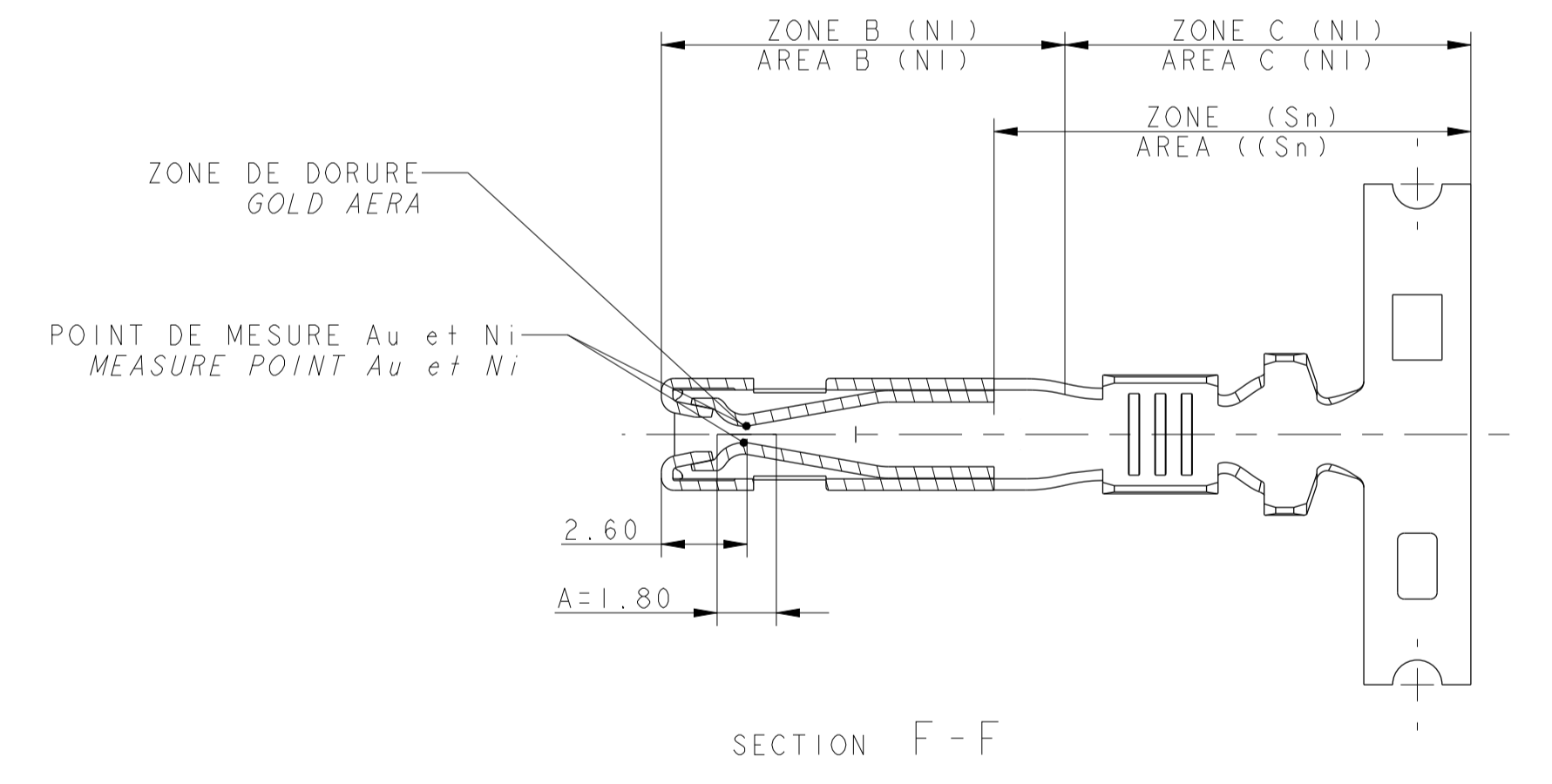

SCALE 3:1

ECN-NO. / NUMERO ECH	POSITION / POSITION	CHANGE DESCRIPTION / MODIFICATION	
PROJECT SPEC. / SPECIF. PRODUIT	PACKAGING SPEC. / SPECIF. EMBALLAGE	APPLICATION SPEC. / SPECIF. APPLICATION	COPYRIGHT DELPHI CORPORATION AND/OR ITS AFFILIATES. ALL RIGHTS RESERVED. REVISED 1997
TOLERANCES / TOLERANCES	±0.2 ± 2*	MATERIAL / MATIERE	SEE TABLE
CONTRACT NO. / CONTRAT N°		COLOR / COULEUR	
DO NOT REASURE DRAWING / NE PAS REASURE LE DROUING		TOOL NO. / NO. OUTIL	211 36 01/21/51
ECO EX. / ECO EX.		ECO EX. / ECO EX.	644 FE
DATE / DATE	NAME / NOM	TITLE / TITRE	DESIGNATION
1997-04-21	DM	15 x 08 FEMALE TERMINAL	
STATE / ETAT		PROJECT / PROJET	SICMA 2
APPROVED BY / APPROUVE PAR		ESR NO. / NUMERO ESR	FBA-0049
FILE NAME / NOM DE FICHER		NUMERO CAP	
211FT0278			

X-ON Electronics

Largest Supplier of Electrical and Electronic Components

Click to view similar products for [Automotive Connectors](#) category:

Click to view products by [APTIV](#) manufacturer:

Other Similar products are found below :

[003-018-000](#) [60403001](#) [60993906-B](#) [629515004020001](#) [M902-2131](#) [M902-2161](#) [72.330.1035.1](#) [73.353.4028.0](#) [F119300-B](#) [F166900](#)
[F258300-B](#) [F358300-B](#) [F407400](#) [F444110](#) [F487000](#) [F509500B-B](#) [827153-1](#) [8N1515-32-24P](#) [9-1326729-8](#) [925474-1](#) [928905-1](#) [964562-4](#)
[968782-1](#) [GT17SA-8DS-HU](#) [98891-1012](#) [98947-1016](#) [12004475-L](#) [12010290](#) [12010309-B](#) [12015454](#) [12020219-B](#) [12020308](#) [12041318-B](#)
[12052225-L](#) [12052466](#) [12059125](#) [12064869](#) [12004327-B](#) [12010503-B](#) [12015308](#) [12015384](#) [12015909](#) [1-21030-1](#) [12041254](#) [12041318](#)
[12047946-B](#) [12047957](#) [12047957-L](#) [12059473](#) [12066261](#)