

COMPONENTS

MVL P/Ns DELPHI P/Ns	HOUSING	HOUSING MATERIAL	SEC. LOCK	GASKET	GROMMET "RED"	GROMMET "GREEN"	GROMMET "BLUE"	GROMMET STOP BLACK	GROMMET STOP 12# GREEN	SLED VIOLET "RENAULT"	SLED VIOLET "NEUTRAL" Position -A-	SLED VIOLET "NEUTRAL" Position -B-	SLED "GREY"
21IPC249S0018 33504100 RevOI	Black	PA 6	Yes	Yes	Yes			Yes			Yes		
21IPC249S8018 33504103 RevOI	Grey	PA 6	Yes	Yes		Yes		Yes			Yes		
21IPC249S0031 33503458 RevOI	Black	PA 6	Yes	Yes	Yes			Yes				Yes	
21IPC249S1031 33503459 RevOI	Brown	PA 6	Yes	Yes	Yes			Yes				Yes	
21IPC249S0020 13751295 RevOI	Black	PBT	Yes										
21IPC249S1020 13751296 RevOI	Brown	PBT	Yes										
21IPC249S8020 13751294 RevOI	Grey	PBT	Yes										
21IPC249S0023 10776496 RevOI	Black	PBT	Yes	Yes	Yes			Yes					
21IPC249S8023 15535519 RevOI	Grey	PBT	Yes	Yes	Yes			Yes					
21IPC249S0033 10820454 RevOI-B	Black	PBT	Yes	Yes		Yes		Yes					
21IPC249S1033 13841561 RevOI	Brown	PBT	Yes	Yes		Yes		Yes					
21IPC249S6033 33500315 RevOI	Blue	PBT	Yes	Yes		Yes		Yes					
21IPC249S8033 13841588 RevOI	Grey	PBT	Yes	Yes		Yes		Yes					
21IPC249S0053 33504115 RevOI	Black	PBT	Yes	Yes		Yes		Yes				Yes	
21IPC249S8063 33503460 RevOI	Grey	PBT	Yes	Yes		Yes		Yes			Yes		
1 726 12 05 13593425 RevOI	Black	PBT	Yes	Yes		Yes		Yes					
33403921 RevOI	Natural	PBT	Yes	Yes		Yes		Yes					
33403922 RevOI	Green	PBT	Yes	Yes		Yes		Yes					
33403923 RevOI	Orange	PBT	Yes	Yes		Yes		Yes					
35141428	Dark blue	PBT	Yes	Yes		Yes		Yes					
35141595	Red	PBT	Yes	Yes		Yes		Yes					
35141598	Light brown	PBT	Yes	Yes		Yes		Yes					
35141599	Light green	PBT	Yes	Yes		Yes		Yes					
35141600	Purple	PBT	Yes	Yes		Yes		Yes					

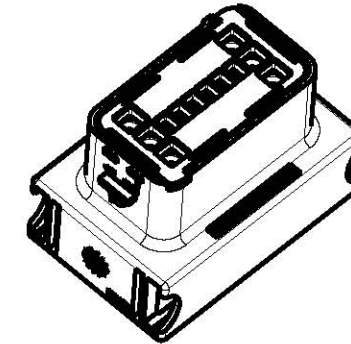

1 726 12 05
 12 WAYS CLOSED VERSION
 A2,A3,A4,A5,A6,A7
 C2,C3,C4,C5,C6,C7

	27-09-2017	D	A7	Added new pas (dark blue,red,light brown,light green,purple)	GB		GI		
14-10942	28-11-2014	C	-	Deleted obsolete part numbers on the table	FG.		MC.		
14-03142	05/03/14	B	A7	Added new pn33403921-33403922-33403923	GB	FG	MC		
14-11	05/08/11	A	--	Added pn 21IPC249S8018	GB	FG	MC		
38-07	02/05/07	11	C7	Added PN 21IPC249S8063, Deleted PN 21IPC249S8018 Reduced rib length	GB	FG	MC		
29-2007	29-03-2007	10	--	Ass'y 21IPC249S8043, changed Hsg-mtl. It was PA 6	EC		MC		
21-06	13-03-06	09	--	Added new PN	[Cini]		M.C.		
ECN 85/05	16/12/05	08		See ECN Documentation	E.C.		M.C.		
ECN 17/04	28/05/04	07		See ECN Documentation	E.C.		M.C.		
ECN 10/04	17/02/04	06		ADDED 3 CATALOG NUMBERS (SEE SHEET 3)	R.R. G.S.				
ECN 41/03	05/11/03	05		RELEASED FOR PRODUCTION	R.R. G.S.				
	28/10/03	04		UPDATED DRAWING	R.R. G.S.				
	01/09/03	03		MODIFIED MATERIAL FOR THE FOLLOWING P/N 21IPC249S8020 - 21IPC249S8023 - 121IPC249S1033 WAS PAB GF 15 PBT GF	R.R. G.S.				
	28/05/03	02		ADDED P/N 21IPC249SX043	R.R. G.S.				
	21/03/03	01		UPDATED DRAWING	R.R. G.S.				
ECN-NO. NUMERO -ECN	DATE DATA	DD/ MM / YY	REVISION REVISIONE	POSITION POSIZIONE	CHANGE DESCRIPTION DESCRIZIONE MODIFICA		DRAWN BY DISEGNATORE	CHK. BY CONTROLLATO	APPR. BY APPROVATO
PRODUCT SPEC. SPEC. DI PRODOTTO	PACKAGING SPEC. SPEC. DI IMBALLAGGIO	APPLICATION SPEC. SPEC. DI APPLICAZIONE	COPYRIGHT DELPHI CORPORATION AND/OR ITS AFFILIATES. ALL RIGHTS RESERVED. REVISED THIS DRAWING IS THE PROPERTY OF DELPHI CORPORATION. THE REPRODUCTION, DISTRIBUTION AND UTILIZATION OF THIS DOCUMENT OR ITS RELATED CAD MATH DATA, AS WELL AS COMMUNICATION OF ANY CONTENT TO OTHERS, WITHOUT EXPRESS AUTHORIZATION IS PROHIBITED.				QUESTO DISEGNO E' PROPRIETA' DI DELPHI CORPORATION E CONTIENE INFORMAZIONI CONFIDENZIALI. LA RIPRODUZIONE, DISTRIBUZIONE E UTILIZZAZIONE DI QUESTO DOCUMENTO O DELLE SUE RELATIVE MATEMATICHE CAD, SENZA LA COMUNICAZIONE DI QUALSIASI CONTENUTO AD ALTRI, SENZA ESPlicita AUTORIZZAZIONE, E' PROIBITA.		
TOLERANCES TOLLERANZE	± 0.3mm / ± 0.1"	MATERIAL : MATERIALE :	see table		SURFACE FINISH FINITURA SUPERFICIALE	DELPHI DELPHI PACKARD ELECTRICAL/ELECTRONIC ARCHITECTURE TORINO, ITALY			CAD SYSTEM pro / eng.
COUNTERPART N°. CONTROPARTE N°.		COLOUR : COLORE :	-			C			DWG SIZE FORMATO A3
DO NOT SCALE DRAWING DISEGNO FUORI SCALA	DATE DATA	NAME NOME	TITLE DESCRIZIONE	LOC. CODE NAZIONALITA'	IT	DRAWING NUMBER NUMERO DISEGNO		SHEET FOGLIO	
DRAWN BY DISSEGNATORE	09/01/03	R. Ramponc	24 WAYS SECTIONING ASSEMBLY FEMALE HOLDER	FILE NAME	fsc309602.conn.pf	DRAWING NUMBER NUMERO DISEGNO		SHEET FOGLIO	2 of 1 di 2
CHECKED BY CONTROLLATO	09/01/03	G. Stella	ESR NO. NUMERO ESR	CAT. NO. NUMERO CAT	see table	DRAWING NUMBER NUMERO DISEGNO		SHEET FOGLIO	2 of 1 di 2
APPROVED BY APPROVATO			IT A2043	FILE NAME	fsc309602.conn.pf	DRAWING NUMBER NUMERO DISEGNO		SHEET FOGLIO	2 of 1 di 2

X-ON Electronics

Largest Supplier of Electrical and Electronic Components

Click to view similar products for [Automotive Connectors](#) category:

Click to view products by [APTIV](#) manufacturer:

Other Similar products are found below :

[003-018-000](#) [60403001](#) [60993906-B](#) [629515004020001](#) [M902-2131](#) [M902-2161](#) [72.330.1035.1](#) [73.353.4028.0](#) [F119300-B](#) [F166900](#)
[F258300-B](#) [F358300-B](#) [F407400](#) [F444110](#) [F487000](#) [F509500B-B](#) [827153-1](#) [8N1515-32-24P](#) [9-1326729-8](#) [925474-1](#) [928905-1](#) [964562-4](#)
[968782-1](#) [GT17SA-8DS-HU](#) [98891-1012](#) [98947-1016](#) [12004475-L](#) [12010290](#) [12010309-B](#) [12015454](#) [12020219-B](#) [12020308](#) [12041318-B](#)
[12052225-L](#) [12052466](#) [12059125](#) [12064869](#) [12004327-B](#) [12010503-B](#) [12015308](#) [12015384](#) [12015909](#) [1-21030-1](#) [12041254](#) [12041318](#)
[12047946-B](#) [12047957](#) [12047957-L](#) [12059473](#) [12066261](#)