

ASSEMBLY NUMBER	KEY OPTION	ITEM 1 HOUSING PA66 GF35	ITEM 2 TPA	ITEM 3 RING SEAL	ITEM 4 CPA
		FCI PART NUMBER	COLOR FCI PART NUMBER	FCI PART NUMBER	FCI PART NUMBER
F258300	A	S546300	DK GREY F055000	F546000 GREEN	NO
F593500	A		AQUA S643500		
F358300	B		NATURAL F138400		
F832210	C		DK GREY S632210		
F932210	D		BLACK S732210		
F731210	A		DK GREY F055000		
F007400	B		DK BLUE F366000		
F242210	C		DK GREY S632210		
F342210	D	BLACK S732210	F752210		

APPLICABLE COMPONENTS								
ITEM NO.	ITEM DESCRIPTION	PLATING OR COLOR	SUPPLIER	SUPPLIER COMP PART NUMBER	GRIP CODE	WIRE SIZE	WIRE INSULATION DIAMETER RANGE	MATERIAL/SPEC NO
5	2.8mm SEALED SYSTEM TERMINAL (F)	TIN	FCI	54001840	18	20-18 AWG 0.50-1.00mm <sup>2</sup>	1.40mm-2.13mm	COPPER ALLOY / NA
	2.8mm SEALED SYSTEM TERMINAL (F)	TIN	FCI	54001432	14	16-14 AWG 1.50-2.50mm <sup>2</sup>	2.18mm-3.00mm	COPPER ALLOY / NA
	2.8mm SEALED SYSTEM TERMINAL (F)	GOLD	FCI	54001879	18AU	20-18 AWG 0.50-1.00mm <sup>2</sup>	1.40mm-2.13mm	COPPER ALLOY / NA
	2.8mm SEALED SYSTEM TERMINAL (F)	GOLD	FCI	54001448	14AU	16-14 AWG 1.50-2.50mm <sup>2</sup>	2.18mm-3.00mm	COPPER ALLOY / NA
	2.8mm SEALED SYSTEM TERMINAL (F)	TIN	FCI	54001807	18	20-18 AWG 0.50-1.00mm <sup>2</sup>	1.40mm-2.13mm	COPPER ALLOY / NA
	2.8mm SEALED SYSTEM TERMINAL (F)	TIN	FCI	54001404	14	16-14 AWG 1.50-2.50mm <sup>2</sup>	2.18mm-3.00mm	COPPER ALLOY / NA
	2.8mm SEALED SYSTEM TERMINAL (F)	GOLD	FCI	54001811	18AU	20-18 AWG 0.50-1.00mm <sup>2</sup>	1.40mm-2.13mm	COPPER ALLOY / NA
	2.8mm SEALED SYSTEM TERMINAL (F)	GOLD	FCI	54001410	14AU	16-14 AWG 1.50-2.50mm <sup>2</sup>	2.18mm-3.00mm	COPPER ALLOY / NA
6	2.80mm SYSTEM CABLE SEAL ROUND	GREEN	FCI (OSR)	F676000	-	20-18 AWG 0.50-1.00mm <sup>2</sup>	1.40mm-2.13mm	SILICONE
	2.80mm SYSTEM CABLE SEAL ROUND	BLUE	FCI (OSR)	F576000	-	16-14 AWG 1.50-2.0mm <sup>2</sup>	2.18mm-2.80mm	SILICONE
	2.80mm SYSTEM CABLE SEAL ROUND	YELLOW	FCI	60994034	-	2.5mm <sup>2</sup>	2.70mm-3.00mm	SILICONE
7	2.80 SYSTEM CAVITY PLUG ROUND	WHITE	DELPHI	15305170	-	-	-	SILICONE

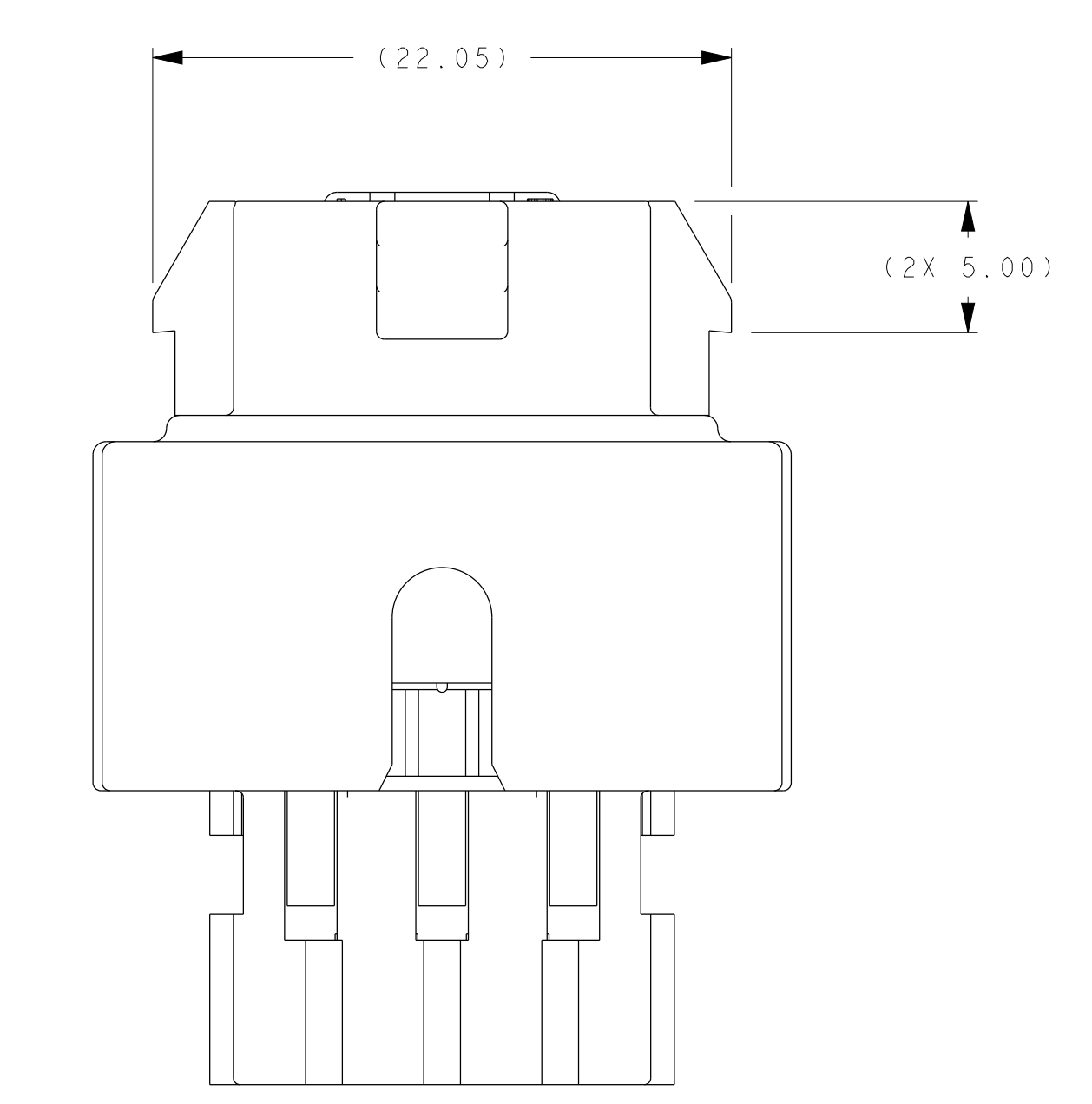
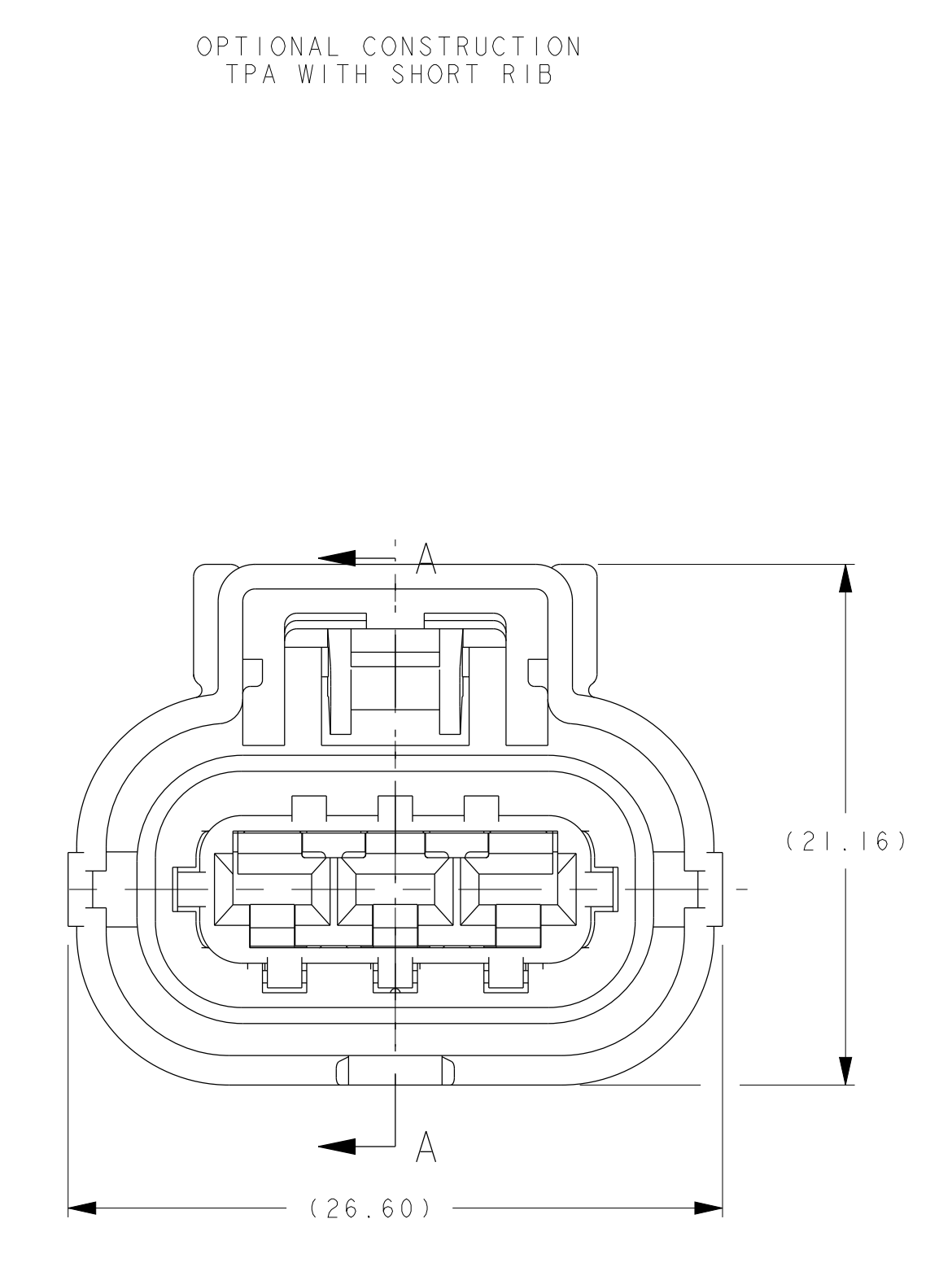
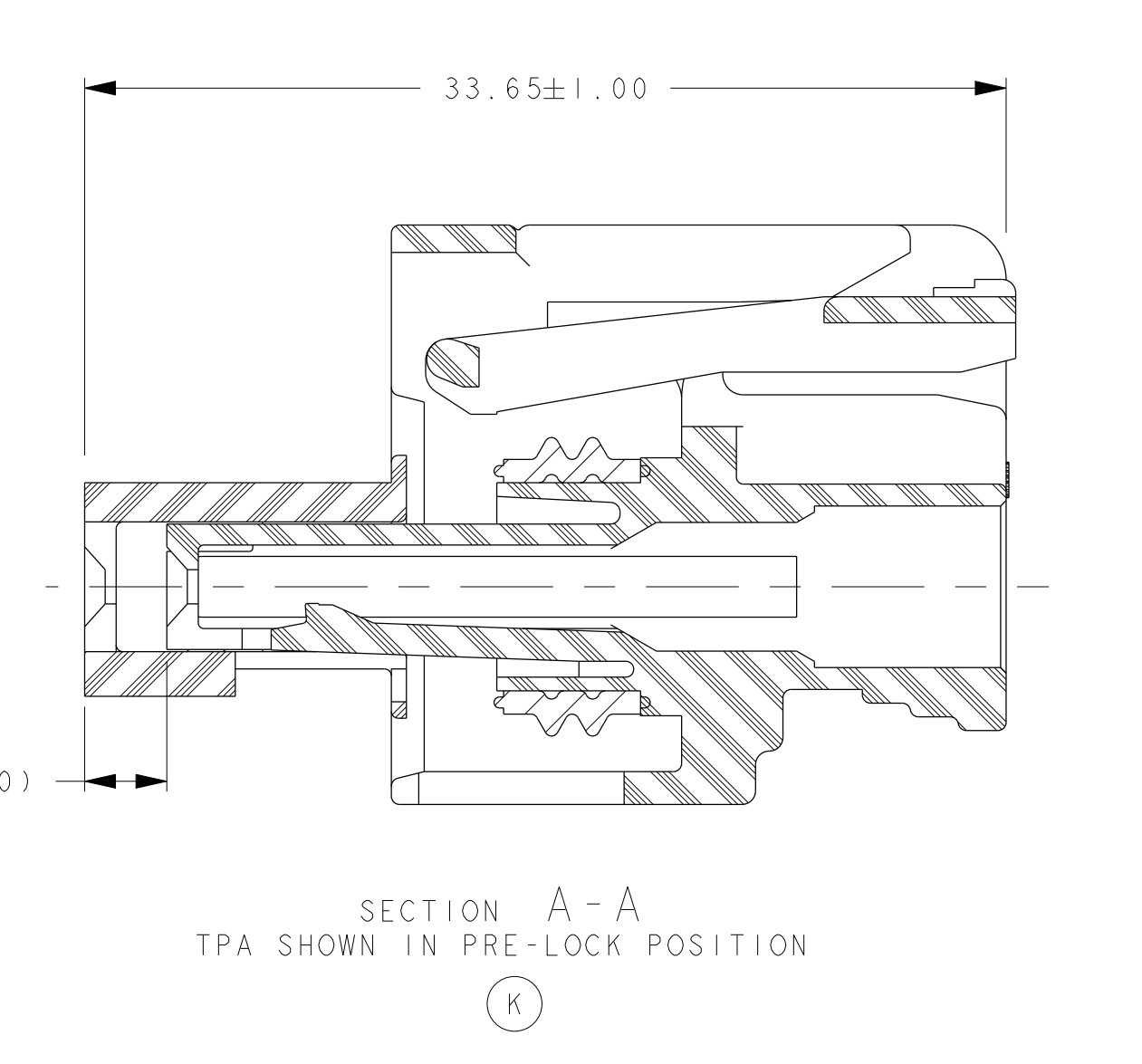
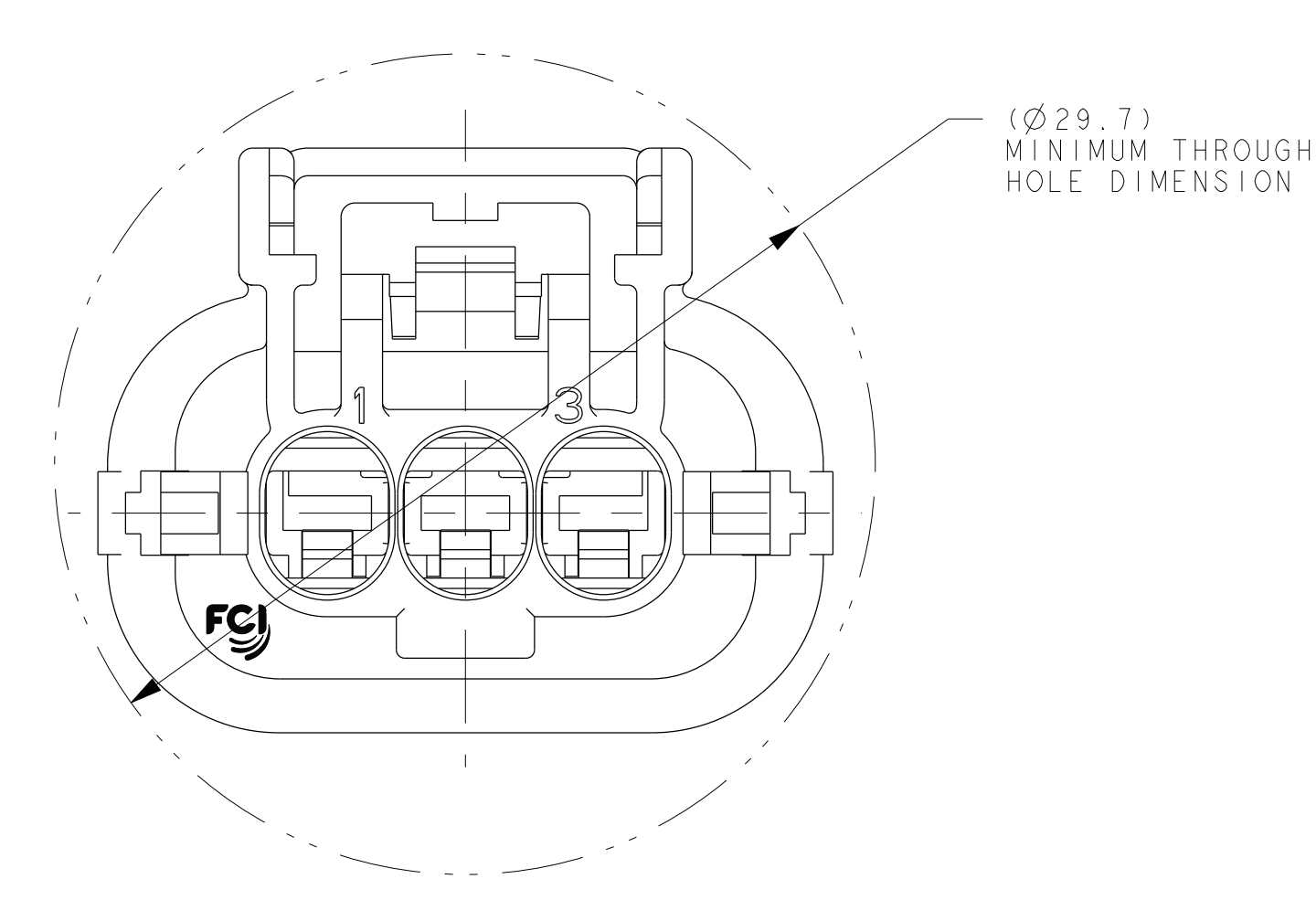
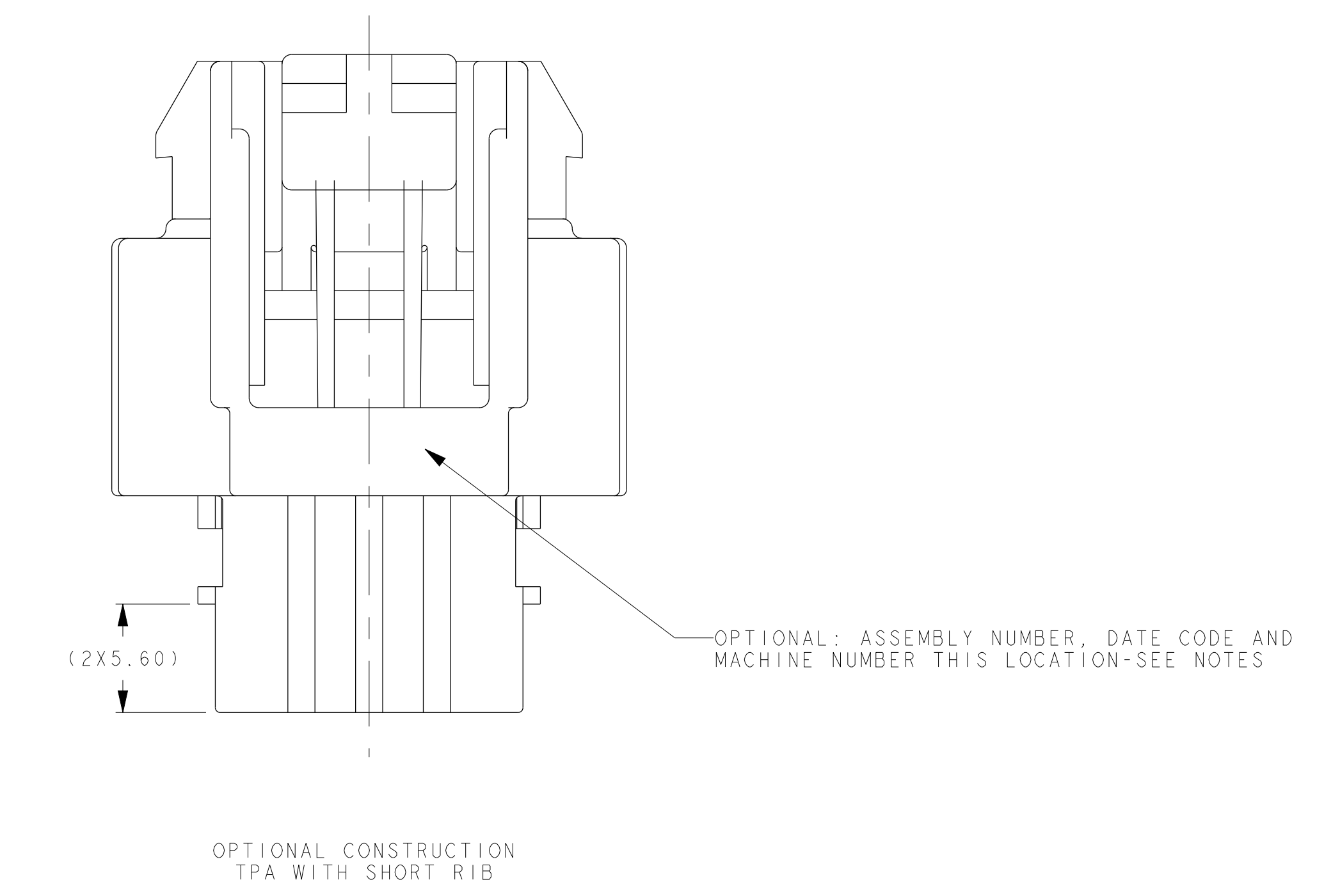
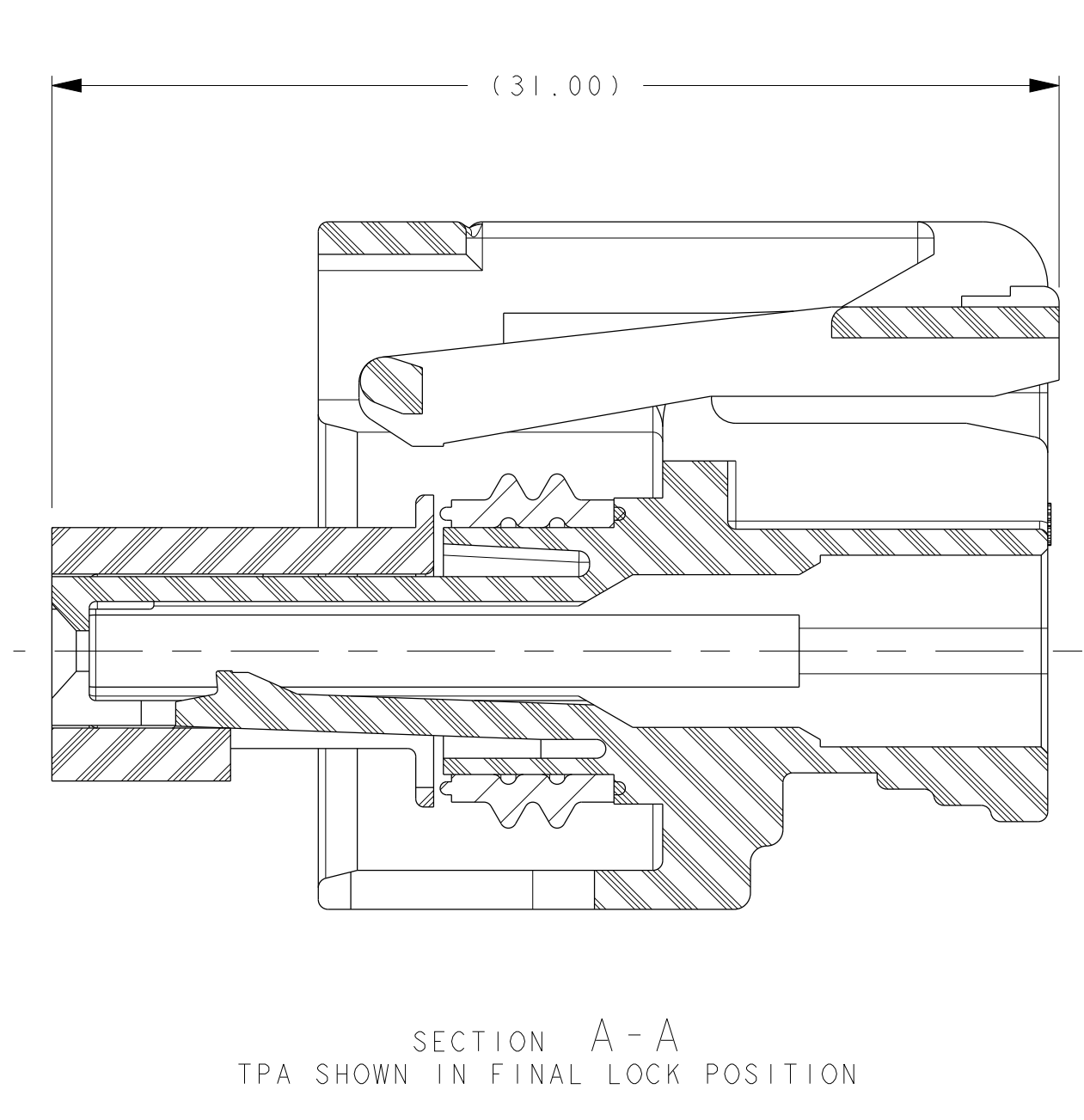
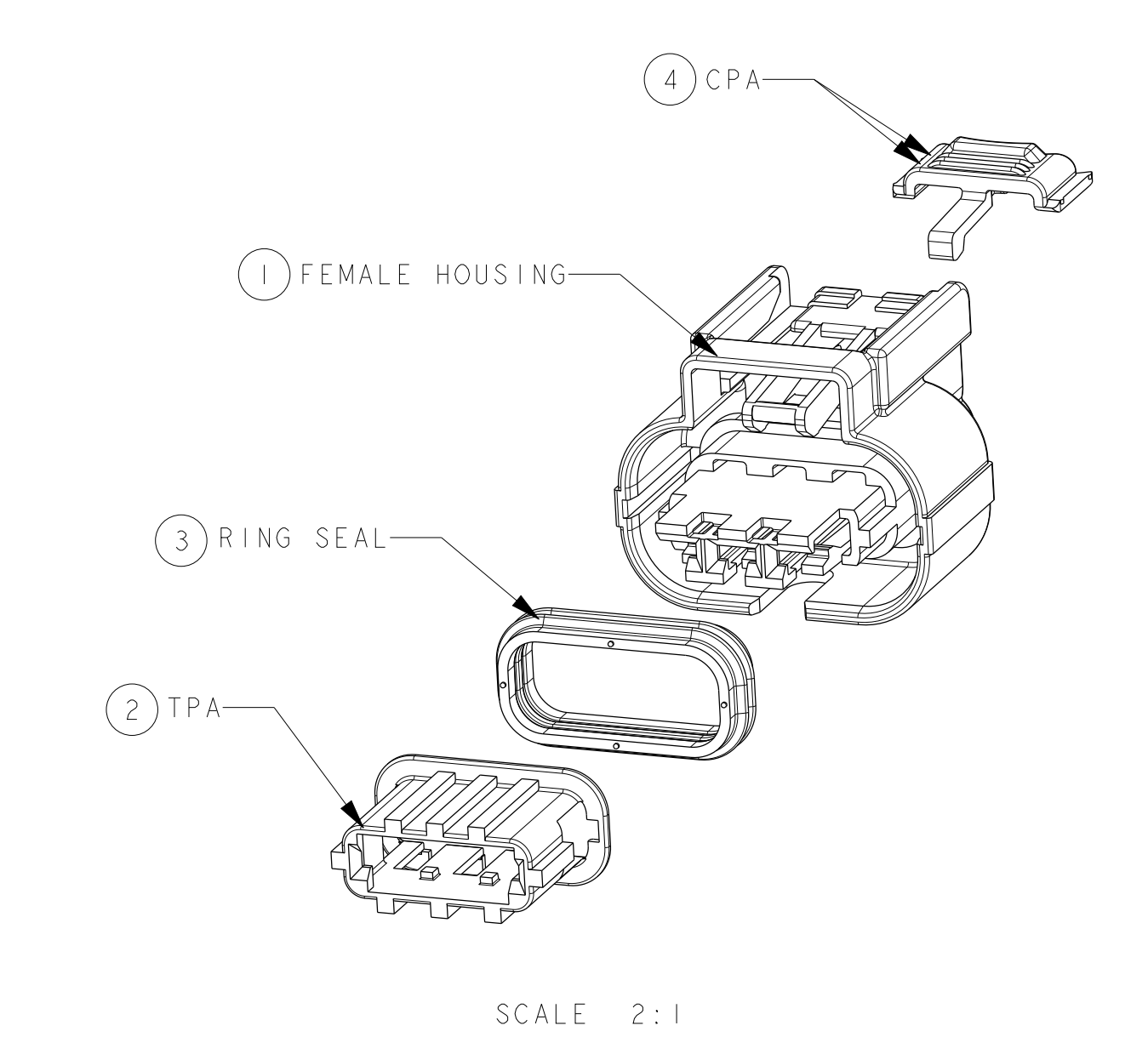
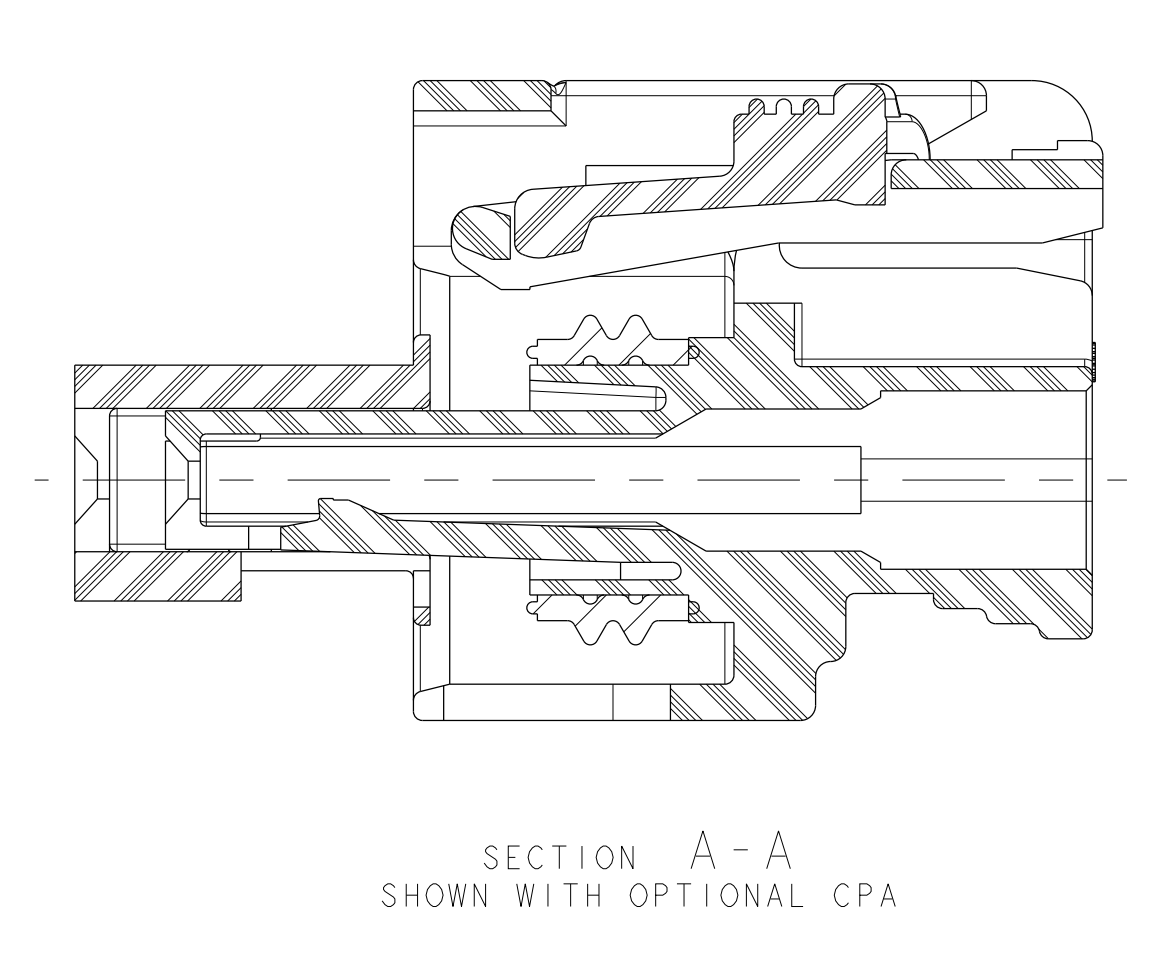
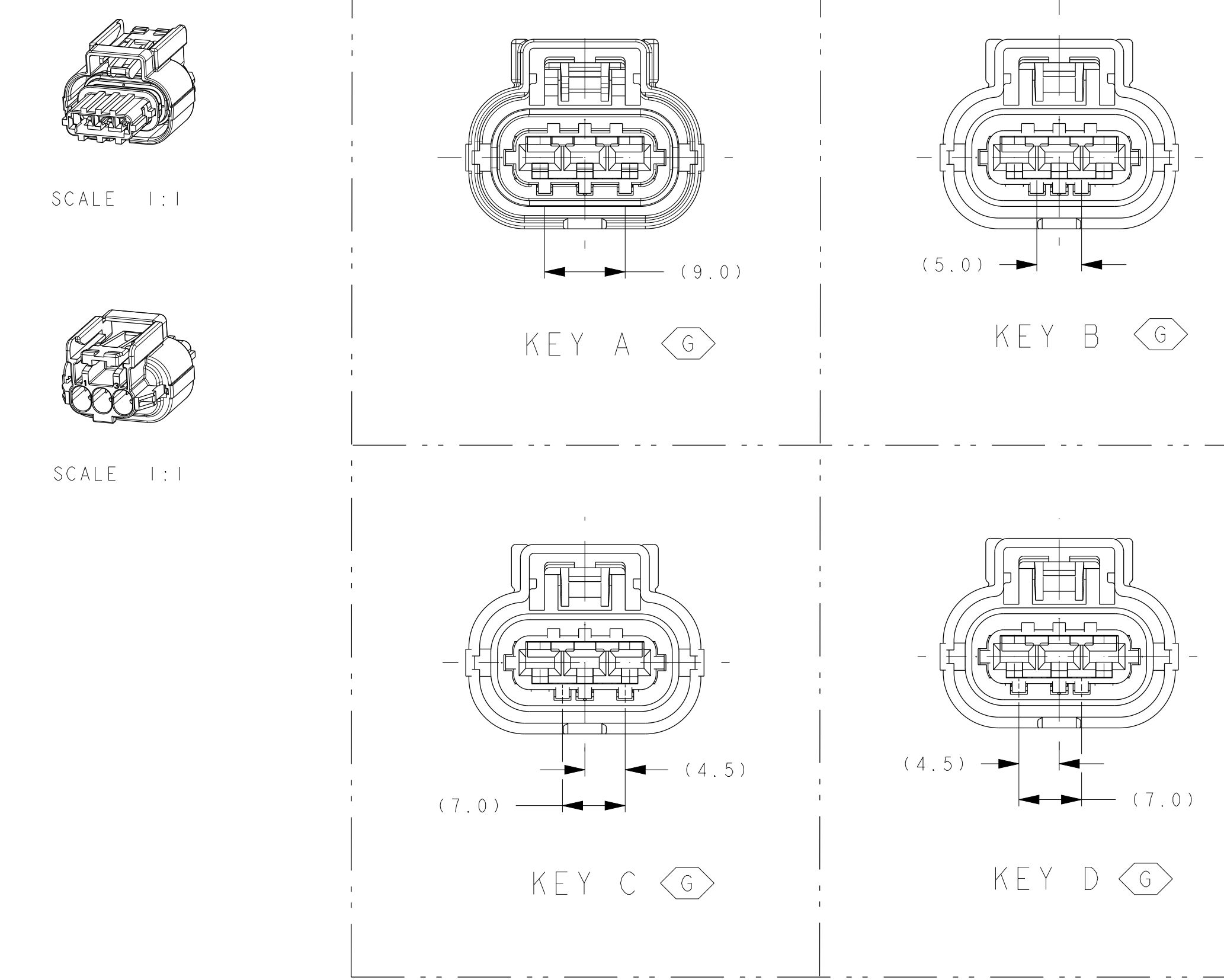

- NOTES:
- 1) VALIDATED TO SAE/USCAR-2 REV 5
  - 2) VALIDATED TO THE FOLLOWING TEMP, VIBRATION, AND SEALING CLASSES:
    - SAE/USCAR-2 V3 T3 (125°C) WITH GOLD TERMINALS
    - SAE/USCAR-2 SEALING S3 T3 (125°C)(ISO16750 9K EQUIVALENT)
  - 3) CONNECTOR MAY BE USED WITH THE FOLLOWING TERMINALS:
    - FCI APEX 2.8 TERMINALS LISTED IN THE APPLICABLE COMPONENTS CHART ON THIS DRAWING WITH WIRE SIZES DEFINED IN NOTE 4.
    - SEE FCI DRAWING C15004-CUST FOR SPECIFIC TERMINAL DETAILS AND CRIMPING REQUIREMENTS
    - PLATING OF TERMINALS AND MATING DEVICE BLADES MUST BE COMPATIBLE
    - SEE NOTE 5
    - EXCESSIVELY THICK TIN PLATING ON DEVICE BLADES IS NOT RECOMMENDED
  - 4) CONNECTOR SYSTEM VALIDATED TO USCAR-2 REQUIREMENTS WITH THE FOLLOWING RANGE OF WIRE SIZES AND TYPES IN CONJUNCTION WITH APPROPRIATE COMPONENTS FOUND IN THE "APPLICABLE COMPONENTS" CHART:
    - AWG - WIRE SIZES: 20AWG - 14AWG
    - INSULATION DIAMETER: 1.70mm MIN - 2.77mm MAX
    - WIRE TYPE: ML-123-A, MS-8288 OR EQUIVALENT (STRUCTURE AND PROPERTIES ACCORDING TO SAE J1128)
    - METRIC - WIRE SIZE: 0.50mm<sup>2</sup> - 2.50mm<sup>2</sup>
    - INSULATION DIAMETER: 1.40mm MIN - 3.00mm MAX
    - WIRE TYPE: FLR2X-A OR EQUIVALENT (STRUCTURE AND PROPERTIES ACCORDING TO ISO 6722)

CONTACT FCI ENGINEERING REGARDING USE OF OTHER WIRE SIZES AND/OR TYPES

WIRE AND INSULATION TYPE MUST BE APPROPRIATE FOR TEMPERATURE CLASS & APPLICATION ENVIRONMENT
  - 5) CONNECTOR IS MATE COMPATIBLE WITH DEVICES CONFORMING WITH THE FOLLOWING INTERFACE SPECIFICATIONS:
    - FORD DWG 8U5T-14A464-GAC SHEET 2 (PREFERRED)
    - BOSCH DWG 1928S0000 VARIANT A
    - GM DWG 13115604

FOR CONSTRUCTION OF NEW DEVICES, FORD DWG 8U5T-14A464-GAC SHEET 2 IS RECOMMENDED

NOTE: EXCESSIVELY THICK TIN PLATING ON DEVICE BLADES IS NOT RECOMMENDED. SEE EWAP-001 (280-T001) BLADE SPECIFICATION FOR PREFERRED PLATING

DEVICE SUPPLIERS RESPONSIBLE FOR VALIDATING PERFORMANCE OF DEVICE TO SAE/USCAR-2 REV 5
  - 6) ANNUAL QUALITY REQUIREMENTS:
    - IT IS PERMISSIBLE TO PERFORM CONTINUOUS CONFORMANCE PER FCI SPECIFICATION #A0A-001 INSTEAD OF ANNUAL LAYOUT AND ANNUAL PV REQUIREMENTS OF ISO 15189 AND SAE/USCAR-2 REV 5, FOR TERMINAL TO CONNECTOR AND TPA TO CONNECTOR ONLY.
  - 7) SOURCE ID, MOLD & CAVITY ID SIGNIFIES TOOL OWNERSHIP, FOR REFERENCE
  - 8) (K) INDICATES IN-PROCESS INSPECTION FOR MANUFACTURING DIMENSIONS OR SPECIFICATIONS.

EN-12-01314P CHART ADD 0.5mm<sup>2</sup> WIRE, REVISE WIRE SIZE COLUMN, REVISE INSUL. O.D. COLUMN

NOTES: REVISE NOTE 4 WITH 0.5mm WIRE INFO

1200730 AP CHART CORRECTED WIRE INSULATION DIA RANGE FOR F516000 2.18mm-2.80mm WAS 2.18mm-2.77mm

R23 CORRECTED PART NUMBER: F731210 WAS F181210

1200532 NEW RELEASE - RELEASED AT REV B

REV	DATE	BY	CHKD	DESCRIPTION
1				INITIAL CHART ASSEMBLY - SWAY FEMALE
2				CAVITY DETAIL-APEX 280MM

PROJECT: CAVITY DETAIL-APEX 280MM

DRAWING NUMBER: PCC060106

SHEET: 1 OF 1

SCALE: 1:1

STATUS: SERIAL RELEASED

## X-ON Electronics

Largest Supplier of Electrical and Electronic Components

*Click to view similar products for [Automotive Connectors](#) category:*

*Click to view products by [APTIV](#) manufacturer:*

Other Similar products are found below :

[003-018-000](#) [60403001](#) [60993906-B](#) [629515004020001](#) [M902-2131](#) [M902-2161](#) [72.330.1035.1](#) [73.353.4028.0](#) [F119300-B](#) [F166900](#)  
[F258300-B](#) [F358300-B](#) [F407400](#) [F444110](#) [F487000](#) [F509500B-B](#) [827153-1](#) [8N1515-32-24P](#) [9-1326729-8](#) [925474-1](#) [928905-1](#) [964562-4](#)  
[968782-1](#) [GT17SA-8DS-HU](#) [98891-1012](#) [98947-1016](#) [12004475-L](#) [12010290](#) [12010309-B](#) [12015454](#) [12020219-B](#) [12020308](#) [12041318-B](#)  
[12052225-L](#) [12052466](#) [12059125](#) [12064869](#) [12004327-B](#) [12010503-B](#) [12015308](#) [12015384](#) [12015909](#) [1-21030-1](#) [12041254](#) [12041318](#)  
[12047946-B](#) [12047957](#) [12047957-L](#) [12059473](#) [12066261](#)