

1	2	3	4	5	6	7
---	---	---	---	---	---	---

A **A XX-LC-TT** **A XX-LC/7-T**

CKT: 06, 08, 14, 16, 18, 20 CKT: 24, 28, 32, 40 CKT: 24, 28

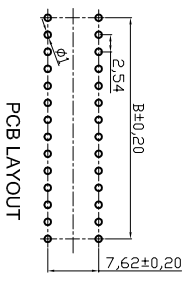
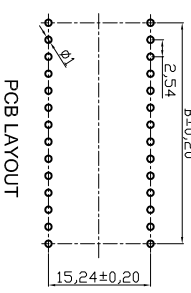
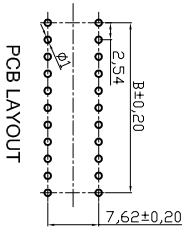
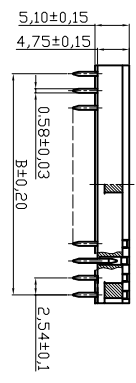
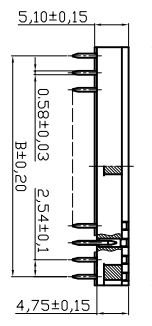
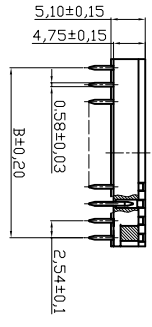
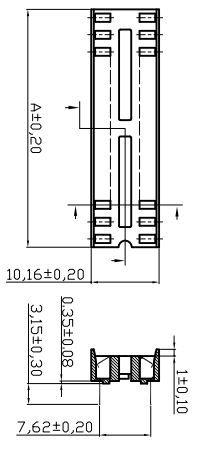
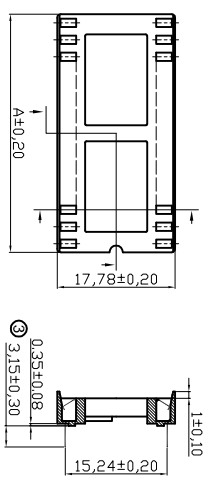
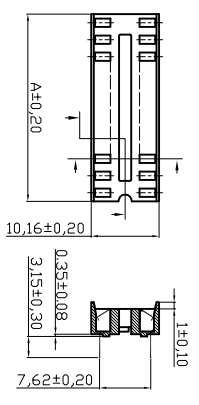

CKT	A±0.20	B±0.20
06	7.62	5.08
08	10.16	7.62
14	17.78	15.24
16	20.32	17.78
18	22.86	20.32
20	25.40	22.86

CKT	A±0.20	B±0.20
24	30.48	27.94
28	35.56	33.02
32	40.64	38.10
40	50.80	48.26

CKT	A±0.20	B±0.20
24	30.48	27.94
28	35.56	33.02

MATERIAL:
 Contact : Phosphor- Bronze thickness 0.15mm
 Plating : Contact Plating, Tin plated 60u"~80u" (Lead free plating)
 Insulator : PBT-4830 , UL 94V-0

SPECIFICATIONS:
 Current Rating : 1A
 Dielectric withstanding Voltage : 1000V RMS/minute
 Insulator resistance : 5000 Megohms min.
 Contact resistance : 20 milliohms initial
 30 milliohms after test.
 Operating temperatures : -55°c to 85°c
 Insertion force : 340g(12 oz) max.per contact.
 Withdrawal force : 80g(2.82 oz) min.per contact
 Soldering temperature: +245° C , 5S max.

RoHS compliant
 Unit: mm

Scale	Free						
TOLERANCE							
X.	±X	④	Add soldering temperature	24.02.2017	Amy	Drawn	24.03.1999
X.X	±X	③	Correct dimensions	05.11.2009	Dean	Approved	24.02.2017
X.XX	±X	②	Update	21.07.2009	Dean		
DIM	TOL	①	Drawn	24.03.1999	Hellwig		
X.°	±X°						
X.X°	±X°						
Angle	TOL	Id.	Modification	Date	Name		



Customer-No.		Date	24.03.1999	Name	Hellwig
ASSMANN WSW-No.	A XX-LC-TT				
	A XX-LC/7-T				
Drawing-No.	ASS 0810 CO				
Replace	ASS 0333A CO				
	ASS 0333B CO				
	rev04				
	Sheet				

1	2	3	4	5	6	7
---	---	---	---	---	---	---

H	G	F	E	D	C	B	A
---	---	---	---	---	---	---	---

X-ON Electronics

Largest Supplier of Electrical and Electronic Components

Click to view similar products for [assmann](#) manufacturer:

Other Similar products are found below :

[AU-Y1007-R](#) [AK-320200-100-S](#) [AK-330114-050-S](#) [AK-340100-020-S](#) [AK-340305-010-W](#) [AK-340305-030-W](#) [AK-340603-000-S](#) [AK500-RA-6-0.5-R](#) [AK669/2-18-BLACK-R](#) [AT-K-26-10-B/1000](#) [AU-Y1008-2-R](#) [AWG28-50/G/300](#) [AWH26G-0232](#) [AB-900](#) [AB-970](#) [AB-984](#) [A-DS 15PP](#) [AK-320200-030-S](#) [AK-340100-030-S](#) [AK-340301-020-S](#) [AK-340301-030-S](#) [AK-340305-020-W](#) [AK-340602-000-S](#) [AK3730X-R](#) [AK579/F-2](#) [A-MCU60010/Y](#) [A-PC2302-030028-1](#) [A-LED8-1WAAS-MR7-1](#) [AT-S-26-8/8/W-7/R](#) [DN-91524U](#) [DK-2631-05](#) [DN-91624U](#) [DN-91548U](#) [DK-1511-015/WH](#) [A-MCU60030/R](#) [AWH50G-0202-T-R](#) [AK500/16-OE-7-0.5](#) [DK-1611-020/B](#) [DK-1511-100/G](#) [AK-300136-018-S](#) [AT-K-26-10-W/1000](#) [AWG28-15/G/300](#) [ATUP-P305T](#) [AWP 10-7540-T](#) [AK-330118-100-S](#) [AK-330118-300-S](#) [AK500/U-1-R](#) [AK-SATA-030DL-R](#) [AWG28-16/G/300](#) [AWG28-9/F/300](#)