

Male

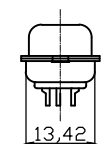
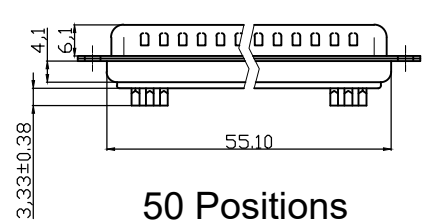
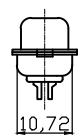
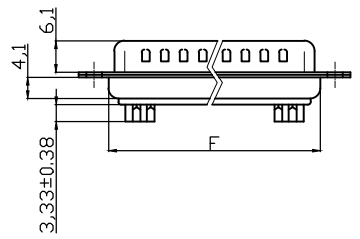
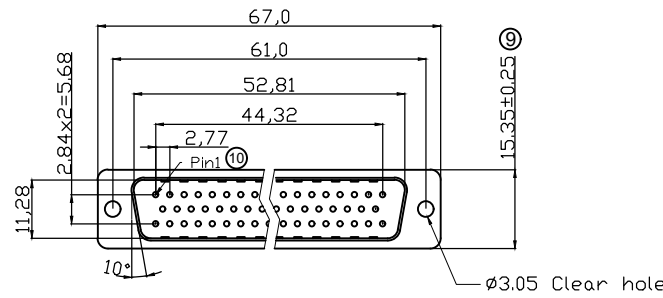
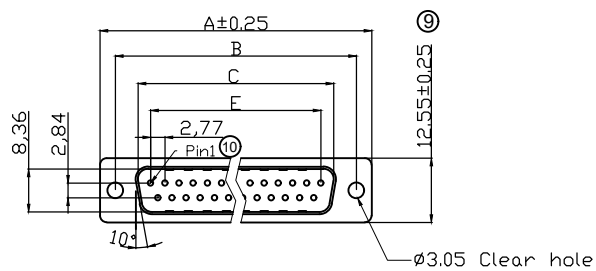

50 Positions

Product Specification

Material

- ⑨ Insulator : Glass-Filled Thermoplastic PBT,UL94V-0
- ⑨ Contact : Copper alloy, plating: see order code
- ⑥ Shell: Steel ,100u"Tin Over 50u" min Copper

Electrical

- Contact Resistance : 20 milliohms Max at 1 AMP DC.
- Insulation Resistance : 1000 magohms at 500 VDC
- Dielectric Withstanding Voltage : 1000 VAC/rms 60Hz for 1 minute
- Current Rating : 3 AMP
- Volatge Rating : 250 VAC/rms 60Hz
- ⑤ Durability :250 mating cycles
- Operating Temperature : -55°C+105°C
- ⑦ Soldering Temperature : 245±5°C in 10s
- ⑧ Recommended wire size: 28~30AWG

D-SUB						
ORDERING CODE						
⑪	Style	Gender	No of contacts	Plating specification	Insulator color	
A-	D	x	xx	LL/	x	- xx
A-	D	F Female	09	LL/	Z Gold selective tin	Blank White
		S Male	15		G Gold flash	BK Black
			25			GY Gray
			37			
			50			

Dimensions					
Positions	A	B	C	E	F
9	30.81	24.99	16.92	11.08	19.20
15	39.20	33.30	25.25	19.39	27.70
25	53.04	47.04	38.96	33.24	41.10
37	69.40	63.50	55.42	49.86	57.30

RoHS compliant
Unit: mm

File No.: E198287

Scale	Free	⑪	Add PN	21.07.2022	Daniel	Date	Name	Customer-No.
TOLERANCE		⑩	Show the pin1 in drawing	22.10.2021	Daniel	Drawn	15.08.2012	Lucas
X.	±0.38	⑨	Add PN and update dimension	09.03.2021	Daniel	Approved	21.07.2022	Daniel
X.X	±0.25	⑧	Add recommended wire size	17.01.2019	Xavier			
X.XX	±0.13	⑦	Add solder temperature	16.07.2018	Xavier			
DIM	TOL	⑥	Add the detail plating of shell	17.01.2018	Tom			
X.°	±3°							
X.X°	±1°							
Angle	TOL	Id.	Modification	Date	Name			

ASSMANN WSW-No.
⑨ **A-Dx xx LL/x-xx**

Drawing-No.
ASS 4884 CO

rev11

Replace

Sheet 1/2

Female

Product Specification

Material

- ⑨ Insulator : Glass-Filled Thermoplastic PBT,UL94V-0
- ⑨ Contact : Copper Alloy , plating: see order code
- ⑥ Shell: Steel 100u"Tin Over 50u" min Copper

Electrical

- Contact Resistance : 20 milliohms Max at 1 AMP DC.
- Insulation Resistance : 1000 magohms at 500 VDC
- Dielectric Withstanding Voltage :1000 VAC/rms 60Hz for 1 minute
- Current Rating : 3 AMP
- Volatge Rating : 250 VAC/rms 60Hz
- ⑤ Durability :250 mating cycles
- Operating Temperature : -55°C+105°C
- ⑦ Soldering Temperature : 245±5°C in 10s
- ⑧ Recommended wire size: 28~30AWG

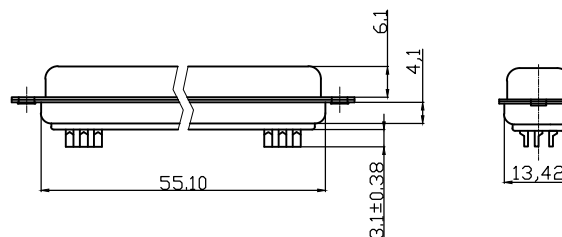
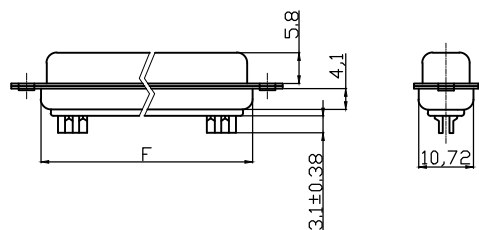
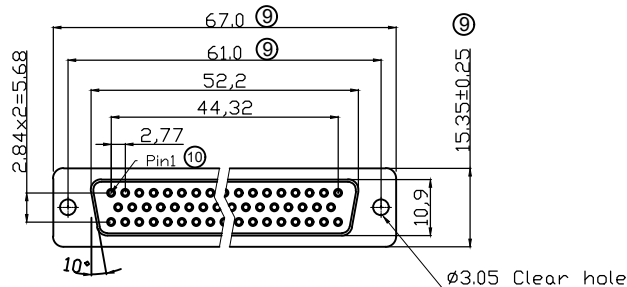
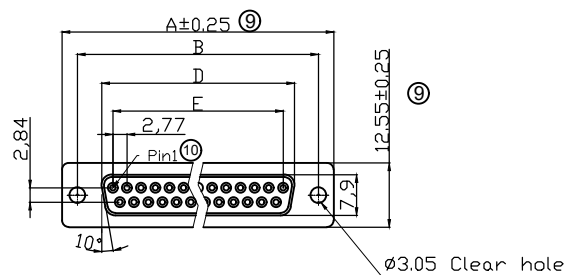

D-SUB						
ORDERING CODE						
⑪	Style	Gender	No of contacts		Plating specification	Insulator color
	A -	D	x	xx	LL/	x - xx
	A -	D	F Female	09	LL/ Z Gold selective tin	Blank White
			S Male	15	G Gold flash	BK Black
				25		GY Gray
				37		
				50		

Dimensions					
Positions	A	B	D	E	F
9	30.81	24.99	16.33	11.08	19.20
15	39.20	33.30	24.70	19.39	27.70
25	53.05	47.04	38.40	33.24	41.10
37	69.40	63.50	54.84	49.86	57.30

RoHS compliant

Unit: mm



File No.: E198287

Scale	Free	⑪	Add PN	21.07.2022	Daniel		Date	Name	Customer-No.	
TOLERANCE		⑩	Show the pin1 in drawing	22.10.2021	Daniel	Drawn	15.08.2012	Lucas	ASSMANN WSW-No. ⑨ A-Dx xx LL/x-xx	
X.	±0.38	⑨	Add PN and update dimension	09.03.2021	Daniel	Approved	21.07.2022	Daniel		
X.X	±0.25	⑧	Add recommended wire size	17.01.2019	Xavier					
X.XX	±0.13	⑦	Add solder temperature	16.07.2018	Xavier	ASSMANN WSW components			Drawing-No.	
DIM	TOL	⑥	Add the detail plating of shell	17.01.2018	Tom				ASS 4884 CO	rev11
X.°	±3°	Id.	Modification	Date	Name				Replace	Sheet 2/2
X.X°	±1°									
Angle	TOL									



ASS 4884 CO
rev11
Sheet 2/2

X-ON Electronics

Largest Supplier of Electrical and Electronic Components

Click to view similar products for [D-Sub Standard Connectors](#) category:

Click to view products by [Assmann](#) manufacturer:

Other Similar products are found below :

[015-0339-000](#) [015-0341-000](#) [015-0349-000](#) [015-0350-000](#) [015-8544-011](#) [015-8755-001](#) [017041-0005](#) [020419-0104](#) [609-25P](#) [609-9P](#)
[M24308/2-23Z](#) [CT0-24-10SC](#) [CT0-36-3PC](#) [CT0E20-8PS](#) [CT0F16S-1PS](#) [CT0TA16-11SXCA232](#) [CT1E20-19SS](#) [CT2-10SL-3SC](#) [CT2-14S-2PCA34](#) [CT2-18-11PCAU](#) [CT2-22-19SC](#) [CT2-36-5PC](#) [CT6-10SL-3SC](#) [CT6-10SL-4SC](#) [CT6-14S-2SC](#) [CT6-16-12SC](#) [CT6-18-10PSA206](#)
[CT6-18-10PSA232](#) [CT6-18-11PXSA206](#) [CT6-18-11PXSA232](#) [CT6-22-10PS](#) [CT6-24-5PC](#) [CT6-9767-18-8-18-4SS](#) [CT6E14S-5SC](#)
[CT6E14SA7SC](#) [CT6E20-14SS](#) [CT6E22-14PC](#) [CT6E22-14PS](#) [CT6E22-19PS](#) [CT6E22-22PS](#) [CT6E24-10SC](#) [CT6F16S-1SC](#) [CT6FA10SL-4PS](#)
[CT6LA20-19PC](#) [CT6M20-19SS](#) [CT6NSB4-20-8SS](#) [CT6TC14S-6SCAU](#) [CT6TC14S-7PS](#) [6STD15SCT99S40X](#) [6STF09PCM05B70X](#)