

1

2

3

4

5

6

7

NOTES:**MATERIAL**

- 1.Pin(outer sleeve): Brass, machined CuZn38Pb2
 - ② 2.Clip(contact 4 finger): Beryllium copper, heat treated
 - 3.Plating(outer sleeve): 2um/80u"nickel, 5um/200u"TiN
 - 4.Plating(contact): 2um/80u"nickel, Gold flash
 - 5.Insulator Material: Glass filled PBT, UL94V-0 Black
- ELECTRICAL**
- 1.Current Rating: 3Amps/contact max.
 - 2.Contact Resistance: 4mΩ/contact max.
 - 3.Insulation Resistance: ≥10000MΩ at 500VAC
 - 4.Operating Voltage: 100 VRMS/150VDC
- MECHANICAL**
- 1.Average Insertion force with steel pin of $\phi 0.43\text{mm}/0.017''$: <250g
 - 2.Average Withdrawal force with steel pin of $\phi 0.43\text{mm}/0.017''$: >50g min.
 - 3.Mechanical life cycle: 200 mln.
 - 4.Operation Temperature: -40°C to +105°C
 - 5.Soldering temperature: +220°C, 10s max.

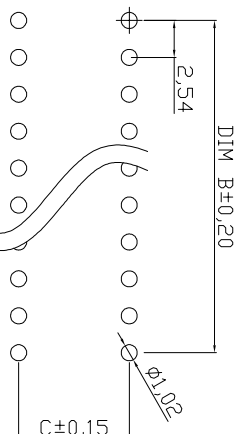
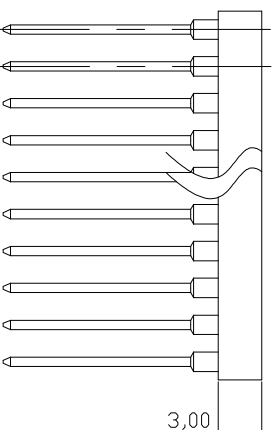
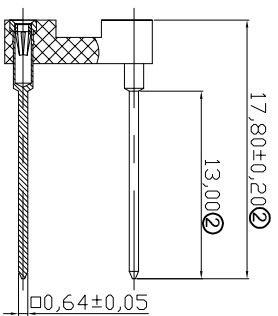
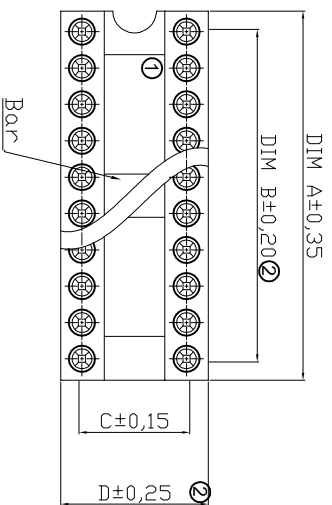
**Packing: Tube**

Contact	DIM A	DIM B	DIM C	DIM D	Note
6	7.62	5.08	7.62	10.16	
8	10.16	7.62	7.62	10.16	
10	12.70	10.16	7.62	10.16	
14	17.78	15.24	7.62	10.16	W/O Bar
16	20.32	17.78	7.62	10.16	
18	22.86	20.32	7.62	10.16	
① 20	25.40	22.86	7.62	10.16	
③ 24	30.48	27.94	15.24	17.78	
③ 28	30.56	33.02	15.24	17.78	W Bar
③ 40	50.80	48.26	15.24	17.78	

RoHS compliant

Unit: mm

Scale	Free TOLERANCE	Free TOL	Id.	Modification	Date	Name
X.	±0.50					
X.X	±0.30					
X.XX	±0.20			Update to new drawing	28.10.2016	Amy
X.XXX	±0.10			Update	30.10.2014	Amy
DIM	±0.10			Drawn	17.02.2014	Amy
Angle	±5°					
Angle	TOL					

Customer-No.

ASSMANN WSW-No.

AR xx-HZW/TTN

Drawing-No.

ASS 6290 CO

rev03

Replace ASS 3579 CO
ASS 3580 CO

Sheet

1

2

3

4

5

6

7

H

G

G

H

H

1

2

3

4

5

6

7

X-ON Electronics

Largest Supplier of Electrical and Electronic Components

Click to view similar products for [assmann manufacturer](#):

Other Similar products are found below :

[AU-Y1007-R](#) [A-DF15-HOOD-WP](#) [A-USB-1](#) [AK-320200-100-S](#) [AK-330109-020-S](#) [AK-330114-050-S](#) [AK-340603-000-S](#) [AK500-RA-6-0.5-R](#) [AK669/2-18-BLACK-R](#) [AT-K-26-10-B/1000](#) [AU-Y1008-2-R](#) [AWG28-50/G/300](#) [AWH26G-0232](#) [AB-900](#) [AB-970](#) [AB-984](#) [A-DS 15PP](#) [AK-320108-030-S](#) [AK-320200-030-S](#) [AK-330107-010-S](#) [AK-330107-020-S](#) [AK-330505-000-S](#) [AK3730X-R](#) [AK579/F-2](#) [A-MCU60010/Y](#) [A-PC2302-030028-1](#) [AT-S-26-8/8/W-7/R](#) [AWH-24G-E202-IDC](#) [DK-2631-05](#) [DN-91624U](#) [DN-91548U](#) [DK-1511-015/WH](#) [A-MCU60030/R](#) [AWH50G-0202-T-R](#) [AK500/16-OE-7-0.5](#) [AK500/14-OE-5-2](#) [DK-1611-020/B](#) [DK-1511-100/G](#) [AK-320100-020-S](#) [AK-320400-002-S](#) [AT-K-26-6-B/500](#) [AK-400102-008-R](#) [AT-K-26-6-W/100](#) [AWP 10-7540-T](#) [AK-330118-100-S](#) [AK-330118-300-S](#) [AK-340102-010-W](#) [AK500/U-1-R](#) [AK-SATA-030DL-R](#) [AWG28-16/G/300](#)