

1

2

3

4

5

6

7

A

A

**NOTES:****MATERIAL**

1. Insulator Material: PBT +30%GF(UL94V-0), Black
2. Contact Material : Phosphor Bronze
3. Contact Plating : Gold flash/ Tin Over Ni ELECTRICAL

1. Current Rating : 1AMP

2. Withstand Voltage : 500V AC/DC

3. Contact Resistance : 20mΩ max

4. Insulation Resistance: 1000MΩ min

**ENVIRONMENTAL**

1. Operation Temperature: -40°C to +105°C

2. Packing: Tray

No. of contacts: 06, 08, 10, 12, 14, 16, 18, 20, 22, 24, 26

30, 34, 36, 40, 44, 50, 60, 64, 68

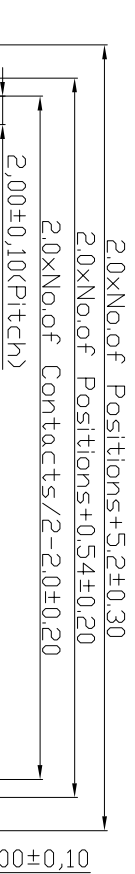

3.50±0.15(6/8P:2.0)

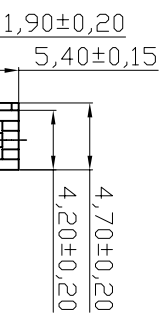
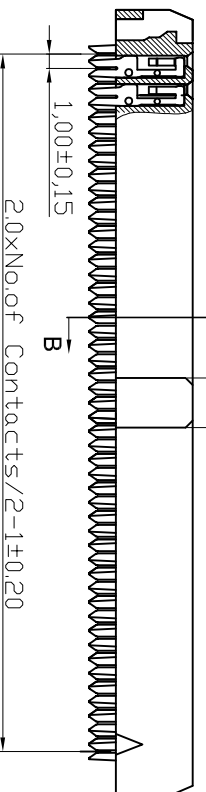
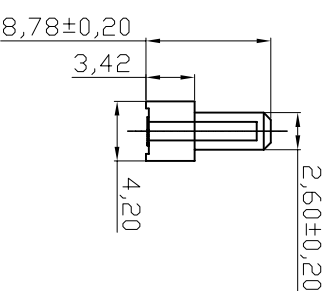
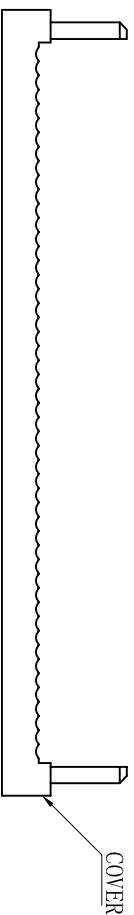
**SECTION B-B****SECTION A-A**

A

A

B

B

C

C

D

D

E

E

F

F

G

G



File No.: E198287

⑥

**RoHS compliant**

Scale 1:1

⑥ Add the UL-File No

13.12.2013 Winnie

Date

Name

Customer-No.

TOLERANCE

⑤ Delete page 2

22.11.2013 Ray

25.01.2006 Alex

ASSMANN WSW-No

X.X

④ Added 68 Pin

24.12.2009 Dean

13.12.2013 Winnie

AWP2 XX-7240 ②

X.XX

③ Correct P/N

28.10.2009 Dean

Drawing-No.

X.XXX

② Update

29.06.2009 Dean

ASS 2309 CO

rev06

Angle

① Drawn

25.01.2006 Alex

Replace

Sheet 1 / 1

±3°

② Update

29.06.2009 Dean

ASSMANN WSW components

Sheet 1 / 1

Id.

① Drawn

25.01.2006 Alex

Replace

Sheet 1 / 1

Id.

Modification

Date

Name

Replace

Sheet 1 / 1

1

2

3

4

5

6

7

SV1751

## X-ON Electronics

Largest Supplier of Electrical and Electronic Components

*Click to view similar products for [assmann](#) manufacturer:*

Other Similar products are found below :

[AU-Y1007-R](#) [A-DF15-HOOD-WP](#) [A-USB-1](#) [AK-320200-100-S](#) [AK-330109-020-S](#) [AK-340603-000-S](#) [AK500-RA-6-0.5-R](#) [AK669/2-18-BLACK-R](#) [AT-K-26-10-B/1000](#) [AU-Y1008-2-R](#) [AWG28-50/G/300](#) [AWH26G-0232](#) [AB-900](#) [AB-970](#) [AB-984](#) [A-DS 15PP](#) [AK-330505-000-S](#) [AK3730X-R](#) [AK579/F-2](#) [A-MCU60010/Y](#) [A-PC2302-030028-1](#) [AT-S-26-8/8/W-7/R](#) [AWH-24G-E202-IDC](#) [DK-2631-05](#) [DN-91624U](#) [DN-91548U](#) [DK-1511-015/WH](#) [A-MCU60030/R](#) [AWH50G-0202-T-R](#) [AK500/16-OE-7-0.5](#) [AK500/14-OE-5-2](#) [DK-1611-020/B](#) [DK-1511-100/G](#) [AK-320400-002-S](#) [AT-K-26-6-B/500](#) [AK-400102-008-R](#) [AT-K-26-6-W/100](#) [AWP 10-7540-T](#) [AK-330118-100-S](#) [AK-330118-300-S](#) [AK-340102-010-W](#) [AK500/U-1-R](#) [AK-SATA-030DL-R](#) [AWG28-16/G/300](#) [AWG28-9/F/300](#) [ADIP16-G-LC-R](#) [AK-310203-018-E](#) [AK-330105-300-S](#) [AK-340406-001-W](#) [A-MCSP60020/B-R](#)