

REV.	A	2014/07/07	ECN NO.	/	MODIFICATION	NEW	Vicky
APPROVER							

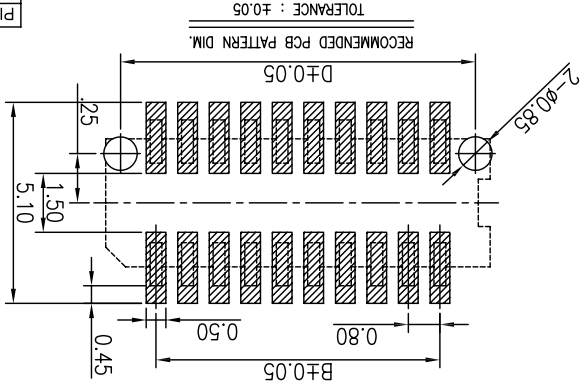
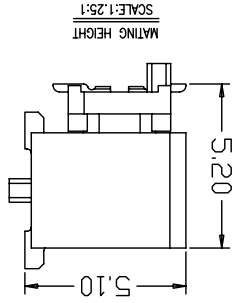
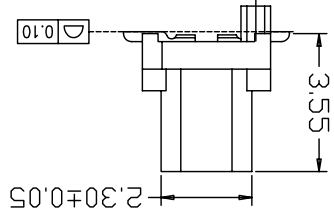
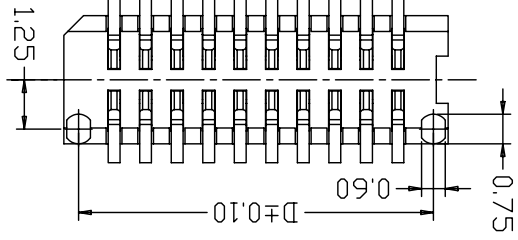
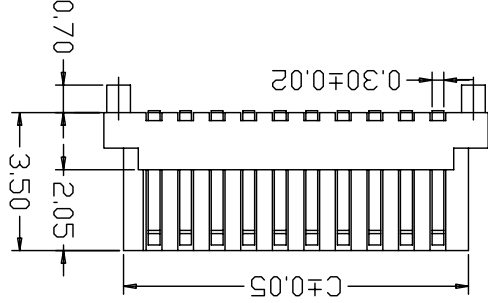
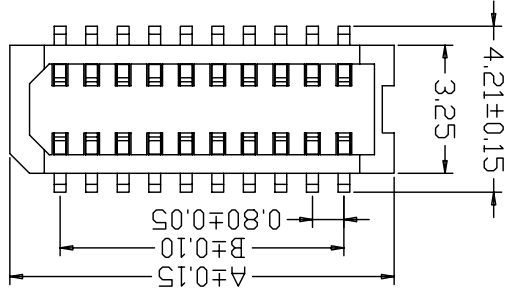

**SPECIFICATIONS:**

Voltage Rating: 60V DC  
 Current Rating: 0.5A Max.(Each Pin)  
 Contact Resistance: 60mΩ MAX  
 Insulation Resistance: 800MΩ MIN  
 Dielectric Withstanding : AC 500V  
 Operating Temperature : -25°C~+85°C  
 Contact Material: Copper Alloy  
 Insulator Material: Thermoplastic,UL94V-0  
 Plating: Gold Plated.

PIN NO.	A.	B.	C.	D.
4	3.35	0.80	2.35	2.60
6	4.15	1.60	3.15	3.40
8	4.95	2.40	3.95	4.20
10	5.75	3.20	4.75	5.00
12	6.55	4.00	5.55	5.80
14	7.35	4.80	6.35	6.60
16	8.15	5.60	7.15	7.40
18	8.95	6.40	7.95	8.20
20	9.75	7.20	8.75	9.00
22	10.55	8.00	9.55	9.80
24	11.35	8.80	10.35	10.60
26	12.15	9.60	11.15	11.40
28	12.95	10.40	11.95	12.20
30	13.75	11.20	12.75	13.00
32	14.55	12.00	13.55	13.80
34	15.35	12.80	14.35	14.60
36	16.15	13.60	15.15	15.40
38	16.95	14.40	15.95	16.20
40	17.75	15.20	16.75	17.00
42	18.55	16.00	17.55	17.80
44	19.35	16.80	18.35	18.60
46	20.15	17.60	19.15	19.40
48	20.95	18.40	19.95	20.20
50	21.75	19.20	20.75	21.00
52	22.55	20.00	21.55	21.80

NAME: BTB		PART NO: BTB080***-M2S11***		TITLE: BTB0.8mm 2*XP 单槽 公座 侧插 带定位柱 合高H=5.2mm		DWG NO. ATOM-A03550		DR: Jillian	
UNITS mm		MATERIAL		FINISH		QTY		CHECKED: Vicky	
GENERAL TOLERANCE		SELECT ✓		TOL		ON.		APPD: Jason	
				±0.05 ±0.15		±0.15 ±0.25		CHKD: Vicky	
		1 2 3		±0.25 ±0.50		±0.38 ±1.00		DR: Jillian	
ANGLE ±Z								SCALE 1:1	
								SHEET 1/1	
								REV	

SHENZHEN ATOM TECHNOLOGY CO., LTD.		ATOM		深圳市爱特姆科技有限公司	
------------------------------------	--	------	--	--------------	--

## X-ON Electronics

Largest Supplier of Electrical and Electronic Components

*Click to view similar products for [Board to Board & Mezzanine Connectors](#) category:*

*Click to view products by [ATOM](#) manufacturer:*

Other Similar products are found below :

[10135583-642402LF](#) [89885-310LF](#) [589158040000018](#) [6-1393048-0](#) [68683-613](#) [MDF7-12DP-2.54DSA](#) [MDF7-18P-2.54DSA\(01\)](#) [MDF7-20DP-2.54DSA](#) [MDF7-26D-2.54DSA\(55\)](#) [MDF7-3P-2.54DSA\(01\)](#) [MDF7B-20P-2.54DSA\(01\)](#) [MDF7B-3P-2.54DSA\(55\)](#) [MDF7C-11P-2.54DSA\(55\)](#) [MDF7C-18P-2.54DSA\(55\)](#) [MDF7C-5P-2.54DSA\(01\)](#) [MDF7P-5P-2.54DSA\(55\)](#) [75234-0516](#) [FCN-230C068-11](#) [FCN-268F012-G/BD](#) [FCN-268F036-G/BD](#) [FCN-268M012-G/0D](#) [FCN-268M024-G/1D](#) [FCN-360C008-C](#) [FCN-360C040-C](#) [FCN-723J004/1](#) [MIS-048-01-F-D-DP-K](#) [832-10-034-10-001000](#) [93696-325LF](#) [11828-1FA](#) [AXK630345P](#) [18097-0013](#) [ICA-328STT](#) [2007042-2](#) [304400-2](#) [FCN-214Q030-G/0](#) [FCN-215Q040-G/0](#) [FCN-230C068-ESA](#) [FCN-234P048-G/0](#) [FCN-235D050-G/C](#) [FCN-360A3](#) [FCN-360C040-B](#) [210-93-314-41-105000](#) [2-22603-0](#) [379-064-521-202](#) [MDF7-12P-2.54DSA\(01\)](#) [MDF7-16P-2.54DS\(56\)](#) [MDF7-40DP-2.54DSA\(55\)](#) [MDF7-8P-2.54DSA\(55\)](#) [MDF7B-16P-2.54DSA\(55\)](#) [AXG720047](#)