

ACAD GENERATED DRAWING. DON'T CHANGE BY HAND

5	6	7	8
REV	DATE	ECN NO.	MODIFICATION
A	2014/03/12	/	NEW
			APPROVER
			Jason

PITCH 0.5mm FPC CONNECTOR SMT TYPE

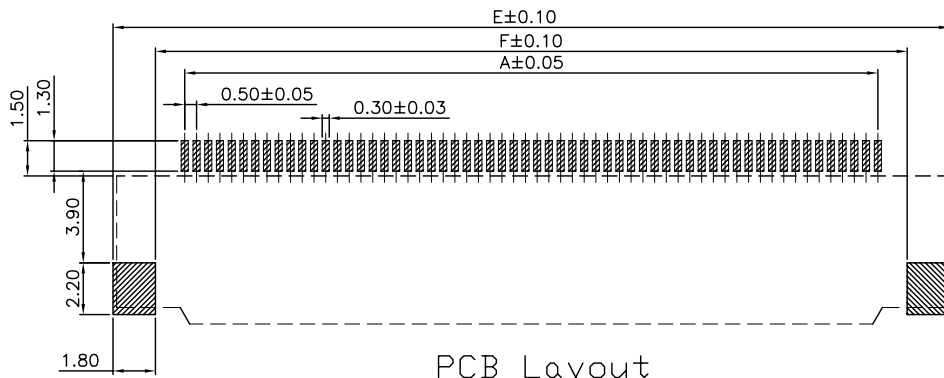
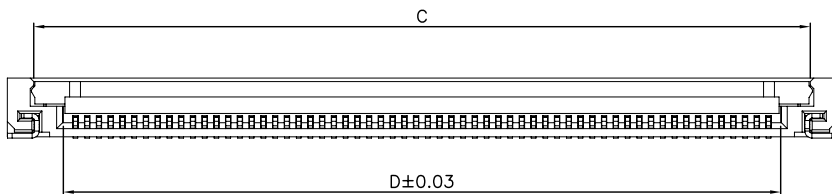
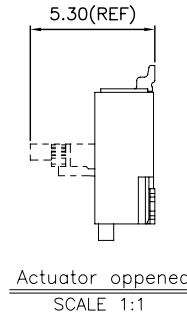
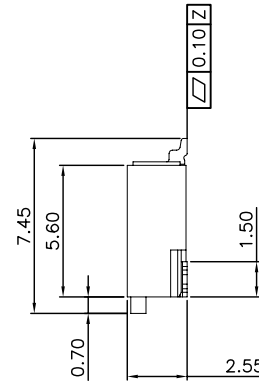
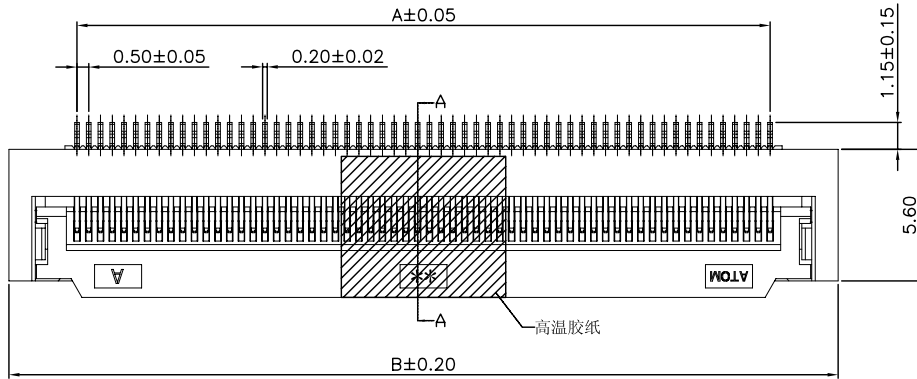
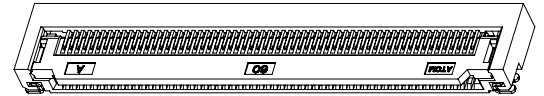
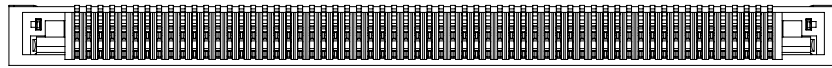

PCB Layout

SPECIFICATION

1. Material:
- Housing: Thermoplastic, UL94V-0, color: Natural .
 - Lock: Thermoplastic, UL94V-0, color: black.
 - Contacts: Copper alloy,
 - Tin/Gold plated over nickel plated (50 u" min)
 - Solder tab: Copper alloy,
 - Tin/Gold plated over nickel plated (50 u" min)

2. Electrical Characteristics:
- Voltage rating: 50V(max).
 - Current rating : 0.5A(max).
 - Operating Temperature: -40°C~+85°C.
 - Insulation resistance: 500MΩ min. at 500VDC
 - Dielectric withstanding voltage: 500 VAC/1minute.
 - Contact resistance: 30mΩ max.

GENERAL TOLERANCE	UNITS mm	NAME:	FPC	深圳市爱特姆科技有限公司 SHENZHEN ATOM TECHNOLOGY CO., LTD.			
SELECT ✓	MAT'L	PART NO:	FPC050**-43***	TITLE: 0.5mm FPC 掀盖式 (H=2.55mm) 贴高温胶纸			
DN. TOL	FINISH	APPD:	Jason	DWG NO. ATOM-A01977			
X.XXX ±0.10 ±0.05 ±0.15	Q'TY	CHKD:	Vicky		SCALE	SHEET	REV
X.XX ±0.15 ±0.13 ±0.25		DR:	xh		1:1	1/2	A
X.X ±0.20 ±0.25 ±0.5							
X. ±0.30 ±0.38 ±1.00							
ANGLE ±2°							

X-ON Electronics

Largest Supplier of Electrical and Electronic Components

Click to view similar products for [FFC & FPC Connectors](#) category:

Click to view products by [ATOM](#) manufacturer:

Other Similar products are found below :

[00-6200-227-022-800](#) [006205250500825+](#) [006205280500825+](#) [FPH-1602G](#) [086222026001800](#) [52610-0675](#) [62674-201121DLF](#) [52746-1671-TR250](#) [10051922-1610EHLF](#) [10051922-2810EHLF](#) [686322124422](#) [XF3M-2915-1B-R100](#) [AYF353125A](#) [AYF530665TA](#) [AYF534065TA](#) [20FLH-RSM1-TB](#) [207356-1](#) [SFW12R-5STE9LF](#) [SFW18R-1STAE9LF](#) [SFW4R-5STE9LF](#) [52807-0430](#) [046283021002868+](#) [FFC05011-10SBB114W5M](#) [502250-8027](#) [67000-008LF](#) [200528-0260](#) [FH28K-10S-0.5SH](#) [FH52K-6S-0.5SH](#) [0.5K-DX-30PWB](#) [DS1020-08-10VBT12](#) [THD0515-34CL-GF](#) [X05A10L28G](#) [ECC2841061EU](#) [1.0K-DHQX-16PWB](#) [1.0K-DHQX-30PWB](#) [1775333-6](#) [10054365-202110ELF](#) [10054365-242110ELF](#) [10054365-282110ELF](#) [10064555-392220HLF](#) [59453-041110EBHLF](#) [59453-091110EDHLF](#) [62674-241141ALF](#) [62684-432100ALF](#) [62684-451100AHLF](#) [62684-5721N0ALF](#) [HFW11R-1STE1MTLF](#) [HFW12R-1STE9LF](#) [HFW14R-1STE9MTLF](#) [HFW18S-2STE9LF](#)