

ACAD GENERATED DRAWING. DON'T CHANGE BY HAND

5	6	7	8
REV	DATE	ECN NO.	MODIFICATION
A	2014/03/12	/	NEW
			APPROVER
			Jason

PITCH 0.5mm FPC CONNECTOR SMT TYPE

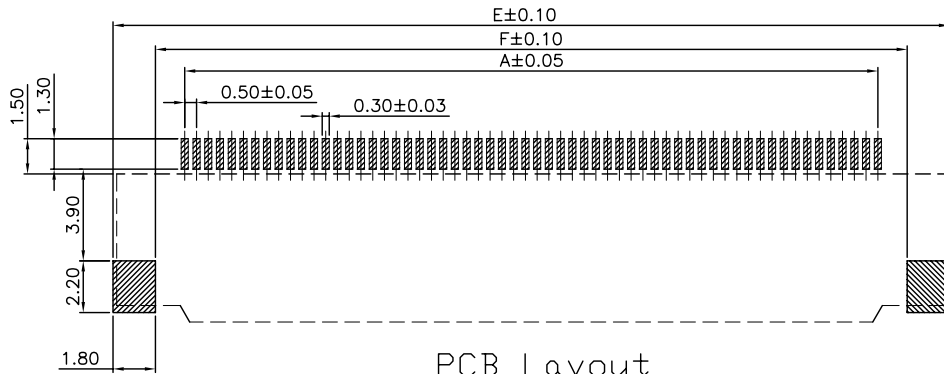
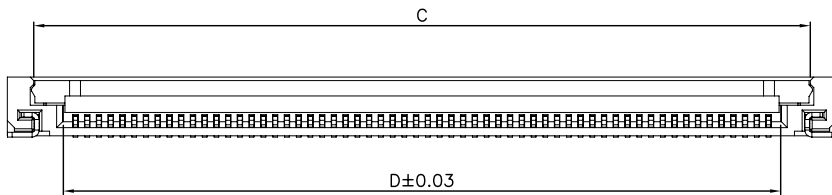
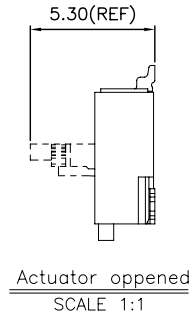
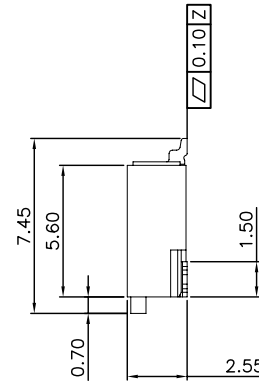
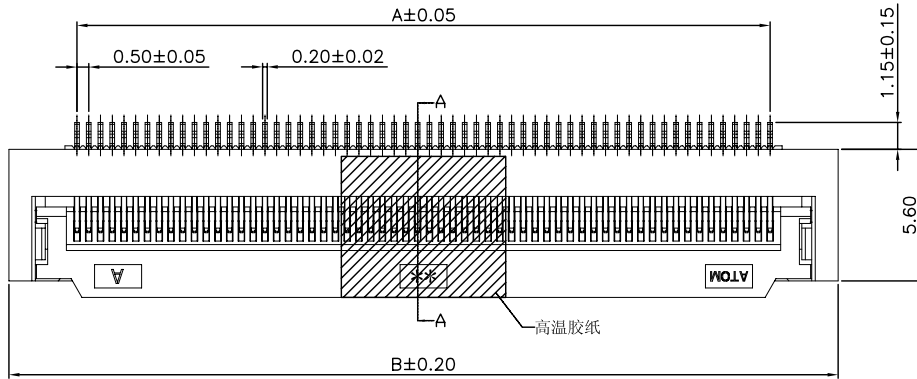
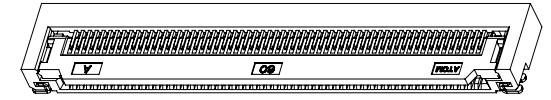
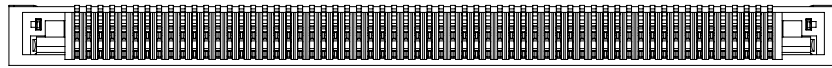

SPECIFICATION

1. Material:
- Housing: Thermoplastic, UL94V-0, color: Natural .
 - Lock: Thermoplastic, UL94V-0, color: black.
 - Contacts: Copper alloy,
 - Tin/Gold plated over nickel plated (50 u" min)
 - Solder tab: Copper alloy,
 - Tin/Gold plated over nickel plated (50 u" min)

2. Electrical Characteristics:
- Voltage rating: 50V(max).
 - Current rating : 0.5A(max).
 - Operating Temperature: -40°C~+85°C.
 - Insulation resistance: 500MΩ min. at 500VDC
 - Dielectric withstanding voltage: 500 VAC/1minute.
 - Contact resistance: 30mΩ max.

GENERAL TOLERANCE	UNITS mm	NAME:	FPC	深圳市爱特姆科技有限公司 SHENZHEN ATOM TECHNOLOGY CO., LTD.			
SELECT	✓	MAT'L	PART NO:	TITLE: 0.5mm FPC 掀盖式 (H=2.55mm) 贴高温胶纸			
DN.	TOL		FPC050**-43***	APPD:	Jason	DWG NO.	ATOM-A01977
X.XXX	±0.10	±0.05	±0.15	CHKD:	Vicky		
X.XX	±0.15	±0.13	±0.25	DR:	xh	SCALE	1:1
X.X	±0.20	±0.25	±0.5			SHEET	1/2
X.	±0.30	±0.38	±1.00			REV	A
ANGLE	±2°						

ACAD GENERATED DRAWING. DON'T CHANGE BY HAND

PIN NO.	A	B	C	D	E	F	G	H	PIN NO.	A	B	C	D	E	F	G	H
4P	1.50	7.30	5.05	2.60	7.60	4.00	4.10	2.50	33P	16.00	21.80	19.55	17.10	22.10	18.50	18.60	17.00
5P	2.00	7.80	5.55	3.10	8.10	4.50	4.60	3.00	34P	16.50	22.30	20.05	17.60	22.60	19.00	19.10	17.50
6P	2.50	8.30	6.05	3.60	8.60	5.00	5.10	3.50	35P	17.00	22.80	20.55	18.10	23.10	19.50	19.60	18.00
7P	3.00	8.80	6.55	4.10	9.10	5.50	5.60	4.00	36P	17.50	23.30	21.05	18.60	23.60	20.00	20.10	18.50
8P	3.50	9.30	7.05	4.60	9.60	6.00	6.10	4.50	37P	18.00	23.80	21.55	19.10	24.10	20.50	20.60	19.00
9P	4.00	9.80	7.55	5.10	10.10	6.50	6.60	5.00	38P	18.50	24.30	22.05	19.60	24.60	21.00	21.10	19.50
10P	4.50	10.30	8.05	5.60	10.60	7.00	7.10	5.50	39P	19.00	24.80	22.55	20.10	25.10	21.50	21.60	20.00
11P	5.00	10.80	8.55	6.10	11.10	7.50	7.60	6.00	40P	19.50	25.30	23.05	20.60	25.60	22.00	22.10	20.50
12P	5.50	11.30	9.05	6.60	11.60	8.00	8.10	6.50	41P	20.00	25.80	23.55	21.10	26.10	22.50	22.60	21.00
13P	6.00	11.80	9.55	7.10	12.10	8.50	8.60	7.00	42P	20.50	26.30	24.05	21.60	26.60	23.00	23.10	21.50
14P	6.50	12.30	10.05	7.60	12.60	9.00	9.10	7.50	43P	21.00	26.80	24.55	22.10	27.10	23.50	23.60	22.00
15P	7.00	12.80	10.55	8.10	13.10	9.50	9.60	8.00	44P	21.50	27.30	25.05	22.60	27.60	24.00	24.10	22.50
16P	7.50	13.30	11.05	8.60	13.60	10.00	10.10	8.50	45P	22.00	27.80	25.55	23.10	28.10	24.50	24.60	23.00
17P	8.00	13.80	11.55	9.10	14.10	10.50	10.60	9.00	46P	22.50	28.30	26.05	23.60	28.60	25.00	25.10	23.50
18P	8.50	14.30	12.05	9.60	14.60	11.00	11.10	9.50	47P	23.00	28.80	26.55	24.10	29.10	25.50	25.60	24.00
19P	9.00	14.80	12.55	10.10	15.10	11.50	11.60	10.00	48P	23.50	29.30	27.05	24.60	29.60	26.00	26.10	24.50
20P	9.50	15.30	13.05	10.60	15.60	12.00	12.10	10.50	49P	24.00	29.80	27.55	25.10	30.10	26.50	26.60	25.00
21P	10.00	15.80	13.55	11.10	16.10	12.50	12.60	11.00	50P	24.50	30.30	28.05	25.60	30.60	27.00	27.10	25.50
22P	10.50	16.30	14.05	11.60	16.60	13.00	13.10	11.50	51P	25.00	30.80	28.55	26.10	31.10	27.50	27.60	26.00
23P	11.00	16.80	14.55	12.10	17.10	13.50	13.60	12.00	52P	25.50	31.30	29.05	26.60	31.60	28.00	28.10	26.50
24P	11.50	17.30	15.05	12.60	17.60	14.00	14.10	12.50	53P	26.00	31.80	29.55	27.10	32.10	28.50	28.60	27.00
25P	12.00	17.80	15.55	13.10	18.10	14.50	14.60	13.00	54P	26.50	32.30	30.05	27.60	32.60	29.00	29.10	27.50
26P	12.50	18.30	16.05	13.60	18.60	15.00	15.10	13.50	55P	27.00	32.80	30.55	28.10	33.10	29.50	29.60	28.00
27P	13.00	18.80	16.55	14.10	19.10	15.50	15.60	14.00	56P	27.50	33.30	31.05	28.60	33.60	30.00	30.10	28.50
28P	13.50	19.30	17.05	14.60	19.60	16.00	16.10	14.50	57P	28.00	33.80	31.55	29.10	34.10	30.50	30.60	29.00
29P	14.00	19.80	17.55	15.10	20.10	16.50	16.60	15.00	58P	28.50	34.30	32.05	29.60	34.60	31.00	31.10	29.50
30P	14.50	20.30	18.05	15.60	20.60	17.00	17.10	15.50	59P	29.00	34.80	32.55	30.10	35.10	31.50	31.60	30.00
31P	15.00	20.80	18.55	16.10	21.10	17.50	17.60	16.00	60P	29.50	35.30	33.05	30.60	35.60	32.00	32.10	30.50
32P	15.50	21.30	19.05	16.60	21.60	18.00	18.10	16.50									

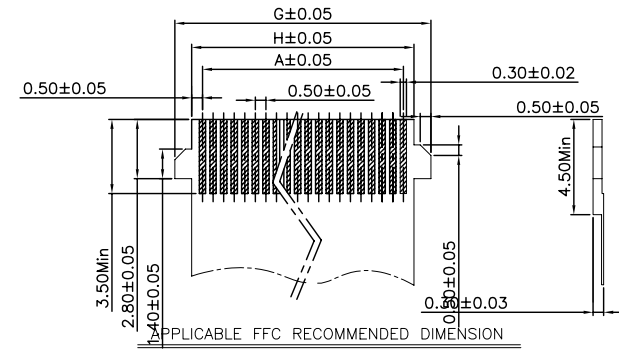
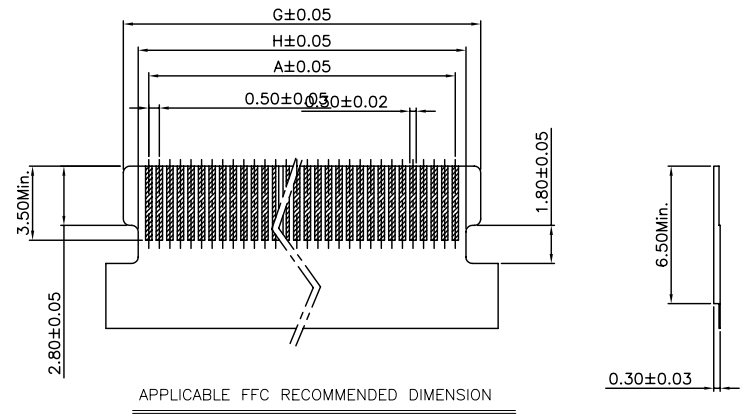

<table border="1"> <tr><th colspan="4">GENERAL TOLERANCE</th></tr> <tr><th>SELECT</th><th colspan="3">✓</th></tr> <tr><th>TOL.</th><th>1</th><th>2</th><th>3</th></tr> <tr><th>DN.</th><td>X.XXX</td><td>±0.10</td><td>±0.05</td><td>±0.15</td></tr> <tr><td>X.XX</td><td>±0.15</td><td>±0.13</td><td>±0.25</td></tr> <tr><td>X.X</td><td>±0.20</td><td>±0.25</td><td>±0.5</td></tr> <tr><td>X.</td><td>±0.30</td><td>±0.38</td><td>±1.00</td></tr> <tr><th>ANGLE</th><td>±2°</td><td></td><td></td></tr> </table>	GENERAL TOLERANCE				SELECT	✓			TOL.	1	2	3	DN.	X.XXX	±0.10	±0.05	±0.15	X.XX	±0.15	±0.13	±0.25	X.X	±0.20	±0.25	±0.5	X.	±0.30	±0.38	±1.00	ANGLE	±2°			<table border="1"> <tr><th>UNITS</th><td>mm</td></tr> <tr><th>MAT'L</th><td></td></tr> <tr><th>FINISH</th><td></td></tr> <tr><th>Q'TY</th><td></td></tr> </table>	UNITS	mm	MAT'L		FINISH		Q'TY		<table border="1"> <tr><td>NAME:</td><td>FPC</td></tr> <tr><td>PART NO:</td><td>FPC050**-43***</td></tr> <tr><td>APPD:</td><td>Jason</td></tr> <tr><td>CHKD:</td><td>Vicky</td></tr> <tr><td>DR:</td><td>xh</td></tr> </table>	NAME:	FPC	PART NO:	FPC050**-43***	APPD:	Jason	CHKD:	Vicky	DR:	xh	<table border="1"> <tr><td colspan="3"> ATOM® 深圳市爱特姆科技有限公司 SHENZHEN ATOM TECHNOLOGY CO., LTD. </td></tr> <tr><td colspan="3">TITLE: 0.5mm FPC 掀盖式 (H=2.55mm)贴高温胶纸</td></tr> <tr><td colspan="3">DWG NO. ATOM-A01977</td></tr> <tr> <td> </td> <td>SCALE</td> <td>SHEET</td> <td>REV</td> </tr> <tr> <td></td> <td>1:1</td> <td>2/2</td> <td>A</td> </tr> </table>	ATOM ® 深圳市爱特姆科技有限公司 SHENZHEN ATOM TECHNOLOGY CO., LTD.			TITLE: 0.5mm FPC 掀盖式 (H=2.55mm)贴高温胶纸			DWG NO. ATOM-A01977				SCALE	SHEET	REV		1:1	2/2	A
	GENERAL TOLERANCE																																																																						
	SELECT	✓																																																																					
	TOL.	1	2	3																																																																			
	DN.	X.XXX	±0.10	±0.05	±0.15																																																																		
X.XX	±0.15	±0.13	±0.25																																																																				
X.X	±0.20	±0.25	±0.5																																																																				
X.	±0.30	±0.38	±1.00																																																																				
ANGLE	±2°																																																																						
UNITS	mm																																																																						
MAT'L																																																																							
FINISH																																																																							
Q'TY																																																																							
NAME:	FPC																																																																						
PART NO:	FPC050**-43***																																																																						
APPD:	Jason																																																																						
CHKD:	Vicky																																																																						
DR:	xh																																																																						
ATOM ® 深圳市爱特姆科技有限公司 SHENZHEN ATOM TECHNOLOGY CO., LTD.																																																																							
TITLE: 0.5mm FPC 掀盖式 (H=2.55mm)贴高温胶纸																																																																							
DWG NO. ATOM-A01977																																																																							
	SCALE	SHEET	REV																																																																				
	1:1	2/2	A																																																																				

X-ON Electronics

Largest Supplier of Electrical and Electronic Components

Click to view similar products for [FFC & FPC Connectors](#) category:

Click to view products by [ATOM](#) manufacturer:

Other Similar products are found below :

[00-6200-227-022-800](#) [006205250500825+](#) [006205280500825+](#) [FPH-1602G](#) [086222026001800](#) [52610-0675](#) [62674-201121DLF](#) [52746-1671-TR250](#) [10051922-1610EHLF](#) [10051922-2810EHLF](#) [686322124422](#) [XF3M-2915-1B-R100](#) [AYF353125A](#) [AYF530665TA](#) [AYF534065TA](#) [20FLH-RSM1-TB](#) [PCA-7F-25-HL-3-G](#) [207356-1](#) [52807-0430](#) [FFC05011-10SBB114W5M](#) [502250-8027](#) [FH28K-40S-0.5SH](#) [200528-0260](#) [FH28K-10S-0.5SH](#) [501951-1250](#) [X05B20U43T](#) [0.5K-DX-30PWB](#) [DS1020-08-10VBT12](#) [THD0515-34CL-GF](#) [X05A10L28G](#) [ECC2841061EU](#) [20539-030E-01](#) [1.0K-DHQX-16PWB](#) [1.0K-DHQX-30PWB](#) [1775333-6](#) [10054365-202110ELF](#) [10054365-242110ELF](#) [10054365-282110ELF](#) [10064555-392220HLF](#) [59453-041110EBHLF](#) [59453-091110EDHLF](#) [62674-241141ALF](#) [62684-432100ALF](#) [62684-451100AHLF](#) [62684-5721N0ALF](#) [HFW11R-1STE1MTLF](#) [HFW12R-1STE9LF](#) [HFW14R-1STE9MTLF](#) [HFW18S-2STE9LF](#) [HFW20R-1STAE1HLF](#)