

| | | | | |
|--|-------------------|------------|------------|-----|
| UNLESS OTHERWISE SPECIFIED TOLERANCE | mm | X | ±0.50 | ±5° |
| | DECIMAL | LINEAR | ANGLES | |
| DRAWN | Fros | 2018/10/23 | | |
| | Ken | 2018/10/23 | | |
| CHECKED | | Tjm | 2018/10/23 | |
| APPROVED | | Ken | 2018/10/23 | |
| SCALE | 2.5/1 | SHEET | 1/2 | A4 |
| FILE NAME | 115S-BS00_B_1 | | | |
| PRODUCT NO. | 115S-BS00 | | | |
| DRAWN NAME | www.attend.com.tw | | | |
| Nano SIM Socket, Dual Card Tray Eject Type, 30u" | | | | |

| NO. | PART NAME | DESCRIPTION |
|-----|-----------|---|
| 1 | HOUSING | LCP, UL94V-0, black |
| 2 | CONTACT | Copper alloy 0.12t, contact area: 30u" Gold plating solder area: Gold flash, under plating 50u" Nickel |
| 3 | SHELL | under plating 12u" Nickel Stainless Steel 0.15t, solder area: Gold flash, |
| 4 | BAR | Stainless Steel 0.25t |
| 5 | CAM | Stainless Steel 0.4t |

DATE CODE: YWWD
 Y=year 0~9
 WW=Week 1~52
 D=1~7

1. ELECTRICAL
 1.1 Current Rating: 0.5A max.
 1.2 Voltage Rating: 10VAC/DC
 1.3 Contact Resistance: 50mΩ
 1.4 Insulation Resistance: 1000MΩ
 1.5 Dielectric Withstanding Voltage: 500VAC

2. MECHANICAL
 2.1 Durability: 2,000 Cycles
 2.2 Tray Insertion Force: 10N max.
 2.3 Tray Extraction Force: 3N min.
 2.4 Contact Normal Force: 20gf min. per pin

3. ENVIRONMENTAL
 3.1 Operating temperature range: -40°C~+105°C
 3.2 Storage temperature range: -40°C~+105°C

4. SOLDER ABILITY
 4.1 Recommended IR-Reflow Temperature: 260°C

| REV. | DESCRIPTION | DRAWN | DATE |
|------|-----------------|-------|------------|
| 1 | INITIAL RELEASE | FROS | 2019/04/15 |

RECOMMENDED LAYOUT (TOP VIEW)
 GENERAL TOLERANCE: $\pm 0.05\text{mm}$

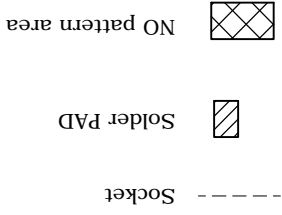
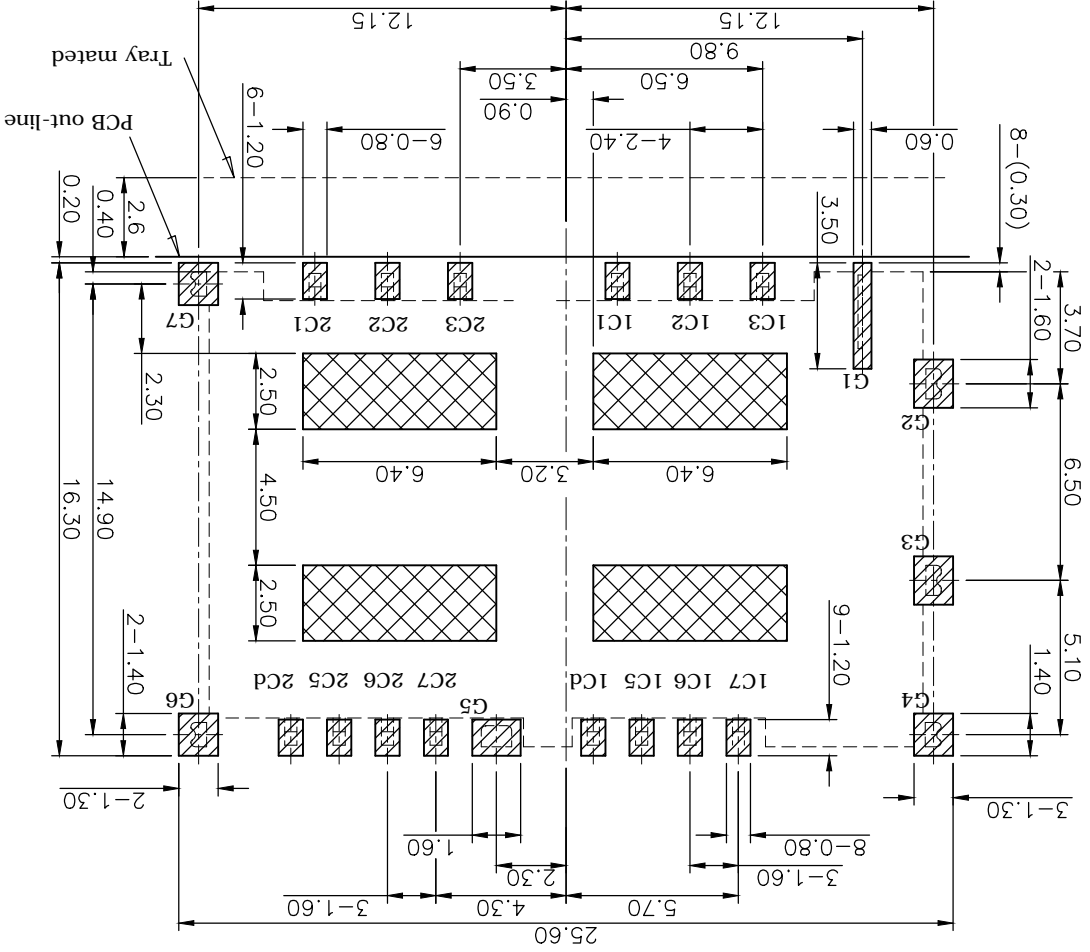

Pin assignment

| Pin no. | Description |
|---------|-------------|
| IC1 2C1 | Vcc |
| IC2 2C2 | RST |
| IC3 2C3 | CLK |
| ICd 2Cd | Detect |
| IC5 2C5 | GND |
| IC6 2C6 | Vpp |
| IC7 2C7 | I/O |

| | | | | |
|--|----|--------------|------------|---------------|
| UNLESS OTHERWISE SPECIFIED TOLERANCE | | DECIMAL | LINEAR | ANGLES |
| UNIT: | mm | X | ± 0.50 | $\pm 5^\circ$ |
| | | X.X | ± 0.25 | $\pm 3^\circ$ |
| | | X.XX | ± 0.12 | $\pm 1^\circ$ |
| DRAWN NAME: Fros 2018/10/23 | | | | |
| CHECKED: Tim 2018/10/23 | | | | |
| APPROVED: Ken 2018/10/23 | | | | |
| DRAWN NAME: NANO SIM SOCKET, DUAL CARD TRAY EJECT TYPE, 30U" | | PRODUCT NO.: | 115S-BS00 | |
| FILE NAME: 115S-BS00_B_1 | | SIZE: | A4 | |
| SCALE: | | SHEET: | 2/2 | |
| 4/1 | | | | |

| | | | |
|------|---------------|-------|------|
| REV. | DESCRIPTION | DRAWN | DATE |
| | see sheet one | | |

10 9 8 7 6 5 4 3 2 1

A B C D E F G

Carton L*W*H=350*350*320

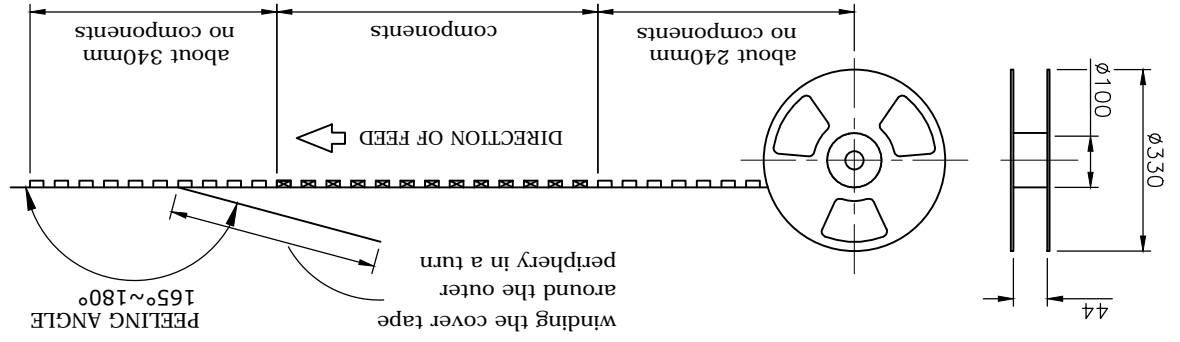
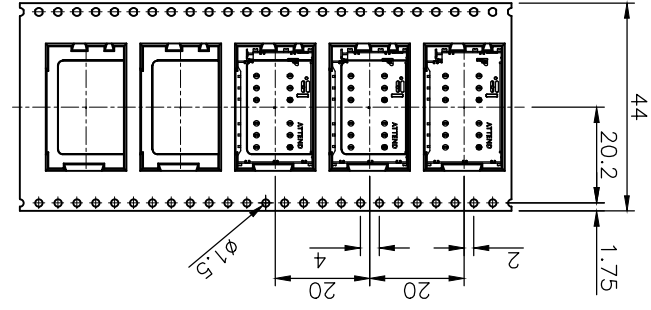
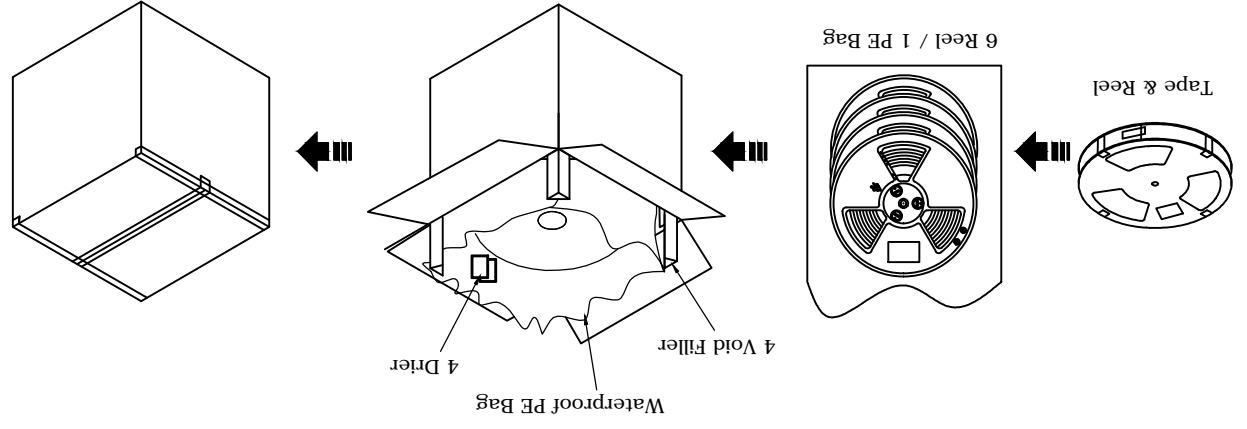

- PACKAGING SPECIFICATION:**
1. MATERIAL
 - 1.1 Embossed Carrier Tape: PS Black
 - 1.2 Top Cover Tape: PET
 - 1.3 Taping Reel: Plastic
 2. PACKING
 - 2.1 Quantity: 7,200 PCS/Carton
 - 2.2 REEL/Carton: 6 REEL/Carton
 - 2.3 PCS/REEL: 1,200 PCS/REEL

| | | | | |
|--------------------------------------|---------------|--|------------|--------|
| UNLESS OTHERWISE SPECIFIED TOLERANCE | | DECIMAL | LINEAR | ANGLES |
| UNIT: | mm | X | ±0.50 | ±5° |
| | | X.X | ±0.25 | ±3° |
| | | X.XX | ±0.12 | ±1° |
| DRAWN NAME: | | www.attend.com.tw | | |
| DRAWN | | Fros | 2018/10/23 | |
| CHECKED | | Tjm | 2018/10/23 | |
| APPROVED | | Ken | 2018/10/23 | |
| SCALE | N/A | SHEET | 1/1 | SIZE |
| FILE NAME | 115S-BS00_D_1 | | | |
| PRODUCT NO. | 115S-BS00 | | | |
| DRAWN NAME: | | Nano SIM Socket, Dual Card Tray Eject Type, 30u" | | |



| | | | |
|------|---------------|-------|------|
| REV. | DESCRIPTION | DRAWN | DATE |
| | see sheet one | | |

10 9 8 7 6 5 4 3 2 1

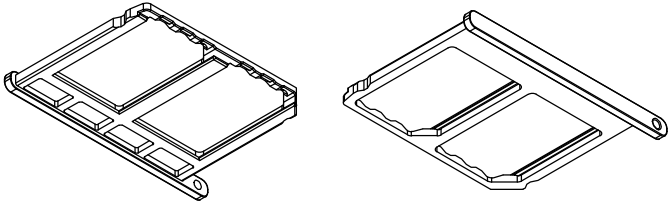
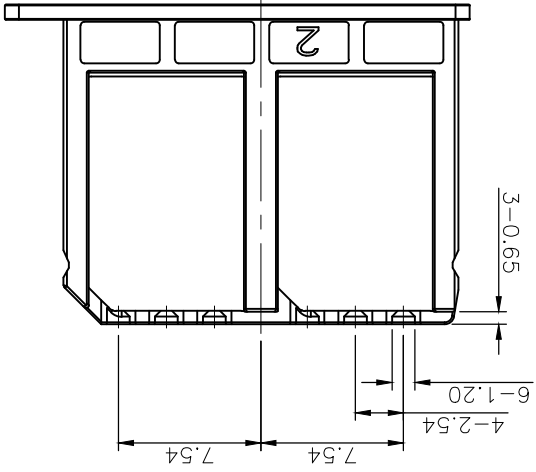
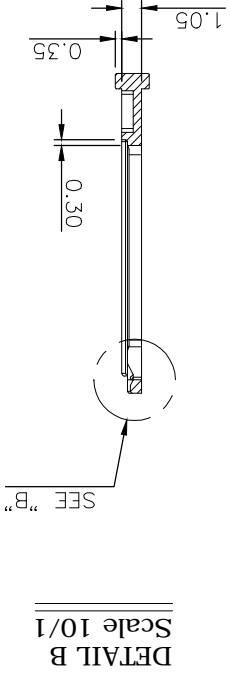
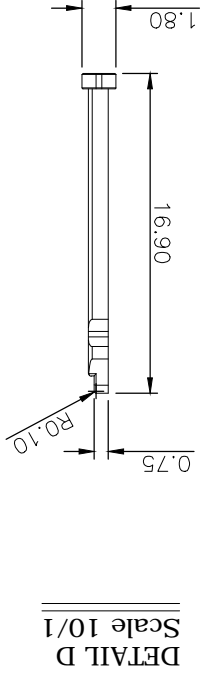
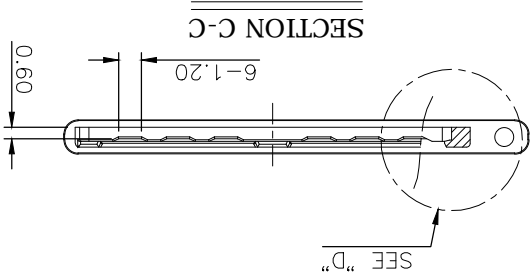
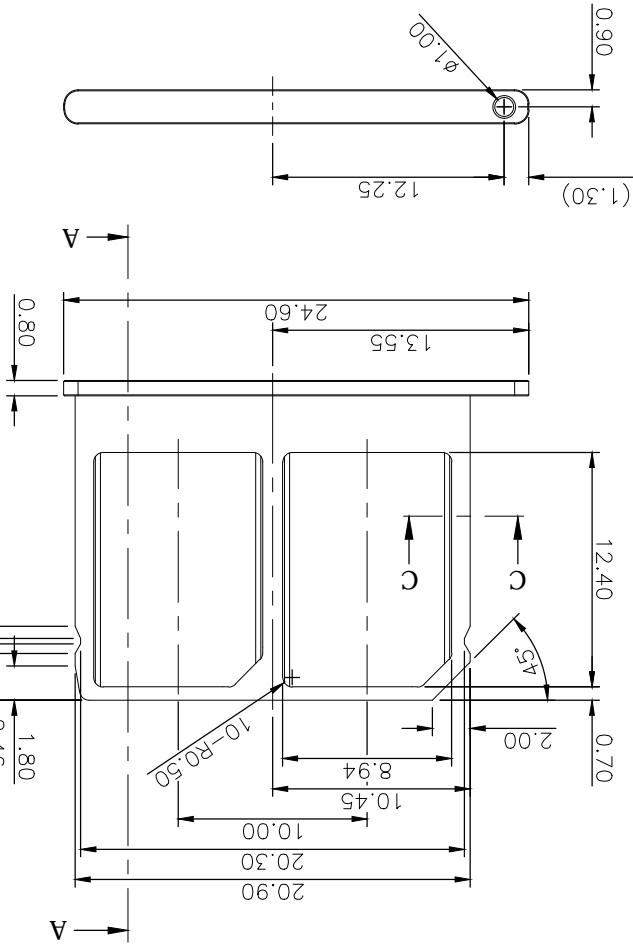

SCALE 2/1

DETAIL B
Scale 10/1

DETAIL D
Scale 10/1

SECTION C-C

SECTION A-A

| | | | |
|--------------------------------------|-----------------|------------|---------------|
| NO. | 1 | PART NAME | Tray |
| DESCRIPTION | Stainless steel | | |
| UNLESS OTHERWISE SPECIFIED TOLERANCE | | | |
| UNIT: | DECIMAL | LINEAR | ANGLES |
| | X | ±0.50 | ±5° |
| | X.X | ±0.25 | ±3° |
| | X.XX | ±0.12 | ±1° |
| DRAWN NAME: Fros | | | |
| CHECKED: Tm | | | |
| APPROVED: Ken | | | |
| SCALE | 2.5 | SHEET | 1/1 |
| SIZE | A4 | FILE NAME | 115S-BT00_B_1 |
| DRAWN NAME: Fros | | 2018/10/23 | |
| CHECKED: Tm | | 2018/10/23 | |
| APPROVED: Ken | | 2018/10/23 | |
| PRODUCT NO. 115S-BT00 | | | |
| NANO SIM TRAY, DUAL CARD, SUS316 | | | |
| NATURAL COLOR, 16.9MM, REEL | | | |
| WWW.ATTEND.COM.TW | | | |
| ATTEND | | | |

| | | | |
|-------|------|-------------|-----------------|
| REV. | 1 | DESCRIPTION | INITIAL RELEASE |
| DRAWN | FROS | DATE | 2018/10/23 |

10 9 8 7 6 5 4 3 2 1

A B C D E F G

Carton L*W*H=350*350*320

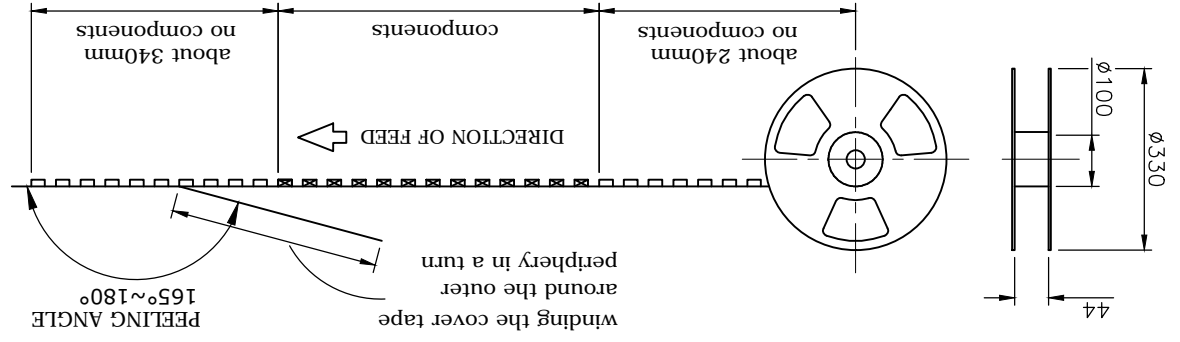
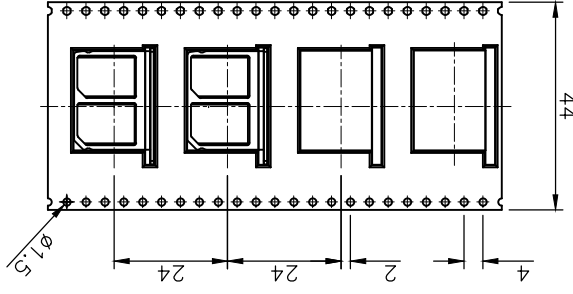
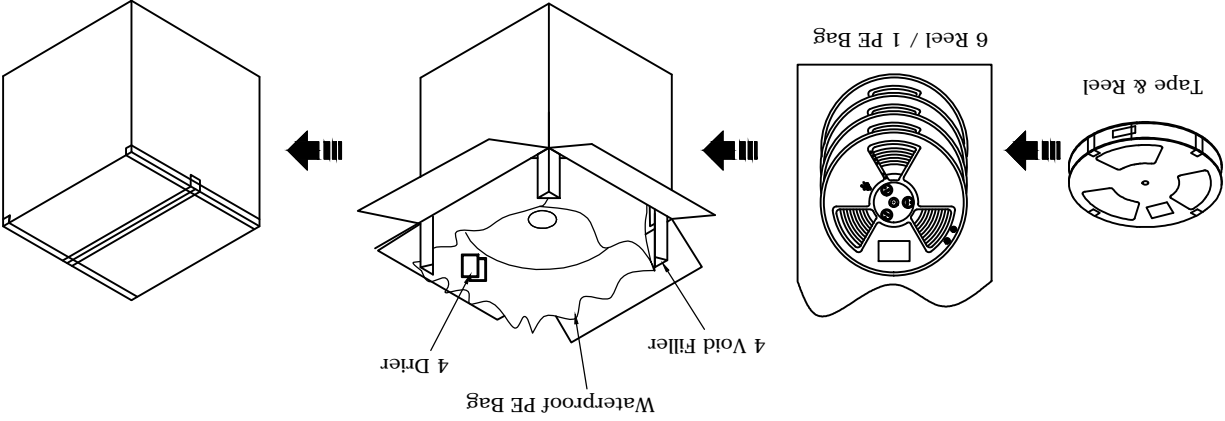

PACKAGING SPECIFICATION:

1. MATERIAL
 - 1.1 Embossed Carrier Tape: PS Black
 - 1.2 Top Cover Tape: PET
 - 1.3 Taping Reel: Plastic
2. PACKING
 - 2.1 Quantity: 7,200 PCS/Carton
 - 2.2 6 REEL/Carton
 - 2.3 1,200 PCS/REEL

| | | | | | | |
|--------------------------------------|---------------|--------|------------|--------|--------|--|
| UNLESS OTHERWISE SPECIFIED TOLERANCE | | UNIT: | DECIMAL | LINEAR | ANGLES | |
| X | ±0.50 | mm | X | ±5° | | |
| XX | ±0.25 | | XX | ±3° | | |
| XXX | ±0.12 | | XXX | ±1° | | |
| DRAWN NAME: Thm | | DATE: | 2018/12/10 | | | |
| CHECKED: Fros | | DATE: | 2018/12/10 | | | |
| APPROVED: Ken | | DATE: | 2018/12/10 | | | |
| SCALE: | N/A | SHEET: | 1/1 | SIZE: | A4 | |
| FILE NAME: | 115S-BT00_D_1 | | | | | |
| PRODUCT NO.: | 115S-BT00 | | | | | |
| DRAWN NAME: www.attend.com.tw | | | | | | |
| Nano SIM Tray, Dual Card, SUS316 | | | | | | |
| Natural color, 16.9mm, Reel | | | | | | |



| | | | |
|------|---------------|-------|------|
| REV. | DESCRIPTION | DRAWN | DATE |
| | see sheet one | | |

10 9 8 7 6 5 4 3 2 1

X-ON Electronics

Largest Supplier of Electrical and Electronic Components

Click to view similar products for [Memory Card Connectors](#) category:

Click to view products by [Attend manufacturer](#):

Other Similar products are found below :

[M10-597810-355](#) [M21-033321-005](#) [6426-201-21343](#) [69.920.0553.0](#) [MCR60A-98D-2.54DSA\(70\)](#) [FCN-568P068-G/07-4V](#) [809180410000000](#)
[95622-003LF](#) [AD2-262F-38900-232](#) [DM3AT-SF-PEJM5\(41\)](#) [EN2997S72039F6](#) [N7E50-7516PG-20-WF](#) [IC11S-BUR-PNEJL\(71\)](#) [NX30TA-](#)
[15PAA\(50\)](#) [21920-5](#) [2041353-2](#) [FUA006-3220-0](#) [308-DS1P0811-192](#) [33CFAE-DN](#) [MI21A-50PD-SF-EJR\(91\)](#) [502431-1011](#) [5175651-2](#) [10-](#)
[247926-166](#) [10-629549-258N](#) [11327-001](#) [11327-002](#) [EN2997S02039B8](#) [EN2997S61212BN](#) [EN2997S72039B6](#) [EN2997SE02039B8](#)
[EN2997SE61212BN](#) [EN2997SE72039B6](#) [603020000](#) [617230001](#) [71-252718-32P](#) [NX1-32T-KT3K\(05\)](#) [95622-003LF](#) [91-570124-15P](#)
[192900-0488](#) [N7E50-U516RB-50-SIN0005](#) [DM1AA-SF-PEJ](#) [95079-00CALF](#) [84648-056HLF](#) [68-580163-21S](#) [33DVIR-29S12R](#)
[SF58S006VBBR2000](#) [93-570123-08P](#) [GMC020080HR](#) [125A-78C00](#) [1010040575#](#)