

NANO840

Nano-ITX SBC with Intel® Atom™ Processor E3845/E3827, LVDS/VGA/HDMI, Dual LANs and Audio

Features

- Intel® Atom™ processor E3845/E3827
- 1 DDR3L-1066/1333 SO-DIMM, up to 8GB
- 5 USB 2.0 ports and 1 USB 3.0 port
- 2 COM ports
- 2 PCI Express Mini Card slots



Core System

CPU	Intel® Atom™ processor E3845 quad core, E3827 dual core onboard
System Memory	1 x 204-pin DDR3L-1066/1333 SO-DIMM, up to 8GB
Chipset	SoC integrated
BIOS	AMI
SSD	N/A
Watchdog Timer	255 levels, 1 ~ 255 sec.
Expansion Interface	1 x Full-size PCI Express Mini Card with mSATA 1 x Half-size PCI Express Mini Card
Battery Lithium	Lithium 3V/220mAh
Power Input	DC power jack connector +12V DC-in AT Auto Power On function supported
Power Requirements	Intel® Atom™ E3845 @1.91 GHz 8GB DDR3L Max. RMS: +12V @ 0.9A Intel® Atom™ E3827 @1.75 GHz 8GB DDR3L Max. RMS: +12V @ 0.8A
Size	120 x 120 mm
Board Thickness	1.6 mm
Temperature	-40°C ~ +80°C (-40°F ~ +176°F), operation
Relative Humidity	10% ~ 95% relative humidity, non-condensing

I/O

MIO	1 x RS-232/422/485 (+5V/+12V powered) 1 x RS-232
SATA	1 x SATA-300
Hardware Monitoring	Detect CPU/system temperature and voltage
Ethernet	2 ports 10/100/1000 Mbps supports Wake-on-LAN, PXE Boot ROM with Intel® i210IT
Audio	HD Codec audio as MIC-in/Line-out with Realtek ALC662
USB	5 x USB 2.0 1 x USB 3.0
SMBus	System Management Bus for advanced monitoring/control
Digital I/O	8 channels IN/OUT programmed
TPM	ST ST33TPM12LPC with TPM 1.2 compliant

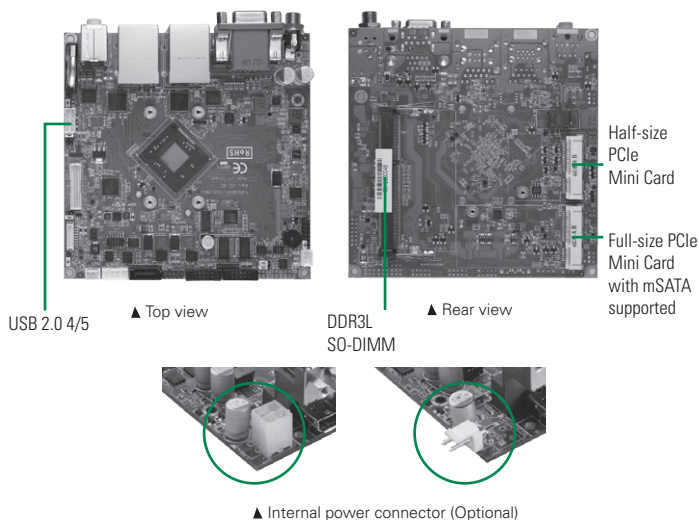
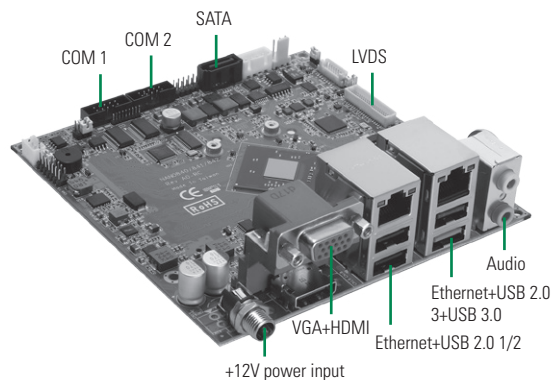

Display

Chipset	Intel® HD Graphics
Memory Size	Share System memory
Display Interface	1 x VGA 1 x LVDS; 18/24-bit single/dual channel 1 x HDMI

Packing List

Standard		
Quick installation guide, user's manual/utility CD and cable		
Cable		
Part Number	Description	Qty
5938262000E	1 x COM cable w/ bracket, P=2.0 mm, L=300 mm	1
Optional		
50966124030E	ADAPTER 12V60W FSP060-DIBAN2 W/SCREW	
59406260610E	SATA power, L=10cm	

Ordering Information

Standard	
NANO840VHGGGA-E3845 (P/N: E38K840100)	Nano-ITX SBC with Intel® Atom™ processor E3845 (1.91 GHz, 2 MB Cache, 10 W), VGA/LVDS/HDMI, 2 GbE LANs, audio and gift box
NANO840VHGGGA-E3827 (P/N: E38K840101)	Nano-ITX SBC with Intel® Atom™ processor E3827 (1.75 GHz, 1 MB Cache, 8 W), VGA/LVDS/HDMI, 2 GbE LANs, audio and gift box

X-ON Electronics

Largest Supplier of Electrical and Electronic Components

Click to view similar products for [Single Board Computers](#) category:

Click to view products by [Axiomtek](#) manufacturer:

Other Similar products are found below :

[MANO882VPGGA-H81](#) [SSD3200W-S-SLC-INN 20-101-0738](#) [MVME61006E-2173R](#) [SHB230DGGGA-RC](#) [IMB210VGGA](#) [IB915F-3955](#)
[MI958F-16C](#) [S2600WFT](#) [S2600STB](#) [BBS2600BPS](#) [BLKNUC7I3DNHNC1978015](#) [DEV-17745](#) [BEAGLEBOARD POCKET](#) [MICROSOM](#)
[I2 + WIFI/BT](#) [HUMMINGBOARD-I2EX](#) [BASE + WIFI/BT](#) [HUMMINGBOARD-I4 PRO + WIFI/BT](#) [VAB-600-B](#) [RT5350F-OLINUXINO-](#)
[EVB](#) [MITX-440-DVI-2E](#) [ATCA-7365-D-24GB](#) [NITX-315-DEVKIT](#) [A13-SOM-512](#) [NITX-315](#) [BANANA PI BPI-M1+](#) [A13-SOM-WIFI-](#)
[4GB](#) [AM3359-SOM-EVB-IND](#) [UPS-APLC2-A10-0432](#) [DFR0419](#) [UPS-APLP4-A10-0864](#) [UPS-APLP4-A10-0432](#) [UPS-APLP4-A10-08128](#)
[MI977F-Q27](#) [BBBLUE](#) [IB811F-I30](#) [DFR0470-ENT](#) [Nit6Q_i](#) [M2M \(TELIT\)](#) [RELAY](#) [PROFESSIONAL](#) [GCS22.2.080.2.2.I](#)
[GCS22.8.100.4.2.I](#) [GLS11.2.053.2.2.E](#) [A20-OLINUXINO-LIME-E16GS16M](#) [A20-OLINUXINO-LIME-S16M](#) [A20-OLINUXINO-LIME2-](#)
[E16GS16M](#) [A20-OLINUXINO-MICRO-E16GS16M](#) [A20-OLINUXINO-MICRO-S16M](#) [BANANA PI BPI-W2](#) [T2-OLINUXINO-LIME2-](#)
[S16M-IND](#)