

8				7				6				5				4				3				2				1																								
MODEL NO.	"L"	"D"	P/N	MODEL NO.	"L"	"D"	P/N	MODEL NO.	"L"	"D"	P/N	MODEL NO.	"L"	"D"	P/N	MODEL NO.	"L"	"D"	P/N	MODEL NO.	"L"	"D"	P/N	MODEL NO.	"L"	"D"	P/N	MODEL NO.	"L"	"D"	P/N																					
ITA230S	9144 [360]	3.18 [.125]	20210	ITA13S	914 [36]	1.57 [.062]	20180	ITA2.5S	152 [6]	3.18 [.125]	20944	ITA21.5S	457 [18]	3.18 [.125]	20790	ITA210S	3048 [120]	3.18 [.125]	20689	ITA212S	3658 [144]	3.18 [.125]	20779	ITA215S	4572 [180]	3.18 [.125]	20269	ITA21S	305 [12]	3.18 [.125]	20488	ITA22S	610 [24]	3.18 [.125]	20431																	

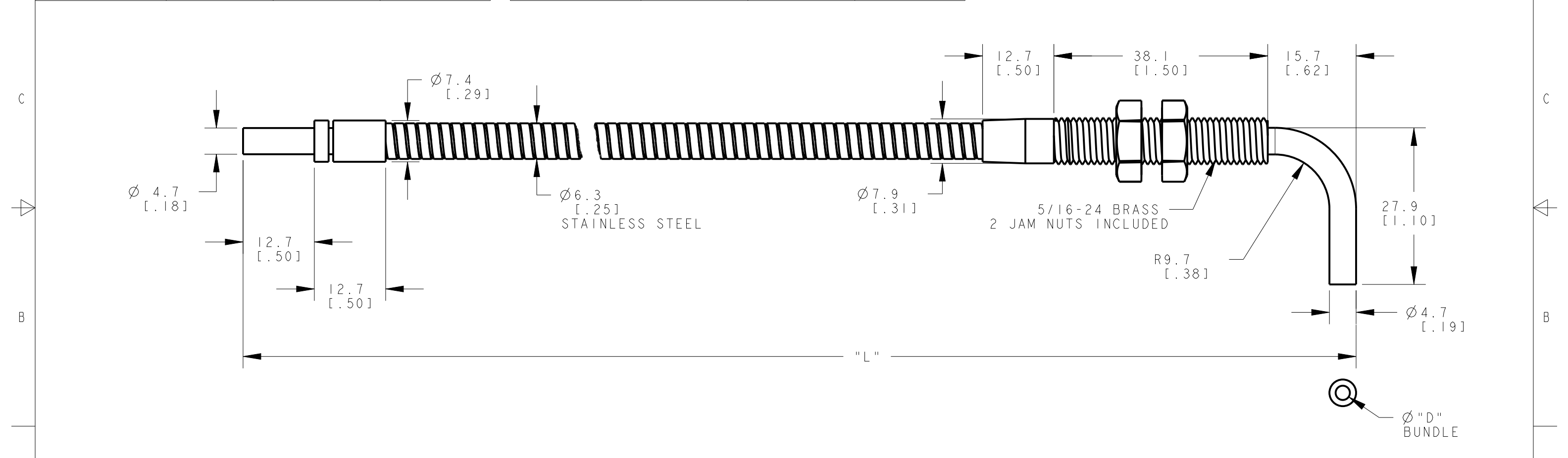

NOTES:
 1. ALL DIMENSIONS ARE MILLIMETERS [INCHES] UNLESS OTHERWISE NOTED.
 2. REFER TO "www.bannerengineering.com" FOR ADDITIONAL DATA AND SPECIFICATIONS.

This drawing is the property
 of BANNER ENGINEERING CORP.
 Any use or reproduction,
 in any form, without prior
 written permission of
 Banner is prohibited.
 © 2015 Banner Engineering Corp.

BANNER BANNER ENGINEERING CORP.
 www.bannerengineering.com

TITLE
ITA2 SERIES SS TERMINATED

SIZE B DRAWING NO. **161909** REV. **A**

SCALE 3:2 SHEET 1 OF 2

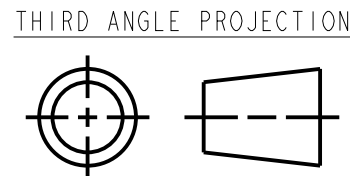

8	7	6	5	4	3	2	1
MODEL NO.	"L"	"HL"	"AL"	"D"	P/N		
ITA25S	60	.62	1.1	.125	20114		
ITA26S	72	.62	1.1	.125	20114		
ITA27S	84	.62	1.1	.125	20292		
ITA28S	96	.62	1.1	.125	20594		
ITA29S	108	.62	1.1	.125	20245		
ITA23S	36	.62	1.1	.125	17967		
ITA23SM8X1.1	36	8.0 ± .1	1.1	.125	23665		
ITA21.4S	17	.62	1.1	.125	23702		
ITA221S	252	.62	1.1	.125	23773		
ITA222S	264	.62	1.1	.125	23774		
ITA224.5S	294	.62	1.1	.125	23775		
ITA225.5S	306	.62	1.1	.125	23776		
ITA211S	132	.62	1.1	.125	23972		
ITA28SM600	96	.62	1.1	.125	24190		
ITA23SM2X1.1	36	2.0	1.1	.125	24386		
ITA13SM3X1.1	36	3.0	1.1	.062	00000		
ITA23SM3X1.1	36	3.0	1.1	.125	00000		
ITA216.4SM600	197	.62	1.1	.125	00000		
ITA210SM600	120	.62	1.1	.125	24637		
ITA21.8SM.8	21	.62	.8	.125	24896		
ITA230SM600	360	.62	1.1	.125	81899		
ITA.52S	24	.62	1.1	.032	00000		

NOTES:

- 'M600' SUFFIX INDICATES THAT FIBERS POTTED ON ANGLED END WITH EPOXY THAT OPERATES IN MAX. TEMPERATURES OF 600°F.

- NOTES:
- ALL DIMENSIONS ARE MILLIMETERS [INCHES] UNLESS OTHERWISE NOTED.
 - REFER TO "www.bannerengineering.com" FOR ADDITIONAL DATA AND SPECIFICATIONS.

This drawing is the property of BANNER ENGINEERING CORP. Any use or reproduction, in any form, without prior written permission of Banner is prohibited.
© 2015 Banner Engineering Corp.

BANNER BANNER ENGINEERING CORP.
www.bannerengineering.com

THIRD ANGLE PROJECTION

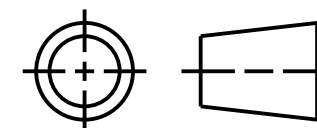

TITLE
ITA2 SERIES SS TERMINATED

SIZE B DRAWING NO. **161909** REV. **A**

SCALE 2:1 SHEET 2 OF 2

CREO

X-ON Electronics

Largest Supplier of Electrical and Electronic Components

Click to view similar products for [Fibre Optic Sensors](#) category:

Click to view products by [Banner](#) manufacturer:

Other Similar products are found below :

[BTA23S](#) [IAT23S](#) [D12EN6FP](#) [BA23S](#) [BF13S](#) [BT21S](#) [IAT28S](#) [IT26S](#) [E32L56E1](#) [E32L56E2](#) [D12E2N6FP](#) [D12DAB6FPQ](#) [D12EP6FV](#)
[W/30](#) [PBT46UHT1](#) [D12SN6FVY](#) [FL-DR90W](#) [CCS-NFCB2-CC-3](#) [CCS-LFV3-35RD](#) [CCS-QBL-120120SW](#) [E3Z-T81-M1TJ-1 0.3M](#) [S7-4-](#)
[E-P](#) [CN-14A-R-C2](#) [CN-73-C1](#) [LL3-TB01](#) [FD-42G](#) [E32-D11L 2M](#) [E32-T11L 2M](#) [1830L3500MSC](#) [FX-101-CC2](#) [FX-101P](#) [FX-101P-CC2](#)
[FX-101P-Z](#) [FX-102-CC2](#) [D11SN6FP](#) [PBCL22T](#) [SM312FP1H](#) [FT-420-10](#) [WLL180T-P432](#) [FD-31](#) [FD-62](#) [E3X-NA41 2M](#) [FT-F93](#) [FX-](#)
[102P-CC2](#) [FX-502P](#) [FX-505P-C2](#) [E32-D32 2M](#) [CN-73-C2](#) [CN-24A-C5](#) [CN-24A-C2](#) [CN-14A-R-C5](#)