

# K50 Pro Touch Audible Button

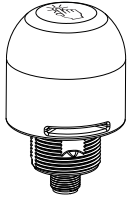

## Datasheet

50 mm Programmable Multicolor RGB Indicator with Audible and Touch Button Output



Standard Model



Compact Model

- Excellent immunity to false triggering by water spray, detergents, oils, and other foreign materials
- Programmable using Banner's Pro Editor software and Pro Converter Cable
- Integral audible can be used as standalone indicator or as an input to touch conditions
- 14 different tones available including intensity and input control
- 97 dB maximum sound intensity
- Rated IP67 and IP65
- Ergonomically designed to eliminate hand, wrist, and arm stresses associated with repeated switch operation; no physical force required to operate
- 12 V DC to 30 V DC operation
- Can be actuated with bare hands or gloves; adjustable sensitivity using Pro Editor software
- Compact models available for lower profile applications
- Configurable input/output with Pro Editor software

## Models

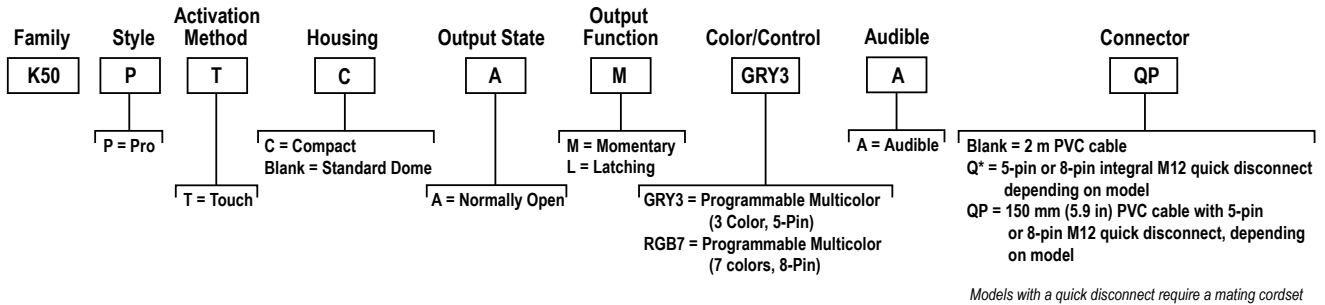

## Pro Editor

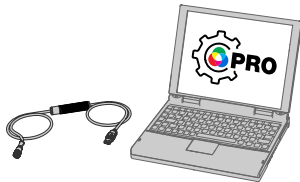

Use Banner's Pro Editor software and Pro Converter Cable to create custom configurations by selecting different colors, flash patterns, and animations.  
For more information visit [www.bannerengineering.com/proeditor](http://www.bannerengineering.com/proeditor).



# Wiring

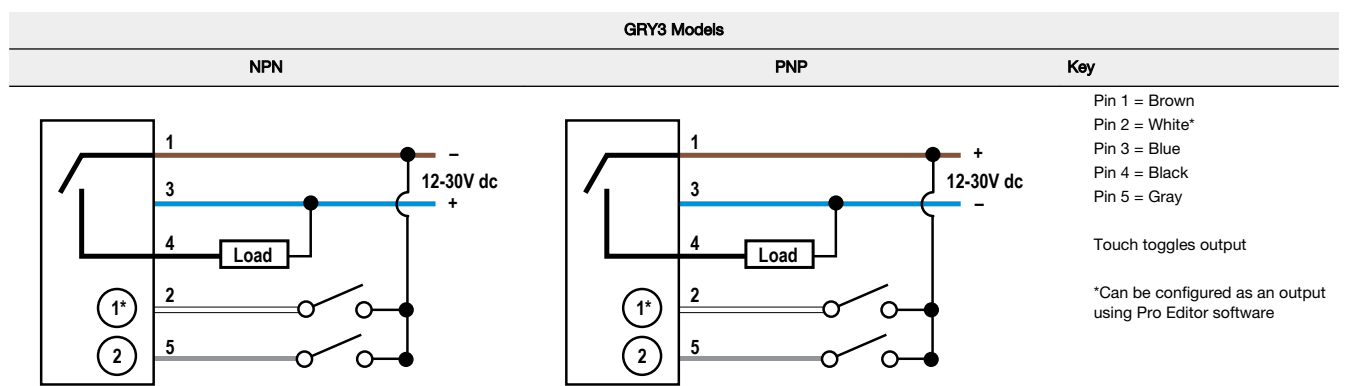

Table 1: GRY3 Multicolor Default Color/Function and Audible Definition

| Audible |       |        |     |
|---------|-------|--------|-----|
| Color   | Green | Yellow | Red |
| Input 1 | X     | X      |     |
| Input 2 |       | X      | X   |

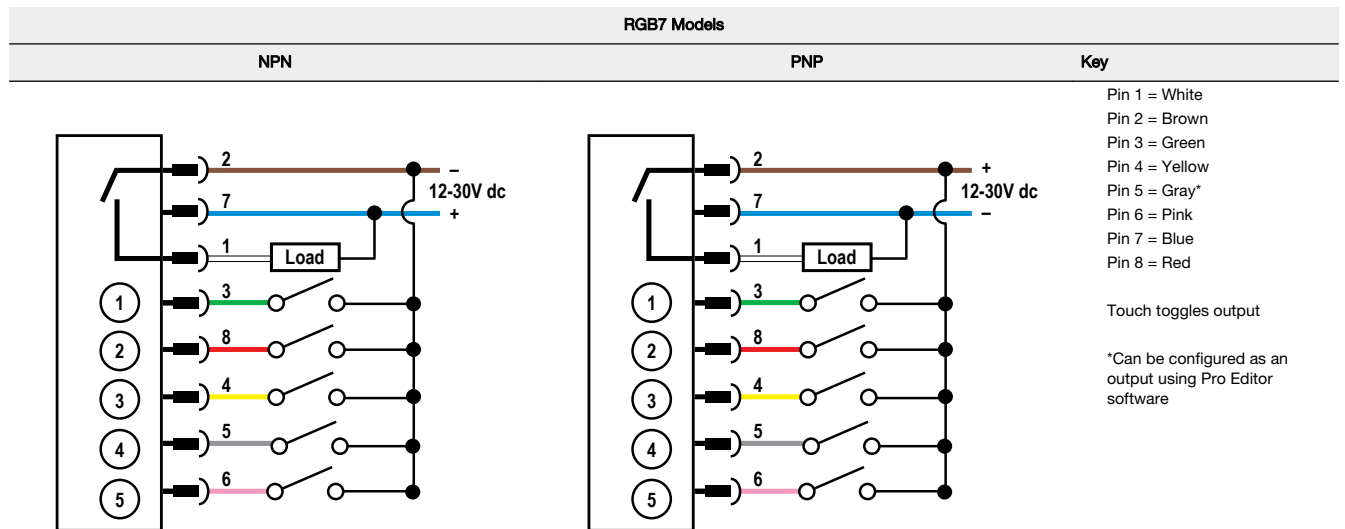

Table 2: RGB7 Multicolor Default Color/Function and Audible Definition

| Color   | Red | Yellow | Green | Cyan | Blue | Magenta | White |
|---------|-----|--------|-------|------|------|---------|-------|
| Input 1 | X   | X      |       |      |      | X       | X     |
| Input 2 |     | X      | X     | X    |      |         | X     |
| Input 3 |     |        |       | X    | X    | X       | X     |

| Audible | Continuous | Jingle | Wobble |
|---------|------------|--------|--------|
| Input 4 | X          | X      |        |
| Input 5 |            | X      | X      |

## Specifications

### Supply Voltage

12 V DC to 30 V DC

### Supply Current

135 mA maximum current at 12 V DC (exclusive of load)  
108 mA maximum current at 24 V DC (exclusive of load)  
105 mA maximum current at 30 V DC (exclusive of load)

### Supply Protection Circuitry

Protected against reverse polarity and transient voltages

### Leakage Current Immunity

400  $\mu$ A

### Output Rating

Maximum load: 150 mA  
ON-state saturation voltage: < 2 V DC at 10 mA; <2.5 V DC at 150 mA  
OFF-state leakage current: <10  $\mu$ A at 30 V DC

### Audible Characteristics

Values shown apply to continuous tone. Frequency and intensity response will vary depending on the Audible Tone selected.

#### Audible Intensity

Maximum intensity at 2.9 kHz: 97 dB at 1 m  
Minimum intensity at 2.9 kHz: 94 dB at 1 m

### Output Response Time

Power-Up Delay: 500 milliseconds maximum  
Input Response: 40 milliseconds maximum  
Output Response: 300 milliseconds maximum

### Touch Dwell Time

If touch dwells for longer than 60 seconds, the output will revert to the untouched state

### Operating Conditions

-40 °C to +50 °C (-40 °F to +122 °F)  
Humidity: 90% at +50 °C maximum relative humidity (non-condensing)

### Environmental Rating

IP67, IP65

### Mounting

M30 x 1.5 threaded base, maximum torque 4.5 N-m (40 in-lbf)

### Construction

Base, Dome, and Nut: Polycarbonate

### Vibration and Mechanical Shock

Meets IEC 60068-2-6 requirements (Vibration: 10 Hz to 55 Hz, 1.0 mm amplitude, 5 minutes sweep, 30 minutes dwell)  
Meets IEC 60068-2-27 requirements (Shock: 30G 11 ms duration, half sine wave)

### Certifications



**Banner Engineering Europe** Park Lane, Culliganlaan 2F bus 3, 1831 Diegem, BELGIUM



**Turck Banner LTD** Blenheim House, Blenheim Court, Wickford, Essex SS11 8YT, Great Britain



### Connections

5-pin or 8-pin integral M12 quick disconnect, 2 m (6.5 ft) integral PVC cable, or 5-pin or 8-pin 150 mm (5.9 inch) PVC cable with an M12 quick disconnect, depending on model  
Models with a quick disconnect require a mating cordset

### Storage

-40 °C to +70 °C (-40 °F to +158 °F)

### Pro Editor Configuration

Connection to Pro Editor software enables control of:

- **Animation:** Steady, Flash, Two Color Flash, 50/50, 50/50 Rotate, Chase, Intensity Sweep, Demo
- **Color:** Green, Red, Yellow, Blue, White, Cyan, Magenta, Amber, Rose, Lime Green, Orange, Sky Blue, Violet, Spring Green
- **Intensity:** Low, Medium, High
- **Speed:** Slow, Standard, Fast
- **Output State:** Normally Open, Normally Closed, Momentary, Latching, On Delay, Off Delay, Remember Touch State on Power Loss
- **Touch Sensitivity:** Low, Standard, High
- **Logic Type:** Three State Advanced Control (F2 Mode), Seven State Advanced Control (F2 Mode), Four State Full Logic (Custom)
- **Audible Tones:** Pulse, Wobble, Strobe, Whoop, Staccato, Siren, Continuous 1, Continuous 2, Jingle, Melody 1, Melody 2, Melody 3
- **Audible Intensity:** Low, Medium, High
- One pin configurable as either an input or an output

Pro Converter Cable required to interface between PC and indicator, see accessories

### Default Indicator Characteristics

| Color        | Dominant Wavelength (nm) or Color Temperature (CCT) | Color Coordinates <sup>1</sup> |       | Lumen Output (Typical at 25 °C) <sup>2</sup> |
|--------------|---|--------------------------------|-------|--|
|              |   | x                              | y     |  |
| Green        | 522   | 0.154                          | 0.700 | 16.5   |
| Red          | 620   | 0.689                          | 0.309 | 8.3  |
| Yellow       | 576   | 0.477                          | 0.493 | 23.8   |
| Blue         | 466   | 0.140                          | 0.054 | 4.6  |
| White        | 5700K   | 0.328                          | 0.337 | 25.1   |
| Cyan         | 493   | 0.170                          | 0.340 | 18.4   |
| Magenta      | –   | 0.379                          | 0.172 | 11.1   |
| Amber        | 589   | 0.556                          | 0.420 | 15.7   |
| Rose         | –   | 0.515                          | 0.220 | 9.1  |
| Lime Green   | 562   | 0.388                          | 0.561 | 21.4   |
| Sky Blue     | 486   | 0.155                          | 0.247 | 19.5   |
| Orange       | 599   | 0.616                          | 0.370 | 12.1   |
| Violet       | –   | 0.217                          | 0.089 | 9.7  |
| Spring Green | 508   | 0.177                          | 0.536 | 17.0   |

### Required Overcurrent Protection



**WARNING:** Electrical connections must be made by qualified personnel in accordance with local and national electrical codes and regulations.

Overcurrent protection is required to be provided by end product application per the supplied table.  
Overcurrent protection may be provided with external fusing or via Current Limiting, Class 2 Power Supply.  
Supply wiring leads < 24 AWG shall not be spliced.  
For additional product support, go to [www.bannerengineering.com](http://www.bannerengineering.com).

| Supply Wiring (AWG) | Required Overcurrent Protection (Amps) |
|---------------------|--|
| 20                  | 5.0                                    |
| 22                  | 3.0                                    |
| 24                  | 2.0                                    |
| 26                  | 1.0                                    |
| 28                  | 0.8                                    |
| 30                  | 0.5                                    |

## Dimensions

All measurements are listed in millimeters [inches], unless noted otherwise.

### Standard Models

### Compact Models

<sup>1</sup> Refer to the CIE 1931 (x,y) Chromaticity Diagram to show equivalent color with indicated color coordinates. Actual coordinates may differ  $\pm$  5%.

<sup>2</sup> Values shown apply to dome models only. Compact models are 20% lower.

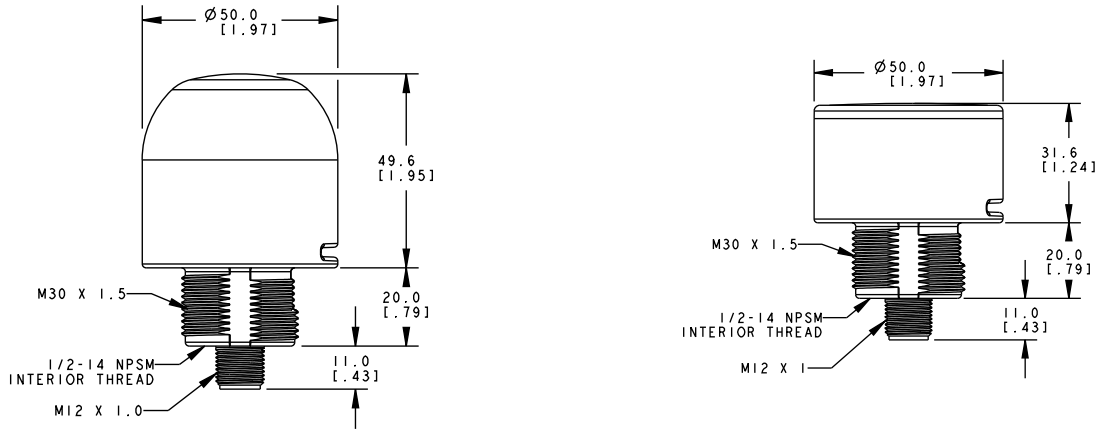

## Accessories

### Pro Editor Hardware

#### MQDC-506-USB

- Pro Converter Cable
- 1.83 m (6 ft) length 5-pin M12 quick disconnect to Device and USB to PC
- Required for connection to Pro Editor

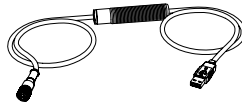

#### CSB-M1251FM1251M

- 5-pin parallel Y splitter (Male-Male-Female)
- For full Pro Editor preview capability
- Requires external power supply, sold separately

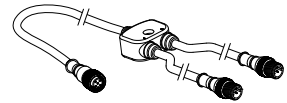

#### PSW-24-1

- 24 V DC, 1 A power supply
- 2 m (6.5 ft) PVC cable with M12 quick disconnect
- Provides external power with splitter cable, sold separately

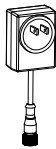

#### ACC-PRO-CABLE5

- Mating accessory for cabled and terminal models
- 150 mm (6 inch) PVC cable with M12 quick disconnect
- Lever wire nuts included (qty 5)
- Required to connect cabled models and screw terminal models to Pro Converter Cable, sold separately

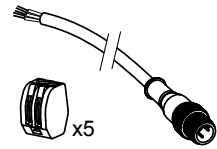

#### MQDC-801-5M-PRO

- 8-pin to 5-pin double-ended cordset
- 0.31 m (1 ft) PVC cable with M12 quick disconnects
- Required to connect 8-pin Pro Series-enabled devices to Pro Converter Cable (MQDC-506-USB), sold separately



## Cordsets

| 5-Pin Threaded M12 Cordsets—Single Ended |                |             |            |  |
|--|----------------|-------------|------------|--|
| Model                                    | Length         | Style       | Dimensions | Pinout (Female)  |
| MQDC1-501.5                              | 0.5 m (1.5 ft) | Straight    |            | <p>1 = Brown<br/>2 = White<br/>3 = Blue<br/>4 = Black<br/>5 = Gray</p> |
| MQDC1-506                                | 2 m (6.5 ft)   |             |            |  |
| MQDC1-515                                | 5 m (16.4 ft)  |             |            |  |
| MQDC1-530                                | 9 m (29.5 ft)  | Right-Angle |            |  |
| MQDC1-506RA                              | 2 m (6.5 ft)   |             |            |  |
| MQDC1-515RA                              | 5 m (16.4 ft)  |             |            |  |
| MQDC1-530RA                              | 9 m (29.5 ft)  |             |            |  |

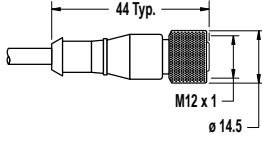
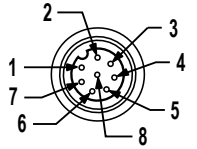
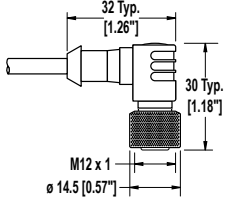
| 8-Pin Threaded M12 Cordsets with Open-Shield—Single Ended |                    |             |  |  |
|---|--------------------|-------------|--|--|
| Model   | Length             | Style       | Dimensions   | Pinout (Female)  |
| MQDC2S-806  | 2.04 m (6.7 ft)    | Straight    |  |  <p>1 = White<br/>2 = Brown<br/>3 = Green<br/>4 = Yellow<br/>5 = Gray<br/>6 = Pink<br/>7 = Blue<br/>8 = Red</p> |
| MQDC2S-815  | 5.04 m (16.54 ft)  |             |  |  |
| MQDC2S-830  | 10.04 m (32.95 ft) |             |  |  |
| MQDC2S-850  | 16 m (52.49 ft)    | Right-Angle |  |  |
| MQDC2S-806RA  | 2 m (6.56 ft)      |             |  |  |
| MQDC2S-815RA  | 5 m (16.4 ft)      |             |  |  |
| MQDC2S-830RA  | 10 m (32.81 ft)    |             |  |  |
| MQDC2S-850RA  | 16 m (52.49 ft)    |             |  |  |

## Brackets

### SMB30A

- Right-angle bracket with curved slot for versatile orientation
- Clearance for M6 (¼ in) hardware
- Mounting hole for 30 mm sensor
- 12-ga. stainless steel

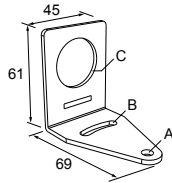

Hole center spacing: A to B=40  
Hole size: A=ø 6.3, B= 27.1 x 6.3, C=ø 30.5

### SMB30FA

- Swivel bracket with tilt and pan movement for precise adjustment
- Mounting hole for 30 mm sensor
- 12-ga. 304 stainless steel
- Easy sensor mounting to extrude rail T-slot
- Metric and inch size bolt available

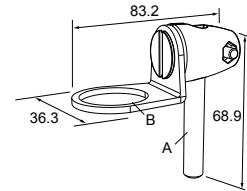

Bolt thread: SMB30FA, A= 3/8 - 16 x 2 in; SMB30FAM10, A= M10 - 1.5 x 50  
Hole size: B= ø 30.1

### SMB30FVK

- V-clamp, flat bracket and fasteners for mounting to pipe or extensions
- Clamp accommodates 28 mm dia. tubing or 1 in. square extrusions
- 30 mm hole for mounting sensors

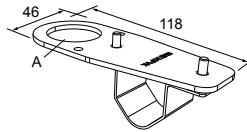

Hole size: A= ø 31

### SMB30MM

- 12-ga. stainless steel bracket with curved mounting slots for versatile orientation
- Clearance for M6 (¼ in) hardware
- Mounting hole for 30 mm sensor

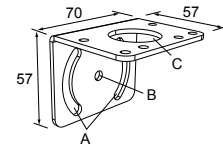

Hole center spacing: A = 51, A to B = 25.4  
Hole size: A = 42.6 x 7, B = ø 6.4, C = ø 30.1

### SMB30RAVK

- V-clamp, right-angle bracket and fasteners for mounting sensors to pipe or extrusion
- Clamp accommodates 28 mm dia. tubing or 1 in. square extrusions
- 30 mm hole for mounting sensors

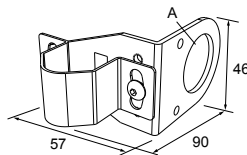

Hole size: A = ø 30.5

### SMB30SC

- Swivel bracket with 30 mm mounting hole for sensor
- Black reinforced thermoplastic polyester
- Stainless steel mounting and swivel locking hardware included

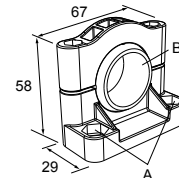

Hole center spacing: A=ø 50.8  
Hole size: A=ø 7.0, B=ø 30.0

**SMBAMS30P**

- Flat SMBAMS series bracket
- 30 mm hole for mounting sensors
- Articulation slots for 90°+ rotation
- 12-ga. 300 series stainless steel

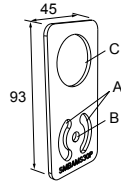

**Hole center spacing:** A=26.0, A to B=13.0  
**Hole size:** A=26.8 x 7.0, B=ø 6.5, C=ø 31.0

**SMBAMS30RA**

- Right-angle SMBAMS series bracket
- 30 mm hole for mounting sensors
- Articulation slots for 90°+ rotation
- 12-ga. (2.6 mm) cold-rolled steel

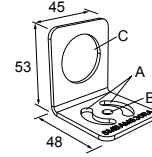

**Hole center spacing:** A=26.0, A to B=13.0  
**Hole size:** A=26.8 x 7.0, B=ø 6.5, C=ø 31.0

**TC-K50-CL**

- Touch cover

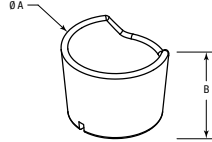

**Diameter:** A = 67 mm  
**Height:** B = 42.5 mm

## Banner Engineering Corp. Limited Warranty

Banner Engineering Corp. warrants its products to be free from defects in material and workmanship for one year following the date of shipment. Banner Engineering Corp. will repair or replace, free of charge, any product of its manufacture which, at the time it is returned to the factory, is found to have been defective during the warranty period. This warranty does not cover damage or liability for misuse, abuse, or the improper application or installation of the Banner product.

**THIS LIMITED WARRANTY IS EXCLUSIVE AND IN LIEU OF ALL OTHER WARRANTIES WHETHER EXPRESS OR IMPLIED (INCLUDING, WITHOUT LIMITATION, ANY WARRANTY OF MERCHANTABILITY OR FITNESS FOR A PARTICULAR PURPOSE), AND WHETHER ARISING UNDER COURSE OF PERFORMANCE, COURSE OF DEALING OR TRADE USAGE.**

This Warranty is exclusive and limited to repair or, at the discretion of Banner Engineering Corp., replacement. **IN NO EVENT SHALL BANNER ENGINEERING CORP. BE LIABLE TO BUYER OR ANY OTHER PERSON OR ENTITY FOR ANY EXTRA COSTS, EXPENSES, LOSSES, LOSS OF PROFITS, OR ANY INCIDENTAL, CONSEQUENTIAL OR SPECIAL DAMAGES RESULTING FROM ANY PRODUCT DEFECT OR FROM THE USE OR INABILITY TO USE THE PRODUCT, WHETHER ARISING IN CONTRACT OR WARRANTY, STATUTE, TORT, STRICT LIABILITY, NEGLIGENCE, OR OTHERWISE.**

Banner Engineering Corp. reserves the right to change, modify or improve the design of the product without assuming any obligations or liabilities relating to any product previously manufactured by Banner Engineering Corp. Any misuse, abuse, or improper application or installation of this product or use of the product for personal protection applications when the product is identified as not intended for such purposes will void the product warranty. Any modifications to this product without prior express approval by Banner Engineering Corp will void the product warranties. All specifications published in this document are subject to change; Banner reserves the right to modify product specifications or update documentation at any time. Specifications and product information in English supersede that which is provided in any other language. For the most recent version of any documentation, refer to: [www.bannerengineering.com](http://www.bannerengineering.com).

For patent information, see [www.bannerengineering.com/patents](http://www.bannerengineering.com/patents).

## FCC Part 15

This device complies with Part 15 of the FCC Rules. This equipment generates, uses, and can radiate radio frequency energy and, if not installed and used in accordance with the instruction manual, may cause harmful interference to radio communications. Operation is subject to the following two conditions: 1) This device may not cause harmful interference; and 2) This device must accept any interference received, including interference that may cause undesired operation.

## Industry Canada

This device complies with CAN ICES-3 (B)/NMB-3(B). Operation is subject to the following two conditions: 1) This device may not cause harmful interference; and 2) This device must accept any interference received, including interference that may cause undesired operation.

Cet appareil est conforme à la norme NMB-3(B). Le fonctionnement est soumis aux deux conditions suivantes : (1) ce dispositif ne peut pas occasionner d'interférences, et (2) il doit tolérer toute interférence, y compris celles susceptibles de provoquer un fonctionnement non souhaité du dispositif.

## X-ON Electronics

Largest Supplier of Electrical and Electronic Components

*Click to view similar products for [Beacons](#) category:*

*Click to view products by [Banner](#) manufacturer:*

Other Similar products are found below :

[K50APTWXDQ](#) [K50ABT2XGH](#) [K50APT2GXDQ](#) [K50ABTGRHQ](#) [K50APT2FGRYF2QP](#) [K50LGRYPPB1Q](#) [K50APTGRCQ](#)  
[K50APTGRYF2](#) [K50ABT2GYHQ](#) [K50APTGRYC3Q](#) [K50APT2GREQP](#) [K50APT2GRYF2Q](#) [K100PBLGYRQ](#) [K30LGRYPPB2](#)  
[K30APPBGREQP](#) [K30APT2FGRYF2QP](#) [K30LGRXPPB2Q](#) [K30LGRYPPB2Q](#) [K30APT2RGF2](#) [K30APTXRQF2](#) [K30APTXXWF2](#)  
[K30PTALRGB7](#) [K30PTAMGRY3QP](#) [K30PTALGRY3Q](#) [K30PTAMGRY3Q](#) [K30PTALRGB7Q](#) [K30PTAMRGB7Q](#) [K50APPBGRYF2Q8](#)  
[K50BCLXRXPQ](#) [K50BCLS1XYXPQ](#) [K50BCLGRBP](#) [K50BCLXGXP](#) [K50BCLS1XRXPQ](#) [K50BLGRXPQ](#) [K50LGRYPPB2](#)  
[K50LGXXPPB2Q](#) [K50LGRXPPB2Q](#) [K50LBXXPPB2Q](#) [K50LGYXPPB2Q](#) [K50PBLSQ](#) [K50PBLRGB7Q](#) [K50PFF100AMGRY3Q](#)  
[K50PTAMGRY3](#) [K50PTAMGRY3AQP](#) [K50PTKAQ](#) [K50PTAMGRY3AQ](#) [K50PTAMRGB7AQ](#) [K50PTCAMGRY3AQ](#)  
[K50PTCAMGRY3Q-812166](#) [K50PTCAMGRY3Q](#)