

承 認 書

SPECIFICATION FOR APPROVAL

<i>CUSTOMER:</i>	
<i>CUSTOMER P/N</i>	
<i>PART NO:</i>	
<i>DESCRIPTION:</i>	<i>SMD POWER INDUCTORS</i>
<i>PRODUCTS NO:</i>	BC43-100K
<i>PRODUCTS REV:</i>	01
<i>DATE:</i>	2018-6-11

<i>PURCHASER CONFIRMED.</i>		
<i>APPROVAL BY</i>	<i>CHECK BY</i>	<i>DRAWN BY</i>
<i>REMARK</i>		

<i>PROVIDER ENGINEER DEPT.</i>		
<i>APPROVAL BY</i>	<i>CHECK BY</i>	
		chenlinli



TAIPEI OFFICE

誠陽實業有限公司

TAIWAN CHENG YANG COMPONENT CORP

2F-1, NO. 176, Chine-Yi Road., Zhonghe District, New Taipei City, TAIWAN(R.O.C)

新北市中和區建一路 176 號 2 樓之一

POSTAL CODE: 23500

TEL NO.:+886-2- 8228-0930 FAX NO.:+886-2-8228-0929 E-mail:h21803@ms29.hinet.net



CHINA FACTORY

寶誠電子有限公司

ZHUHAI BAO CHENG ELECTRONICSCO.,LTD

Guan Tang Industrial Park, Tang Jia Wan Town, Zhuhai City, Guangdong Province, CHINA

中國廣東省珠海市塘家灣鎮官塘工業區

POSTAL CODE: 519085

TEL NO:86-756-3383187 FAX NO:86-756-3380704 E-mail: baocheng@baocheng.biz

CHINA FACTORY

昆山誠陽電子有限公司

KUNSHAN CHENG YANG ELECTRONICSCO.,LTD

Qiang-An Road., High-Tech. Industrial Park, Kunshan City, Jiangsu Province, China

江蘇省昆山市高科技工業園區強安路 35 號

POSTAL CODE: 215300

TEL NO:86-512-57823500 FAX NO:86-512-57823503 E-mail: ksey@taiwan-chengyang.com.tw

TEST DATA

DIMENSION&ELECTRIC CHARACTER

CUSTOMER:		PART NO.:	
DESCRIPTION:	SMD INDUCTOR	SERIES NO:	BC43-100K

1.MECHANICAL DIMENSION

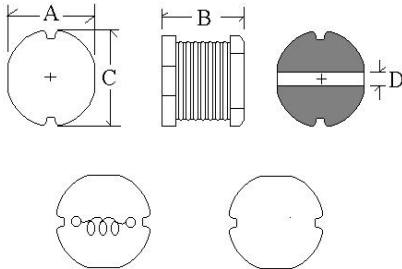

UNIT:mm

A	4.3MAX
B	3.5MAX
C	4.8MAX
D	1.2TYP
E	
F	
G	
H	
I	

2.RECOMMEND LAND PATTERN DIMENSIONS

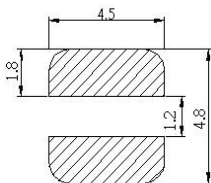

3.SPECIFICATIONS

Part Number	L(0A) Inductance 10(uH) \pm 10% @2.52MHZ	R _{dc} (mOHM)		Heat Rating Current DC Amps.Idc(A)	Saturation Current DC Amps.Idc(A)
		Typical	Max		
BC43-100K	10	149.53	182	1.25	1.15

- (1). All test data is referenced to 25°C ambient.
- (2). Operating Temperature Rangr-30°C to +100°C.
- (3). DC current(1.25A)that will cause an approximate Δ T of 40°C.
- (4). DC current(1.15A)that will cause Lo to drop approximately 10%.
- (5). The part temperature(ambient+temp rise)should not exceed 100°C under worst case operating conditions.Circuit design,component placement,PWB trace size and thickness,airflow and other coating provisions all affcet the part temperature part temperature should be verified in the end appliation.

4.PACKAGING INFORMATION

parts are packaged on 13"reels

1500 parts per reel.

A0= 4.2mm

B0= 4.8mm

K0= 3.6mm

APPROVED BY:

CHECKED BY: Yasir

DRAWN BY: chenlinli

ZHUHAI BAOCHENG ELECTRONICS CO.,LTD

TEST DATA FOR PREPRODUCTION SAMPLE

CUSTOMER:			CUSTOMER P/N:				CUSTOMER REV:			TEST DATE:2018-6-11	
PART NAME: SMD INDUCTOR			CY PART NO:BC43-100K				CY REV:			QUANTITY:20PCS	
TEST ITEM	A	B	C	D	E	F	G	H	I	J	K
SPEC.	4.30	3.50	4.80								
	MAX	MAX	MAX								
01	4.08	3.20	4.26								
02	4.08	3.18	4.27								
03	4.07	3.17	4.28								
04	4.08	3.18	4.28								
05	4.08	3.21	4.27								
06	4.06	3.19	4.28								
07	4.07	3.18	4.27								
08	4.07	3.17	4.27								
09	4.07	3.19	4.28								
10	4.09	3.17	4.28								
11	4.06	3.19	4.28								
12	4.07	3.18	4.27								
13	4.07	3.17	4.27								
14	4.07	3.19	4.28								
15	4.09	3.17	4.28								
X	4.07	3.18	4.27								
σ	0.009	0.012	0.006								
Cpk	8.57	8.95	28.32								
APPROVED BY				CHECKED BY				PREPARED BY			
				Yasir				chenlinli			

ZHUHAI BAOCHENG ELECTRONICS CO.,LTD

TEST DATA FOR PREPRODUCTION SAMPLE

CUSTOMER:		CUSTOMER P/N:		CUSTOMER REV:		TEST DATE:2018-6-11	
PART NAME:SMD INDUCTOR		CY PART NO:BC43-100K		CY REV:		QUANTITY:20PCS	
TEST ITEM	L(0A)	L(1.15A)/L(0A)· 100%	DCR(S-F)				
TEST CONDITION	2.52MHZ 0.25V						
SPEC.	10uH ±10%	≥90% AT DC 1.15A	182mΩ MAX				
01	9.78	99%	146.95				
02	9.76	98%	146.71				
03	9.81	98%	147.47				
04	9.71	97%	146.07				
05	9.72	98%	148.99				
06	9.74	98%	153.79				
07	9.88	98%	151.20				
08	9.76	98%	148.28				
09	9.78	98%	152.40				
10	9.87	98%	150.51				
11	9.74	98%	152.26				
12	9.80	98%	148.54				
13	9.75	98%	154.08				
14	9.80	98%	147.55				
15	9.88	98%	148.21				
\bar{X}	9.79		149.53				
σ	0.053		2.551				
Cpk	4.90		4.24				

1. TEST INSTRUMENTS:

- HP-4284A METER
 HP-4285A METER
 HP-4191A METER
 CH-3200 METER
 CH-310 METER
 CH-3305 METER
 CD1068+CD1320 METER
 VR116+VR7220 METER
 WK3260B+WK3265B METER
 VR562 METER
 CH-502B DCR METER

CORE: DR4.5*3.2R B:2.1 F:1.5 DL5
WIRE: 0.18mm*22.5TS(REF)

APPROVED BY	CHECKED BY	PREPARED BY
		chenlinli

2.CONDITION

TEMPERATURE: 25 °C
HUMIDITY: 65%RH

ELECTRONICS CHARACTER TEST CHART

CUSTOMER:		CUSTOMER P/N:	TEST DATE:2018-6-11
PART NAME:	SMD INDUCTOR	CY P/N:BC43-100K	SAMPLE CO:

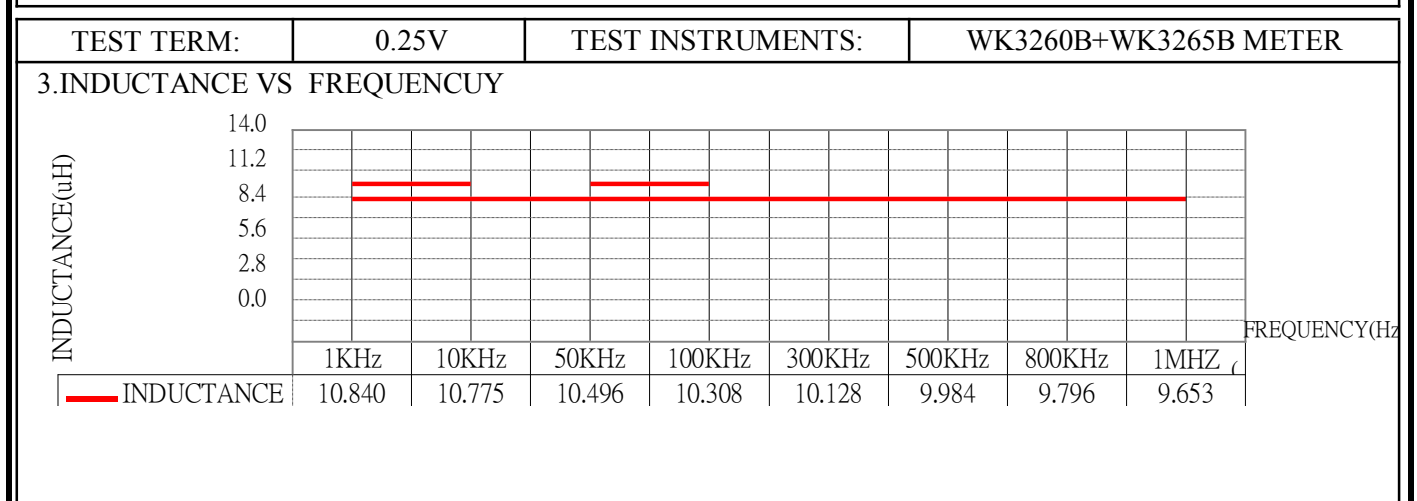
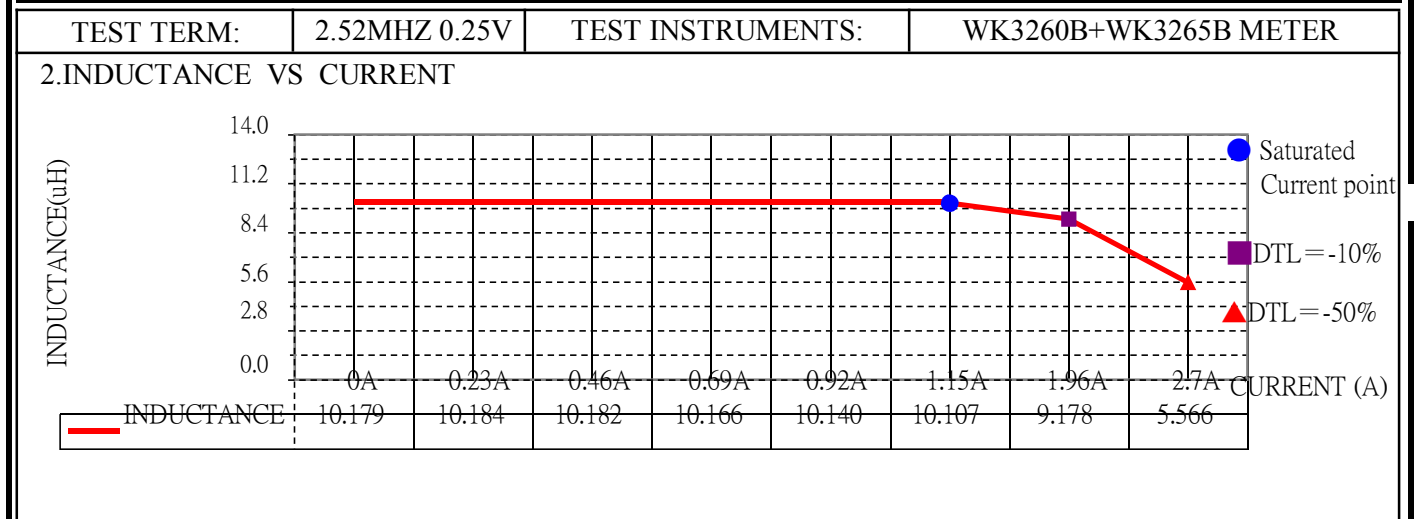
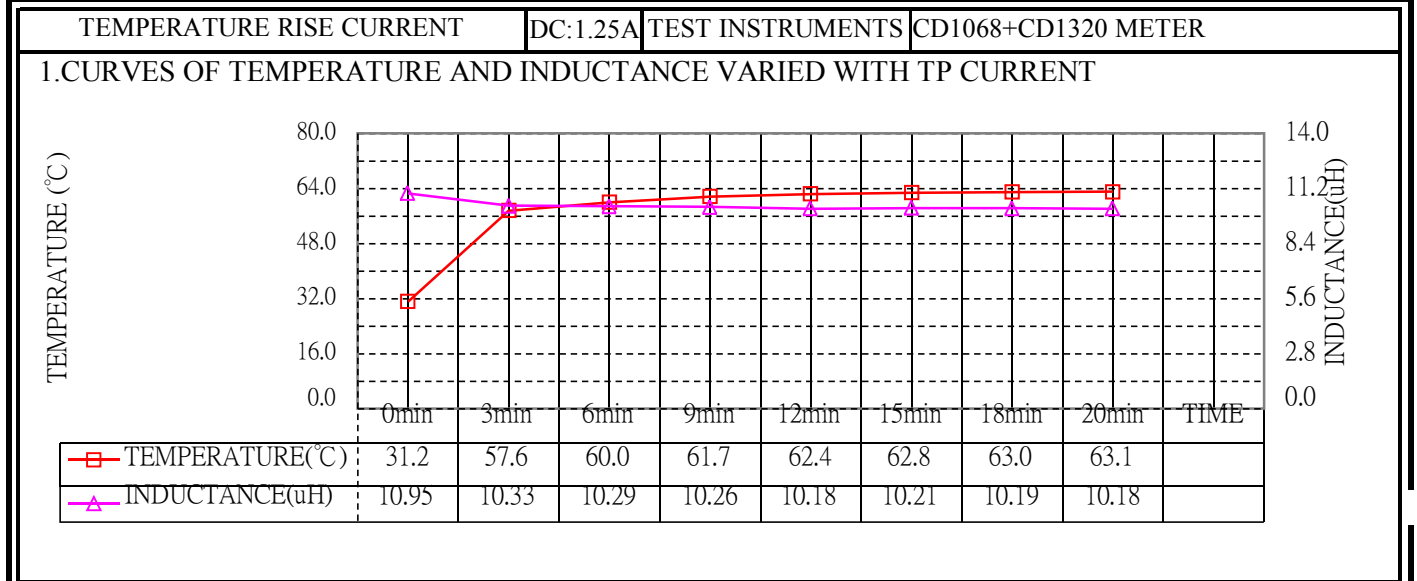

1.TEST CONDITION
 TEMPERATURE: 25°C
 HUMIDITY: ≅ 65% RH

APPROVED BY	CHECKED BY	PREPARED BY
		chenlinli

X-ON Electronics

Largest Supplier of Electrical and Electronic Components

Click to view similar products for [Fixed Inductors](#) category:

Click to view products by [Bao Cheng](#) manufacturer:

Other Similar products are found below :

[CR32NP-100KC](#) [CR32NP-151KC](#) [CR32NP-180KC](#) [CR32NP-181KC](#) [CR32NP-1R5MC](#) [CR32NP-390KC](#) [CR32NP-3R9MC](#) [CR32NP-680KC](#) [CR32NP-820KC](#) [CR32NP-8R2MC](#) [CR43NP-390KC](#) [CR43NP-560KC](#) [CR43NP-680KC](#) [CR54NP-181KC](#) [CR54NP-470LC](#) [CR54NP-820KC](#) [CR54NP-8R5MC](#) [70F224AI](#) [MGDQ4-00004-P](#) [MHL1ECTTP18NJ](#) [MHQ1005P10NJ](#) [MHQ1005P1N0S](#) [MHQ1005P2N4S](#) [MHQ1005P3N6S](#) [MHQ1005P5N1S](#) [MHQ1005P8N2J](#) [PE-51506NL](#) [PE-53601NL](#) [PE-53602NL](#) [PE-53630NL](#) [PE-53824SNLT](#) [PE-92100NL](#) [PG0434.801NLT](#) [PG0936.113NLT](#) [9220-20](#) [9310-16](#) [PM06-2N7](#) [PM06-39NJ](#) [A01TK](#) [1206CS-471XJ](#) [HC2LP-R47-R](#) [HC2-R47-R](#) [HC3-2R2-R](#) [HCF1305-3R3-R](#) [1206CS-151XG](#) [RCH664NP-140L](#) [RCH664NP-4R7M](#) [RCH8011NP-221L](#) [RCP1317NP-332L](#) [RCP1317NP-391L](#)