

AX101047 Modular Connectors - CAT5E Modular Jack - MDVO style

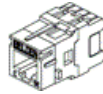

For more Information
please call

1-800-Belden1

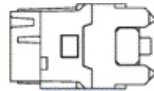

General Description:

CAT5E Modular Jack, RJ45, MDVO style, Black

Usage (Overall)

Suitable Applications:	IBDN System 1200, TIA Category 5E, ISO Class D, 1000 BASE-T
Related Parts:	Compatible with Interface and MDVO Style Faceplates, Adapters, Boxes and Patch Panels

Physical Characteristics (Connectivity)

Dimensions

Dimensions:

Height (in.)	Width (in.)	Depth (in.)
0.765	0.770	1.290

Materials

Materials:

Description	Type	Material
Front Connection	Lead Frame	Copper Allow with 50u inch Gold over Nickel
Rear Connection	IDC	Copper Allow with Nickel Plating
Connector Body		Plastic - UL940V-0

Color

Color: Black

Wiring Scheme

Wiring Scheme: T568A/B

Weight

Weight: 0.014 lbs.

Included Parts

Included Parts: 1 T-Bar + 1 Dust Cap

Packaging

Packaging: Individually packaged in a plastic bag. Standard pack of 50 units.

Mechanical Characteristics (Connectivity)

Footprint/Type: MDVO-Style

Plug / Jack Compatibility: RJ45, RJ11

Termination Interface:

Termination	Connection	Durabilities
Front	Mated Connection	1,000 cycles
Rear	Gas Tight IDC Connection	20 terminations

Connector/Hardware Retention: 20 lbs.

Plug/Connector Retention: 11.250 lbs.

Storage Temperature Range: -40°C To +70°C

Installation Temperature Range: -10°C To +60°C

Operating Temperature Range: -10°C To +60°C

Tool Compatibility: Belden 110 Connecting Tool, MediaFlex Termination Station

Applicable Specifications and Agency Compliance (Overall)

Applicable Standards & Environmental Programs

Other Standards: FCC Part 68, Subpart F, IEC 60603-7

EU Directive 2002/95/EC (RoHS): Yes

EU RoHS Compliance Date (mm/dd/yyyy): 07/01/2006

Mil Order #39 (China RoHS): EUP 50

AX101047 Modular Connectors - CAT5E Modular Jack - MDVO style

Telecommunications Standards:	Category 5e - TIA 568.B.2, Category 5 - ISO/IEC 11801:2002 Ed.2
Third Party Performance Verification:	ETL - Verified Category 5e
Safety Listing:	ACA, Bi-national Standard Listed

Suitability

Suitability - Indoor:	Yes - Indoor
------------------------------	--------------

Transmission Characteristics (Connectivity)

Mated Connection Table 1:

Frequency (MHz)	Max. Insertion Loss TIA* (dB)	Max. Insertion Loss Belden** (dB)	Min. NEXT TIA* (dB)	Min. NEXT Belden** (dB)	Min. FEXT TIA* (dB)	Min. FEXT Belden** (dB)
1.000	0.100	0.100	65.000	77.000	65.000	77.000
4.000	0.100	0.100	65.000	73.800	63.100	74.800
8.000	0.100	0.100	64.900	67.700	57.000	68.700
10.000	0.100	0.100	63.000	65.800	55.100	66.800
16.000	100.000	0.100	58.900	61.700	51.000	62.700
20.000	0.100	0.100	57.000	59.800	49.100	60.800
25.000	0.100	0.100	55.000	57.800	47.100	58.800
31.250	0.110	0.100	53.100	55.900	45.200	56.900
62.500	0.160	0.120	47.100	49.900	39.200	50.900
100.000	0.200	0.160	43.000	45.800	35.100	46.800
160.000		0.210		41.700		42.700

Mated Connection Table - Footnote:

* TIA/EIA-568-C.2 Category 5E Standard.
 ** Worst-case performance for a CAT5E mated connection using CAT5E modular plugs.

Mated Connection Table 2:

Frequency (MHz)	Min. Return Loss TIA* (dB)	Min. Return Loss Belden** (dB)	Min. Balanced TCL Belden** (dB)
1.000	30.000	32.000	42.000
4.000	30.000	32.000	42.000
8.000	30.000	32.000	42.000
10.000	30.000	32.000	42.000
16.000	30.000	32.000	42.000
20.000	30.000	32.000	42.000
25.000	30.000	32.000	42.000
31.250	30.000	32.000	42.000
62.500	24.100	31.100	36.100
100.000	20.000	27.000	32.000
160.000		22.900	27.900

Dielectric Strength:	1,000 V RMS @ 60 Hz for 1 minute
Current Rating:	1.500 A
Insulation Resistance:	500 M-Ohm Minimum
Max. Contact Resistance:	20 m-Ohm
Termination Resistance:	2.5 m-Ohm

Notes (Overall)

Notes: Please see Installation Guide PX103329
Notes (Cont'd.): IDC Wire Gauge: 22-24 AWG

Product Family

Part Number List:

Item Number	Color
AX101044	Gray
AX101045	Almond
AX101046	White
AX101047	Black
AX101048	Orange (TIA 606)
AX101049	Red (TIA 606)
AX101050	Yellow (TIA 606)
AX101051	Green (TIA 606)
AX101052	Blue (TIA 606)
AX101053	Purple (TIA 606)

Put Ups and Colors:

AX101047 Modular Connectors - CAT5E Modular Jack - MDVO style

Item #	Putup	Ship Weight	Color	Notes	Item Desc
AX101047	1 EA	0.024 LB			CAT5E JACK MDVO BLACK

Revision Number: 1 Revision Date: 08-14-2014

© 2017 Belden, Inc.
All Rights Reserved.

Although Belden makes every reasonable effort to ensure their accuracy at the time of this publication, information and specifications described herein are subject to error or omission and to change without notice, and the listing of such information and specifications does not ensure product availability. Belden provides the information and specifications herein on an "AS IS" basis, with no representations or warranties, whether express, statutory or implied. In no event will Belden be liable for any damages (including consequential, indirect, incidental, special, punitive, or exemplary damages) whatsoever, even if Belden has been advised of the possibility of such damages, whether in an action under contract, negligence or any other theory, arising out of or in connection with the use, or inability to use, the information or specifications described herein. All sales of Belden products are subject to Belden's standard terms and conditions of sale. Belden believes this product to be in compliance with EU RoHS (Directive 2002/95/EC, 27-Jan-2003). Material manufactured prior to the compliance date may be in stock at Belden facilities and in our Distributor's inventory. The information provided in this Product Disclosure, and the identification of materials listed as reportable or restricted within the Product Disclosure, is correct to the best of Belden's knowledge, information, and belief at the date of its publication. The information provided in this Product Disclosure is designed only as a general guide for the safe handling, storage, and any other operation of the product itself or the one that it becomes a part of. This Product Disclosure is not to be considered a warranty or quality specification. Regulatory information is for guidance purposes only. Product users are responsible for determining the applicability of legislation and regulations based on their individual usage of the product.

X-ON Electronics

Largest Supplier of Electrical and Electronic Components

Click to view similar products for [Modular Connectors](#) / [Ethernet Connectors](#) category:

Click to view products by [Belden](#) manufacturer:

Other Similar products are found below :

[8949-H88/06BLKA/SN](#) [74441-0010/BKN](#) [MP1010RX-1000](#) [MP44RX-1000](#) [PHJ-4P4C-1-V-4](#) [PHP-6P6C-5](#) [GAX-3-66](#) [GAX-8-62](#) [GDCX-PA-66-50](#) [GDCX-PN-64](#) [GDCX-PN-66](#) [GDCX-PN-66-50](#) [GDLX-A-66](#) [GDLX-N-66](#) [GDLX-S-66](#) [GDLX-S-88K](#) [GDTX-S-88-50](#) [GDX-PA-1010](#) [GLX-N-1010M-BLK](#) [GLX-S-88M-BLK](#) [GMX-N-1010](#) [GMX-S-1010](#) [GMX-S-66](#) [GMX-SMT4-N-88](#) [GPX-2-64](#) [GSGX-N-2-88](#) [GSGX-N-4-88](#) [GSX-NS2-88-3.05](#) [GSX-NS2-88-3.05-50](#) [GSX-NS-88-3.05-50](#) [PT-108A-8C-UL](#) [PT-J951-8C](#) [PTS-J531-8CS-50UL](#) [1-1775629-2](#) [A-2014-0-4](#) [GWLX-S-88-GR](#) [GWLX-S9-88-YG](#) [DC-1021-8-WH-6](#) [1300530003](#) [1324640-4](#) [RJ11FTVC2G](#) [RJ11FTVC2N](#) [RJFTVX2SA1G](#) [132764-001](#) [1413235](#) [MP88X-1000](#) [MPS88RX-5000](#) [E5288-S000K3-L](#) [E5908-15A242-L](#) [155302-001](#)