

PART NUMBER	ATTENUATION	ITEM ①	ITEM ②	ITEM ③	ITEM ④	ITEM ⑤	ITEM ⑥	ITEM ⑦	ITEM ⑧
X-DB		BODY	CONTACT JACK	INSULATOR 2X	CONTACT PLUG	ATTENUATOR	COURING NUT	RETENTION SPRING	SHOCK RUBBER
141-3901-802	2	PASSIVATED	GOLD PL. 00003 MM OVER	TEFLON	GOLD PL. 00003 MM OVER	ALUMINUM SUBSTRATE	STAINLESS STEEL	UNPLATED	SILICONE RUBBER
141-3901-803	3		COPPER PL. 00002 MM		COPPER PL. 00002 MM				
141-3901-804	4								
141-3901-805	6								
141-3901-806	6								
141-3901-807	7								
141-3901-808	8								
141-3901-809	8								
141-3901-810	10								

*Thick film
oxide
(Red Ox)*

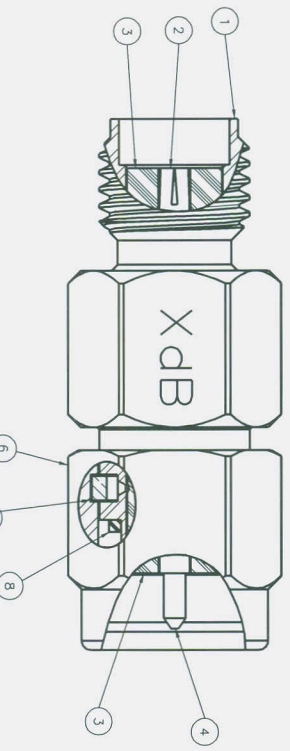
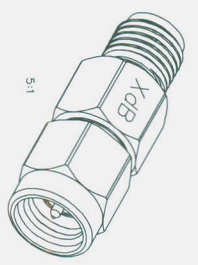
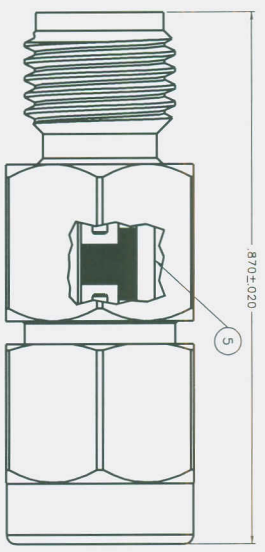
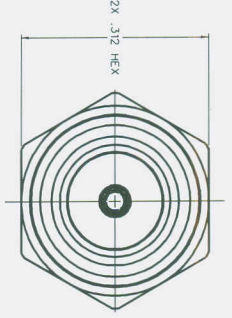

NOTES:

1. SPECIFICATIONS

ELECTRICAL

METHOD: 50 OHMS NOMINAL

ATTENUATION ACCURACY: ±0.5 DB

Attenuation	OC - 4 GHz	4.6 GHz
1.3	±0.3	±0.5
4.6	±0.4	±0.5
7.0	±0.5	±0.5

VSWR MAX:

Attenuation	OC - 2.3 GHz	2.5-4 GHz	4.6 GHz
1.3	1.151	1.201	1.251
4.6	1.151	1.201	1.251
7.0	1.151	1.201	1.251

AVERAGE INPUT POWER: 2W MAX AT +25°C
 DEGRADED LINEARITY TO 0.5W MAX AT +125°C

Mechanical:

MATING ENGAGEMENT: MIL-STD-348A, SERIES SMA

ENGAGE/DISENGAGE FORCE: 2 N (LBS) MAX

REPEATING ENGAGEMENTS: 1000

CORROSION RESISTANCE: 1000 HRS

COURING NUT RETENTION: 60 LBS MIN

COMPLIANT: 500 G/1000 MS

ENVIRONMENTAL:

TEMPERATURE: -55°C TO +125°C

SHOCK: MIL-STD-202, METHOD 204, CONDITION B

THERMAL SHOCK: MIL-STD-202, METHOD 207, CONDITION B

VIBRATION: MIL-STD-202, METHOD 204, CONDITION D

DESIGNED BY	DATE	5-9-08
CHECKED BY	DATE	5-27-08
APPROVED BY	DATE	5-27-08
RELEASE DATE	SCALE	1:1
DWG NO	SCALE	1:1
REV	DATE	DESCRIPTION
1	5-23-08	141-3901-801/810

CINCH CONDUCTIVITY SOLUTIONS
 1800 247 6295
 WISCONSIN, WI 53093

COMPANY CONFIDENTIAL

CUSTOMER DRAWING

THIS DRAWING TO BE INTERPRETED PER CODE 14-3M - 894

"LASTATION"

X-ON Electronics

Largest Supplier of Electrical and Electronic Components

Click to view similar products for [Attenuators - Interconnects](#) category:

Click to view products by [Bel Fuse](#) manufacturer:

Other Similar products are found below :

[R411803119](#) [R413806115](#) [R413808000](#) [R413810115](#) [R413850115](#) [R414510000](#) [R414701000](#) [R415303000](#) [BNC-13](#) [R411800121](#)
[R411801121](#) [R412412124](#) [R412450000](#) [R413800000](#) [R413805000](#) [R413830000](#) [R413840115](#) [R414730000](#) [R415420000](#) [R415703000](#)
[R416010000](#) [R420003110](#) [R411801000](#) [R411815121](#) [R413305000](#) [R413801000](#) [R414520000](#) [R411808121](#) [R412500124](#) [R412414124](#)
[R412501124](#) [R413802000](#) [R412400124](#) [R411700124](#) [R417310130](#) [R411801119](#) [R412419124](#) [R411703124](#) [R412401124](#) [R443131000](#)
[R417130110](#) [R414700000](#) [R414505000](#) [R411802119](#) [R417720128](#) [R420706110](#) [R413811000](#) [R413803115](#) [R414501000](#) [R417903128](#)