

ITEM NUMBER	ATTENUATION	ITEM ①	ITEM ②	ITEM ③	ITEM ④	ITEM ⑤	ITEM ⑥	ITEM ⑦	ITEM ⑧
1	X-DB	BODY	CONTACT JACK	INSULATOR 2X	CONTACT PLUG	ATTENUATOR	COURING NUT	RETENTION SPRING	SHOCK RUBBER
141-3901-802	2	PASSIVATED	GOLD PL. 00003 MM OVER	TEFLON	GOLD PL. 00003 MM OVER	ALUMINUM SUBSTRATE	STAINLESS STEEL	UPRATED	SILICONE RUBBER
141-3901-803	3		COPPER PL. 00002 MM		COPPER PL. 00002 MM				
141-3901-804	4								
141-3901-805	6								
141-3901-807	7								
141-3901-808	8								
141-3901-810	10								

*Thick film  
oxide  
(Red Ox)*

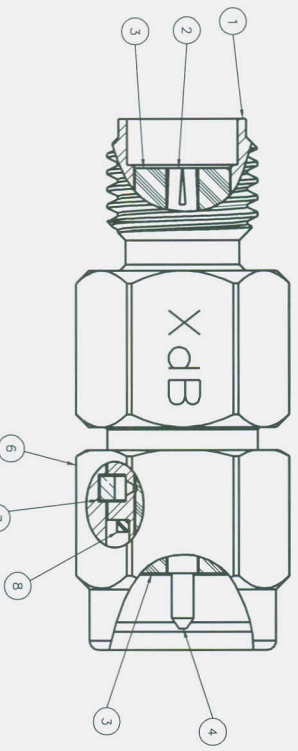
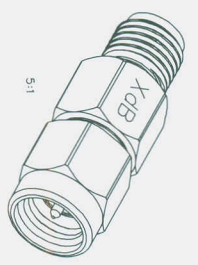
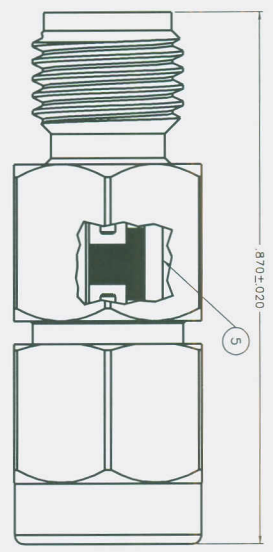
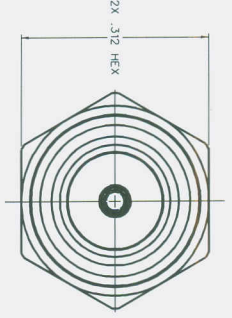

ATTENUATION	ITEM ①	ITEM ②	ITEM ③	ITEM ④
1-3	20.5	20.5	20.5	20.5
4-6	20.4	20.4	20.5	20.5
7-10	20.5	20.5	20.5	20.5

VSWR MAX:

AVERAGE INPUT POWER: 2W MAX AT +25°C  
DEGRADED LINEARLY TO 0.5W MAX AT +125°C

MECHANICAL:  
MATING ENGAGEMENT: MIL-STD-348A, SERIES SMA  
MATING DISMOUNTING FORCE: 2 N-LBS MAX  
MATING TORQUE: 1.5 N-LBS IN  
COURING NUT RETENTION: 60 LBS MIN  
DOWNTURN: 500 OUNCES MIN  
ENVIRONMENTAL:  
TEMPERATURE: -55°C TO +125°C  
SHOCK: MIL-STD-202, METHOD 1000, 1000 CI  
VIBRATION: MIL-STD-202, METHOD 204, CONDITION D

NOTES:  
1. SPECIFICATIONS  
ELECTRICAL:  
MEDIAN: 50 OHMS NOMINAL  
RETURN LOSS: 20 DB MIN  
ATTENUATION ACCURACY:  
±0.5 DB

REVISION	DATE	BY	CHKD	APP'D
0	5-27-08	DR	JMK	
1	5-27-08	DR	JMK	

**cinch**  
CONNECTION SYSTEMS  
WISCONSIN  
1800 247 6295

CUSTOMER DRAWING  
THIS DRAWING TO BE INTERFERED  
PER CODE Y 4.5.3M - 8948  
"L" STATION "

COMPANY CONFIDENTIAL  
SMA 6 GHz ATTENUATOR,  
PLUG & JACK  
-14 1-3901-801/810

## X-ON Electronics

Largest Supplier of Electrical and Electronic Components

*Click to view similar products for [Attenuators - Interconnects](#) category:*

*Click to view products by [Bel Fuse](#) manufacturer:*

Other Similar products are found below :

[R411803119](#) [R413806115](#) [R413808000](#) [R413810115](#) [R413850115](#) [R414510000](#) [R414701000](#) [R415303000](#) [BNC-13](#) [R411800121](#)  
[R411801121](#) [R412412124](#) [R412450000](#) [R413800000](#) [R413805000](#) [R413830000](#) [R413840115](#) [R414730000](#) [R415420000](#) [R415703000](#)  
[R416010000](#) [R420003110](#) [R411801000](#) [R411815121](#) [R413305000](#) [R413801000](#) [R414520000](#) [R411808121](#) [R412500124](#) [R412414124](#)  
[R412501124](#) [R413802000](#) [R412400124](#) [R411700124](#) [R417310130](#) [R411801119](#) [R412419124](#) [R411703124](#) [R412401124](#) [R443131000](#)  
[R417130110](#) [R414700000](#) [R414505000](#) [R411802119](#) [R417720128](#) [R420706110](#) [R413811000](#) [R413803115](#) [R414501000](#) [R417903128](#)