

5

4

3

2

1

DRAWING NO. <b>27-8471-CUST</b>	
REVISIONS	
01	OFFICIAL RELEASE
	03-11-09 J J W T Thomas s Chow



Description: Adapter assembly, isolated dual BNC chassis MT  
 Part No: 27-8471  
 Application: Adapter  
 Crimp Tool: N/A  
 Impedance: 50 Ohms  
 Frequency Range: 0-4 GHz  
 Material: Body Zinc Nickel plated  
 Contact Beryllium Gold plated  
 Insulator Delrin  
 Mounting nut Brass Nickel plated  
 Washer Steel Nickel plated  
 Gasket Delrin  
 RoHS Compliance: Yes  
 Technical Detail: Refer to Emerson Document P/N 27-0000

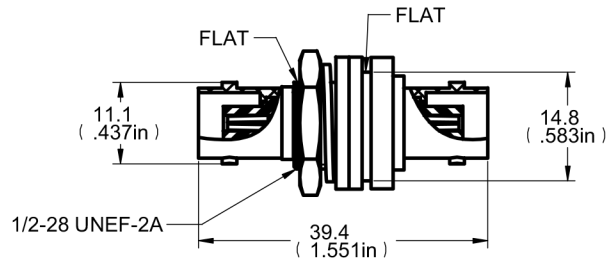
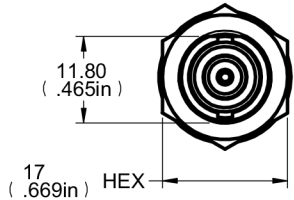

**DIM OUTLINE**

**CUSTOMER COPY**



TOLERANCE UNLESS OTHERWISE SPECIFIED		DRAWN BY <b>JEAN.JIN</b>	DATE 03-11-09
DECIMALS	mm	CHECKED BY <b>TERRY.W</b>	DATE 03-11-09
X	± 0.5	APPROVED BY <b>THOMAS</b>	DATE 03-12-09
X.X	± 0.3	U/M	mm
X.XX	± 0.1		
ANGLES	± 0.5°		

TITLE  
**ADAPTER ASSEMBLY,  
 ISOLATED DUAL BNC CHASSIS MT**

受控 CONTROLLED DOCUMENT					
编号 P/N	27-8471-CUST	版本 Rev	01	日期 Rel'd Date	Apr29,09

THIS DRAWING WAS PRODUCED BY COMPUTER,  
 DO NOT SCALE DRAWING OR UPDATE MANUALLY.

SHEET	DRAWING NO.	SIZE
1 OF 1	<b>27-8471-CUST</b>	<b>A</b>

5

4

3

2

1

## X-ON Electronics

Largest Supplier of Electrical and Electronic Components

*Click to view similar products for [RF Adapters - In Series](#) category:*

*Click to view products by [Bel Fuse](#) manufacturer:*

Other Similar products are found below :

[5916-1103-603](#) [5919-1503-000](#) [5919-9503-000](#) [651A505](#) [82-5552](#) [9030-9523-502](#) [PN2C](#) [A0407000](#) [R114703000W](#) [R125771001](#)  
[R127871001](#) [R141710000W](#) [R141723161](#) [R141730000](#) [R143730700](#) [R143770000](#) [R161703000W](#) [R161753000W](#) [R161791530W](#)  
[R201705000](#) [R222705200](#) [R222M40010W](#) [R223703180](#) [R316754000](#) [R405006000](#) [R443162000](#) [AD78TL](#) [HRM-513S](#) [1996352-2](#)  
[2157155-1](#) [252169-75](#) [AD158](#) [2101130-1](#) [252186](#) [R114704000W](#) [R114720000W](#) [R125705001](#) [R125705701](#) [R125771000](#) [R125771001W](#)  
[R127704001](#) [R127.870.001](#) [R127872001](#) [R141717000](#) [R142710000](#) [R142723000](#) [R143703000](#) [R143704000](#) [R143705700](#) [R143710000](#)