

PART NUMBER	ITEM ① BODY	ITEM ② CONTACT	ITEM ③ INSULATOR	ITEM ④ CRIMP SLEEVE	ITEM ⑤ CUPLING NUT
27-9208	BRASS NICKEL PLATED	BRASS GOLD PLATED	DELTRIN	BRASS NICKEL PLATED	BRASS NICKEL PLATED

<b>受控 CONTROLLED DOCUMENT</b>					
编号 P/N	27-9208	版本 Rev	0B	日期 Rel'd Date	Mar 24,08

DRAWING NO. 27-9208					
REVISIONS					
A	RELEASE FOR QUTATION				
	12-06-05	Y	U	W	T
B	RELAX CONTACT RESISTANCE ADD NOTES 4 & 5				
	09-14-07	Z	W	T	<i>[Signature]</i>

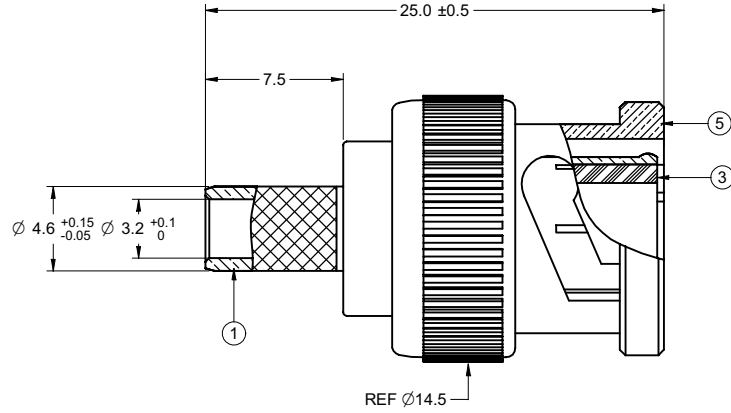
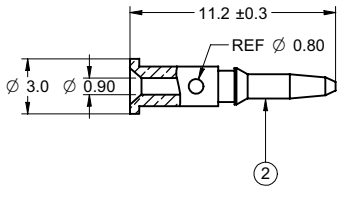
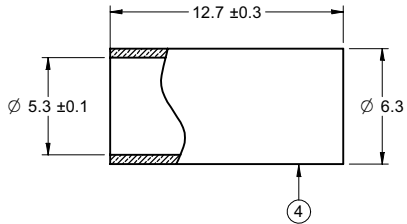

NOTES:

- ELECTRICAL SPECIFICATIONS**  
 IMPEDANCE: 50 OHMS NOMINAL  
 FREQUENCY RANGE: 0-4 GHz  
 WORKING VOLTAGE: 500 Vrms MAX AT SEA LEVEL  
 DIELECTRIC WITHSTANDING VOLTAGE: 1500 vrms AT SEA LEVEL  
 CORONA LEVEL: 375 VOLTS MINIMUM AT 70,000 FEET  
 CONTACT RESISTANCE: OUTER - NICKEL PLATED INITIAL 2.5 MILLIOHMS MAXIMUM  
 AFTER ENVIRONMENTAL 3.5 MILLIOHMS MAXIMUM  
 CENTER - INITIAL 3 MILLIOHMS MAXIMUM  
 AFTER ENVIRONMENTAL 4 MILLIOHMS MAXIMUM  
 BRAID TO BODY - 2.5 MILLIOHMS MAXIMUM (NICKEL PLATED),  
 AFTER ENVIRONMENTAL NOT APPLICABLE  
 INSULATION RESISTANCE: 5000 MEGOHMS MINIMUM
- MECHANICAL SPECIFICATIONS**  
 DURABILITY: 500 CYCLES MIN  
 CABLE ACCEPTABILITY: RG58 THIN NET, BELDEN 9907  
 CABLE RETENTION: 20 lbs MIN  
 THE MATERIAL OF CRIMP SLEEVE SHALL HAVE A MAXIMUM HARDNESS OF 85 VICKERS.
- ENVIRONMENTAL SPECIFICATIONS**  
 RECOMMENDED TEMPERATURE RANGE: -55 °C TO +85 °C  
 MOISTURE RESISTANCE: MIL-STD-202
- PRODUCT SHOULD BE RoHS COMPLIANCE.
- PACKAGING REQUIREMENT FOLLOWS ENGINEER DOCUMENT P/N 836-40200001XX

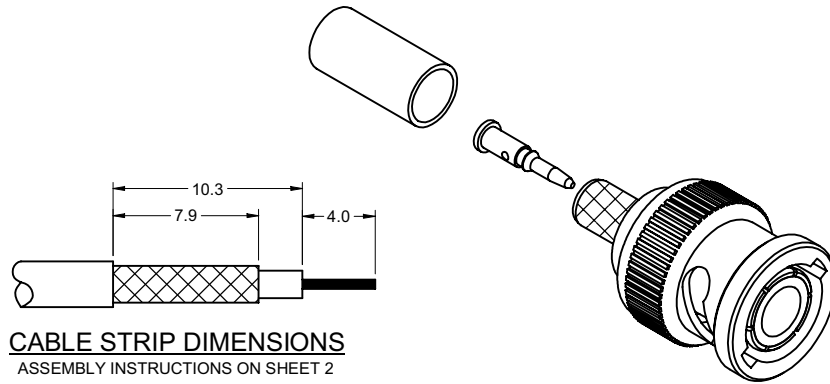

**CABLE STRIP DIMENSIONS**  
ASSEMBLY INSTRUCTIONS ON SHEET 2

THIS DRAWING TO BE INTERPRETED  
PER ANSI Y 14.5M - 1994

**COMPANY CONFIDENTIAL**

TOLERANCE UNLESS OTHERWISE SPECIFIED		DRAWN BY GARY.ZHG	DATE 09-14-07
DECIMALS	mm	CHECKED BY LINDA.WU	DATE 09-14-07
X	± 0.5	APPROVED BY THOMAS	DATE 10-14-07
X.X	± 0.2	U/M	mm
X.XX	± 0.1		
ANGLES	± 0.5°		

<b>EMERSON</b> Network Power		<b>Connectivity Solutions</b>	
TITLE BNC MALE CRIMP FOR RG58 THIN NET			
SHEET 1 OF 2	DRAWING NO. 27-9208	SIZE C	

THIS DRAWING WAS PRODUCED BY COMPUTER,  
DO NOT SCALE DRAWING OR UPDATE MANUALLY.

PART NUMBER	CABLE	CRIMP SLEEVE HEX SIZE	CRIMP CONTACT HEX SIZE	RECOMMENDED CRIMP TOOL
27-9208	RG58 THIN NET BELDEN 9907	5.41	1.70	24-9958P

<b>受控 CONTROLLED DOCUMENT</b>					
编号 P/N	27-9208	版本 Rev	0B	日期 Rel'd Date	Mar 24,08

DRAWING NO. 27-9208	
REVISIONS	
A	RELEASE FOR QUOTATION
	12-06-05 Y U W T
VERSION UPDATE	
B	09-14-07 Z W T

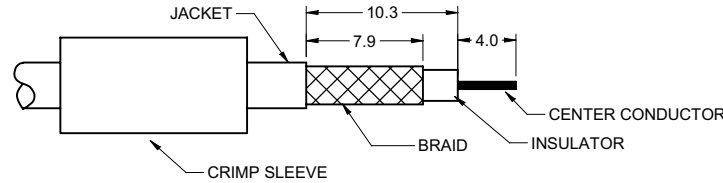
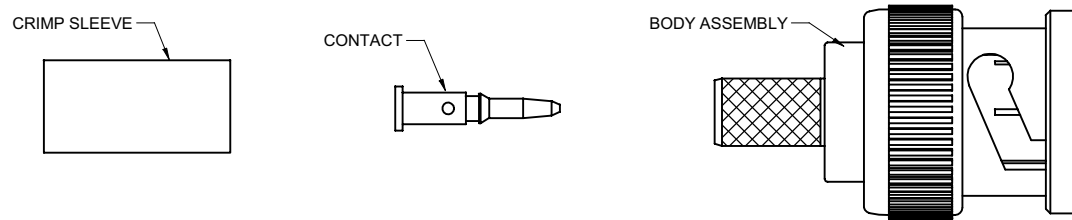

### ASSEMBLY INSTRUCTIONS

1. IDENTIFY CONNECTOR PARTS. (3 PIECE PARTS.)
2. TRIM CABLE AS SHOWN. TAKING CARE NOT TO NICK THE INNER CONDUCTOR OR BRAID.
3. SLIP CRIMP SLEEVE OVER CABLE. PLACE INNER CONDUCTOR INTO CONTACT. NOTE THAT THE END OF CONTACT AND INNER INSULATOR MUST BE BUTTING AND SQUARE. CRIMP WITH APPROPRIATE TOOLING.
4. FLAIR OUTER BRAID AND GENTLY BUT FIRMLY PUSH THE CONTACT INTO THE CONNECTOR HOUSING UNTIL A GENTLE SNAP IS FELT, INDICATING THE CONTACT IS IN PLACE. SLIP THE CRIMP SLEEVE IN PLACE, BUTTING THE FLANGE AGAINST THE CONNECTOR BODY AND CRIMP WITH APPROPRIATE TOOLING.

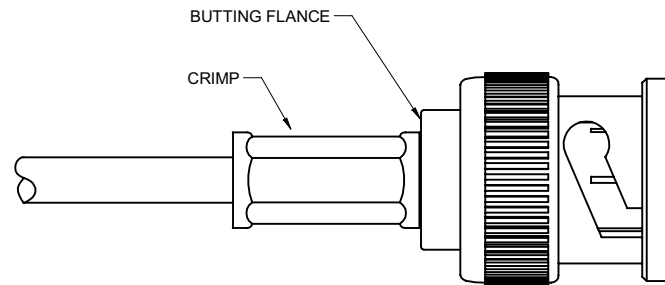
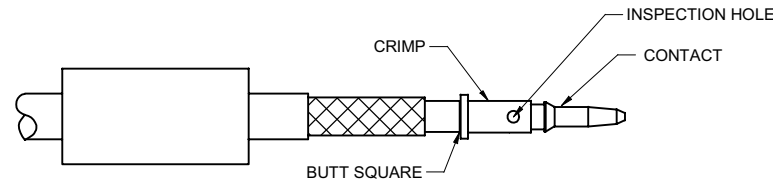

THIS DRAWING TO BE INTERPRETED  
PER ANSI Y 14.5M - 1994

**COMPANY CONFIDENTIAL**

TOLERANCE UNLESS OTHERWISE SPECIFIED		DRAWN BY GARY.ZHG	DATE 09-14-07
DECIMALS	mm	CHECKED BY LINDA.WU	DATE 09-14-07
X	± 0.5	APPROVED BY THOMAS	DATE 10-14-07
X.X	± 0.2		
X.XX	± 0.1		
ANGLES	± 0.5°	U/M	mm

<b>EMERSON</b> Network Power		<b>Connectivity Solutions</b>	
TITLE BNC MALE CRIMP FOR RG58 THIN NET			

THIS DRAWING WAS PRODUCED BY COMPUTER,  
DO NOT SCALE DRAWING OR UPDATE MANUALLY.

SHEET 2 OF 2	DRAWING NO. 27-9208	SIZE C
-----------------	------------------------	-----------

## X-ON Electronics

Largest Supplier of Electrical and Electronic Components

*Click to view similar products for [RF Connectors / Coaxial Connectors](#) category:*

*Click to view products by [Bel Fuse](#) manufacturer:*

Other Similar products are found below :

[8915-1511-000](#) [89674-0827](#) [6001-7071-019](#) [6002-7051-003](#) [6002-7551-202](#) [6059674-1](#) [619550-1](#) [630059-000](#) [M39030/3-01N](#) [6500-7071-046](#) [6769](#) [CX050L2AQ](#) [7002-1541-010](#) [7002-1542-011](#) [7004-1512-000](#) [7009-1511-004](#) [7010-1511-000](#) [7029-1511-060](#) [7101-1541-010](#) [7101-1571-002](#) [7145-1521-002](#) [7203-1571-003](#) [7209-1511-011](#) [7210-1511-015](#) [7210-1511-019](#) [73137-5015](#) [73216-2241](#) [73404-2300](#) [7405-1521-005](#) [7405-1521-802](#) [8527](#) [8547](#) [FS11V](#) [877931](#) [9049-9513-000](#) [9074-9513-000](#) [9101-9573-002](#) [910A205F](#) [9130-9573-002](#) [PL11SC-026](#) [PL375-33](#) [PL40-5](#) [PL74C-221](#) [PL75MC-217](#) [PL803-7](#) [980-8666-005](#) [1200690078](#) [1-201144-1](#) [R107003010W](#) [R110A172100](#)