

5

4

3

2

1

| 受控 CONTROLLED DOCUMENT | | | | | |
|------------------------|--------------|-----------|----|------------------|-----------|
| 编号 P/N | 28-5022-CUST | 版本 Rev | 01 | 日期 Rel'd Date | SEP 17,09 |

DRAWING NO.
28-5022

REVISIONS

| | | | | | |
|----|------------------|---|---|---|-------------------------------|
| 01 | OFFICIAL RELEASE | | | | 2009.09.1 |
| | 08-05-09 | I | W | T | H <i>Betty</i> + 08'00' |

D



Description: SMA Crimp Plug RG55,142,223,400
 Part No: 28-5022
 Application: RG55,142,223,400
 Crimp Tool: 24-328P
 Impedance: 50Ohm
 Frequency Range: 0-12.4 GHz
 Material: Body Brass Nickel Plated
 Nut Brass Nickel Plated
 Insulator PTFE
 Contact Brass Gold Plated
 Sleeve Brass Nickel Plated

RoHS Compliance: Yes
 Technical Detail: N/A

C

B

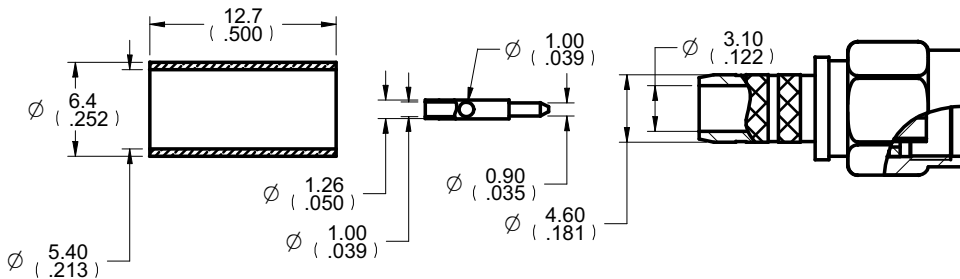

DIM OUTLINE

A

CUSTOMER COPY

| | | | |
|--------------------------------------|--------|-----------------------|------------------|
| TOLERANCE UNLESS OTHERWISE SPECIFIED | | DRAWN BY IVON.W | DATE 08-05-09 |
| DECIMALS | mm | CHECKED BY IVON.W | DATE 08-05-09 |
| X | ± 0.5 | APPROVED BY THOMAS | DATE 08-05-09 |
| X.X | ± 0.3 | U/M | mm |
| X.XX | ± 0.1 | | |
| ANGLES | ± 0.5° | | |

| | | |
|--------------------------------|------------------------|------------------------|
| | | Connectivity Solutions |
| TITLE | | |
| SMA CRMP PLUG RG55,142,223,400 | | |
| SHEET 1 OF 1 | DRAWING NO. 28-5022 | SIZE A |

THIS DRAWING WAS PRODUCED BY COMPUTER,
DO NOT SCALE DRAWING OR UPDATE MANUALLY.

5

4

3

2

1

D

C

B

A

X-ON Electronics

Largest Supplier of Electrical and Electronic Components

Click to view similar products for [RF Connectors / Coaxial Connectors](#) category:

Click to view products by [Bel Fuse](#) manufacturer:

Other Similar products are found below :

[8915-1511-000](#) [89674-0827](#) [6001-7071-019](#) [6002-7051-003](#) [6002-7551-202](#) [6059674-1](#) [619550-1](#) [630059-000](#) [M39030/3-01N](#) [6500-7071-046](#) [6769](#) [CX050L2AQ](#) [7002-1541-010](#) [7002-1542-011](#) [7004-1512-000](#) [7009-1511-004](#) [7010-1511-000](#) [7029-1511-060](#) [7101-1541-010](#) [7101-1571-002](#) [7145-1521-002](#) [7203-1571-003](#) [7209-1511-011](#) [7210-1511-015](#) [7210-1511-019](#) [73137-5015](#) [73216-2241](#) [73404-2300](#) [7405-1521-005](#) [7405-1521-802](#) [8527](#) [8547](#) [FS11V](#) [877931](#) [8808-1511-001](#) [9049-9513-000](#) [9074-9513-000](#) [9101-9573-002](#) [910A205F](#) [9130-9573-002](#) [PL11SC-026](#) [PL375-33](#) [PL40-5](#) [PL74C-221](#) [PL75MC-217](#) [PL803-7](#) [980-8666-005](#) [1200690078](#) [1-201144-1](#) [R107003010W](#)