

5

4

3

2

1

DRAWING NO. 32-6001C-CUST			
<b>REVISIONS</b>			
01	ENGINEERING RELEASE		
	03-12-2013	T T	L M

D

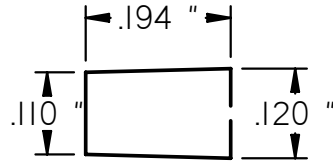
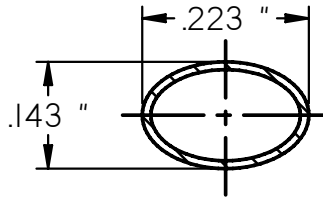

Description: B-Wire Connector; Splices 17 AWG bare wire and 22 AWG Insulated wire

Part No: 32-6001C

Material: Insulation-PVC  
Outer shell-Soft Metal Alloy  
Piercing Teeth- Plated Phosphor-bronze

C

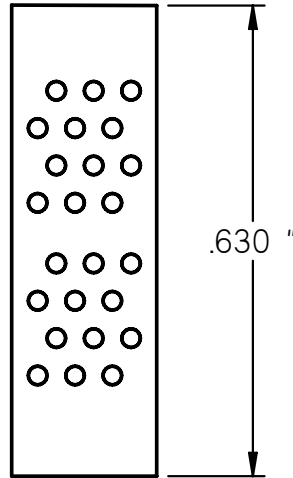
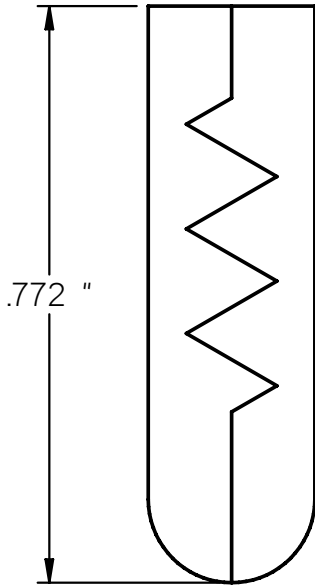

B

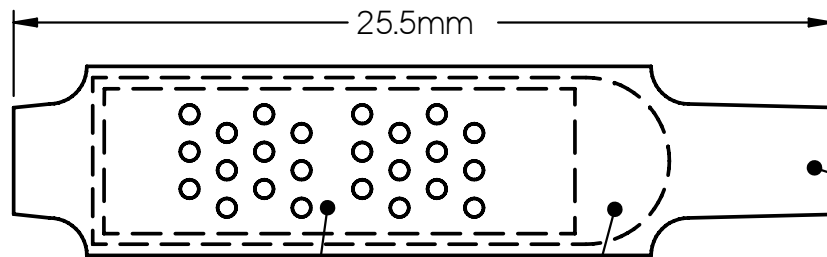

PVC TUBING

A

CONNECTION INSERT

OUTER SHELL

**CUSTOMER COPY**

TOLERANCE UNLESS OTHERWISE SPECIFIED		DRAWN BY <b>TONY. T</b>	DATE 03-12-13
DECIMALS	mm	CHECKED BY <b>TONY. T</b>	DATE 03-12-13
X	+ 0.5	APPROVED BY <b>LIN. M</b>	DATE 03-12-13
X.X	+ 0.3	U/M	mm
X.XX	+ 0.1		
ANGLES	+ 0.5°		

		<b>Connectivity Solutions</b>	
TITLE B-Wire Connector; Splices 17 AWG bare wire and 22 AWG Insulated wire			
SHEET 1 OF 1	DRAWING NO. 32-6001C-CUST	SIZE A	

THIS DRAWING WAS PRODUCED BY COMPUTER,  
DO NOT SCALE DRAWING OR UPDATE MANUALLY.

5

4

3

2

1

## X-ON Electronics

Largest Supplier of Electrical and Electronic Components

*Click to view similar products for [D-Sub Tools & Hardware](#) category:*

*Click to view products by [Bel Fuse](#) manufacturer:*

Other Similar products are found below :

[000-01-09-132](#) [000-01-21-132](#) [000-01-31-162](#) [572019-00105-70](#) [000-01-37-162](#) [621-250-113-115](#) [D110550-2](#) [D20418-137](#) [780-518-50SG6-WS](#) [86552009](#) [86553115TLF](#) [86553117TLF](#) [1230032-1](#) [1-5021101-2](#) [1589283-4](#) [160-000-005R031](#) [16-000230](#) [160-025-004R031](#) [160-000-137R000](#) [160-020-209R000](#) [164C03939A](#) [177-505-A-2-2](#) [1-966830-8](#) [21018-6](#) [21028-2](#) [2-1393560-9](#) [JS-1000](#) [L17D204182M3E](#) [L17D53018](#) [300X10779X](#) [160X10189X](#) [160X10419X](#) [160X10959X](#) [162-000-050R000](#) [21018-5](#) [212561-3](#) [248C21550X](#) [CF15P](#) [QLOCKPOST-2](#) [D110277](#) [500-008NF1K-01](#) [500-008NF3R3KS-01](#) [500-017M09FN](#) [500-017M15MHN](#) [500-024M1](#) [500-068M3](#) [5-1393561-5](#) [C115373-0001](#) [C115373-0002](#) [3342-4-KIT](#)