

5

4

3

2

1

受控 CONTROLLED DOCUMENT

编号 P/N	40-98442F/-C	版本 Rev	02	日期 Rel'd Date	Aug9,11
-----------	--------------	-----------	----	------------------	---------

Description: F SCREW LOCKS, .50" (1SET)
 Part No: 40-98442F
 Application: D-Sub Hardware
 Crimp Tool: N/A
 Impedance: N/A
 Frequency Range: N/A
 Material: Nut Brass Nickel Plated
 Washer Brass Nickel Plated
 Washer Brass Nickel Plated
 Bolt Brass Nickel Plated
 RoHS Compliance: Yes
 Technical Detail: N/A



DRAWING NO. 40-98442F/ -C	
REVISIONS	
01	OFFICIAL RELEASE 08-05-09 L W T H
	CHANGE DIMENSION 7.00 TO 12.00 07-01-11 L H M <i>Li Ma</i> 07/01/11

D

D

C

C

B

B

A

A

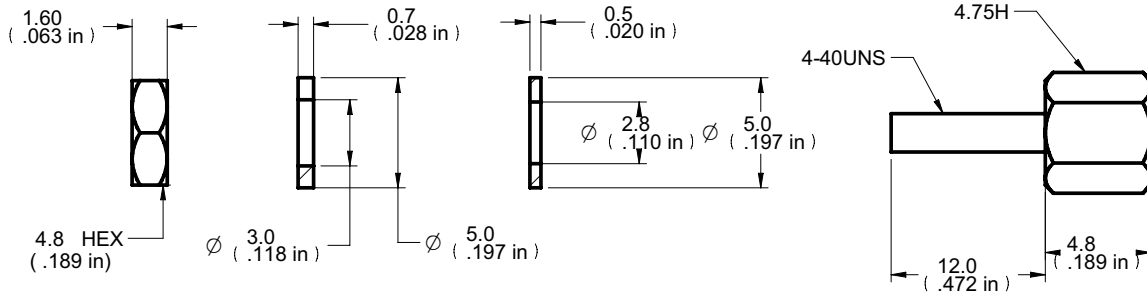

DIM OUTLINE

40-98442F-C	F SCREW LOCKS,.50"(50 SET)
40-98442F	F SCREW LOCKS,.50"(1 SET)

TOLERANCE UNLESS OTHERWISE SPECIFIED		DRAWN BY Wencan Li	DATE 07-01-11
DECIMALS	mm	CHECKED BY Hu Yuge	DATE 07-01-11
X	± 0.5	APPROVED BY Ma Lin	DATE 07-01-11
X.X	± 0.3	U/M	mm
X.XX	± 0.1		
ANGLES	± 0.5°		



TITLE F SCREW LOCKS, .50"		
SHEET 1 OF 1	DRAWING NO. 40-98442F/ -C	SIZE A

THIS DRAWING WAS PRODUCED BY COMPUTER, DO NOT SCALE DRAWING OR UPDATE MANUALLY.

5

4

3

2

1

X-ON Electronics

Largest Supplier of Electrical and Electronic Components

Click to view similar products for [D-Sub Tools & Hardware](#) category:

Click to view products by [Bel Fuse](#) manufacturer:

Other Similar products are found below :

[000-01-09-132](#) [000-01-21-132](#) [000-01-31-162](#) [572019-00105-70](#) [000-01-37-162](#) [621-250-113-115](#) [D110550-2](#) [D20418-137](#) [780-518-50SG6-WS](#) [86552009](#) [86553115TLF](#) [86553117TLF](#) [1230032-1](#) [1-5021101-2](#) [1589283-4](#) [160-000-005R031](#) [16-000230](#) [160-025-004R031](#) [160-000-137R000](#) [160-020-209R000](#) [164C03939A](#) [177-505-A-2-2](#) [1-966830-8](#) [21018-6](#) [21028-2](#) [2-1393560-9](#) [JS-1000](#) [L17D204182M3E](#) [L17D53018](#) [300X10779X](#) [160X10189X](#) [160X10419X](#) [160X10959X](#) [162-000-050R000](#) [21018-5](#) [212561-3](#) [248C21550X](#) [CF15P](#) [QLOCKPOST-2](#) [D110277](#) [500-008NF1K-01](#) [500-008NF3R3KS-01](#) [500-017M09FN](#) [500-017M15MHN](#) [500-024M1](#) [500-068M3](#) [5-1393561-5](#) [C115373-0001](#) [C115373-0002](#) [3342-4-KIT](#)