

DRAWING REVISIONS  
(RELEASE DATE ON FILE)

REV	DOCUMENT	APP	APPROVAL DATE
E	CO 3274	V.RICE	7/18/16

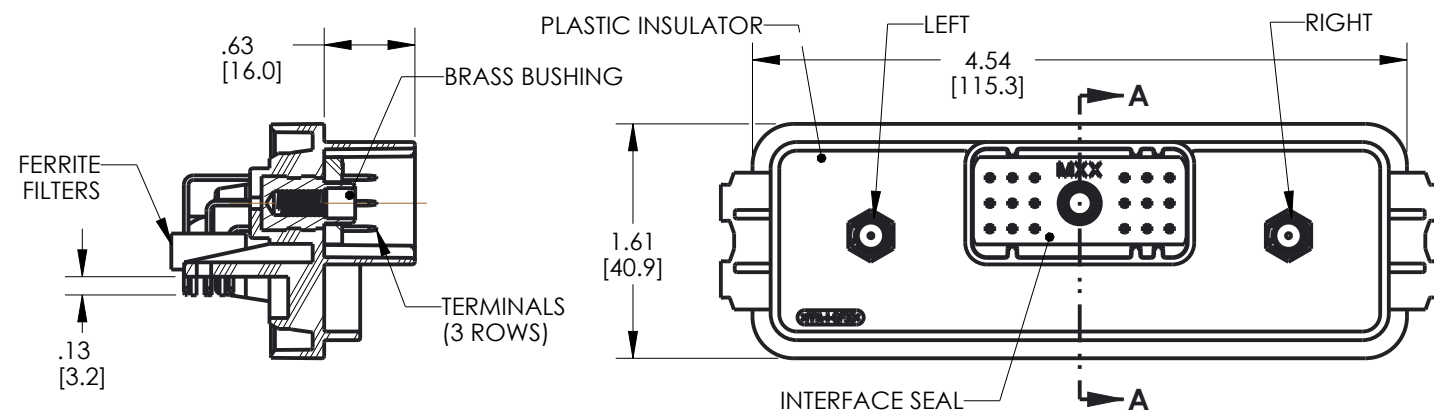

SECTION A-A  
SCALE 3:4

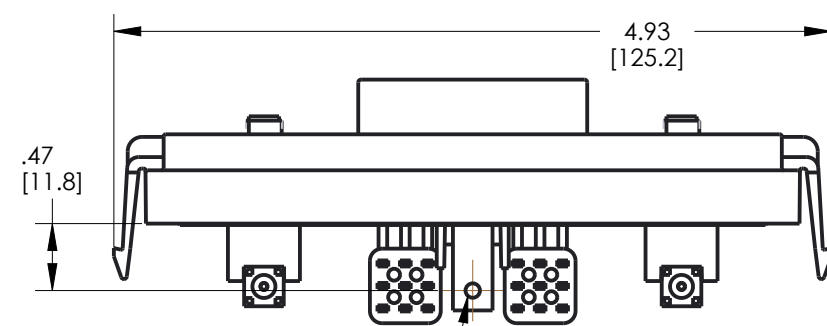
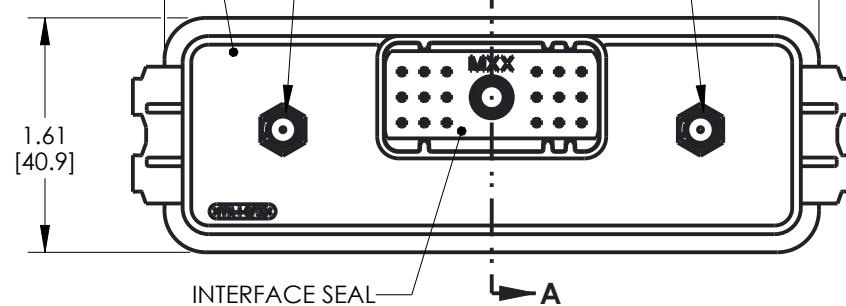

**CINCH P/N: 5810618002 SHOWN  
(18 POS HEADER WITH FILTERS)**

RP SMA = REVERSE POLARITY SMA SMA = STANDARD POLARITY SMA LEFT RIGHT	HEADER	I/O	FERRITE	LEFT RF	RIGHT RF
	5810618001	18	NO	RP SMA	SMA
	5810618002	18	YES	RP SMA	SMA
	5810618003	18	NO	N/A	SMA
	5810618004	18	YES	N/A	SMA
	5810618005	18	NO	RP SMA	N/A
	5810618006	18	YES	RP SMA	N/A
	5810618007	18	NO	RP SMA	RP SMA
	5810618008	18	YES	RP SMA	RP SMA
	5810618009	18	NO	SMA	SMA
	5810618010	18	YES	SMA	SMA

NOTES:

- ALL DIMENSIONS ARE REFERENCE ONLY. DIMENSIONS ARE IN INCHES; [BRACKETED DIMENSIONS ARE IN mm]
- MATERIALS:  
INSULATOR: 30% GLASS FILLED POLYMER, COLOR BLACK  
SMA: BODY: BRASS, NICKEL PLATED  
CONTACT: PHOSPHOR BRONZE, GOLD PLATING OVER NICKEL  
INSULATOR: PTFE  
INTERFACE SEAL: SILICONE RUBBER, COLOR BLUE  
INSULATOR: 30% GLASS FILLED POLYMER, COLOR BLACK  
BUSHING: BRASS ALLOY, UNPLATED, 10-24 UNC THREAD  
TERMINAL BLADES: 1.5 mm BRASS WITH TIN OVER NICKEL PLATING  
FILTERS: FERRITE BLOCKS
- ALL HEADERS ARE REFLOW OR WAVE SOLDERING PROCESS COMPATIBLE, AND ROHS COMPLIANT
- SUGGESTED PCB THICKNESS: .062 [1.57]
- IF USING FERRITE FILTER VERSION, TRACES SHOULD BE AVOIDED UNDER THE FERRITE SPACER FEET. SEE "PCB TOP SIDE PIN AREA WITH FERRITES DETAIL" - PAGE 2.
- MATES WITH CINCH SHS PUSH-TO-SEAT HARNESS CONNECTOR P/N: 5810118023
- TORQUE SCREW OF MATING CONNECTOR TO 15 - 20 in-lbs [1.69 - 2.26 Nm]

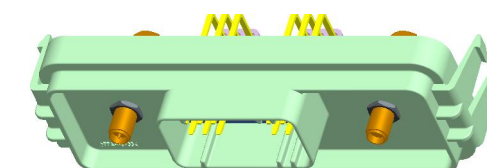

SCALE 1:2

MODELED BY:  
V. RICE

UNITS		PRO/E		CINCH	
ENGLISH INCHES		PRO/E		1700 FINLEY RD LOMBARD, IL 60148	
DO NOT SCALE DRAWING		DESIGN ENGINEER V. RICE	DATE 5/16/12	TITLE MODICE ME-RF 18-WAY / SMA HEADER ASSEMBLY	
CONFIDENTIAL THIS DOCUMENT IS THE PROPERTY OF CINCH. NEITHER THIS DOCUMENT NOR ANY OF THE INFORMATION CONTAINED IN IT MAY BE DUPLICATED OR DISCLOSED WITHOUT PRIOR WRITTEN CONSENT OF CINCH. ©COPYRIGHT 2009 CINCH		APPROVALS ON FILE		MATERIAL SEE NOTES	
				CONTROL SPEC NUMBER	
				PROJECT NUMBER A15085	
				DRAWING NUMBER 5810618001S	
				SIZE 71785 B	
				SCALE 1:1	
				SHEET 1 OF 2	

**RECOMMENDED  
TOP SIDE  
PCB GENERAL  
ZONING AND KEEP-OUT AREAS**

**RECOMMENDED  
BOTTOM SIDE  
PCB GENERAL  
ZONING AND KEEP-OUT AREAS**

**RECOMMENDED  
PCB OVERALL DIMENSIONS  
AND HOLE LOCATIONS**

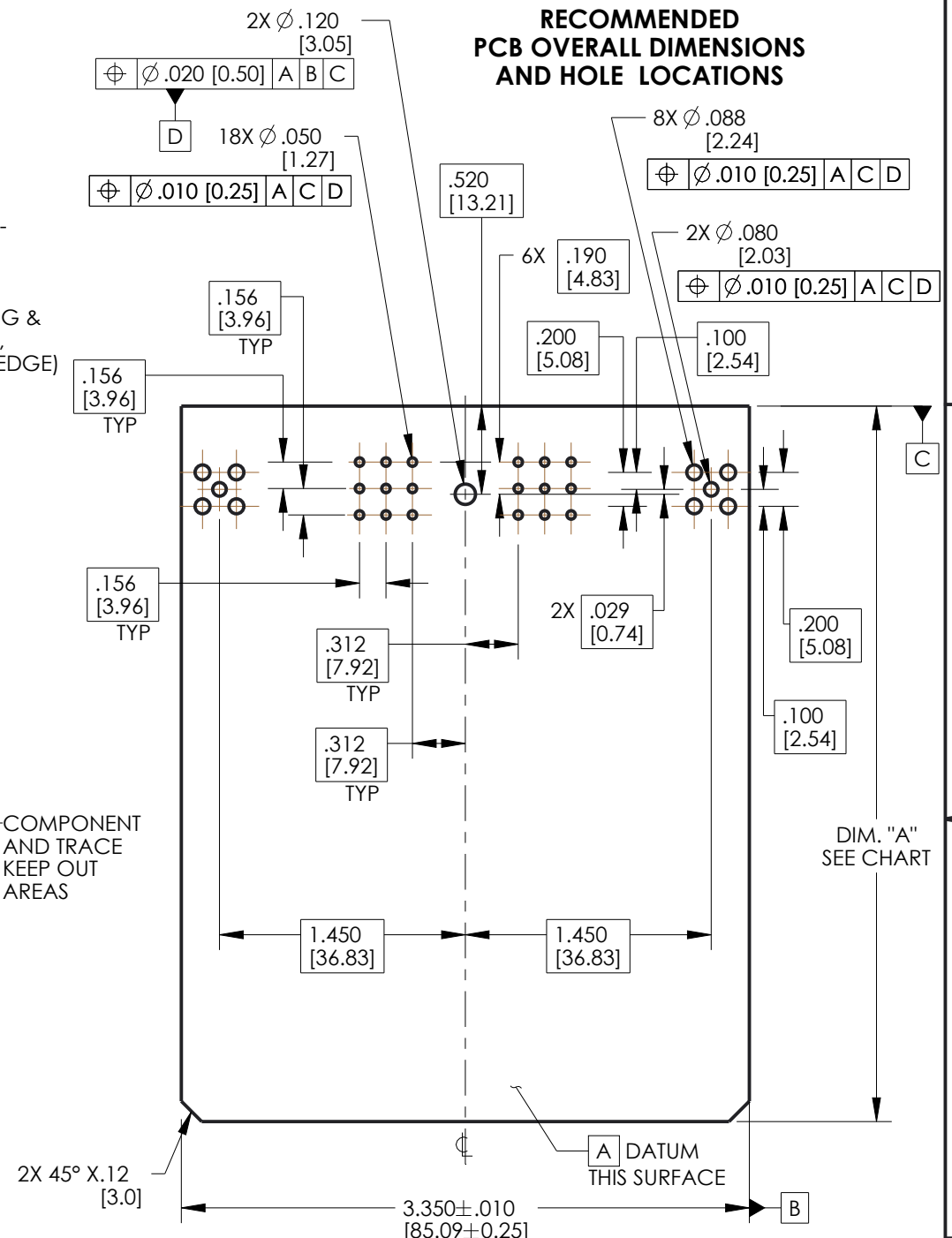
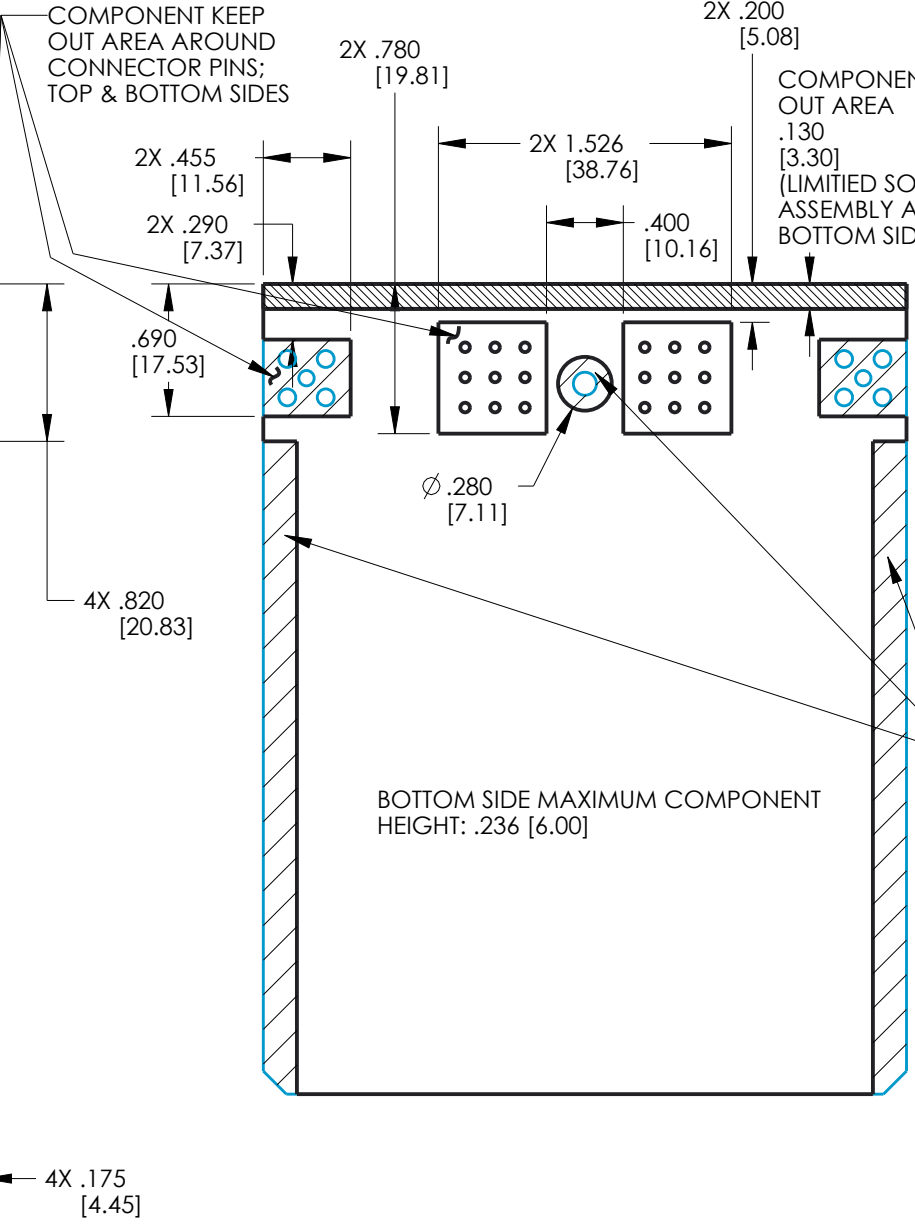
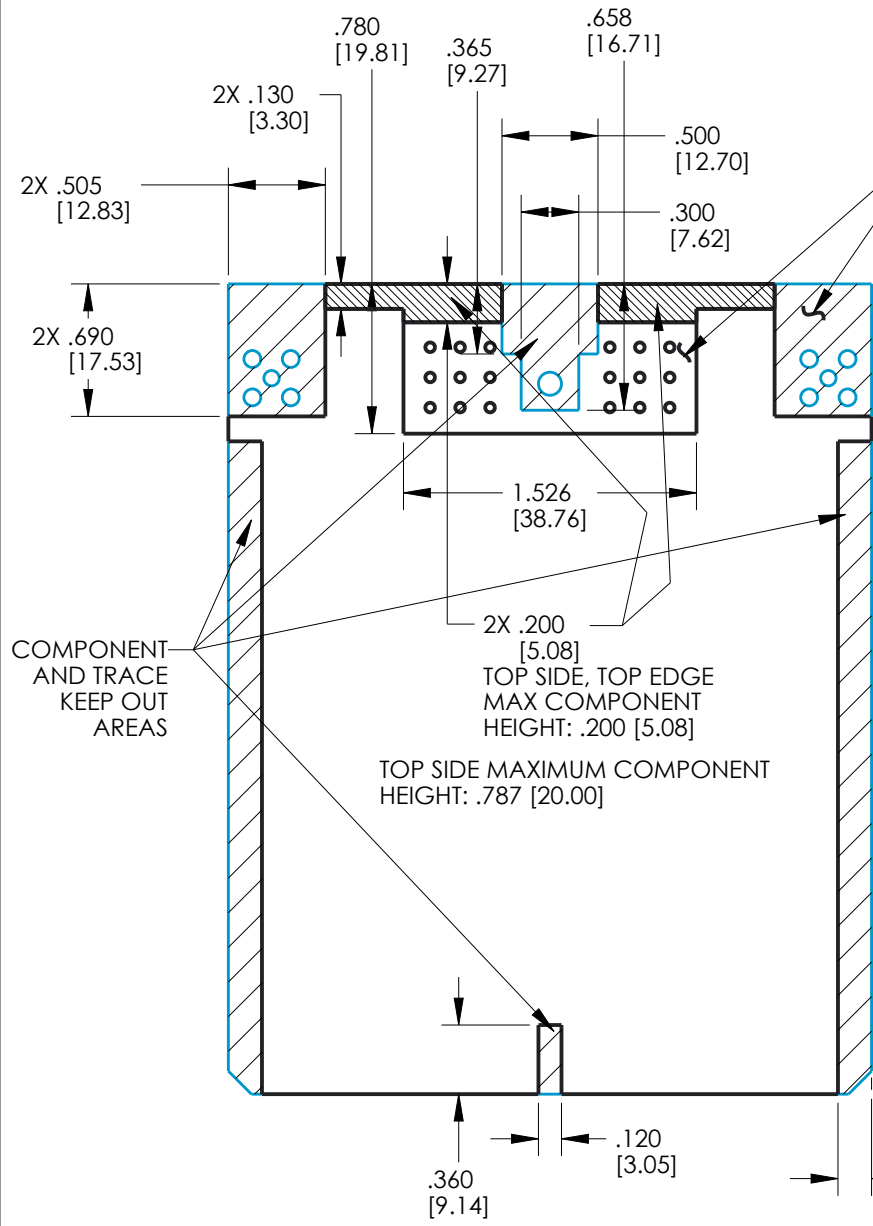

COMPONENT AND TRACE KEEP OUT AREAS

TOP SIDE, TOP EDGE MAX COMPONENT HEIGHT: .200 [5.08]  
TOP SIDE MAXIMUM COMPONENT HEIGHT: .787 [20.00]

BOTTOM SIDE MAXIMUM COMPONENT HEIGHT: .236 [6.00]

COMPONENT AND TRACE KEEP OUT AREAS

DIM. "A" SEE CHART

FERRITE SPACER FEET TRACE KEEP OUT AREAS (8 PLACES) SEE NOTE 5

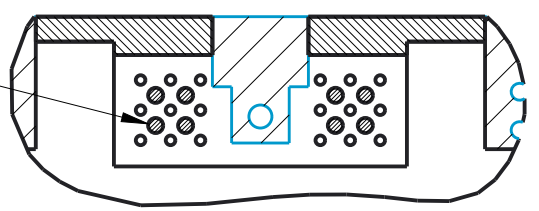

**PCB TOP SIDE PIN AREA WITH FERRITES DETAIL**

**RECOMMENDED PCB LENGTH**

DIM. "A" (SEE DRAWING)	USE WITH ENCLOSURE	
	PART NUMBER	DESCRIPTION
4.220±0.015 [107.19±0.38]	581 01 30 065	ME
	581 01 30 075	ME WITH BREATHER
2.520±0.015 [64.01±0.38]	581 01 30 090	MINI ME
	581 01 30 095	MINI ME WITH BREATHER

UNITS <b>ENGLISH INCHES</b>	<b>CINCH</b>		1700 FINLEY RD LOMBARD, IL. 60148
DO NOT SCALE DRAWING	TITLE MODICE ME-RF 18-WAY / SMA HEADER ASSEMBLY		
<b>PRO/E DRAWING</b>			
CONFIDENTIAL THIS DOCUMENT IS THE PROPERTY OF CINCH. NEITHER THIS DOCUMENT NOR ANY OF THE INFORMATION CONTAINED IN IT MAY BE DUPLICATED OR DISCLOSED WITHOUT PRIOR WRITTEN CONSENT OF CINCH. ©COPYRIGHT 2009 CINCH	CAD FILE NUMBER 5810618001S	DRAWING NUMBER <b>5810618001S</b>	REV E
	CAGE IDENT NO. 71785	SIZE B	SCALE 1:1
		SHEET 2 OF 2	

## X-ON Electronics

Largest Supplier of Electrical and Electronic Components

*Click to view similar products for [Automotive Connectors](#) category:*

*Click to view products by [Bel Fuse](#) manufacturer:*

Other Similar products are found below :

[003-018-000](#) [600858](#) [60403001](#) [60993906-B](#) [60993913-B](#) [629515004020001](#) [M902-2131](#) [M902-2161](#) [M902-2344](#) [72.330.1035.1](#)  
[73.353.4028.0](#) [F118010](#) [F119300-B](#) [F132210](#) [F132210-B](#) [F166900](#) [F180100](#) [F258300](#) [F258300-B](#) [F294300-B](#) [F339100](#) [F339700](#) [F358300-](#)  
[B](#) [F374110](#) [F407400](#) [F412210](#) [F427600](#) [F444110](#) [F487000](#) [F495100-B](#) [F500900-B](#) [F509500B-B](#) [770444-1](#) [776880-1](#) [827153-1](#) [881735-1](#)  
[8N1515-32-24P](#) [9-1326727-8](#) [9-1326729-8](#) [925467-1](#) [925474-1](#) [928905-1](#) [936398-2](#) [964562-1](#) [964562-4](#) [964731-2](#) [965051-1](#) [968782-1](#)  
[GT17SA-8DS-HU](#) [GT17VS-10DP-5.2CF](#)