

NOTES:

1. SPECIFICATIONS:

ELECTRICAL:
 WITHSTANDING VOLTAGE: MINIMUM 1000 V RMS @ SEA LEVEL
 INSULATION RESISTANCE: INITIAL 5000 MEGOHMS MAXIMUM,
 1000 MEGOHMS MIN. AFTER ENVIRONMENTAL TESTING.
 CONTACT RATING: 5 AMPS
 CONTACT RESISTANCE: 2.7 MILLIOHMS MAX.

MATERIALS:
 INSULATOR: BLACK UL94V-0 RATED GLASS FILLED NYLON
 CONTACT(030-1952-000): COPPER ALLOY
 CONTACT AREA PLATING: GOLD OVER NICKEL,
 CONNECTOR SHELL: STEEL, PLATING ZINC WITH CLEAR CHROMATE.

ENVIRONMENTAL:
 OPERATING TEMPERATURE: -65°C TO +125°C

TERMINATION:
 CRIMP WILL ACCOMODATE # 20 TO 28 AWG WIRE.
 TERMINATION-TOOLS:
 CRIMP TOOL: M22520/2-01
 INSERTION/EXTRACTION TOOL: CIET-20-HDB
 POSITIONER: EP-580

2. DIMENSIONS IN [] ARE IN MILLIMETERS.

DRAWING REVISIONS			
REV	DOCUMENT	APP	DATE
A	DO 05-11146	AKB	01/07/06
B	ECN 06E296		

NUMBER OF POSITIONS	SELECTIVE GOLD FLASH PLATING (.120" [3.05] MTG. HOLES)		CONTACTS	DIMENSION									FRONT MOUNTING HOLE DIMENSIONS		REAR MOUNTING HOLE DIMENSIONS					
	PART NO.	FACTORY NO.		"A"	"B"	"C"	"D"	"E"	"F"	"G"	"H"	"J"	"K"	"X"	"Y"	"X"	"Y"			
9	DEUH-9P	702 03 09 001	INCLUDED	1.213 [30.81]	.984 [24.99]	.697 [17.70]	.360 [9.14]		.759 [19.28]									.874 [22.20]	.806 [20.47]	
	DEUH-9P-FO	702 03 09 005	NOT INCLUDED																	
15	DAUH-15P	702 03 15 001	INCLUDED	1.541 [39.14]	1.312 [33.32]	1.025 [26.03]	.494 [12.55]		1.083 [27.51]	.422 [10.72]								.513 [13.03]	1.134 [28.80]	.449 [11.40]
	DAUH-15P-FO	702 03 15 005	NOT INCLUDED																	
25	DBUH-25P	702 03 25 001	INCLUDED	2.088 [53.04]	1.852 [47.04]	1.583 [40.21]	.378 [9.60]		1.629 [41.38]	.422 [10.72]									1.674 [42.52]	
	DBUH-25P-FO	702 03 25 005	NOT INCLUDED																	
37	DCUH-37P	702 03 37 001	INCLUDED	2.729 [69.32]	2.500 [64.50]	2.231 [56.67]	.484 [12.29]	.605 [15.37]	2.272 [57.71]	.534 [13.56]									2.326 [59.08]	
	DCUH-37P-FO	702 03 37 005	NOT INCLUDED																	
50	DDUH-50P	702 03 50 001	INCLUDED	2.635 [66.93]	2.406 [61.11]	2.127 [54.02]	.484 [12.29]	.605 [15.37]	2.178 [55.32]	.534 [13.56]									2.218 [56.34]	.555 [14.10]
	DDUH-50P-FO	702 03 50 005	NOT INCLUDED																	

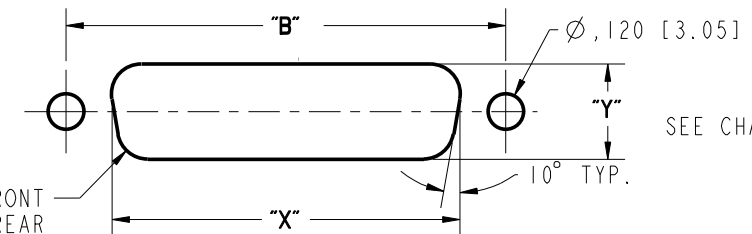

RECOMENDED MTG. HOLE LAYOUT
 SEE CHART FOR FRONT AND REAR MTG. DIMENSIONS

ROHS COMPLIANT

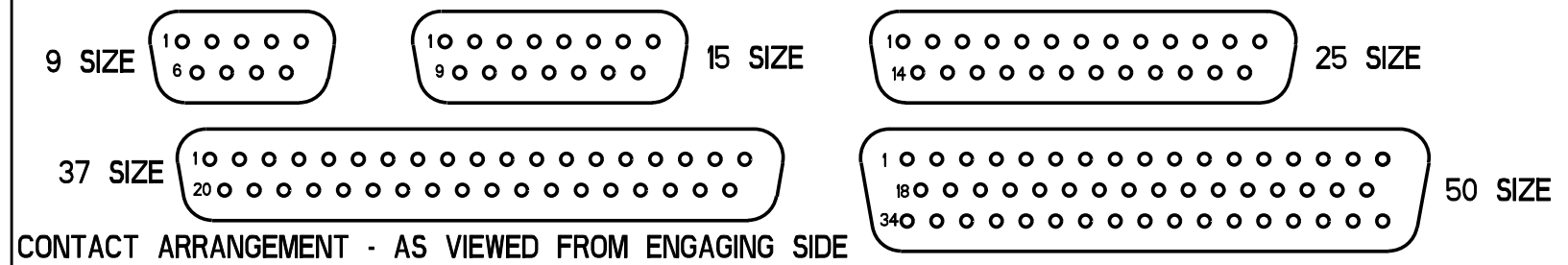

UNITS	ENGLISH	PRO/E	Cinch		MODELED BY: V. SKUZA
DO NOT SCALE DRAWING	DRAWN BY V. SKUZA	DATE 06/17/05	TITLE D*U SERIES CRIMP & POKE CONNECTOR PLUG ASS'Y (.120" HOLES)		1700 FINLEY RD LOMBARD, IL. 60148
	DESIGN ENGINEER A. BALI	06/17/05	MATERIAL		CONTROL SPEC NUMBER
	DESIGN ENGINEERING MGR. A. SHAH	07/09/05	MATERIAL SPEC NUMBER	FINISH	PROJECT NUMBER C14740
	MFG. ENGINEERING J. OCEGUERA	07/07/05	CAD FILE NUMBER DXUHXXP	DRAWING NUMBER D*UH-XXP	
	QUALITY ASSURANCE A. VAZQUEZ	07/06/05	CAGE IDENT NO. / SIZE 71785 B	SCALE 1:1	SHEET 1 OF 1

THIS DOCUMENT IS THE PROPERTY OF CINCH. NEITHER THIS DOCUMENT NOR ANY OF THE INFORMATION CONTAINED IN IT MAY BE DUPLICATED OR DISCLOSED WITHOUT PRIOR WRITTEN CONSENT OF CINCH.

X-ON Electronics

Largest Supplier of Electrical and Electronic Components

Click to view similar products for [D-Sub Standard Connectors](#) category:

Click to view products by [Bel Fuse](#) manufacturer:

Other Similar products are found below :

[56F711-015](#) [012-9507-004](#) [LV242999-142T12](#) [015-0341-000](#) [015-0349-000](#) [015-0372-005](#) [015-0372-008](#) [015-8755-001](#) [020419-0104](#) [012-0467-000](#) [012-0515-000](#) [012-9507-034](#) [012-9507-114](#) [020745-0008](#) [609-25P](#) [M24308/2-23Z](#) [CT2-14S-2PCA34](#) [CT2-18-11PCAU](#) [CT2-36-15SC](#) [CT6-14S-2SC](#) [CT6E14SA7SC](#) [CT6E22-14PC](#) [CT6E22-14PS](#) [CT6E22-22PS](#) [M83513/01-FC](#) [M85049/48-3-2F](#) [6STD09PCM99B70X](#) [6STD09SCM99B30X](#) [6STD09SCT99S40X](#) [6STD15PCT99S40X](#) [6STD15SCM99B30X](#) [6STD15SCT99S40X](#) [6STF09PCM05B70X](#) [7-135760-9](#) [MC11E-10-6SN](#) [747552-3](#) [MD1-21PS](#) [MDM-15SCBRM7-F222](#) [MDM96517-699](#) [MDM96521-744](#) [MDVB1-21SL1](#) [MIK0-1-7SH003](#) [MIKQ6-7SH076](#) [MIKQ7-7PH077](#) [MIKQ7-7PH11](#) [MIKQ7-7PH32](#) [MIKQ9-7PH003](#) [MJSV-28SL61](#) [MKJ4A1F14-55S](#) [8-135760-3](#)