

### 7mm Flange Mount to SMA Male Plug

Model Number

**ADT-2655-7M-SMM-02**

**SPECIFICATIONS**

**Frequency:** DC - 18.0 GHz

**VSWR:** 1.025 + .0025 f (GHz)

**Impedance:** 50 Ohms

**Finish:** Passivated Stainless Steel

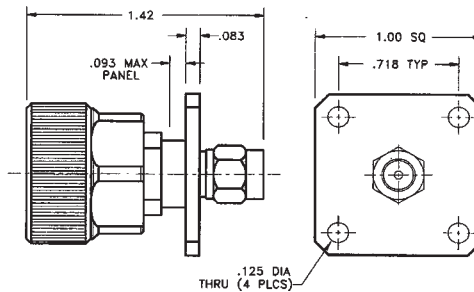

### 7mm Flange Mount to SMA Female Jack

Model Number

**ADT-2653-7M-SMF-02**

**SPECIFICATIONS**

**Frequency:** DC - 18.0 GHz

**VSWR:** 1.025 + .0025 f (GHz)

**Impedance:** 50 Ohms

**Finish:** Passivated Stainless Steel

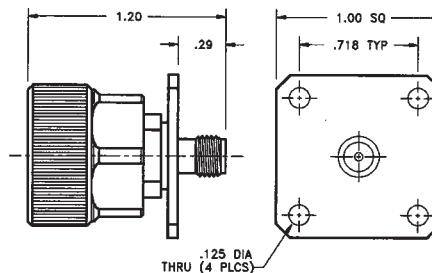

### 7mm to 3.5mm Male Plug

Model Number

**ADT-2701-7M-3MM-02**

**SPECIFICATIONS**

**Frequency:** DC - 18.0 GHz

**VSWR:** 1.025 + .0025 f (GHz)

**Impedance:** 50 Ohms

**Finish:** Passivated Stainless Steel

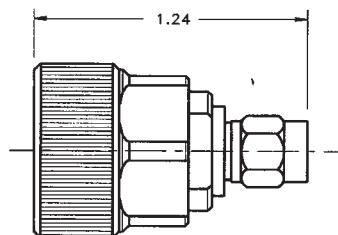

### 7mm to 3.5mm Female Jack

Model Number

**ADT-2702-7M-3MF-02**

**SPECIFICATIONS**

**Frequency:** DC - 18.0 GHz

**VSWR:** 1.025 + .0025 f (GHz)

**Impedance:** 50 Ohms

**Finish:** Passivated Stainless Steel

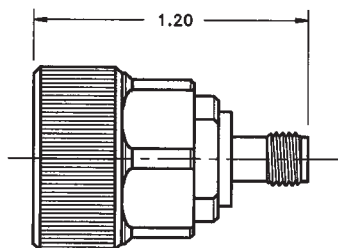

## X-ON Electronics

Largest Supplier of Electrical and Electronic Components

*Click to view similar products for [RF Adapters - Between Series category:](#)*

*Click to view products by [Bel Fuse manufacturer:](#)*

Other Similar products are found below :

[5945-9503-000](#) [MCX/F-SMA/M](#) [R192417010](#) [ADBJ20-E1-BJ379](#) [ADM2](#) [ADPL75-A1-PL75](#) [242191](#) [9317505](#) [29-3835P](#) [AD130](#) [ADBJ20-E1-PL74](#) [ADBJ20-E2-BJ79](#) [ADBJ77-A1-PL375](#) [ADBJ77-E1-UPL20](#) [ADRMF370](#) [242215](#) [242228](#) [R125680000W](#) [R192430000](#) [UAD95](#) [1057367-1](#) [8311505](#) [R114704000](#) [R451034500](#) [R451030500](#) [R451543000](#) [HDVDPN](#) [ADBJ20-K1-PL20](#) [R451570000](#) [R451034000](#) [J9](#) [J3WE-5](#) [R451032500](#) [242201RP](#) [17K132-K00S5](#) [AD-RSMAF-RTNC](#) [53K156-K00N5](#) [02K119-K00E3](#) [29S132-K01N5](#) [53S156-K00N5](#) [02S119-S00E3](#) [28K132-K00N5](#) [02S109-K00S3](#) [27-8200TP](#) [242235](#) [ADBJ20-E1-BJ89](#) [000-2900](#) [321-102-003 \(SMA-50/2-H155/W1.03 AU\)](#) [1057377-1](#) [321-350-001 \(SMA-50-R/2-RG316/N2.01\)](#)