

# Attenuators

## BNC Type

### DC - 4 GHz Performance

**Frequency:** DC - 4.0 GHz and DC - 2.0 units available

**Attenuation Values:** 1 - 40 dB as noted

**Attenuation Accuracy:**

1 - 6 dB	± 0.3 dB
7 - 10 dB	± 0.5 dB
11 - 20 dB	± 0.75 dB
21 - 40 dB	± 1.0 dB
41-60 dB	± 1.5 dB

**Impedance:** 50 Ohms

**VSWR:** 1.25 max

**Power:** 2 Watts average @ +25 °C derated linearly to 0.5 Watts @ +125 °C U.O.S.

**Peak Power:** 200 Watts for 2Watt units and 100 Watts Peak for 5 & 10 Watt

**Operating Temperature Range:** -54C to +125C

**Finish:** Nickel Plated Brass and Black Anodized Aluminum



DC - 4.0 GHz		313 Series	Model Number
Male / Female	Female / Female		Male / Male
<a href="#">ATT-0313-XX-BNC-10</a>	<a href="#">ATT-313F-XX-BNC-10</a>		<a href="#">ATT-313M-XX-BNC-10</a>
Attenuation Value = XX, Select 1 - 60 dB in 1 dB increments			

DC - 2.0 GHz		314 Series	Model Number
Male/Female	Female/Female		Male/Male
<a href="#">ATT-0314-XX-BNC-10</a>	<a href="#">ATT-314F-XX-BNC-10</a>		<a href="#">ATT-314M-XX-BNC-10</a>
Attenuation Value = XX, Select 1 - 60 dB in 1 dB increments			

DC - 4.0 GHz		581 Series	Model Number
Male/Female	Female/Female		Male/Male
<a href="#">ATT-0581-XX-BNC-07</a>	<a href="#">ATT-581F-XX-BNC-07</a>		<a href="#">ATT-581M-XX-BNC-07</a>
Attenuation Value = XX, Select 1 - 60 dB in 1 dB increments			
<b>5 Watts</b>			

DC - 4.0 GHz		582 Series	Model Number
Male/Female	Female/Female		Male/Male
<a href="#">ATT-0582-XX-BNC-07</a>	<a href="#">ATT-582F-XX-BNC-07</a>		<a href="#">ATT-582M-XX-BNC-07</a>
Attenuation Value = XX, Select 1 - 60 dB in 1 dB increments			
<b>10 Watts</b>			

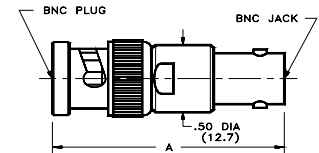

Attenuation Value	Length A
1 - 20 dB	1.36
21 - 60 dB	1.65

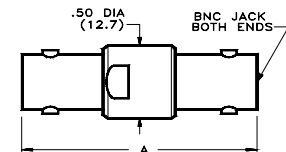

Attenuation Value	Length A
1 - 20 dB	1.43
21 - 60 dB	1.72

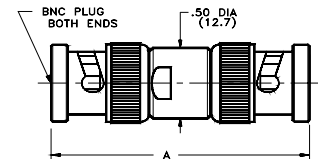

Attenuation Value	Length A
1 - 20 dB	1.55
21 - 60 dB	1.84

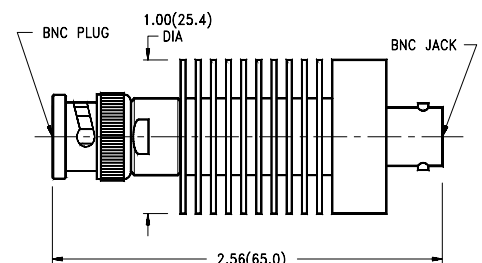
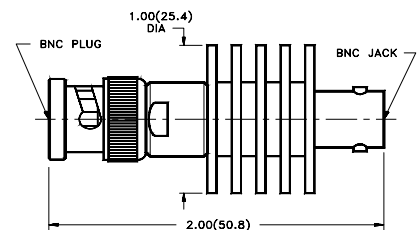

## X-ON Electronics

Largest Supplier of Electrical and Electronic Components

*Click to view similar products for [Attenuators - Interconnects](#) category:*

*Click to view products by [Bel Fuse](#) manufacturer:*

Other Similar products are found below :

[R411803119](#) [R413806115](#) [R413808000](#) [R413810115](#) [R413850115](#) [R414510000](#) [R414701000](#) [R415303000](#) [BNC-13](#) [R411800121](#)  
[R411801121](#) [R412412124](#) [R412450000](#) [R413800000](#) [R413805000](#) [R413830000](#) [R413840115](#) [R414730000](#) [R415420000](#) [R415703000](#)  
[R416010000](#) [R420003110](#) [R411801000](#) [R411815121](#) [R413305000](#) [R413801000](#) [R414520000](#) [R411808121](#) [R412500124](#) [R412414124](#)  
[R412501124](#) [HMC-C584](#) [R413802000](#) [R412400124](#) [R411700124](#) [R417310130](#) [R411801119](#) [R412419124](#) [R411703124](#) [R412401124](#)  
[R443131000](#) [R417130110](#) [R414700000](#) [R414505000](#) [R411802119](#) [R417720128](#) [R420706110](#) [R413811000](#) [R413803115](#) [R414501000](#)