

Attenuators

BNC Type

DC - 4 GHz Performance

Frequency: DC - 4.0 GHz and DC - 2.0 units available

Attenuation Values: 1 - 40 dB as noted

Attenuation Accuracy:

1 - 6 dB	± 0.3 dB
7 - 10 dB	± 0.5 dB
11 - 20 dB	± 0.75 dB
21 - 40 dB	± 1.0 dB
41-60 dB	± 1.5 dB

Impedance: 50 Ohms

VSWR: 1.25 max

Power: 2 Watts average @ +25 °C derated linearly to 0.5 Watts @ +125 °C U.O.S.

Peak Power: 200 Watts for 2Watt units and 100 Watts Peak for 5 & 10 Watt

Operating Temperature Range: -54C to +125C

Finish: Nickel Plated Brass and Black Anodized Aluminum



DC - 4.0 GHz		313 Series	Model Number
Male / Female	Female / Female		Male / Male
ATT-0313-XX-BNC-10	ATT-313F-XX-BNC-10		ATT-313M-XX-BNC-10
Attenuation Value = XX, Select 1 - 60 dB in 1 dB increments			

DC - 2.0 GHz		314 Series	Model Number
Male/Female	Female/Female		Male/Male
ATT-0314-XX-BNC-10	ATT-314F-XX-BNC-10		ATT-314M-XX-BNC-10
Attenuation Value = XX, Select 1 - 60 dB in 1 dB increments			

DC - 4.0 GHz		581 Series	Model Number
Male/Female	Female/Female		Male/Male
ATT-0581-XX-BNC-07	ATT-581F-XX-BNC-07		ATT-581M-XX-BNC-07
Attenuation Value = XX, Select 1 - 60 dB in 1 dB increments			
5 Watts			

DC - 4.0 GHz		582 Series	Model Number
Male/Female	Female/Female		Male/Male
ATT-0582-XX-BNC-07	ATT-582F-XX-BNC-07		ATT-582M-XX-BNC-07
Attenuation Value = XX, Select 1 - 60 dB in 1 dB increments			
10 Watts			

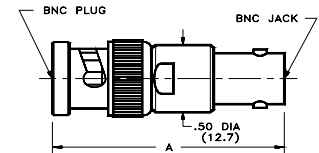

Attenuation Value	Length A
1 - 20 dB	1.36
21 - 60 dB	1.65

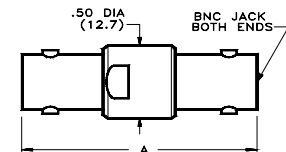

Attenuation Value	Length A
1 - 20 dB	1.43
21 - 60 dB	1.72

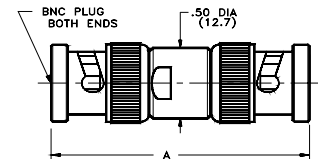

Attenuation Value	Length A
1 - 20 dB	1.55
21 - 60 dB	1.84

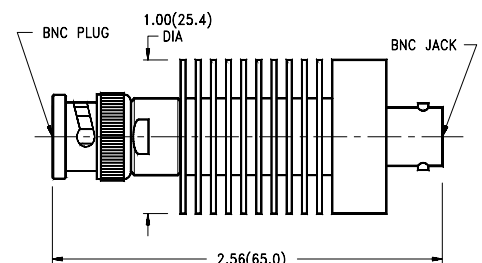
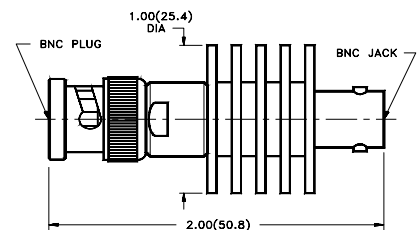

X-ON Electronics

Largest Supplier of Electrical and Electronic Components

Click to view similar products for [Attenuators - Interconnects](#) category:

Click to view products by [Bel Fuse](#) manufacturer:

Other Similar products are found below :

[R411803119](#) [R413806115](#) [R413808000](#) [R413810115](#) [R413850115](#) [R414510000](#) [R414701000](#) [BNC-13](#) [R411800121](#) [R411801121](#)
[R412412124](#) [R412450000](#) [R413800000](#) [R413805000](#) [R413830000](#) [R413840115](#) [R414730000](#) [R415420000](#) [R415703000](#) [R416010000](#)
[R420003110](#) [R411801000](#) [R411815121](#) [R413305000](#) [R413801000](#) [R414520000](#) [R411808121](#) [R412500124](#) [R412414124](#) [R412501124](#)
[HMC-C584](#) [R413802000](#) [R412400124](#) [R411700124](#) [R417310130](#) [R411801119](#) [R412419124](#) [R411703124](#) [R412401124](#) [R443131000](#)
[R417130110](#) [R414700000](#) [R414505000](#) [R411802119](#) [R417720128](#) [R420706110](#) [R413811000](#) [R413803115](#) [R414501000](#) [R417903128](#)