

NOTES:
 1. SPECIFICATIONS:
 ELECTRICAL:
 WITHSTANDING VOLTAGE: MINIMUM 1250 V RMS @ SEA LEVEL
 INSULATION RESISTANCE: INITIAL 5000 MEGOHMS MAXIMUM,
 1000 MEGOHMS MIN. AFTER ENVIRONMENTAL TESTING.
 CONTACT RATING: 5 AMPS
 CONTACT RESISTANCE: 2.7 MILLIOHMS MAX.
 MATERIALS:
 INSULATOR: WHITE UL94V-0 RATED GLASS FILLED POLYESTER
 CONTACT: COPPER ALLOY
 CONTACT AREA PLATING: GOLD OVER NICKEL,
 CONNECTOR SHELL: STEEL, PLATING ZINC WITH CLEAR CHROMATE.
 ENVIRONMENTAL:
 OPERATING TEMPERATURE: -65°C TO +125°C
 TERMINATION:
 SOLDER POTS ACCOMODATE # 20 AWG STRANDED WIRE MAX.
 2. DIMENSIONS IN [] ARE IN MILLIMETERS.

DRAWING REVISIONS			
REV	DOCUMENT	APP	DATE
A	DO 05-1094	AKB	12-08-05
B	ECN 06E420		

NUMBER OF POSITIONS	SELECTIVE GOLD FLASH PLATING (.120" [3.05] MTG. HOLES)		DIMENSION										FRONT MOUNTING HOLE DIMENSIONS		REAR MOUNTING HOLE DIMENSIONS	
	PART NO.	FACTORY NO.	"A"	"B"	"C"	"D"	"E"	"F"	"G"	"H"	"J"	"X"	"Y"	"X"	"Y"	
9	DEH-9P	702 01 09 001	1.213 [30.81]	.984 [24.99]	.697 [17.70]	.360 [9.14]	.494 [12.55]	.759 [19.28]	.422 [10.72]	.045 [1.14]	.030 [0.76]	.874 [22.20]	.513 [13.03]	.806 [20.47]	.449 [11.40]	
15	DAH-15P	702 01 15 001	1.541 [39.14]	1.312 [33.32]	1.025 [26.03]			1.083 [27.51]				1.202 [30.53]		1.134 [28.80]		
25	DBH-25P	702 01 25 001	2.088 [53.04]	1.852 [47.04]	1.583 [40.21]	.378 [9.60]	.605 [15.37]	1.629 [41.38]	.534 [13.56]	.060 [1.52]	.039 [0.99]	1.743 [44.27]	.623 [15.82]	1.674 [42.52]	.555 [14.10]	
37	DCH-37P	702 01 37 001	2.729 [69.32]	2.500 [64.50]	2.231 [56.67]			2.272 [57.71]				2.391 [60.73]		2.326 [59.08]		
50	DDH-50P	702 01 50 001	2.635 [66.93]	2.406 [61.11]	2.127 [54.02]	.484 [12.29]	2.178 [55.32]	2.297 [58.34]	2.218 [56.34]							

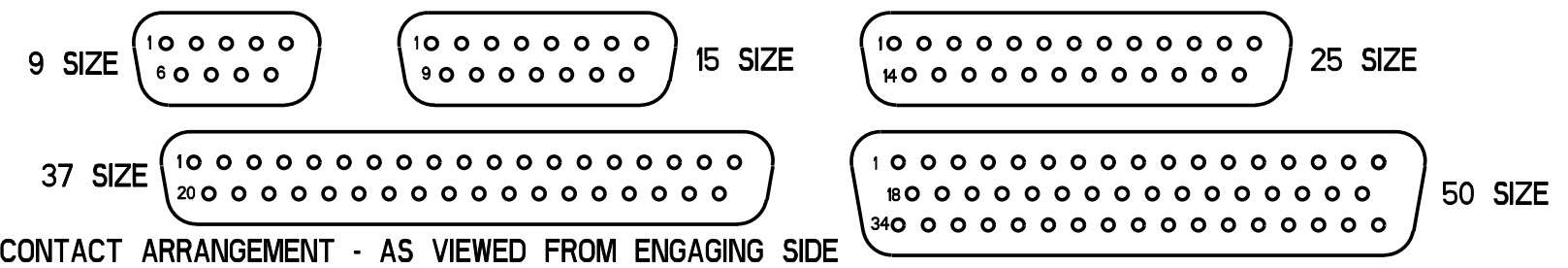
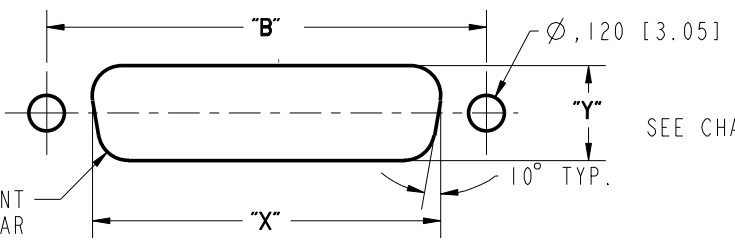

ROHS COMPLIANT

UNITS ENGLISH	PRO/E	Cinch		MODELED BY: V.SKUZA
DO NOT SCALE DRAWING	DRAWN BY V.SKUZA	DATE 06/10/05	TITLE D-SUB SOLDER CUP CONNECTOR PLUG ASS'Y(.120" MTG HOLES)	
	DESIGN ENGINEER A.BALI	06/10/05	MATERIAL	
	DESIGN ENGINEERING MGR. A.SHAH	07/09/05	MATERIAL SPEC NUMBER	FINISH
	MFG. ENGINEERING J.OCEGUERA	07/07/05	CAD FILE NUMBER DXH-XXP	DRAWING NUMBER D#H-XXP
	QUALITY ASSURANCE A.VAZQUEZ	07/06/05	CAGE IDENT NO. SIZE 71785 B	SCALE 1:1
THIS DOCUMENT IS THE PROPERTY OF CINCH. NEITHER THIS DOCUMENT NOR ANY OF THE INFORMATION CONTAINED IN IT MAY BE DUPLICATED OR DISCLOSED WITHOUT PRIOR WRITTEN CONSENT OF CINCH.		PROJECT NUMBER C14716		
		SHEET 1 OF 1		

X-ON Electronics

Largest Supplier of Electrical and Electronic Components

Click to view similar products for [D-Sub Standard Connectors](#) category:

Click to view products by [Bel Fuse](#) manufacturer:

Other Similar products are found below :

[DCM37S732N](#) [DAM15P500](#) [DEV09S364GTLF](#) [DEM09P032N](#) [DDM50P732N](#) [DAM15S332N](#) [173109-2218](#) [173109-2466](#) [173109-2469](#)
[173109-2435](#) [56F706-005-LI](#) [56F711-015](#) [015-0341-000](#) [017041-0005](#) [012-9507-114](#) [012-9534-001](#) [609-25P](#) [M24308/2-23Z](#) [M243082310F](#)
[M24308/2-36Z](#) [M243082411F](#) [M24308315F](#) [M24308/4-21](#) [M243084437F](#) [CT0M22-23SS](#) [CT1N36-5SC](#) [CT2-16S-17PS](#) [CT2-20-15PCAU](#)
[CT2-24-12PS](#) [CT2-24-28PSF127A206](#) [CT6F9767-14-4-14S-5PC](#) [CT7-18-10SC](#) [CT7-18-10SCAU](#) [CT7-18-12SCAU](#) [CT7-18-1PC](#) [CT7-18-](#)
[1PCAU](#) [CT7-18-1SC](#) [CT7-18-21SCAU](#) [CT9-16-12PS](#) [M83513/01-FC](#) [M83723/76W24619 L/C](#) [M85049/48-3-2F](#) [69001-865](#)
[6STD09PCM99B70X](#) [6STD09SCM99B30X](#) [6STD09SCT99S40X](#) [6STD15PCT99S40X](#) [6STD15SCM99B30X](#) [6STD15SCT99S40X](#)
[6STF09PCM05B70X](#)