

RED INDICATES ORIGINAL

| DASH NO | CABLES ACCOMMODATED | A HEX | B MAX | ASSEMBLE PER |
|---------|---|-------|---------|--------------|
| -201 | M17/17B-00002 | .344 | 1.77 | TAI-189 |
| -202 | TWC-7B-1 | | | |
| -203 | TWC-124-1A | | | |
| -204 | 10802, RAYCHEM | | | |
| -205 | TWAC-7B-1F2 | | | |
| -206 | 782800130, RAYCHEM | | | |
| -207 | 83310 BELDEN | | | |
| -208 | 202-3827 MICRODOT | | | |
| -209 | 202-3842 MICRODOT | | | |
| -210 | 8451 BELDEN | | | |
| -211 | 202-3834 MICRODOT | 1.52 | TAI-161 | |
| -212 | 2524E0114, RAYCHEM | | | |
| -213 | TWC-7B-2 | | | |
| -214 | TWC-124-2 | | | |
| -215 | BL-982 TIMES | | | |
| -216 | BL-1242 TIMES | | | |
| -217 | GCB75TM24H, GRUMMAN | 1.77 | TAI-189 | |
| -218 | EPD 22188B, RAYCHEM | | | |
| -219 | 252801114, RAYCHEM | | | |
| -220 | GCB75RR1, GRUMMAN | | | |
| -221 | 10814, RAYCHEM | | | |
| -222 | 10613, RAYCHEM | | | |
| -223 | HMS2-1149, HUGHES | 1.52 | TAI-161 | |
| -224 | TWCP-124-3 | | | |
| -225 | PS665PL, PRIME STOCK | 1.78 | TAI-154 | |
| -301 | GCB75G1, GRUMMAN | | | |
| -302 | 5022E5111; RAYCHEM; GCB75G1, GRUMMAN | | | |
| -303 | 7528A5314, RAYCHEM | 1.76 | TAI-154 | |
| -304 | | | | |
| -305 | M17/177-00001, THERMATICS | 1.47 | TAI-178 | |
| -306 | TRC-50-2 M17/134-00002 | | | |
| -307 | TRC-75-1 | 1.47 | TAI-178 | |
| -308 | TRC-75-2 | | | |
| -309 | TRC-50-1 | 1.78 | TAI-154 | |

| REVISIONS | | | | 310-0070 | SH 1 |
|-----------|-------|----------------------------|-----|----------|--------|
| REV | ED | DESCRIPTION | DWN | APPROVED | DATE |
| H | 12388 | ADDED -224 & -225; SEE ECO | DBN | AM | 2-6-98 |

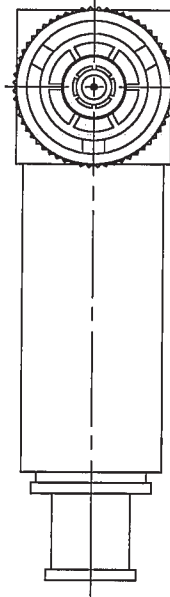

-201 SHOWN

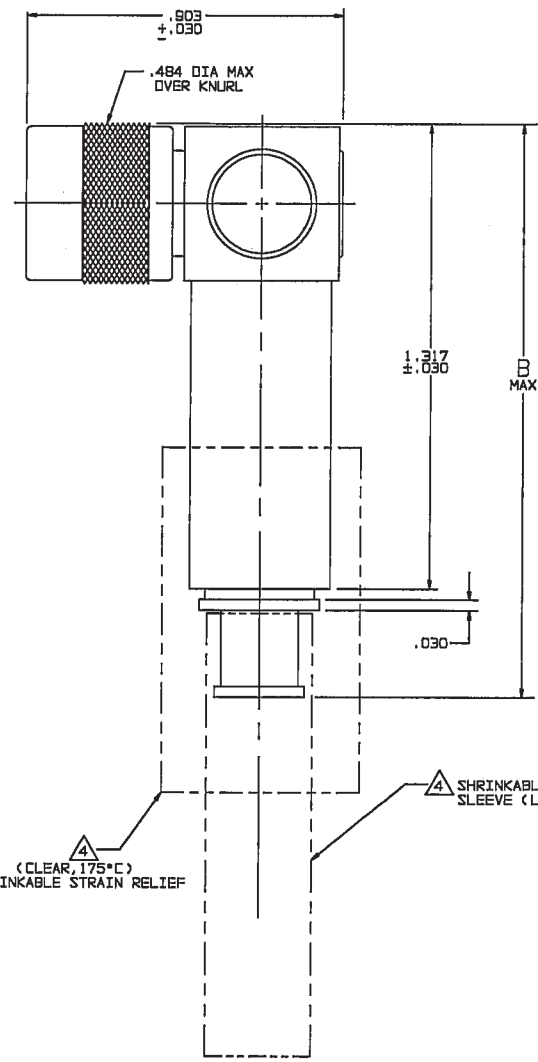

| INCH | MM |
|-------|-------|
| .005 | 0.13 |
| .030 | 0.76 |
| .344 | 8.74 |
| .484 | 12.29 |
| .903 | 22.94 |
| 1.00 | 25.40 |
| 1.25 | 31.75 |
| 1.317 | 33.45 |
| 1.47 | 37.34 |
| 1.52 | 38.61 |
| 1.75 | 44.45 |
| 1.78 | 44.70 |
| 1.77 | 44.96 |

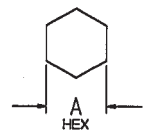

RECOMMENDED
HEX CRIMP
SCALE: NONE

- 1 SHRINKABLE STRAIN RELIEF AND/OR SHRINKABLE SEALING SLEEVE SUPPLIED LOOSE AS FOLLOWS:
- CABLE GROUPS -201 THROUGH -210, -217 THROUGH -303, -305, -307 & -309
 - 1 SHRINKABLE STRAIN RELIEF (1.00 LONG)
 - 1 SHRINKABLE SEALING SLEEVE (1.25 LONG)
 - CABLE GROUPS -211 THROUGH -216, -306 & -308
 - 1 SHRINKABLE STRAIN RELIEF (1.75 LONG)
2. FINISH: TFS-1A (NICKEL)
3. CONCENTRIC TWIAX/TRIAX TRS 3-LUG RIGHT ANGLE FULL CRIMP CABLE PLUG
4. ALL DIM ARE IN INCHES

5. EXAMPLE OF COMPLETE MODEL NO:
PLR155AC-201
- BASIC MODEL NO _____ CABLE GROUP DASH NO _____
5. EXAMPLE OF COMPLETE PART NO:
310-0070-201
- BASIC PART NO _____ CABLE GROUP DASH NO _____

- 4 (CLEAR, 175°C) SHRINKABLE STRAIN RELIEF
- 4 SHRINKABLE SEALING SLEEVE (LONG)

| QTY | DESCRIPTION | PART NUMBER | ITEM |
|---|-------------------------------------|-------------|---------------------------|
| TOL UNLESS SPECIFIED XX ±.03 .XXX ±.005 XXXX ±.0002 ANGLE | TROMPETER RF connectivity | PLR155AC | |
| DWN | DBN 4/3/98 | MATERIAL | CODE IDENT |
| CHK | AM 4-7-98 | 14949 | 310-0070 |
| ENGR | | | H |
| APPR | 2-8-98 | SCALE 4/1 | DATE 4/19/98 SHEET 1 OF 2 |

X-ON Electronics

Largest Supplier of Electrical and Electronic Components

Click to view similar products for [RF Connectors / Coaxial Connectors](#) category:

Click to view products by [Bel Fuse](#) manufacturer:

Other Similar products are found below :

[8915-1511-000](#) [89674-0827](#) [6001-7071-019](#) [6002-7051-003](#) [6002-7551-202](#) [6059674-1](#) [619550-1](#) [630059-000](#) [M39030/3-01N](#) [6500-7071-046](#) [6769](#) [CX050L2AQ](#) [7002-1541-010](#) [7002-1542-011](#) [7004-1512-000](#) [7009-1511-004](#) [7010-1511-000](#) [7029-1511-060](#) [7101-1541-010](#) [7101-1571-002](#) [7145-1521-002](#) [7203-1571-003](#) [7209-1511-011](#) [7210-1511-015](#) [7210-1511-019](#) [73137-5015](#) [73216-2241](#) [73404-2300](#) [7405-1521-005](#) [7405-1521-802](#) [8527](#) [8547](#) [FS11V](#) [877931](#) [8808-1511-001](#) [9049-9513-000](#) [9074-9513-000](#) [9101-9573-002](#) [910A205F](#) [9130-9573-002](#) [PL11SC-026](#) [PL375-33](#) [PL40-5](#) [PL74C-221](#) [PL75MC-217](#) [PL803-7](#) [1200690078](#) [1-201144-1](#) [R107003010W](#) [R110A172100](#)