

DATA CONTAINED ON THIS DOCUMENT IS PROPRIETARY TO TROMPETER ELECTRONICS, INC. AND SHALL NOT BE DISCLOSED, COPIED OR USED FOR REPRODUCTION OR MANUFACTURE WITHOUT EXPRESS WRITTEN PERMISSION.

DASH NO	DESCRIPTION
-1	CAP (NO CHAIN)
-2	CAP WITH 2.5 BRASS CHAIN
-3	CAP WITH 2.5 NYLON CHAIN
-4	CAP WITH 3.0 BRASS CHAIN
-5	CAP WITH 3.0 NYLON CHAIN
-6	CAP WITH 6.0 BRASS CHAIN
-7	CAP WITH 6.0 NYLON CHAIN
-8	CAP WITH 4.0 BRASS CHAIN
-9	CAP WITH 4.0 NYLON CHAIN
-10	CAP WITH 10.0 BRASS CHAIN
-11	CAP WITH 10.0 NYLON CHAIN
-12	CAP WITH 2.5 INCH SST ROPE
-13	CAP WITH 3.0 INCH SST ROPE
-14	CAP WITH 6.0 INCH SST ROPE
-15	CAP WITH 4.0 INCH SST ROPE
-16	CAP WITH 7.0 INCH SST ROPE
-17	CAP WITH 4.5 INCH SST ROPE

MODEL NO	TYPE
RFI85	2-LUG
RFI853	3-LUG
RFI385	THREAD

DASH NO	"A" DIA	"B" DIA	"C" DIM	"D" DIM
-D1	.755	.875	1.191	.513
-D2	.630	.750	1.066	.450
-D3	.505	.625	.941	.388
-D4	.439	.562	.878	.355
-D5	.380	.500	.816	.325
-D6	.317	.437	.753	.295
-D7	.281	.406	.722	.278
-D8	.610	.750	1.066	.450
-D9	.567	.687	1.003	.419
-DD8	.330	.450	.766	.300
-D10	.192	.312	.628	.231

REV	ED	DESCRIPTION	DWN	APPROVED	DATE
F	1357	ADDED -12-01 THRU -17-008, -112-01 THRU -117-008, -812-01 THRU -817-008 AND ITEM 16 TO BOM FOR SST WITH D-LUG B-3265-1 UPGRADE TO LARGER FORMAT, UPGRADE TABLE 1 AND 2; ADDED VIEW FOR SST ROPE & D-LUG; CHANGED NOTE 4; SG ±.03 WAS .500 ±.030; GENERAL UPDATE; SEE ECO	DKC	<i>[Signature]</i>	

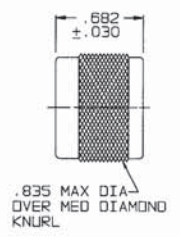

RFI385-1
SHOWN
NO CHAIN/ROPE
OR MOUNTING LUG

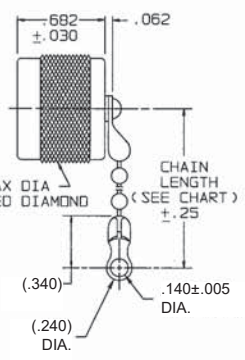

RFI385-2 THRU
-10 SHOWN
STANDARD CHAIN &
MOUNTING LUG

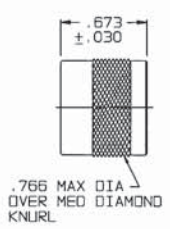

RFI85/
RFI853-1
SHOWN
NO CHAIN/ROPE
OR MOUNTING LUG

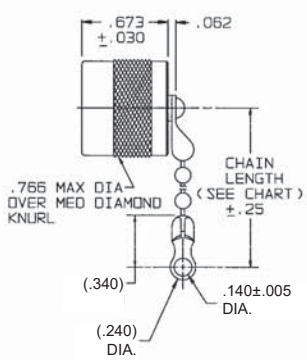

RFI85/RFI853-2 THRU
-11 SHOWN
STANDARD CHAIN &
MOUNTING LUG

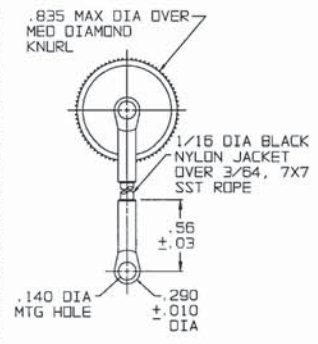

RFI385-12 THRU
-17 SHOWN
STAINLESS STEEL ROPE
AND MOUNTING LUG

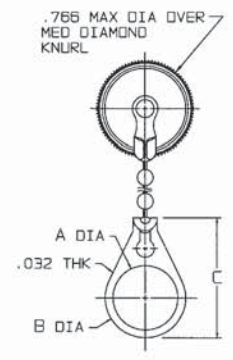

RFI85/RFI853-2-01
THRU -11-008 SHOWN
STANDARD CHAIN AND
BULKHEAD JACK
MOUNTING LUG

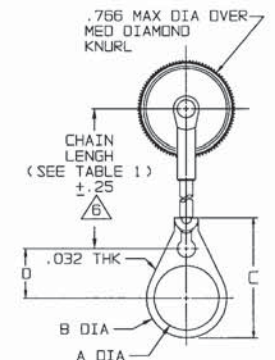

RFI85/RFI853-12-01
THRU -17-008 SHOWN
SST ROPE AND BULKHEAD
JACK MOUNTING LUG

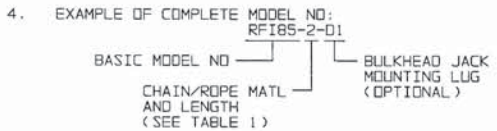

3. MALE "C" STYLE DUST CAP
2. FINISH: NICKEL
1. ALL DIM ARE IN INCHES

QTY	DESCRIPTION	PART NUMBER	ITEM
TOL. UNLESS SPECIFIED - .001 ± - .002 ± - .005 ± - .0002 - .0005	TROMPETER ELECTRONICS, INC.	RFI 85/853/385	
DWN CHK ENGR APPV	MATERIAL 14949	CODE IDENT 305-0137	REV F
NEXT ASSY	SCALE 2/1	DATE 11-14-73	SHEET 1C

X-ON Electronics

Largest Supplier of Electrical and Electronic Components

Click to view similar products for [RF Connector Accessories](#) category:

Click to view products by [Bel Fuse](#) manufacturer:

Other Similar products are found below :

[89674-0712](#) [F702RX24](#) [FERRULE-174](#) [R141802000](#) [R141805000](#) [R141842000](#) [R161862000](#) [R161862000W](#) [R280752000](#) [R280907000](#)
[R694261906](#) [RFI21-13](#) [RFI75-13-D2](#) [RFI75-4-D2](#) [AX102906](#) [AX102907](#) [18097-0013](#) [HP-375](#) [HP-500](#) [2098-0294-00](#) [2098-3251-94](#) [KA-](#)
[81-05](#) [89674-0805](#) [F1](#) [FERRULE-223](#) [202102-11](#) [213337-1](#) [220222-2](#) [24092671A](#) [24092678A](#) [R280468000](#) [R280510000](#) [R282862060](#)
[RFI155-1](#) [RFI25-12-D3](#) [RFI25-5](#) [RFI25-5-D3](#) [RFI75-12-D2](#) [RFI75-2-D2](#) [RFI75-4-D3](#) [RFI77-6](#) [360HS001M2508M6](#) [4-1532137-4](#) [5-21085-](#)
[0](#) [105274-1000](#) [111062-0490](#) [112122-SOD-LUG](#) [112-NUT-KNURL](#) [IPP-2014](#) [R280490020](#)