

THE INFORMATION CONTAINED HEREIN IS CONSIDERED "PROPRIETARY" TO BEL FUSE INC. AND SHALL NOT BE COPIED, REPRODUCED OR DISCLOSED WITHOUT THE WRITTEN APPROVAL OF BEL FUSE INC.

ELECTRICAL CHARACTERISTICS @ 25°C

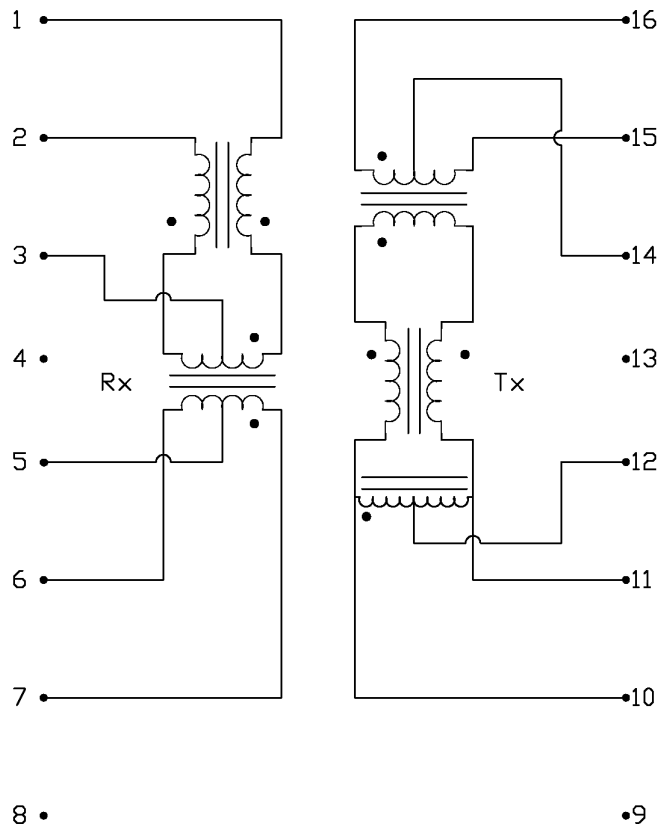

SCHEMATIC



URNS RATIO

(1-3-2) : (7-5-6)  
(16-14-15) : (10-12-11)

1CT : 1CT  
1CT : 1CT

PHASING

1 TO 7 AND 16 TO 10 IN PHASE

OCL

(7-6) OPEN 1 & 2  
(10-11) OPEN 16 & 15

420uH MIN. AT 100kHz, 100mV  
WITH 8mA DC BIAS

INSERTION LOSS

1.0dB MAX AT 100kHz TO 80MHz

RETURN LOSS

MEASURED UNDER A 100 Ω  
ENVIRONMENT (16-15) TO (10-11)  
(6-7) TO (1-2)

| FREQ | 2MHz | 10MHz | 30MHz | 45MHz | 60MHz | 80MHz |
|------|------|-------|-------|-------|-------|-------|
| MIN. | 20dB | 20dB  | 19dB  | 16dB  | 13dB  | 12dB  |

RETURN LOSS

MEASURED UNDER 25 AND 100 Ω  
IMPEDANCE ENVIRONMENT ACROSS  
(16-14) AND (10-11)  
RESPECTIVELY

17dB MIN AT 5MHz & 10MHz

CMDR

40dB MIN AT 100kHz TO 50MHz  
30dB MIN ABOVE 50M TO 100MHz

CROSSTALK

HIPOT

30dB MIN AT 100kHz TO 100MHz  
PER HAND-WORK-03

|         |          |                          |
|---------|----------|--------------------------|
| DRWN    | DATE     | TITLE                    |
| DQ Chen | 01-26-05 | ELECTRICAL SPECIFICATION |
| CHKD    | DATE     |                          |
| HQ      | 01-26-05 | S558-5999-46-F           |

|                        |                  |
|------------------------|------------------|
| PART NO. / DRAWING NO. | FILE NAME        |
| X558599946-F           | X558599946FA.DWG |

|               |                              |
|---------------|------------------------------|
| STANDARD DIM. | [ ] METRIC DIM. AS REFERENCE |
| TOL. IN INCH  | UNIT : INCH [mm] REV. : A    |
| .X            | SCALE : N/A SIZE : A4        |
| .XX           | PAGE : 2                     |
| .XXX          |                              |

|               |                              |
|---------------|------------------------------|
| STANDARD DIM. | [ ] METRIC DIM. AS REFERENCE |
| TOL. IN INCH  | UNIT : INCH [mm] REV. : A    |
| .X            | SCALE : N/A SIZE : A4        |
| .XX           | PAGE : 2                     |
| .XXX          |                              |



THE INFORMATION CONTAINED HEREIN IS CONSIDERED "PROPRIETARY" TO BEL FUSE INC. AND SHALL NOT BE COPIED, REPRODUCED OR DISCLOSED WITHOUT THE WRITTEN APPROVAL OF BEL FUSE INC.

SUGGESTED PCB PAD LAYOUT

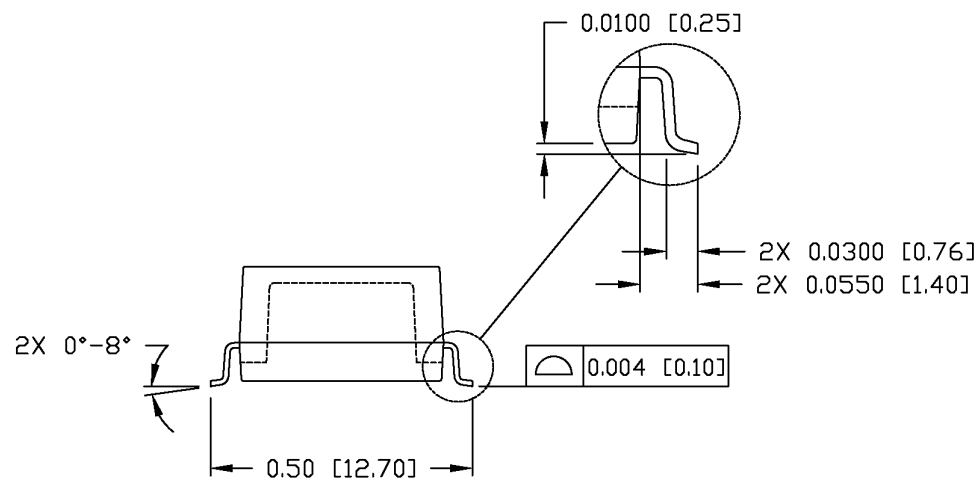
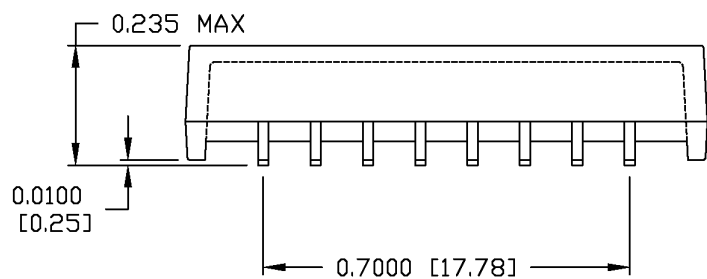
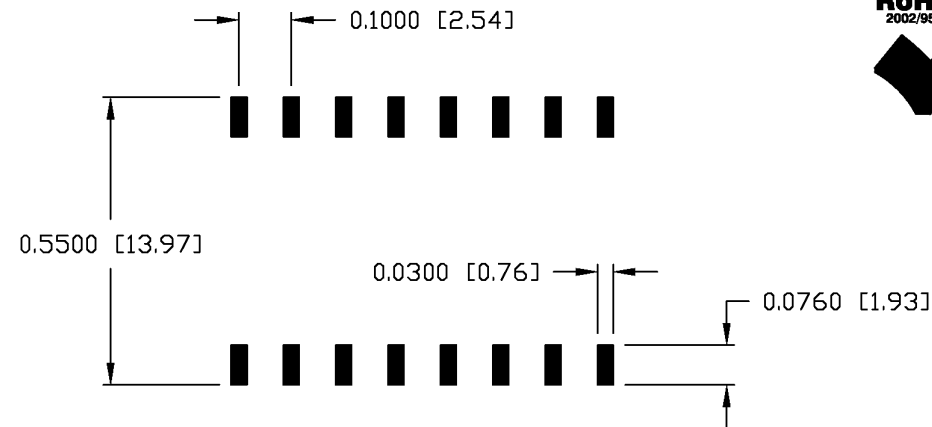
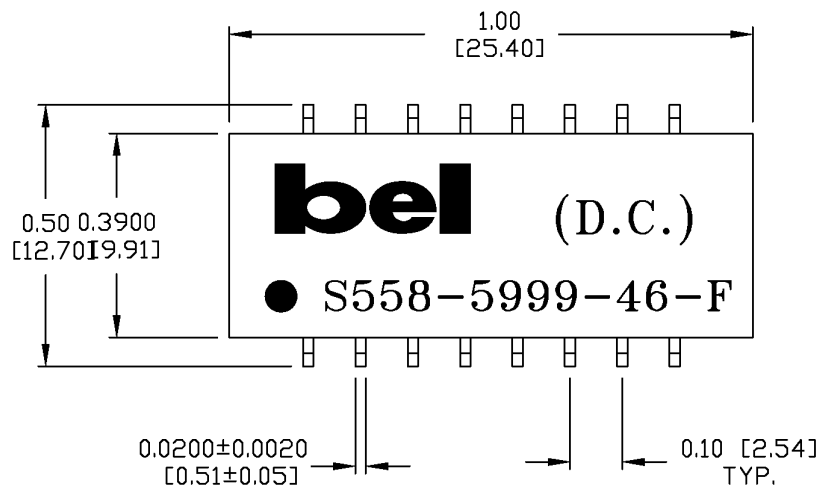

NOTES:

- STANDARD MARKING REFER TO DOC. HAND-WORK-04.
- PACKAGE CODE: "RNS001".

| DRWN    | DATE     | TITLE              | PART NO. / DRAWING NO. | STANDARD DIM. TOL. IN INCH |       | [ ] METRIC DIM. AS REFERENCE |                  | REV. :    | bel                               |
|---------|----------|--------------------|------------------------|----------------------------|-------|------------------------------|------------------|-----------|-----------------------------------|
|         |          |                    |                        | .X                         | .XX   | .XXX                         | UNIT : INCH [mm] |           |                                   |
| DQ Chen | 01-26-05 | MECHANICAL DRAWING | X558599946-F           | .X                         | ±0.01 | ±0.005                       | UNIT : INCH [mm] | REV. : A  | COMPONENTS FOR A CONNECTED PLANET |
| CHKD    | DATE     | S558-5999-46-F     | FILE NAME              | .XX                        | ±0.01 | .XXX                         | SCALE : N/A      | SIZE : A4 |                                   |
| HQ      | 01-26-05 |                    | X558599946FADWG        |                            |       |                              | SCALE : N/A      | PAGE : 3  |                                   |

FORM NO. - ENG02082001

## X-ON Electronics

Largest Supplier of Electrical and Electronic Components

*Click to view similar products for [Audio Transformers / Signal Transformers](#) category:*

*Click to view products by [Bel Fuse](#) manufacturer:*

Other Similar products are found below :

[CX2041NLT](#) [MGPWT-00449-P](#) [PE-64961](#) [H1302FNLT](#) [H5008FNL](#) [H5012FNL](#) [H5020FNLT](#) [H5077NLT](#) [H5079NLT](#) [H5084FNLT](#)  
[B78476A9558A003](#) [1812WBT2-4](#) [1879479-1](#) [HX2260FNL](#) [HX5014FNL](#) [EX2024FNL](#) [FL1066](#) [T1137NLT](#) [T3012NL](#) [PE-65812FNL](#) [PE-65848FNLT](#) [H1174FNL](#) [H1302FNL](#) [H5015FNL](#) [H5019EFNL](#) [H5062FNLT](#) [CX2047LNL](#) [MGPWT-00059-P](#) [MGPWT-00266-P](#) [MGPWT-00278-P](#) [MGPWT-00431-P](#) [TTC-100](#) [TTC-143-H](#) [TTC-5032-1](#) [BX1194WNLT](#) [HX1234NLT](#) [HX5008FNLT](#) [HX5019FNL](#) [HX5084NL](#) [3-1879385-5](#) [TX1263NLT](#) [4-1879391-0](#) [T1142NL](#) [HX6101FNL](#) [HX5084FNL](#) [HX1148NL](#) [HX5020FNLT](#) [HX5014FNLT](#) [T1124NL](#)  
[1879732-1](#)