

**RED INDICATES ORIGINAL**

| DASH NO | FIG | CABLES ACCOMMODATED       | A DIM | B FLATS | C HEX | ASSEMBLE PER |
|---------|-----|---------------------------|-------|---------|-------|--------------|
| -1      |     | RG-58                     |       |         |       |              |
| -U1     |     | ESSEX 621-715             |       |         |       |              |
| -2      |     | RG-59                     |       |         |       |              |
| -U2     |     | BELDEN 8279               |       |         |       |              |
| -2A     |     | AT&T 730A                 |       |         |       |              |
| -U2A    |     | RG-223                    |       |         |       |              |
| -2B     |     | RG-55                     | .931  | .437    | .437  | TAI-101      |
| -U2B    |     | RG-122                    |       |         |       |              |
| -3      |     | BELDEN 8218               |       |         |       |              |
| -U3     |     | RG-174                    |       |         |       |              |
| -3A     |     | RG-187                    |       |         |       |              |
| -U3A    |     | RG-196                    |       |         |       |              |
| -4      |     | HEWLETT-PACKARD 8120-1107 |       |         |       |              |
| -U4     |     | BELDEN 9231               | .988  | .500    | .500  | TAI-119      |
| -5      |     | RG-5                      |       |         |       |              |
| -U5     |     | RG-6                      |       |         |       |              |
| -5A     |     | RG-303                    |       |         |       |              |
| -U5A    |     | RG-180                    |       |         |       |              |
| -5B     |     | GRUMMAN GC875GPI          |       |         |       |              |
| -U5B    |     | RG-187 DBL SHLD           |       |         |       |              |
| -6      |     | BELDEN 8228               | .931  | .437    | .437  | TAI-101      |
| -U6     |     | 275-3991 MICRODOT         |       |         |       |              |
| -6E     |     | 616-569 AMPEX             |       |         |       |              |
| -U6E    |     | 810 RAYCHEM               |       |         |       |              |
| -7      |     | RG-304                    |       |         |       |              |
| -U7     |     | 9248 BELDEN               |       |         |       |              |
| -8      |     | BRAND-REX B749            |       |         |       |              |
| -U8     |     | GORE C06C032              |       |         |       |              |
| -9      |     | 88281 BELDEN              | .988  | .500    | .500  | TAI-119      |
| -U9     |     | 89120 BELDEN              |       |         |       |              |
| -10     |     | 89555 BELDEN              |       |         |       |              |
| -U10    |     | 734A, AT&T                |       |         |       | TAI-101      |
| -11     |     | RG-405                    | .931  | .437    | .437  | TAI-130      |
| -U11    |     | RG-402                    |       |         |       |              |

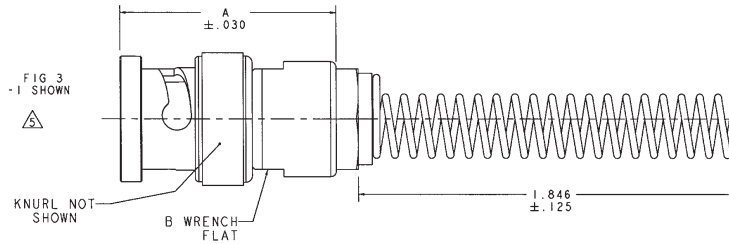

| REVISIONS |         |  |     | 1-0369      | SH 1C   |
|-----------|---------|--|-----|-------------|---------|
| REV       | ECO NO. | DESCRIPTION  | DNW | APPROVED    | DATE    |
| AE        | 11583   | DASH NO COLUMN, -U1 WAS -119; SHEET 2, MADE CORRECTION IN -1 SECTION VIEW; SEE ECO | LSR | [Signature] | 4/24/96 |

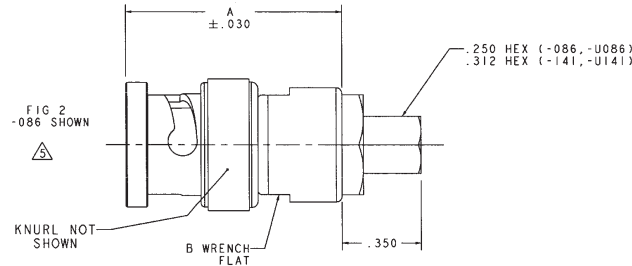
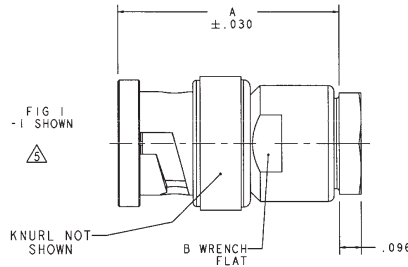
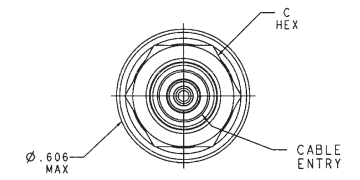

| INCH  | MM    |
|-------|-------|
| .005  | 0.13  |
| .030  | 0.76  |
| .096  | 2.44  |
| .125  | 3.18  |
| .250  | 6.35  |
| .312  | 7.92  |
| .350  | 8.89  |
| .437  | 11.10 |
| .500  | 12.70 |
| .606  | 15.39 |
| .931  | 23.65 |
| .988  | 25.10 |
| 1.846 | 46.89 |

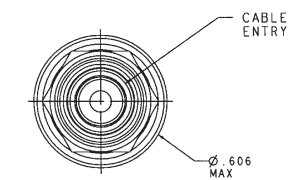
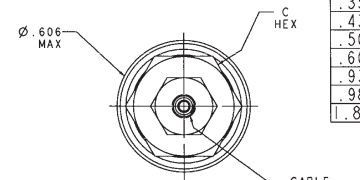

⚠ IF BEND RELIEF SPRING REQUIRED ADD SUFFIX "BR" TO MODEL NO. (SEE FIG 3) (NOT AVAILABLE WITH CABLE GROUPS -6, -U6, -6E, -U6E, -51, -U51, -52, -U52, -63, -U63, -086, -U086, -141 & -U141)

⚠ FOR CABLE GROUPS -1 & -U1 SUPPLY 1 EA ACA1 FOR CABLE GROUPS -2 & -U2 SUPPLY 1 EA ACA2 FOR CABLE GROUPS -5 & -U5 SUPPLY 1 EA ACA5 MAY BE ASSEMBLED TO CABLE/CONNECTOR ASSY USING 3M SCOTCHGRIP NO. 1099 PLASTIC ADHESIVE, OR EQUIV.

⚠ IF PLASTIC STRAIN RELIEF REQUIRED, ADD SUFFIX "BT" TO MODEL NO. (ONLY AVAILABLE WITH -1, -U1, -2, -U2, -5, -U5)

4. BNC COAXIAL CABLE PLUG BOTH 50 & 75 OHM VERSIONS
3. DASH NO DENOTES CABLE GROUP EXCEPT "U" PREFIX DENOTES 75 OHM VERSION
2. FINISH: TFS-IA(NICKEL)(TOTAL BUILD-UP .000180-.000450)
1. ALL DIM ARE IN INCHES

| QTY      | DESCRIPTION | PART NUMBER | ITEM     |
|----------|-------------|-------------|----------|
| 12-09    | 105-1004    | 1-0204      | 110-0003 |
| 105-0717 | 105-0870    | 1-0207      | 1-0227   |
| 305-0541 | 105-0698    | 1-0212      | 105-0944 |
| 105-0158 | 105-0697    | 1-0215      | 105-0007 |
| 305-0383 | 105-0659    | 1-0216      | 105-0449 |
| 305-0187 | 105-0461    | 1-0218      | 105-0394 |
| 105-1016 | 105-0295    | 1-0220      | 1-0304   |

TOL UNLESS SPECIFIED  
 IT # 005  
 SEE #  
 DATE #

DWG LSR 6-26-96  
 CHK [Signature]  
 ENGR [Signature]  
 APPR [Signature] 4/24/96

MATERIAL CODE IDENT DRAWING NO.  
 14949 I-0369 AE

SCALE 4/1 DATE 10-22-93 SHEET 1C

## X-ON Electronics

Largest Supplier of Electrical and Electronic Components

*Click to view similar products for [RF Connectors / Coaxial Connectors](#) category:*

*Click to view products by [Bel Fuse](#) manufacturer:*

Other Similar products are found below :

[8915-1511-000](#) [89674-0827](#) [6001-7071-019](#) [6002-7051-003](#) [6002-7551-202](#) [6059674-1](#) [619550-1](#) [630059-000](#) [M39030/3-01N](#) [6500-7071-046](#) [6769](#) [CX050L2AQ](#) [7002-1541-010](#) [7002-1542-011](#) [7004-1512-000](#) [7009-1511-004](#) [7010-1511-000](#) [7029-1511-060](#) [7101-1541-010](#) [7101-1571-002](#) [7145-1521-002](#) [7203-1571-003](#) [7209-1511-011](#) [7210-1511-015](#) [7210-1511-019](#) [73137-5015](#) [73216-2241](#) [73404-2300](#) [7405-1521-005](#) [7405-1521-802](#) [8527](#) [8547](#) [FS11V](#) [877931](#) [9049-9513-000](#) [9074-9513-000](#) [9101-9573-002](#) [910A205F](#) [9130-9573-002](#) [PL11SC-026](#) [PL375-33](#) [PL40-5](#) [PL74C-221](#) [PL75MC-217](#) [PL803-7](#) [980-8666-005](#) [1200690078](#) [1-201144-1](#) [R107003010W](#) [R110A172100](#)