



BESEL S.A.

FABRYKA SILNIKÓW ELEKTRYCZNYCH

SILNIKI INDUKCYJNE TRÓJFAZOWE ENERGOOSZCZĘDNE klasy IE4

Charakterystyka silników katalogowych:

- silniki ogólnego przeznaczenia do pracy w warunkach klimatu umiarkowanego,
- praca ciągła S1,
- napięcia znamionowe 230V/400V (D/Y),
- częstotliwość zasilania 50 Hz,
- temperatura otoczenia od -30°C do +60°C,
- kolor malowania RAL 5010.



THREE-PHASE INDUCTION MOTORS ENERGY EFFICIENT MOTORS class IE4

Description of the catalogue motors:

- general purpose motors; temperate climate,
- duty S1,
- rated voltage 230V/400V (D/Y),
- frequency 50 Hz,
- ambient temperature from -30°C to +60°C,
- standard paint colour RAL 5010.

stopień ochrony: IP54 (IP55; IP56; IP65)
klasa izolacji F

degree of protection: IP54 (IP55; IP56; IP65)
insulation class F

| Typ | Moc | | Prędkość obrotowa [min ⁻¹] | Prąd [A] przy | | Sprawność h [%] przy obciążeniu | | | Współczynnik mocy cos φ N | Moment znamionowy M _N [Nm] | Krotność prądu rozruchowego I _r /I _N | Krotność momentu rozruchowego M _r /M _N | M _{max} /M _N | Moment bezwładności J [kgm ²] | Masa [kg] |
|------------|--------------|------|---|----------------------|---------|------------------------------------|-----|-----|---------------------------|---------------------------------------|--|--|----------------------------------|---|-------------------|
| | [kW] | [KM] | | 230 V D | 400 V Y | 100% | 75% | 50% | | | | | | | |
| Frame size | Rated output | | Rated speed [min ⁻¹] | Rated current [A] at | | Efficiency h [%] at % of full load | | | Power factor cos φ N | Torque T _N [Nm] | Starting current/ rated current I _L /I _N | Starting torque/ rated torque T _L /T _N | T _b /T _N | Moment of inertia J [kgm ²] | Motor weight [kg] |
| | [kW] | [HP] | | 230 V D | 400 V Y | 100% | 75% | 50% | | | | | | | |

Silniki 2-biegunowe, 3000 min⁻¹; 50Hz

2-pole motors, 3000 min⁻¹; 50Hz

| | | | | | | | | | | | | | | | |
|------------|------|------|------|------|------|------|------|------|------|------|-----|-----|-----|----------|------|
| 4SIE 63-2A | 0,18 | 0,25 | 2880 | 0,95 | 0,55 | 70,8 | 71,0 | 66,0 | 0,68 | 0,6 | 3,9 | 3,4 | 3,6 | 0,000235 | 4,1 |
| 4SIE 63-2B | 0,25 | 0,33 | 2830 | 1,1 | 0,65 | 74,3 | 74,5 | 70,0 | 0,75 | 0,86 | 3,3 | 2,4 | 2,5 | 0,000310 | 5,0 |
| 4SIE 71-2A | 0,37 | 0,50 | 2920 | 1,65 | 0,95 | 78,1 | 78,0 | 75,0 | 0,72 | 1,2 | 8 | 4,5 | 5 | 0,000691 | 7,8 |
| 4SIE 71-2B | 0,55 | 0,75 | 2870 | 2,15 | 1,25 | 81,5 | 80,5 | 77,0 | 0,78 | 1,85 | 7,3 | 3,8 | 4 | 0,000820 | 10,6 |
| 4SIE 80-2A | 0,75 | 1,00 | 2940 | 3,1 | 1,8 | 83,5 | 83,0 | 79,0 | 0,7 | 2,45 | 11 | 6,4 | 6,4 | 0,001422 | 11,9 |
| 4SIE 80-2B | 1,10 | 1,50 | 2900 | 4 | 2,3 | 85,2 | 84,5 | 81,0 | 0,81 | 3,6 | 7,6 | 3,9 | 4 | 0,001673 | 13,0 |

Silniki 4-biegunowe, 1500 min⁻¹; 50Hz

4-pole motors, 1500 min⁻¹; 50Hz

| | | | | | | | | | | | | | | | |
|------------|------|------|------|------|------|------|------|------|------|------|-----|-----|-----|----------|------|
| 4SIE 63-4A | 0,12 | 0,17 | 1425 | 0,7 | 0,41 | 69,8 | 70,0 | 64,0 | 0,61 | 0,8 | 4,2 | 2,8 | 3,2 | 0,000451 | 5,1 |
| 4SIE 63-4B | 0,18 | 0,25 | 1430 | 1 | 0,65 | 74,7 | 75,0 | 70,0 | 0,53 | 1,2 | 4,6 | 3,2 | 3,4 | 0,000495 | 6,0 |
| 4SIE 71-4A | 0,25 | 0,33 | 1465 | 1,73 | 1 | 77,9 | 75,0 | 68,0 | 0,47 | 1,65 | 7,5 | 6,5 | 6,5 | 0,001236 | 7,9 |
| 4SIE 71-4B | 0,37 | 0,50 | 1440 | 1,73 | 1 | 81,1 | 81,0 | 78,0 | 0,63 | 2,45 | 6,8 | 4,3 | 4,2 | 0,001305 | 9,6 |
| 4SIE 80-4A | 0,55 | 0,75 | 1440 | 2,4 | 1,4 | 83,9 | 83,5 | 80,0 | 0,67 | 3,65 | 6,9 | 4,3 | 4,2 | 0,002655 | 11,5 |
| 4SIE 80-4B | 0,75 | 1,00 | 1435 | 3,3 | 1,9 | 85,7 | 84,0 | 80,0 | 0,68 | 5 | 7 | 4,5 | 4,4 | 0,003123 | 12,7 |

Silniki odpowiadają wymaganiom normy IEC 60034-30.

Motors meet requirements of Standard IEC 60034-30.

Silniki odpowiadają wymaganiom Polskiej Normy PN-EN 60034-1 oraz normom międzynarodowym IEC 60034-1.

Wszystkie silniki posiadają znak CE.

Motors meet requirements of Polish Standard PN-EN 60034-1 and the international rules IEC 60034-1.

All motors are provided with CE mark.

Silniki na łapach
Forma wykonania
IMB3

Foot - mounted motors
Type of construction
IMB3

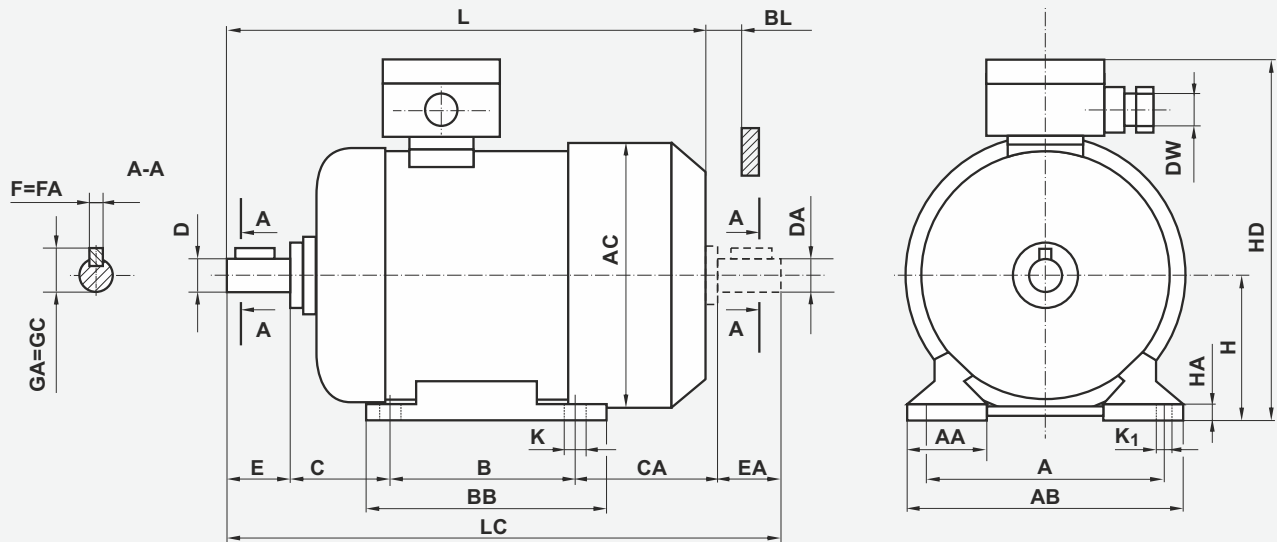

Forma wykonania IMB3

Type of construction IMB3

| Typ | Wymiary (mm) | | | | | | | | | | Dimensions (mm) | | | | | | | | | | Łożyska Bearings | |
|------------|--------------|-----|----|-----|------|------|------|-------|-------------------|----|-----------------|-----|----|-----|-----|-----|-------------------|-----|-----|-----|---------------------|---------|
| | A | B | C | CA | D=DA | E=EA | F=FA | GA=GC | H | K | K ₁ | DW | AA | AB | AC | BB | BL _{min} | HA | HD | L | | LC |
| 4SIE 63-2A | 100 | 80 | 40 | 79 | 11j6 | 23 | 4h9 | 12,5 | 63 _{0,5} | 7 | 10 | M20 | 36 | 124 | 126 | 106 | 11 | 8,5 | 166 | 210 | 242 | 6202 2Z |
| 4SIE 63-2B | 100 | 80 | 40 | 79 | | | | | | | | | | | | | | | | 236 | 268 | |
| 4SIE 63-4A | 100 | 80 | 40 | 79 | | | | | | | | | | | | | | | | 264 | 302 | |
| 4SIE 63-4B | 100 | 80 | 40 | 79 | 14j6 | 30 | 5h9 | 16 | 71 _{0,5} | 7 | 10 | M20 | 45 | 142 | 141 | 116 | 12 | 8 | 182 | 284 | 322 | 6203 2Z |
| 4SIE 71-2A | 112 | 90 | 45 | 106 | | | | | | | | | | | | | | | | 284 | 322 | |
| 4SIE 71-2B | 112 | 90 | 45 | 106 | | | | | | | | | | | | | | | | 306 | 357 | |
| 4SIE 71-4A | 112 | 90 | 45 | 106 | 19j6 | 40 | 6h9 | 21,5 | 80 _{0,5} | 10 | 13 | M20 | 55 | 160 | 157 | 130 | 15 | 9 | 199 | 318 | 369 | 6204 2Z |
| 4SIE 80-2A | 125 | 100 | 50 | 120 | | | | | | | | | | | | | | | | 306 | 357 | |
| 4SIE 80-2B | 125 | 100 | 50 | 138 | | | | | | | | | | | | | | | | 318 | 369 | |
| 4SIE 80-4A | 125 | 100 | 50 | 120 | | | | | | | | | | | | | | | | 306 | 357 | |
| 4SIE 80-4B | 125 | 100 | 50 | 138 | 318 | 369 | | | | | | | | | | | | | | | | |

Silniki kołnierzowe
Formy wykonania
IMB5, IMB14

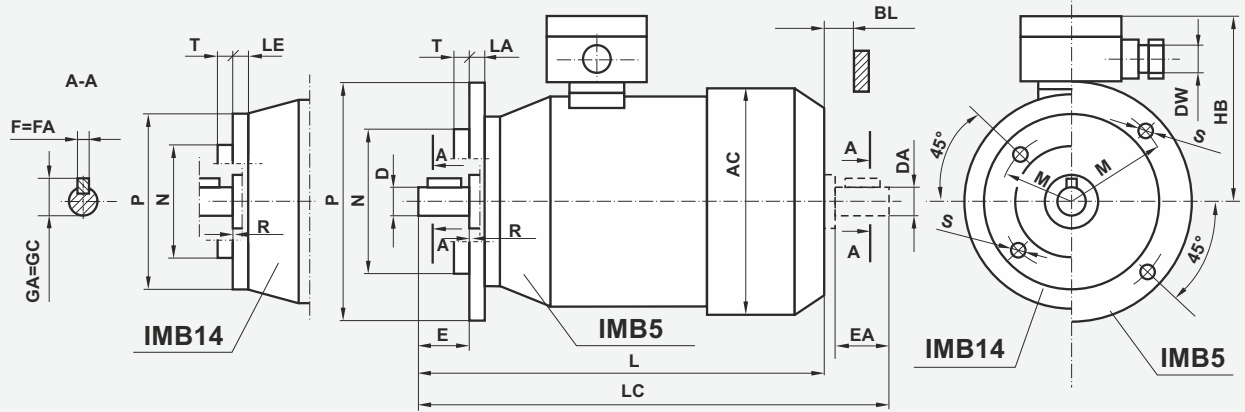

Flange
- mounted motors
Types of construction
IMB5, IMB14

Forma wykonania IMB5

Type of construction IMB5

| Typ Frame size | Wymiary (mm) | | | | | | | | | | Dimensions (mm) | | | | | | | Łożyska Bearings | |
|-------------------|--------------------|-----|-----|-------|----|------|------|------|-------|----|-----------------|---|-----|-----|-----------|-----|-----|---------------------|---------|
| | Kołnierz Flange | P | M | N | S | D=DA | E=EA | F=FA | GA=GC | LA | T | R | DW | AC | BL min | HB | L | | LC |
| 4SIEK 63-2A | B5 | 140 | 115 | 95j6 | 10 | 11j6 | 23 | 4h9 | 12,5 | 9 | 3 | 0 | M20 | 126 | 11 | 103 | 210 | 242 | 6202 2Z |
| 4SIEK 63-2B | | | | | | | | | | | | | | | | | 236 | 268 | |
| 4SIEK 63-4A | | | | | | | | | | | | | | | | | 236 | 268 | |
| 4SIEK 63-4B | | | | | | | | | | | | | | | | | 236 | 268 | |
| 4SIEK 71-2A | B5 | 160 | 130 | 110j6 | 10 | 14j6 | 30 | 5h9 | 16 | 9 | 3,5 | 0 | M20 | 141 | 12 | 111 | 264 | 302 | 6203 2Z |
| 4SIEK 71-2B | | | | | | | | | | | | | | | | | 264 | 302 | |
| 4SIEK 71-4A | B5 | 200 | 165 | 130j6 | 12 | 19j6 | 40 | 6h9 | 21,5 | 10 | 3,5 | 0 | M20 | 157 | 15 | 119 | 306 | 357 | 6204 2Z |
| 4SIEK 80-2A | | | | | | | | | | | | | | | | | 306 | 357 | |
| 4SIEK 80-2B | | | | | | | | | | | | | | | | | 318 | 369 | |
| 4SIEK 80-4A | | | | | | | | | | | | | | | | | 306 | 357 | |
| 4SIEK 80-4B | | | | | | | | | | | | | | | | | 318 | 369 | |

Silniki kołnierzowe
Formy wykonania
IMB5, IMB14

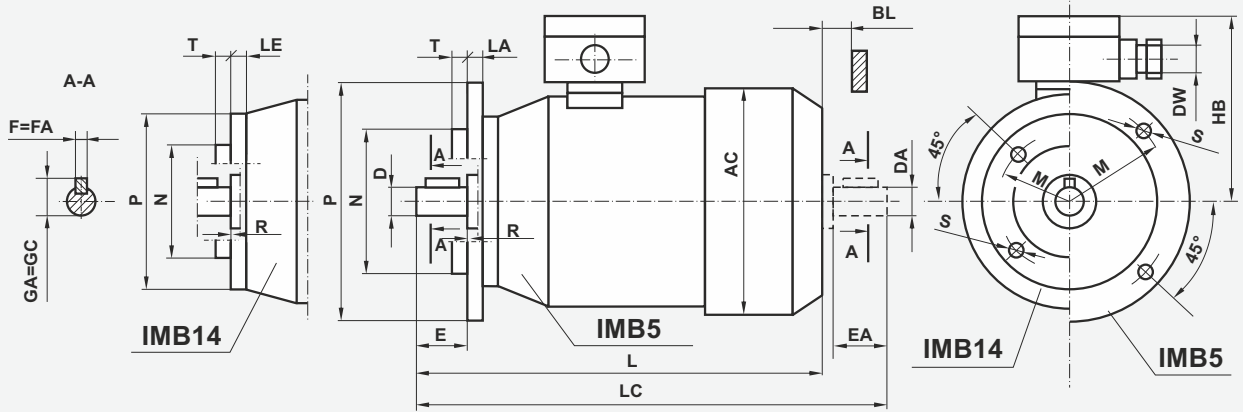

Flange
- mounted motors
Types of construction
IMB5, IMB14

Forma wykonania IMB14

Type of construction IMB14

| Typ Frame size | Wymiary (mm) | | | | | | | | | | | | | | | | | | | Łożyska Bearings |
|-------------------|--------------------|-----|-----|-------|----|------|------|------|-------|-----|-----|---|-----|-----|--------|-----|-----|-----|---------|---------------------|
| | Kołnierz Flange | P | M | N | S | D=DA | E=EA | F=FA | GA=GC | LE | T | R | DW | AC | BL min | HB | L | LC | | |
| 4SIEK 63-2A1 | B14/1 | 120 | 100 | 80j6 | M6 | 11j6 | 23 | 4h9 | 12,5 | 14 | 3 | 0 | M20 | 126 | 11 | 102 | 210 | 242 | 6202 2Z | |
| 4SIEK 63-2A2 | B14/2 | 90 | 75 | 60j6 | M5 | | | | | 9,5 | 2,5 | | | | | | | | | |
| 4SIEK 63-2B1 | B14/1 | 120 | 100 | 80j6 | M6 | | | | | 14 | 3 | | | | | | | | | |
| 4SIEK 63-2B2 | B14/2 | 90 | 75 | 60j6 | M5 | | | | | 9,5 | 2,5 | | | | | | | | | |
| 4SIEK 63-4A1 | B14/1 | 120 | 100 | 80j6 | M6 | | | | | 14 | 3 | | | | | | | | | |
| 4SIEK 63-4A2 | B14/2 | 90 | 75 | 60j6 | M5 | | | | | 9,5 | 2,5 | | | | | | | | | |
| 4SIEK 63-4B1 | B14/1 | 120 | 100 | 80j6 | M6 | | | | | 14 | 3 | | | | | | | | | |
| 4SIEK 63-4B2 | B14/2 | 90 | 75 | 60j6 | M5 | | | | | 9,5 | 2,5 | | | | | | | | | |
| 4SIEK 71-2A1 | B14/1 | 140 | 115 | 95j6 | M8 | 14j6 | 30 | 5h9 | 16 | 14 | 3 | 0 | M20 | 141 | 12 | 111 | 264 | 302 | 6203 2Z | |
| 4SIEK 71-2A2 | B14/2 | 105 | 85 | 70j6 | M6 | | | | | 9,5 | 2,5 | | | | | | | | | |
| 4SIEK 71-2B1 | B14/1 | 140 | 115 | 95j6 | M8 | | | | | 14 | 3 | | | | | | | | | |
| 4SIEK 71-2B2 | B14/2 | 105 | 85 | 70j6 | M6 | | | | | 9,5 | 2,5 | | | | | | | | | |
| 4SIEK 71-4A1 | B14/1 | 140 | 115 | 95j6 | M8 | | | | | 14 | 3 | | | | | | | | | |
| 4SIEK 71-4A2 | B14/2 | 105 | 85 | 70j6 | M6 | | | | | 9,5 | 2,5 | | | | | | | | | |
| 4SIEK 71-4B1 | B14/1 | 140 | 115 | 95j6 | M8 | | | | | 14 | 3 | | | | | | | | | |
| 4SIEK 71-4B2 | B14/2 | 105 | 85 | 70j6 | M6 | | | | | 9,5 | 2,5 | | | | | | | | | |
| 4SIEK 80-2A1 | B14/1 | 160 | 130 | 110j6 | M8 | 19j6 | 40 | 6h9 | 21,5 | 14 | 3,5 | 0 | M20 | 157 | 15 | 119 | 306 | 357 | 6204 2Z | |
| 4SIEK 80-2A2 | B14/2 | 120 | 100 | 80j6 | M6 | | | | | 12 | 3 | | | | | | | | | |
| 4SIEK 80-2B1 | B14/1 | 160 | 130 | 110j6 | M8 | | | | | 14 | 3,5 | | | | | | | | | |
| 4SIEK 80-4A1 | B14/1 | 160 | 130 | 110j6 | M8 | | | | | 14 | 3,5 | | | | | | | | | |
| 4SIEK 80-4A2 | B14/2 | 120 | 100 | 80j6 | M6 | | | | | 12 | 3 | | | | | | | | | |
| 4SIEK 80-4B1 | B14/1 | 160 | 130 | 110j6 | M8 | | | | | 14 | 3,5 | | | | | | | | | |
| 4SIEK 80-4B2 | B14/2 | 120 | 100 | 80j6 | M6 | | | | | 12 | 3 | | | | | | | | | |

Producent zastrzega sobie możliwość zmian danych zawartych w karcie katalogowej wynikających z ciągłego doskonalenia wyrobu.

As part of our development program, we reserve the right to alter or amend any of the specifications without giving prior notice.

X-ON Electronics

Largest Supplier of Electrical and Electronic Components

Click to view similar products for [Motor Drives](#) category:

Click to view products by [Besel](#) manufacturer:

Other Similar products are found below :

[GMA02](#) [1300920283](#) [GMA11](#) [GMA20](#) [R88DUA03LAAC100V30W](#) [R88DUA12HA](#) [R88DUP03LAAC100V30W](#) [STR2](#) [VX5A1400](#)
[VFD002EL11A](#) [MFMCB0030GET](#) [1302263150](#) [1300920078](#) [SR24](#) [R88D-GT04H](#) [R88D-GN04H-ML2](#) [R7D-BP01H](#) [R88D-KN04L-ECT](#)
[70354063](#) [79294435](#) [27358015](#) [15275008](#) [STAC6-QE](#) [1SFA896112R1100](#) [GNCF8-11](#) [KLC35BE](#) [ST10-Q-RN](#) [1302263161](#) [VX5A1300](#)
[2SIE 71-2A](#) [2SIE 71X-4C](#) [DV0P4140-FTDI](#) [R88A-CA1C005SF-E](#) [R88A-CR1B005NF-E](#) [SEH 56-2C](#) [SEHR90-4L](#) [U-PKZ0\(400V50HZ\)](#)
[LUCC12FU](#) [LU9BN11L](#) [LULC08](#) [319.3860.20.00](#) [319.3862.20.00](#) [3AUA0000038701](#) [3AUA0000038843](#) [3AUA0000039630](#)
[3AUA0000058186](#) [68878365](#) [68878373](#) [3G3MX2-AB002-E-ECT](#) [111.9039.20.00](#)