

REV.	DESCRIPTION	DATE	APPROVED
A	Engineering Release	09/14/09	T. Y.
B	Updated fiber in BOM	11/16/12	T. Y.

ITEM	Q'TY	PART NUMBER	PART DESCRIPTION
1	1	FLP-LC-5-02	LENS CAP, FLEXIBLE LIGHT-PIPE, BODY
2	1	FLP-LC-5-03	2mm LENS CAP, FLEXIBLE LIGHT-PIPE, INSERT
3	1	FLPS2031-X.XXX	2mm LIGHT PIPE CABLE, CUT LENGTH IN INCHES

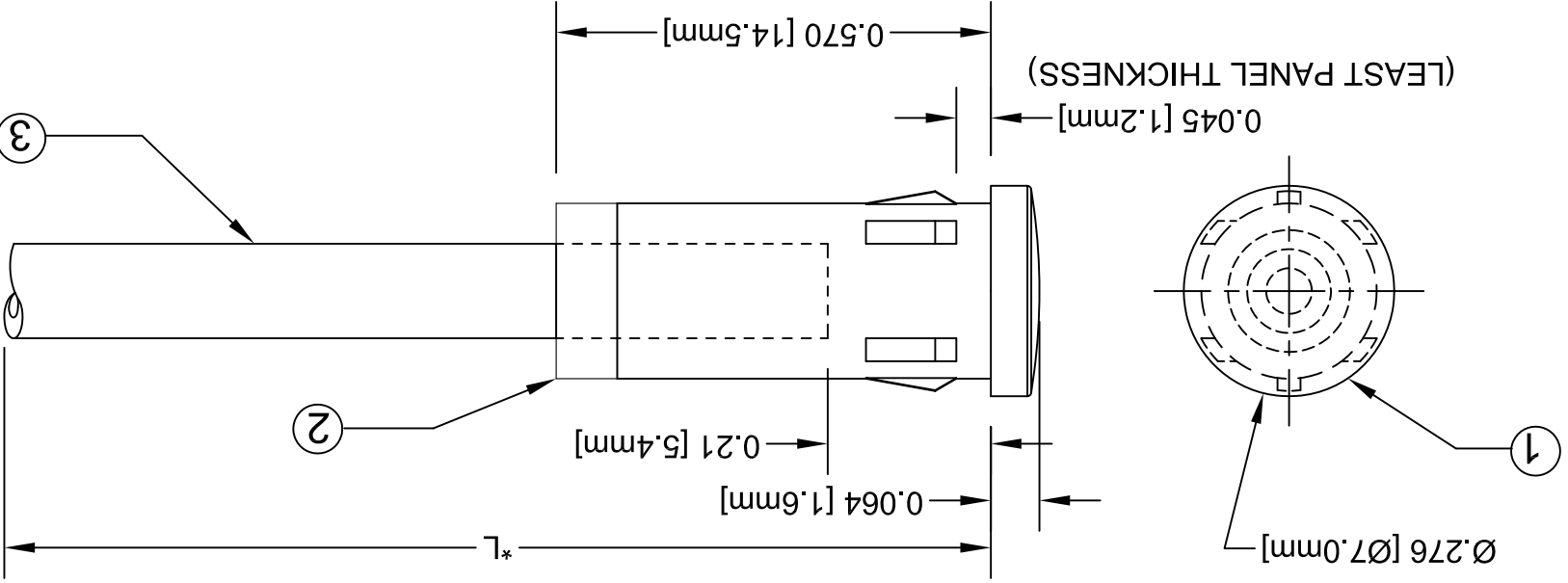

Tolerance	" L "
$\pm 0.050$ "	0.750" ~ 16.000"
$\pm 0.150$ "	16.100" ~ 40.000"
$\pm 0.300$ "	40.100" ~ 80.000"
$\pm 0.500$ "	80.100" ~ 3,940.0"

STANDARD TOLERANCE (UNLESS OTHERWISE SPECIFIED)		DATE: 09/14/09	
DECIMALS		DESIGNED: Brian Oliver	
ANGULAR		CHECKED: Fred Jensen	
$X^\circ \pm 1^\circ$		DATE: 09/14/09	
$.X \pm .1$		PART NO: FLP25-XX.X	
$.XX \pm .02$		CAGE CODE : 32559	
$.XXX \pm .010$		SHEET # 1 OF 1	
TITLE: LENS CAP / FLP ASSEMBLY, 7mm ROUND		REVISION: B	
4 THOMAS, IRVINE, CA, 92618 TEL: (949) 951-8808 FAX: (949) 951-3974 <b>BIVAR</b>			
CAD GENERATED DOCUMENT, DO NOT MEASURE DRAWING.			

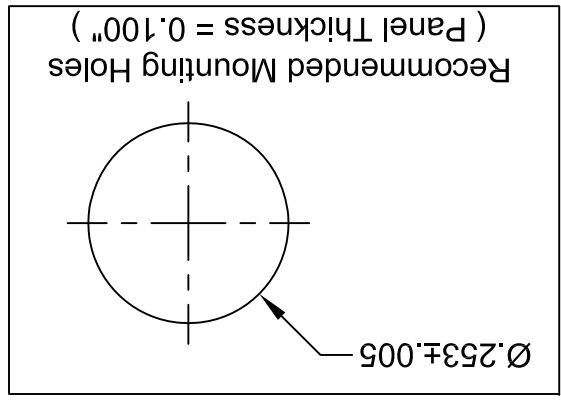

\*NOTE: ALLOWABLE CUT LENGTH IS UP TO 3 DECIMAL PLACES.

## X-ON Electronics

Largest Supplier of Electrical and Electronic Components

*Click to view similar products for [LED Light Pipes](#) category:*

*Click to view products by [Bivar](#) manufacturer:*

Other Similar products are found below :

[1367627-1](#) [SLP3-300-450-F](#) [SLP3-400-450-R](#) [LPA-C011301S-23](#) [LPA-C011301S-6](#) [LPF-C011306S](#) [515-1061-803F](#) [515-1142-170F](#) [515-1155F](#) [VLP-640-F](#) [LMC-034-CTP](#) [LPA-C011301S-5.4](#) [LPA-C041301S-2](#) [LPA-S011331S](#) [LPC\\_155\\_CTP](#) [LPC\\_182\\_CTP](#) [LPC\\_190\\_CTP](#) [515-1001-802F](#) [515-1027-803F](#) [515-1048-801F](#) [515-1142-195F](#) [515-1146F](#) [515-1148F](#) [515-1217F](#) [SLP3-150-300-R](#) [SLP3-500-450-R](#) [515-1058F](#) [515-1064-810F](#) [515-1114-801F](#) [FLPR-SBC](#) [FLPV-SG](#) [FLPR-SG](#) [BDL-1187](#) [7511A41](#) [7511A62V0](#) [7511F2](#) [FLPV-SBC](#) [SLP3-300-250-R](#) [5151064802F](#) [LPF-R011340S](#) [515-1166-801F](#) [FLPF-6.0](#) [SLP3-350-200-F](#) [LC-11.25](#) [CLP-1214](#) [1296.2044](#) [515-1064-808F](#) [FLX3\\_05](#) [515-1192-0025-0DF](#) [515-1192-80-3DF](#)