

Adapters

A variety of standard modular adapters to join or tap connections are available in Ivory plastic. Cross-wired types are for use in Voice - Telephone applications, and Straight-Wired for data applications. Contacts are gold plated.

Part No.	Description	Fig. No.
300024	4C "T" Adapter, Jack/Plug/Jack	225
300026	6C "T" Adapter, Jack/Plug/Jack	225
300028	8C "T" Adapter, Jack/Plug/Jack	225
300034	4C Inline Coupler, Jack/Jack - Cross Wired for Voice	226
300036	6C Inline Coupler, Jack/Jack - Cross Wired for Voice	226
300037	6C Inline Coupler, Jack/Jack - Straight Wired for Data	226
300038	8C Inline Coupler, Jack/Jack - Cross Wired for Voice	226
300039	8C Inline Coupler, Jack/Jack - Straight Wired for Data	226
300074	4C "T" Adapter, Jack/Jack/Jack	227
300124	4C "T" Junction, 3 Jacks, 1 Plug	229
300140	4C Modular Retrofit Adapter	228
300324	4C "T" Junction: 3 Jacks, 1 Plug (6X2 6X2 6X4 Jacks to 6x4 Plug)	230

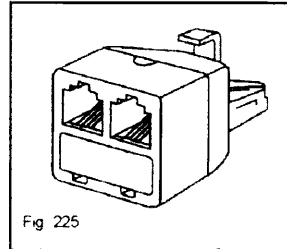

Fig 225

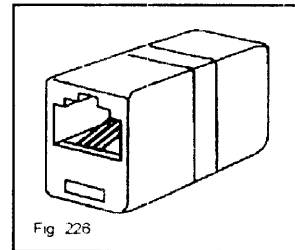

Fig 226

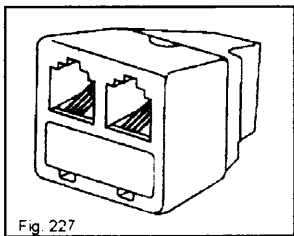

Fig 227

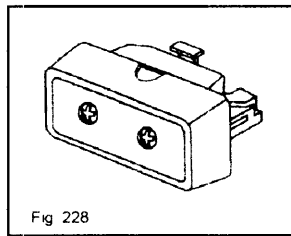

Fig 228

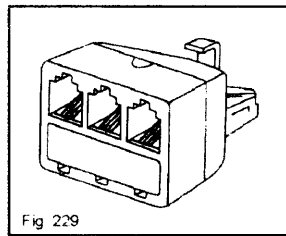

Fig 229

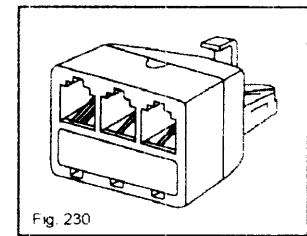

Fig 230

RJ45 Accessories

These extremely attractive boots will offer excellent strain relief on cables, protect the locking tab of the connector, and enable color coding for easy identification of cable. Especially useful on complex multi-port patch panels. No longer a need to buy colored cabled. Save money by buying larger bulk quantities of one color cable and apply these boots. Wall plates will fit Keystone RJ45 8 position and Inline Snap In RJ45 8 position jacks.

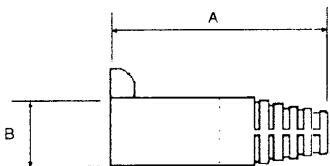
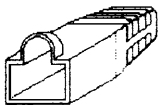

Fig 231

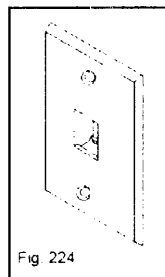
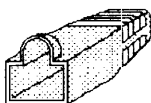

Fig 224



Part Number	"A" Dim.	"B" Dim.	Fig. No.	Description
CXB300BG	1.08	.381	231	RJ45 Strain Relief Cable Boots, Beige
CXB300BK	1.08	.381	231	RJ45 Strain Relief Cable Boots, Black
CXB300BL	1.08	.381	231	RJ45 Strain Relief Cable Boots, Blue
CXB300GN	1.08	.381	231	RJ45 Strain Relief Cable Boots, Green
CXB300GY	1.08	.381	231	RJ45 Strain Relief Cable Boots, Gray
CXB300RD	1.08	.381	231	RJ45 Strain Relief Cable Boots, Red
CXB300WT	1.08	.381	231	RJ45 Strain Relief Cable Boots, White
CXB300YL	1.08	.381	231	RJ45 Strain Relief Cable Boots, Yellow
310201	-	-	224	1 Cavity, Ivory, Keystone Wall Plate
310202	-	-	224	2 Cavity, Ivory, Keystone Wall Plate
310203	-	-	224	3 Cavity, Ivory, Keystone Wall Plate

X-ON Electronics

Largest Supplier of Electrical and Electronic Components

Click to view similar products for [Modular Connectors / Ethernet Connectors](#) category:

Click to view products by [Bomar Interconnect](#) manufacturer:

Other Similar products are found below :

[8949-H88/06BLKA/SN](#) [74441-0010/BKN](#) [MP1010RX-1000](#) [MP44RX-1000](#) [PHJ-4P4C-1-V-4](#) [PHP-6P6C-5](#) [GAX-3-66](#) [GAX-8-62](#) [GDCX-PA-66-50](#) [GDCX-PN-64](#) [GDCX-PN-66](#) [GDCX-PN-66-50](#) [GDLX-A-66](#) [GDLX-N-66](#) [GDLX-S-66](#) [GDLX-S-88K](#) [GDTX-S-88-50](#) [GDX-PA-1010](#) [GLX-N-1010M-BLK](#) [GLX-S-88M-BLK](#) [GMX-N-1010](#) [GMX-S-1010](#) [GMX-S-66](#) [GMX-SMT4-N-88](#) [GPX-2-64](#) [GSGX-N-2-88](#) [GSGX-N-4-88](#) [GSX-NS2-88-3.05](#) [GSX-NS2-88-3.05-50](#) [GSX-NS-88-3.05-50](#) [PT-108A-8C-UL](#) [PT-J951-8C](#) [PTS-J531-8CS-50UL](#) [1-1775629-2](#) [A-2014-0-4](#) [GWLX-S-88-GR](#) [GWLX-S9-88-YG](#) [DC-1021-8-WH-6](#) [1300530003](#) [1324640-4](#) [RJ11FTVC2G](#) [RJ11FTVC2N](#) [RJFTVX2SA1G](#) [132764-001](#) [1413235](#) [MP88X-1000](#) [MPS88RX-5000](#) [E5288-S000K3-L](#) [E5908-15A242-L](#) [155302-001](#)