

Specifications for BNC Connectors

BNC style connectors are miniature, light-weight, weatherproof interconnecting devices characterized by their two-stud, quick disconnect bayonet lock coupling arrangement. Their design functions satisfactorily from DC to 11 GHz in static applications, or from DC to 4GHz in applications involving vibration. The connectors typically yield a low VSWR (reflected signal) to 4GHz. Primary applications include radio telecommunications, broadcast equipment, medical equipment, computer, Precision Video, High definition studio broadcast, video switching and test instrumentation where frequent coupling and de-coupling are necessary. Bomar's BNCs are available in an extensive variety of configurations and cable sizes and are impedance matched to either 50 ohm or 75 ohm.

MATERIALS

Connector Parts	Material	Equivalent Standard
Connector Body and Parts	Brass	ISOCuZn38Pb2 Body Part
Male Contact Pin	Brass	QQ-B-626
Commercial Grade	Zinc Alloy/Brass	-----
Outer Contact	Brass	QQ-B-750
Socket Contact	Beryllium Copper	QQ-C-530 / MIL-H-7199
-----	Phosphor Copper	CuBe2
Crimp Ferrule	Annealed Copper	QQ-C-576
Insulators, Standard Versions	Teflon	L-P403 / BS4271
-----	Delrin	Grade B
Rubber Gaskets	Silicone Rubber	ASTM-E1418PSI
Plating	Nickel (Silver Optional)	MIL-G-45204

ELECTRICAL

Requirement	Performance		Test † Specification
Impedance	50W	75W	
Frequency Range	0-4GHz	0-1 GHz	-----
VSWR	1.30 Max.		MIL-C-39012
RF Insertion Loss	0.2 db Min. at 3 GHz		MIL-C-39012
RF Leakage	-55 db Min. at 3 GHz		MIL-C-39012
Test Voltage (At Sea Level)	1500V rms		MIL-STD-202
Working Voltage (At Sea Level)	500V rms		MIL-STD-202
Insulation Resistance	5000 Meg ohms Min.		MIL-STD-202
Contact Resistance	3 Milli ohms Max.		MIL-C-39012

MECHANICAL & ENVIRONMENTAL

Requirement	Performance	Test † Specification
Durability	500 Insertions & Extractions Min.	MIL-C-39012
Shock	50 G	MIL-STD-202
Vibration	20 G from 80-2000 Hz	MIL-STD-202
Cable Retention (Cable Types)	60 lbs. Minimum Pull Test	MIL-C-39012
Coupling Nut	60 lbs. Maximum	MIL-C-39012
Temperature Range	Teflon: -55 to +199 C Delrin: -40 to +85 C	----- -----
Moisture Resistance	Continuous Test	MIL-STD-202
Salt Spray	48 Hours	MIL-STD-202

†Products are made to conform to the Mil standard but are for commercial applications and are not QPL.

FOR TECHNICAL SUPPORT: PHONE 973-347-4040 / FAX 973-347-2111 [Back to Index](#)

1

3 Piece Crimp

BNC three piece crimp connectors feature semi-captive contacts that "click" into place assuring perfect installation. Each crimp pin has a vent hole for optional soldering. Soldering is recommended for all stranded conductors 26 AWG or smaller.

Part Number (Male)	RoHS	(LD) **	Fig. No.	RG/U Cable
310A205A	<input checked="" type="checkbox"/>	.200 In.	Fig. 1	6, 21 AWG Center Conductor
310A205A18	<input checked="" type="checkbox"/>	.200 In.	Fig. 1	6 CATV, 18 AWG Center Conductor
310A205F	<input checked="" type="checkbox"/>	.124 In.	Fig. 1	58A/U, 58C/U Stranded, 141, Thin PVC
310A205FS	<input checked="" type="checkbox"/>	.124 In.	Fig. 1	58/U Solid Conductor
310A205FV	<input checked="" type="checkbox"/>	.125 In.	Fig. 2	58/U Thin-Net Plenum
310A205FV2	<input checked="" type="checkbox"/>	.125 In.	Fig. 2	Mini 59, RGB Cable (23 AWG)
310A205FV3	<input checked="" type="checkbox"/>	.125 In.	Fig. 2	Mini 59, RGB Cable (26 AWG)
310A204G	<input checked="" type="checkbox"/>	.150 In.	Fig. 1	59, 62, 210
310A205G20	<input checked="" type="checkbox"/>	.150 In.	Fig. 1	RG59 20 AWG Center Cond.
310A205G23	<input checked="" type="checkbox"/>	.150 In.	Fig. 1	Belden 8241
310A205MV	<input checked="" type="checkbox"/>	.125 In.	Fig. 3	174, 178, 196, Mini RGB Cable 50 W
310B205MV	<input checked="" type="checkbox"/>	.125 In.	Fig. 3	174, 178, 196, Mini RGB Cable 75 W
310A205N	<input checked="" type="checkbox"/>	.090 In.	Fig. 3	179, 187
310A205P	<input checked="" type="checkbox"/>	.125 In.	Fig. 1	223
310B205Q	<input checked="" type="checkbox"/>	.205 In.	Fig. 1	Belden 8281 True 75 Ohms
310A204T	<input checked="" type="checkbox"/>	.150 In.	Fig. 2	59, 62, Plenum
310A208W2	<input checked="" type="checkbox"/>	.103 In.	Fig.1	Mini 59, RGB Cable (26 AWG)



Fig.1



Fig.2



Fig.3



Fig.4



Fig.5

RoHS compliant ** crimp shank

Twist-On and 2 Piece Crimp

BNC Twist-On connectors are field installable and require no tooling other than a stripping tool for the cable preparation. The center conductor is inserted into Bomar's unique Posi-Con™ contact, as the connector is twisted onto the cable's outer jacket. BNC 2 Piece crimp connectors make use of a fully captivated pin. Just insert the center conductor into the connector body, slide the ferrule over the braid, and apply a single hex-crimp to the ferrule. These connectors are easy to install and reliable and are recommended only for the lower data transmission speeds.

Part Number	RoHS	Gender	Fig. No.	RG/U Cable
310A405A	✓	Male	Fig. 8	6, Thick net
310A405F	✓	Male	Fig. 8	58A/U Solid Cond. 141, Thin PVC
310A405F1	✓	Male	Fig. 8	58/U Solid Cond. -.172"-.178"
310A405F2	✓	Male	Fig. 8	58/U Thin Plenum -.158"-.162"
310A405F3	✓	Male	Fig. 8	Thin Plenum .150"
310A405G	✓	Male	Fig. 8	59, 62, 210 PVC
310A405T	✓	Male	Fig. 8	59, 62, 210 Plenum
320A405F	✓	Female	Fig. 8A	58 Solid (PVC)
320A405G	✓	Female	Fig. 8A	59, 62, 210 (PVC)
310X205F	✓	Male	Fig. 6	RG58 (PVC)
310X205G	✓	Male	Fig. 6	RG59, 62 (PVC)
320X205F	✓	Female	Fig. 7	RG58 (PVC)
320X205G	✓	Female	Fig. 7	RG59, 62 (PVC)

✓ RoHS compliant



Fig.8A



Fig.8



Fig.6



Fig.7

Standard Clamp

BNC standard clamp style is a simplified version of the original military clamp style. It is required that the contact be soldered to the center conductor of the cable.

Part Number	RoHS	Gender	Fig. No.	RG/U Cable
310A105A	✓	Male	9	6
310A105D	✓	Male	9	11A
310A105F	✓	Male	9	58, 58A, 58C, 141
310A105G	✓	Male	9	59, 62, 210
310A105M	✓	Male	9	174, 188, 316
320A105F*	✓	Female	10	58, 58A, 58C, 141
320A105G*	✓	Female	10	59, 62, 214

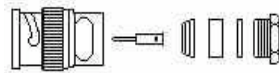

Figure 9



Figure 10

✓ RoHS compliant

Specialty Broadcast Plugs

[Click here for complete Broadcast Catalog](#)

Broadcast grade BNC connectors are perfectly matched to 75 ohm impedance's. The superior plugs are for studio wiring and other broadcast uses. Solid precision machined brass, not die-cast, hold up under the toughest conditions. Here, we are showing the eight most popular but there are many more versions matched to the popular cable manufacturer's part number.



Part Number	RoHS	Gender	Belden Cable
SBC1505A	✓	Male	1505A
SBC1694A	✓	Male	1694A
SBC1695A	✓	Male	1695A
SBC7731A	✓	Male	7731A
SBC8218	✓	Male	8218
SBC8241	✓	Male	8241
SBC8281	✓		

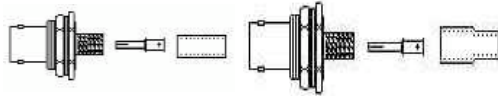

Figure 13

Figure 14

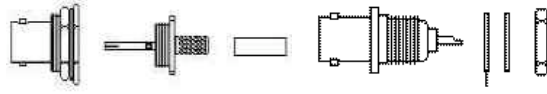

Figure 15

Figure 16

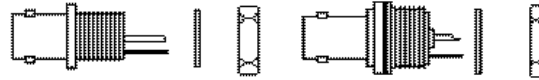

Fig. 17

Fig. 18



Part Number	RoHS	Description	Fig No.	Hole ID
321A245A	☑	R/M Crimp, RG6	13	.500
321A245F	☑	R/M Crimp, RG58 , Thin-net PVC	13	.500
321A245FV	☑	R/M Crimp, Thin-Net Plenum	14	.500
321A245G	☑	R/M Crimp, RG59, 62, 210	13	.500
321A245M	☑	R/M Crimp, RG174, 188, 196, 316	14	.500
321B245M*	☑	R/M Crimp, RG174, 188, 196, 316	14	.500
321B245N*	☑	R/M Crimp, RG179, 187	15	.500
326A515	☑	F/M Solder (Grounded)	16	.375
326R515	☑	F/M Solder (Isolated) White Bushing	17	.375
326R515RD	☑	F/M Solder (Isolated) Red Bushing	17	.375
326R515GN	☑	F/M Solder (Isolated) Green Bushing	17	.375
326R515BL	☑			

Panel Jacks and Plugs

BNC panel plugs and jacks are of machined brass construction for maximum reliability and quality. All contacts are plated with a minimum of five micro-inches of gold. The square panel types mount on .500 inch centers. The bulkhead type mounts into a .380 "D" shaped panel hole. All connector bodies are bright-nickel plated.

Part Number	RoHS	Description	Notations	Fig. No.
316A524C	✓	Male Bulkhead Panel Mount	.380" Mtg. Hole	19
317A507	✓	Male Panel Mount	.500 Mtg. Hole Centers	20
321A205F	✓	Female Panel Mount, Crimp	Fits RG58/U Cables	21
321A205G	✓	Female Panel Mount, Crimp	Fits RG59, 62, 210 Cables	21
321A205M	✓	Female Panel Mount, Crimp	Fits RG174, 178, 196	21
327A507	✓	Female Panel Mount, Solder	.500 Mtg. Hole Centers	22
✓ RoHS compliant				

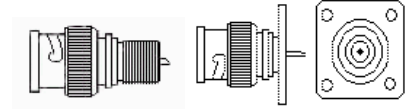

Figure 19

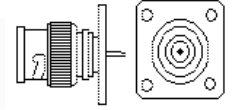

Figure 20

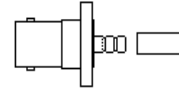

Figure 21

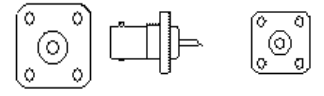

Figure 22

PC Board Vertical Jacks

BNC vertical mount jacks are available in straight PC mounts and "through-panel" styles. The "through-panel", 364 Series, is made in both isolated and grounded versions and are ideal for applications where multiple insertions will require a connector which can endure the stress of higher torque.

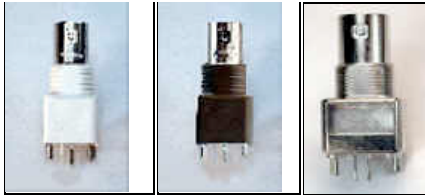

Fig. 23

Fig. 24

Fig. 25

Part Number	RoHS	Body Plating or Material	Description	Insul. Mat.	Con. Plating	"L" Dim	Fig. No.
361A514*	✓	Nickel / Brass	Straight PC Mount 50W	Teflon	Gold	.717	26
361A505*	✓	Nickel / Brass	Straight PC Mount 50 W	Delrin	Gold	.914	27
361A534*	✓	Nickel / Brass	3 Post PC Mount 50 W	Delrin	Gold	.788	27A
361A505APF	✓	Nickel/Zinc	4 Post W/ Press Fit Center Pin 50W	Delrin	Gold	.925	27B
361A705APF	✓	Nickel/Zinc	4 Post W/ Press Fit Center Pin 75W	Delrin	Gold	.925	27B
364S595	✓	White Valox	PC Mount, Thru-Panel, 50 W	Delrin	Gold	1.36	23
364S595B	✓	Black Valox	PC Mount, Thru-Panel, 50 W	Delrin	Gold	1.36	24
364S595M	✓	Nickel/Zinc	PC Mount, Thru-Panel, 50 W	Delrin	Gold	1.36	25
364S795*	✓	White Valox	PC Mount, Thru-Panel, 75 W	Delrin	Gold	1.36	23
364S795B*	✓	Black Valox	PC Mount, Thru-Panel, 75 W	Delrin	Gold	1.36	24
364S795M*	✓	Nickel/Zinc	PC Mount, Thru-Panel, 75 W	Delrin	Gold	1.3	25
✓ RoHS compliant reflow or wave solder RoHS compliant wave solder only							

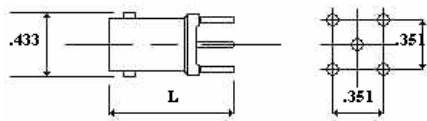

Fig. 26



The press-fit center pin locks the connector into the PC board so it is held firmly for reflow or wave soldering.

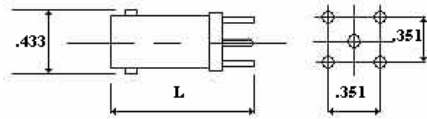
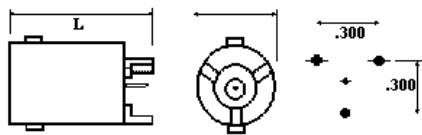

Fig. 27B



These BNC jacks are manufactured to the highest standards to assure stability in maintaining impedance matching at 50 ohm and 75 ohm applications. The 50 ohm versions have been approved by most of the U.S. manufacturers of LAN cards, and the 75 ohm is in wide use in High Definition Video applications which require the use of a True 75 ohm connector. Contacts are phosphor bronze and will remain resilient even after hundreds of insertions.

Black Valox (75W) Lo-Profile W/ Posts (TPX) 50W .515 Gold 31
N/A

Part Number	3030	Body Material	Description	Imp.	Height F.M.S.	Contact Plating	Fig. No.
364M095	✓	Nickel/Zinc	4 Post Low Profile, Metal	50W	.453	Gold	38
364M0975	✓	Nickel /Zinc	4 Post Low Profile, Metal	75W	.453	Gold	38
364A595	✓	White Valox	Standard Profile W/ Posts	50W	.610	Gold	28
364A595T	✓	White Valox	Standard Profile W/ Posts (TPX)	50W	.610	Gold	28
364A595NP*	✓	White Valox	Standard Profile WO Posts	50W	.610	Gold	35
364A595NPT*	✓	White Valox	Standard Profile WO Posts (TPX)	50W	.610	Gold	35
364A595B	✓	Black Valox	Standard Profile W/ Posts	50W	.610	Gold	30
364A595BT	✓	Black Valox	Standard Profile W/ Posts (TPX)	50W	.610	Gold	30
364A595BNP*	✓	Black Valox	Standard Profile WO Posts	50W	.610	Gold	35
364A595BNPT*	✓	Black Valox	Standard Profile WO Posts (TPX)	50W	.610	Gold	35
364A595BL	✓	White Valox	Lo Profile W/ Posts	50W	.515	Gold	29
364A595BLT	✓	White Valox	Lo Profile W/ Posts (TPX)	50W	.515	Gold	29
364A595BLNP*	✓	White Valox	Lo-Profile W/O Posts	50W	.515	Gold	34
364A595BLB	✓	Black Valox	Lo-Profile W/ Posts	50W	.515	Gold	31
364A595BLBT	✓						

364A595BLBNP*	✓	Black Valox	Lo-Profile W/O Posts	50W	.515	Gold	34
364M595	✓	Nickel /Zinc	Standard Profile W/ Posts	50W	.620	Gold	32
364M595T	✓	Nickel /Zinc	Standard Profile W/ Posts (TPX)	50W	.620	Gold	32
364M595M	✓	Nickel /Zinc	Super Lo-Profile W/ Clips	50W	.340	Gold	35A
364M595MT	✓	Nickel /Zinc	Super Lo-Profile W/ Clips (TPX)	50W	.340	Gold	35A
364M595L	✓	Nickel / Zinc	Lo-Profile W/ Posts	50W	.529	Gold	33
364M595LT	✓	Nickel / Zinc	Lo-Profile W/ Posts (TPX)	50W	.529	Gold	33
364A595NP	✓	White Valox	Standard Profile WO Posts	50W	.610	Gold	35
364A595NPT	✓	White Valox	Standard Profile WO Posts (TPX)	50W	.610	Gold	35
364A595BNP*	✓	Black Valox	Standard Profile WO Posts	50W	.610	Gold	35
364A595BLNP*	✓	White Valox	Lo-Profile W/O Posts	50W	.515	Gold	-
364A595BLBNP*	✓	Black Valox	Lo-Profile W/O Posts	50W	.515	Gold	34
364A795	✓	White Valox	Standard Profile W/ Posts (TPX)	75W	.610	Gold	28
364A795T	✓	White Valox	Standard Profile W/ Posts	75W	.610	Gold	28
364A795B	✓	Black Valox	Standard Profile W/ Posts	75W	.610	Gold	30
364A795BT	✓	Black Valox	Standard Profile W/ Posts (TPX)	75W	.610	Gold	30
364A795BL	✓	White Valox	Lo-Profile W/ Posts	75W	.515	Gold	29
364A795BLT	✓	White Valox	Lo-Profile W/ Posts (TPX)	75W	.515	Gold	29
364A795BLB	✓	Black Valox	Lo-Profile W/ Posts	75W	.515	Gold	31
364A795BLBT	✓	Black Valox	Lo-Profile W/ Posts (TPX)	75W	.515	Gold	31
364M795	✓	Metal	Standard Profile W/ Posts	75W	.620	Gold	32
364M795T	✓	Metal	Standard Profile W/ Posts (TPX)	75W	.620	Gold	32
364M795L	✓	Metal	Lo-Profile W/ Posts	75W	.529	Gold	33
364M795LT	✓	Metal	Lo-Profile W/ Posts (TPX)	75W	.529	Gold	33
364F595BL	✓	White Valox	9400pF 500V Decoupled	50W	.515	Gold	36
364F595BLB	✓	Black Valox	9400 pF 500V Decoupled	50W	.515	Gold	37
364H595BL	✓	White Valox	9400 pF 1500V Decoupled	50W	.515	Gold	36
364H595BLB	✓	Black Valox	9400 pF 1500V Decoupled	50W	.515	Gold	37
364NT	✓	Zinc/Brass	Jam Nut (364 Series)	N/A	----	----	36N
364LW	✓	Zinc/ Steel	Lock Washer (364Series)	N/A	----	----	37N
364 KNT	✓	Brass/Nickel	Knurled Nut (364 Series)	N/A	----	----	38N



Fig. 28



Fig. 29



Fig. 30



Fig. 31



Fig. 32



Fig. 33



Fig. 34



Fig. 35



Fig. 36 (top) Fig. 37

✓ RoHS compliant reflow or wave solder ✓ RoHS compliant wave solder only

(TPX) insulator for re-flow solder

Board Clips Are Available In Place of Posts. Add Suffix "C"



Spear-point clips lock snugly into the board.

Hardware

Fig. 36N

Fig. 37N

Note:
Mounting hardware is optional and must be ordered separately. Hardware is not sold without the connectors.

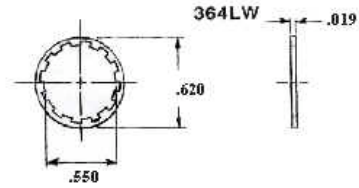
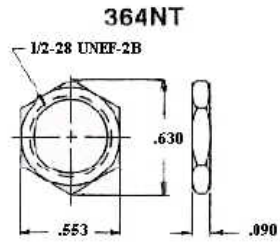
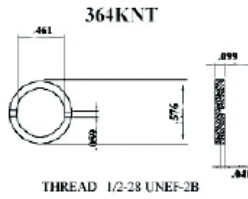

Fig. 38N



* Denotes that items are not popular and may require a special minimum order quantity.



V-Bite® PC Edge Mount

The **V-Bite®** is an industry award winning design PCB connector with all the advantages a designer could want. It edge mounts to the board which offers the lowest profile and utilizes very little PCB real estate. It lends itself to surface mount and through-hole soldering techniques. There are versions for IR and convection reflow soldering. Because the connector locks into place both above and below the PCB it disperses rotational torque relief to the board and not the solder points. The **V-Bite®** design offers the lowest VSWR ratings due to the straight through-put contact design. No right angles for reflection. Available in 50 and 75 ohm, threaded and non-threaded. Other options for PCB thickness available. Other interfaces available. (See "F", BNC Twin and TNC sections.)

Part Number	RoHS	Description	Imp	Contact	Fig. No.
361V504ER	✓	BNC Jack W/ Teflon For Reflow Solder	50W	Phos./Gold	39A
361V504ET	✓	BNC Threaded Jack W/ Teflon For Reflow Solder	50W	Phos./Gold	39
361V509E	✓	BNC Jack W/ Polyethylene Insulator	50W	Phos./Tin	39A
361V509ET	✓	BNC Threaded Jack W/ Polyethylene Insulator	50W	Phos./Tin	39
361V704ER	✓	BNC Jack W/ Teflon For Reflow Solder	75W	Phos./Gold	39A
361V704ET	✓	BNC Threaded Jack W/ Teflon For Reflow Solder	75W	Phos./Gold	39
361V704EFT	✓	BNC Threaded Jack W/ Teflon Insulator/Flange	75W	Phos./Gold	39B
361V709E	✓	BNC Jack W/ Polyethylene Insulator	75W	Phos./Gold	39A
361V709ET	✓	BNC Threaded Jack W/ Polyethylene Insulator	75W	Phos./Gold	39
361KNT	✓	Knurled Nut (361 Series)	NA	---	---
3M61V704	✓	Mini- BNC Jack W/ Teflon for Reflow Solder	75W	Phos./Gold	39C

RoHS compliant reflow or wave solder
 RoHS compliant wave solder only



Low Profile .270 High FMS
Anti Rotational
VSWR 1.15:1
Patented V-Bite® Snaps Into PCB
Surface Mount Center Contact
Pick & Place Version Available



Fig. 39



Fig. 39B

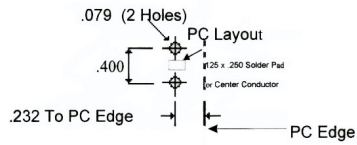

Fig. 39C

Reduced Size PCB Right Angle Mount

The Super Low™ Profile BNC PC jack reduces the amount of board space needed to mount a PC jack. Board clips hold the unit in place for soldering. The smallest, lowest profile right angle BNC jack available.

The Lo-Deco™ features a four post design that offers greater stability after wave soldering. Also featured is a gold plated contact and nickel plated cast zinc body. Smooth, sleek and aesthetically pleasing design is tumbled to remove casting lines.

Part Number	RoHS	Description	Imp.	Contact	Fig. No.
364M595M	✓	BNC Super Low Profile Jack	50W	Phos./Gold	35A
364M595MT	✓	BNC Super Low Profile Jack	50W	Phos./Gold	35A
364M795M	✓	BNC Super Low Profile Jack	75W	Phos./Gold	35A
364M795MT	✓	BNC Super Low Profile Jack	75W	Phos./Gold	35A
364M095	✓	BNC Lo-Deco Jack	50W	Phos./Gold	38
364M0975	✓	BNC Lo-Deco Jack	75W	Phos./Gold	38

RoHS compliant reflow or wave solder
 RoHS compliant wave solder only



Fig 35A

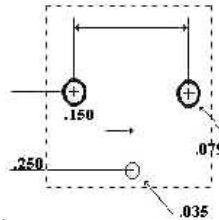

PC Layout for Super Low Profile



Fig. 38

Dual PC Jacks (Threaded)

Right Angle or Vertical Stacked: When board space becomes a serious issue and you still need the robust, full size, BNC connectors, a dual stacked right angle or vertical version will do the trick. Assembly insertion time is cut in half as well. The Dual 364 series is available in both Valox isolated and all metal construction.

(shown with closed back option FS)



Fig. 38A

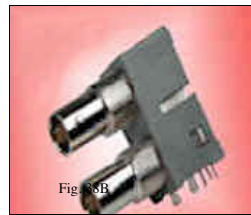

Fig. 38B



Fig. 40D



Fig. 38C

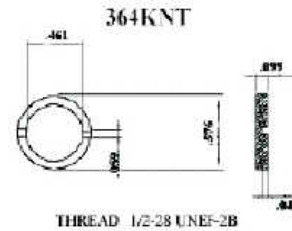

Fig. 38D



Fig. 38E

Right Angle					
Part Number	RoHS	Description	Imp.	Contact	Fig.No.
364A2595	✓	Dual Right Angle, White Valox	50W	Phos./Gold	38A
364A2595T	✓	Dual Right Angle, White Valox (TPX)	50W	Phos./Gold	38A
364A2795	✓	Dual Right Angle, White Valox	75W	Phos./Gold	38A
364A2795T	✓	Dual Right Angle, White Valox (TPX)	75W	Phos./Gold	38A
364A2595B	✓	Dual Right Angle, Black Valox	50W	Phos./Gold	38A
364A2795B	✓	Dual Right Angle, Black Valox	75W	Phos./Gold	38A
364M2595	✓	Dual Right Angle, Metal	50W	Phos./Gold	38B
364M2595T	✓	Dual Right Angle, Metal (TPX)	50W	Phos./Gold	38B
364M2795	✓	Dual Right Angle, Metal	75W	Phos./Gold	38B
364M2795T	✓	Dual Right Angle, Metal (TPX)	75W	Phos./Gold	38B
3M64M2795	✓	Dual Right Angle, Metal Mini-BNC	75W	Phos./Gold	38C
364KNT	✓	Knurled Nut for Dual BNC	N/A	Brass/Nickel	38D
Vertical					
Part Number	RoHS	Description	Imp.	Contact	Fig.No.
364S2595	✓	Dual Vertical, White Valox	50W	Phos./Gold	40D
364S2795	✓	Dual Vertical, White Valox	75W	Phos./Gold	40D
364S2595B	✓	Dual Vertical, Black Valox	50W	Phos./Gold	40D
364S2795B	✓	Dual Vertical, Black Valox	75W	Phos./Gold	40D
364S2595M	✓	Dual Vertical, Metal	50W	Phos./Gold	----
364S2795M	✓	Dual Vertical, Metal	75W	Phos./Gold	----
Tool					
Part Number	RoHS	Description	Imp.	Contact	Fig.No.
BD36400	-	Hex Shafted Tool for Knurled Nut	N/A	Steel/Nickel	38E
<input checked="" type="checkbox"/> RoHS compliant reflow or wave solder <input checked="" type="checkbox"/> RoHS compliant wave solder only					
Note: Hardware is optional and must be ordered separately					

Multi-Port PC Jacks (Non-Threaded)

Side By Side: These right angle units are available in dual or quad configurations. These units are not threaded for panel installation using a jam nut. Up one fourth the installation time.

Part Number	RoHS	Description	Imp.	Contact	Fig. No.
365A2595	✓	Dual Right Angle, Side By Side White Valox	50W	Phos./Gold	38B
365A2795	✓	Dual Right Angle, Side By Side White Valox	75W	Phos./Gold	38B
365A2595B	✓	Dual Right Angle, Side By Side Black Valox	50W	Phos./Gold	38B
365A2795B	✓	Dual Right Angle, Side By Side Black Valox	75W	Phos./Gold	38B
365A4595	✓	Quad Right Angle, Side By Side White Valox	50W	Phos./Gold	38C
365A4795	✓	Quad Right Angle, Side By Side White Valox	75W	Phos./Gold	38C
365A4595B	✓	Quad Right Angle, Side By Side Black Valox	50W	Phos./Gold	38C
365A4795B	✓	Quad Right Angle, Side By Side Black Valox	75W	Phos./Gold	38C
<input checked="" type="checkbox"/> RoHS compliant reflow or wave solder <input checked="" type="checkbox"/> RoHS compliant wave solder only					

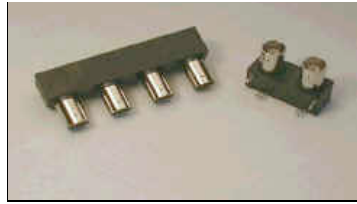

LED Indicator PC Jacks

This unthreaded BNC PCB series is available with amber and green LEDs that are embedded into the Valox body alongside of each BNC port. They can be used to indicate various situations, or conditions of communications through the connector. Single and dual, and quad side by side styles are available.

Part Number	RoHS	Description	Imp	Contact	Fig. No.
365AL595	✓	BNC Single Port, White	50W	Phos./Gold	38E
365AL595B	✓	BNC Single Port, Black	50W	Phos./Gold	---
365AL2595	✓	BNC Dual Port, White	50W	Phos./Gold	---
365AL2595B	✓	BNC Dual Port, Black	50W	Phos./Gold	---
365AL4595	✓	BNC Quad Port, White	50W	Phos./Gold	38
365AL4595B	✓	BNC Quad Port, Black	50W	Phos./Gold	38

RoHS compliant reflow or wave solder
 RoHS compliant wave solder only



Fig 38E

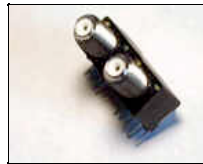
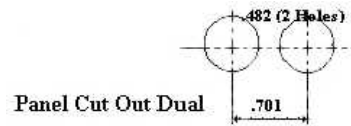
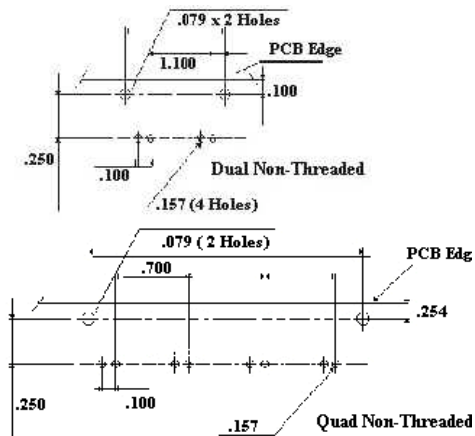
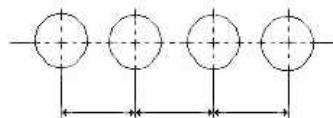

Fig. 38

PCB and Panel Layouts for 365 Series



Panel Cut Out Dual



Panel Cut Out Quad

LED BNC

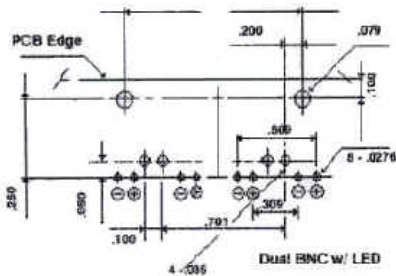

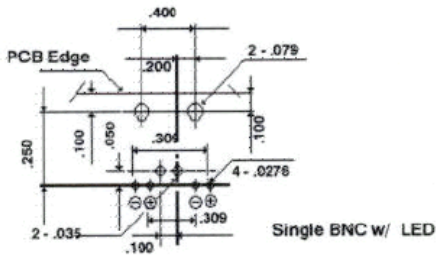

Adapters

These sturdy within-series BNC adapters are available in all standard designs. Additionally, several unique constructions compliment the product group and allow adaptations for every conceivable application. All connector bodies are plated with bright nickel. Male contacts are brass, female contacts are phosphor bronze. All contacts are plated with 5 micro inches of gold.

Part Number	RoHS	Description	Fig. No.
330A505	✓	Male/ Male Inline Barrel Splice	35
332A505	✓	Female/Female Inline Splice	36
335A544	✓	Female/Female Inline Bulkhead Mount (Grounded)	37
335R544	✓	Female/Female Inline Isolated Bulkhead (Metal Outer Thread)	37
343A205F	✓	Crimp "T" Adapter for RG58 Cable	41
343A205G	✓	Crimp "T" Adapter for RG59, 62 Cables	41
343A505	✓	Female/Male/Female "T" Adapter (Yes, it runs with Netware™)	38
345A505	✓	Female/Female/Female "T" Adapter	39
351A505	✓	Female/Male Right Angle Adapter	40
383U505	✓	The Goalie™	42
383U205F	✓	The Goalie Brute™ Crimp Version for RG58 Cable	45
383U205G	✓	The Goalie Brute™ Crimp Version for RG59, 62 Cables	45
383K505*	✓	The Goalie Brute™	43
383P505*	✓	The Insulated Goalie	44
353U205F*	✓	Male/Female/Female Right Angle Double-Down™ Crimp for RG58	49
353U205G*	✓	Male/Female/Female Right Angle Double-Down™ Type for RG59	49
353U505*	✓	Male/Female/Female Right Angle Double-Down™	48
393U205F*	✓	Male/Female/Female Straight Double-Down™ Crimp for RG58	47
393U205G*	✓	Male/Female/Female Straight Double-Down™ Crimp for RG59	47
393U505*	✓	Male/Female/Female Straight Double-Down™	46
✓ RoHS compliant			

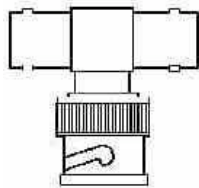

Fig. 38

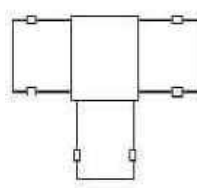

Fig. 39

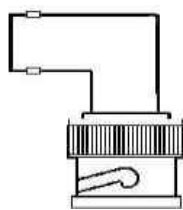

Fig. 40

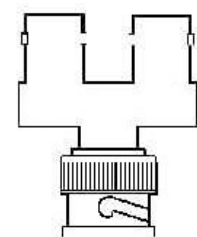

Fig. 42

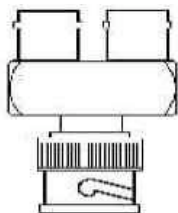

Fig. 43

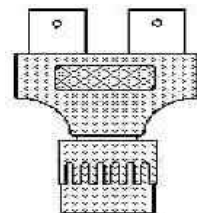

Fig. 44



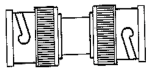

Fig. 35

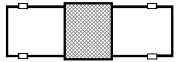

Fig. 36



Fig. 37

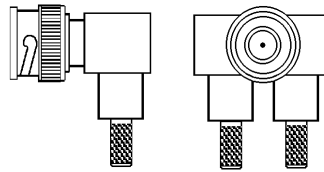

Fig. 48

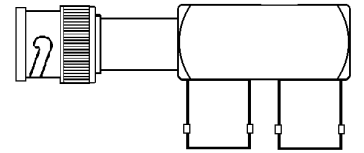

Fig. 46

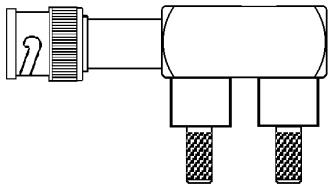

Fig. 41

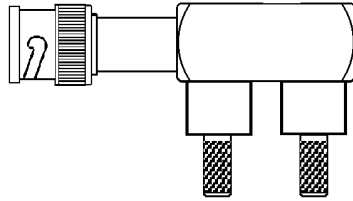

Fig. 49

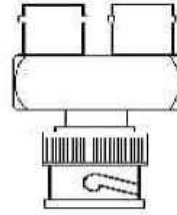

Fig. 45

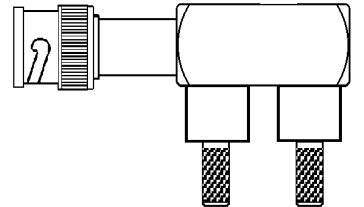

Fig. 47

Specialty LAN Adapters

Double Down™ adapters are designed to allow parallel cables entering a patch panel, or a BNC LAN terminal port to be guided at a right angle to the input jack. Two versions accomplish this: one is a right angle with side-by-side jacks for areas with little rear clearance, and the other is a straight version for installations where width between panel jacks is limited. Crimp types are for permanent installations. Goalie, and Goalie Brute allow parallel cable 90° entry which require a minimum of rotational cable space.



*Minimum quantity Requirements May Apply - Contact Sales

Terminators

BNC terminators are available in standard 1% tolerance versions and in the economy 5% tolerance styles. The standard types have removable color coded caps for easy identification. The economy type are color coded as well but caps are not removable.

Part Number	RoHS	Description	Fig. No.
310X054A	✓	50 W with Red Cap	50
310C054	✓	50 W with Grounding Chain	51
310X074	✓	75 W with Blue Cap	50
HBC310X075	✓	75 W Precision .1% Tolerance	52
310X094	✓	93 W with Yellow Cap	50
HBC310X075	✓	75 W Precision .1% Tolerance	53
EJ175	✓	50 W Economy	52A
EJ177	✓	75 W Economy	52A
EJ179	✓	93 W Economy	52A

✓ RoHS compliant



Fig. 50



Fig. 51



Fig. 52



Fig. 52A



Coax Crimp Tools

Professional grade hex-crimp tools for coaxial connectors are available in ratchet and non-ratcheting types, both provide dependable service. Ratchet tools feature replaceable dies. Included is a convenient release mechanism to unlatch the ratchet in the event of an improper crimp. Each too also crimps the contact pin to the conductor.

Part Number	Description
BD10100	Hex Crimp Ratchet for "F" Types, RG59, RG6
BDHD100	Hex Crimp Ratchet for Belden 8281
BDHD200	Hex Crimp Ratchet for BNC/TNC RG58,59,62 and MV
BDHD100	Hex Crimp Ratchet for Mini-RG59
BD11012	Hex Crimp Ratchet for "N" Crimp RG11, RG213, RG214
BDHD100	Hex Crimp Ratchet for BNC/TNC RG6, RG59

X-ON Electronics

Largest Supplier of Electrical and Electronic Components

Click to view similar products for [RF Connectors / Coaxial Connectors](#) category:

Click to view products by [Bomar Interconnect](#) manufacturer:

Other Similar products are found below :

[R125315120](#) [8915-1511-000](#) [89674-0827](#) [5916-1103-603](#) [0106-001-000](#) [6-0001-3](#) [6001-7071-019](#) [6002-7051-003](#) [6002-7551-202](#) [6059674-1](#) [619550-1](#) [630059-000](#) [M39012/25-0021](#) [M39012/79-3008](#) [M39030/3-01N](#) [M39030/3-03N](#) [M3933/25-29N](#) [M3933/25-36N](#) [6500-7071-046](#) [6501-1071-002](#) [M83723/72W24576](#) [M83723/72W2457N](#) [6769](#) [CX050L2AQ](#) [7002-1541-010](#) [7002-1572-002](#) [7003-1572-002](#) [7004-1512-000](#) [7009-1511-004](#) [7010-1511-000](#) [7029-1511-060](#) [7101-1541-010](#) [7101-1571-002](#) [7105-1521-002](#) [7145-1521-002](#) [7209-1511-011](#) [7210-1511-012](#) [7210-1511-015](#) [7210-1511-019](#) [7210-1511-040](#) [7225-1512-050](#) [7242-1511-000](#) [73137-5015](#) [73251-0111](#) [73251-0672](#) [73276-1501](#) [73366-0013](#) [73404-2300](#) [73413-6080](#) [734151610](#)