

| | | |
|------|-------------|------------|
| REV. | DESCRIPTION | DATE |
| A | RELEASE | 2010.11.23 |

MATERIAL&FINISH
 Insulator: PBT Glass Fiber(UL94V-0)
 Contact : Brass/Phosphorus bronze
 Contact : Gold-Plated Over Nickel.
 SPECIFICATIONS
 Current Rating :1A AC,DC
 Voltage Rating : 250V AC,DC
 Temperature Range:-40°C To+105°C
 Contact Resistance:20mΩ Min
 Insulation Resistance:1000MΩ Min
 Withstanding Voltage:500V AC/Min

| PART NO | Dim. A | Dim. B |
|---------|--------|--------|
| MFC-6P | 4.0 | 11.2 |
| MFC-8P | 6.0 | 13.2 |
| MFC-10P | 8.0 | 15.2 |
| MFC-12P | 10.0 | 17.2 |
| MFC-14P | 12.0 | 19.2 |
| MFC-16P | 14.0 | 21.2 |
| MFC-18P | 16.0 | 23.2 |
| MFC-20P | 18.0 | 25.2 |
| MFC-22P | 20.0 | 27.2 |
| MFC-24P | 22.0 | 29.2 |
| MFC-26P | 24.0 | 31.2 |
| MFC-28P | 26.0 | 33.2 |
| MFC-30P | 28.0 | 35.2 |
| MFC-34P | 32.0 | 39.2 |
| MFC-36P | 34.0 | 41.2 |
| MFC-40P | 38.0 | 45.2 |
| MFC-44P | 42.0 | 49.2 |
| MFC-50P | 48.0 | 55.2 |

| | | |
|------------------|------------|--------|
| UNLESS TOLERANCE | DRAW BY | YUAN |
| | DESIGN BY | YUAN |
| GENERAL | CHECK BY | |
| | APPROVE BY | |
| ANGLE | | |
| X. ± 0.30 | | |
| X. ± 0.20 | | |
| .XX ± 0.15 | | |
| .XXX ± 0.10 | | |
| .XXX ± 0.5 | | |
| SCALE | SHEET | 1/1 |
| UNIT | MM | |
| ITEM : IDC2.0系列 | | |
| DRW NO: | MFC-XP | REV: A |

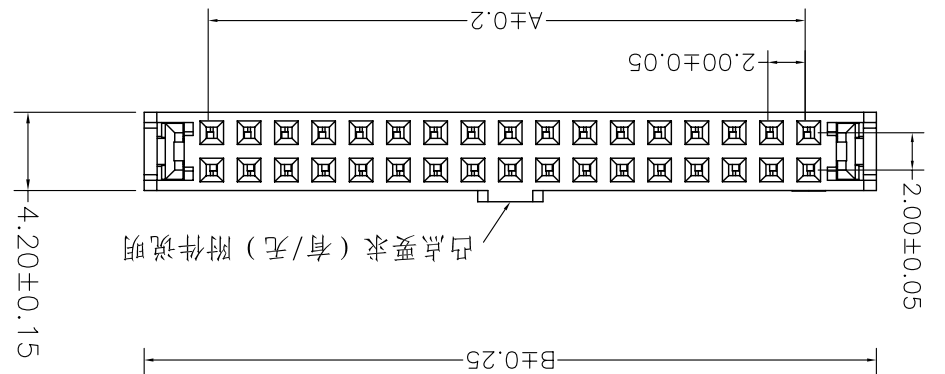
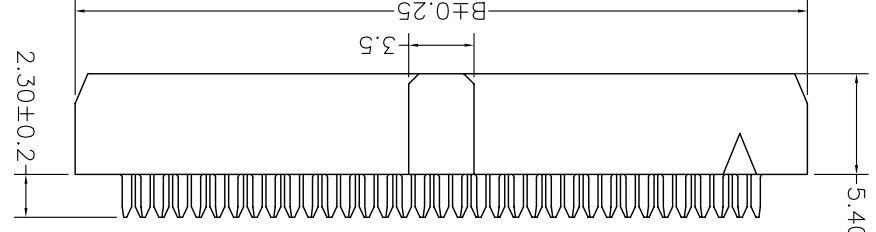
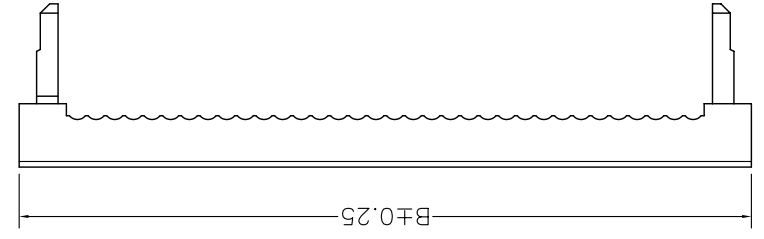
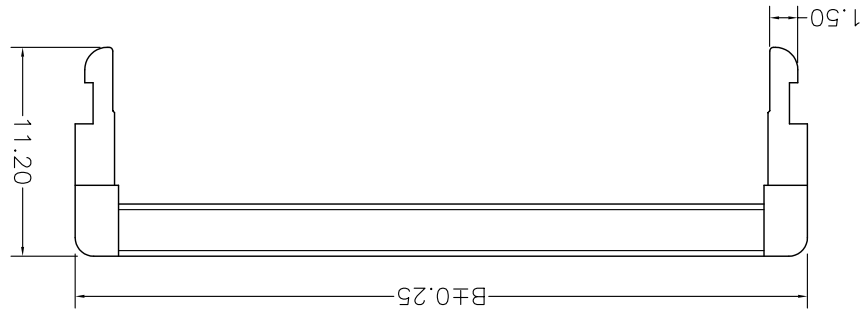
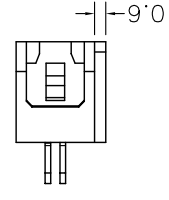
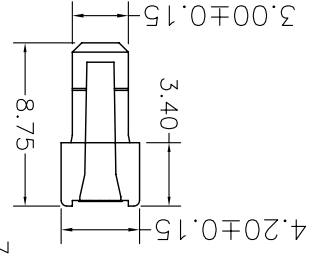
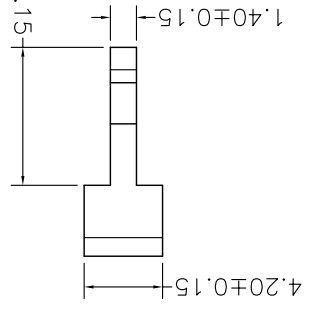

凸点要求 (有/无) 附件说明

X-ON Electronics

Largest Supplier of Electrical and Electronic Components

Click to view similar products for [Headers & Wire Housings](#) category:

Click to view products by [Boom](#) manufacturer:

Other Similar products are found below :

[95000-104TRLF](#) [10135584-644402LF](#) [DF62W-EP2022PCA](#) [95000-106TRLF](#) [DF62W-2022SCA](#) [DF62W-EP2022PC](#) [2203348](#) [DF62W-2022SC](#) [1084018](#) [1029039](#) [1084017](#) [802-10-012-10-002000](#) [1112640](#) [1112639](#) [891-007-9SS-BST1T](#) [000-34000](#) [0008550134](#) [0009482033](#) [0009507031](#) [57102-F02-18ULF](#) [57102-S06-03LF](#) [57202-S52-04LF](#) [PCN6-15S-2.5E](#) [0039019024](#) [58102-G61-06LF](#) [582553-1](#) [0009485154](#) [0009508121](#) [0022285053](#) [0050291907](#) [018731A](#) [LY20-4P-DT1-P1E-BR](#) [02.125.8002.8](#) [60101931](#) [60598-1 \(Cut Strip\)](#) [M1625-3R/100](#) [61062-3](#) [61082-181009](#) [CSU011177004](#) [636-1427](#) [638009-1](#) [641938-9](#) [641991-4](#) [644168-1](#) [644827-2](#) [647662-1](#) [65039-019ELF](#) [65692-001LF](#) [65781-018](#) [65781-047](#)