

技术指标 (Technical Index):

- 塑件表面应光洁、无毛边、无明显收缩、缺陷、裂纹等现象. (The surface of the plastic parts should be smooth, no rough edges, no obvious shrinkage, defects, cracks and other phenomena)
- 锁扣窗口: 2~3PIN为1个, ≥4PIN为2个. (Lock Configuration: 2 to 3Pin is 1, ≥4Pin is 2)
- 温度范围 (Temperature range): -25° C~+85° C.
- 额定电压 (Rated voltage): 125V, AC/DC (=等效).
- 接触电阻 (Contact resistance): ≤0.02Ω.
- 绝缘电阻 (Insulation resistance): ≥100MΩ
- 产品料号 (Product material No.):

版次	变更摘要	日期
0		

序号	品名	材质
①	A型立式DIP型WTB胶芯 1.25 Pitch S/T Wire To Board Housing DIP(H=4.7)	PA66 UL94V-0 本色(常规用料) Natural/PA66 General/PA66 Natural LCP UL94V-0 本色Natural
②	A型立式DIP型WTB端子 1.25 Pitch S/T Wire To Board Terminal DIP(H=4.7)	铜合金/表面镀锡 Copper Alloy/ Tin Plating

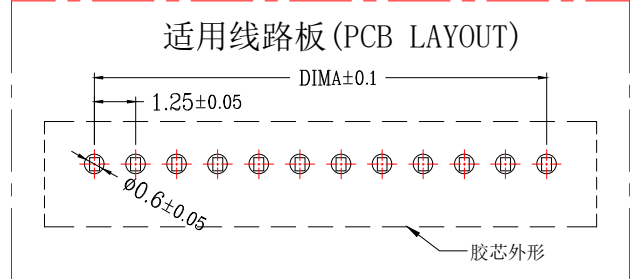
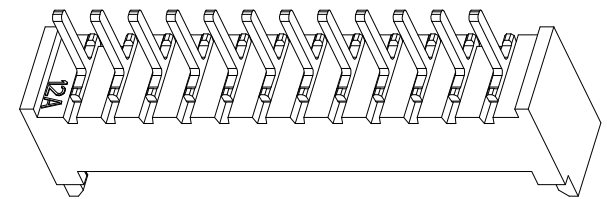
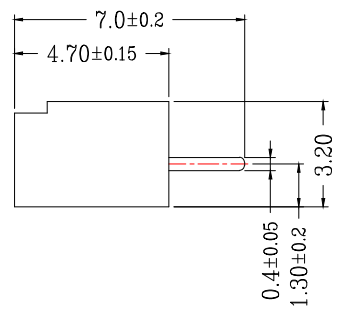
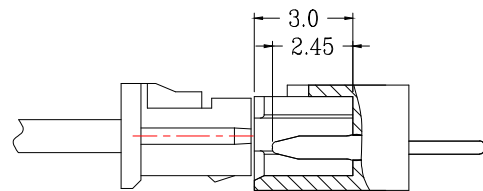

CKT	DIM A	DIM B	DIM C
2	1.25	3.20	4.30
3	2.50	4.45	5.55
4	3.75	5.70	6.80
5	5.00	6.95	8.05
6	6.25	8.20	9.30
7	7.50	9.45	10.55
8	8.75	10.70	11.80
9	10.00	11.95	13.05
10	11.25	13.20	14.30
11	12.50	14.45	15.55
12	13.75	15.70	16.80
13	15.00	16.95	18.05
14	16.25	18.20	19.30
15	17.50	19.45	20.55
16	18.75	20.70	21.80
17	20.00	21.95	23.05
18	21.25	23.20	24.30
19	22.50	24.45	25.55
20	23.75	25.70	26.80

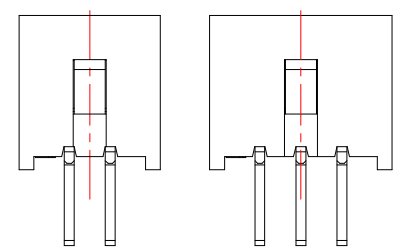

2 PIN 3 PIN  
LOCK CONFIGURATION (锁扣位置)



一般公差 (TOLERANCE)
X: ±.50 XX ±1.0
.X ±.20 .XXX ±.05
ANGLES ±1°



品名 (TITLE) 单排MX1.25 n*Pin 直针 红色/黄色	制图 (DR) (CHKD)
料号 (DWG.NO) BX-MX1.25-nPZZ-R	审核 (APPD)
比例 (SCALE) 1:1	单位 (UNITS) mm
张数 (SHEET) 1 OF 1	SIZE A4
REV A	

## X-ON Electronics

Largest Supplier of Electrical and Electronic Components

*Click to view similar products for [Headers & Wire Housings](#) category:*

*Click to view products by [Bossie](#) manufacturer:*

Other Similar products are found below :

[0015917161](#) [0022155065](#) [57102-F02-18ULF](#) [58102-G61-06LF](#) [582553-1](#) [01.001.5753.1](#) [0050291907](#) [02.125.8002.8](#) [609-3404](#) [61062-3](#)  
[CSU011177004](#) [622-0430](#) [622-3653LF](#) [63453-116](#) [636-1030](#) [636-1427](#) [636-3427](#) [636-4007](#) [641938-9](#) [65495-038](#) [65692-001LF](#) [65781-018](#)  
[65781-047](#) [65817-010LF](#) [65817-015LF](#) [67095-007LF](#) [67601157](#) [68631-112](#) [68645-018](#) [699319-000](#) [70.362.1628.0](#) [70-4210](#) [70-4226B](#) [70-](#)  
[4853B](#) [71.350.2428.0](#) [733-134](#) [733-162](#) [MHR-64-VUAL](#) [80.063.4001.1](#) [800-90-001-10-001000](#) [801-43-002-10-013000](#) [801-43-006-10-](#)  
[002000](#) [803-43-024-10-001000](#) [803-93-012-10-001000](#) [8-1437020-4](#) [819-22-004-30-001101](#) [820-22-006-30-001101](#) [820-22-008-30-001101](#)  
[821-22-002-10-001101](#) [821-22-003-10-002101](#)