

# SPECIFICATIONS

Current Rating: 1.5 Amps  
 Insulation Resistance: 1000MΩ Min  
 Contact Resistance: 20mΩ Max  
 Withstanding Voltage: AC 500V  
 Operation Temperature: -40° to +105°  
 Contact Material: Brass  
 Standard: PA6T  
 Insulator Material: Polyester (UL 94V-0)  
 Contact Plating: Gold Flash  
 Max. Processing Temp: 240° C for 30-60 seconds  
 (260° C for 5 seconds)

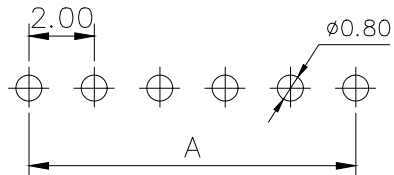

**RECOMMEND P. C. B LAYOUT**  
 PCB TOLERANCE:  $\pm 0.05$  (TOP VIEW)

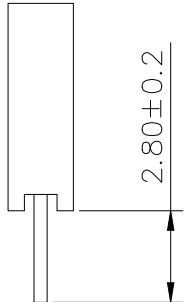
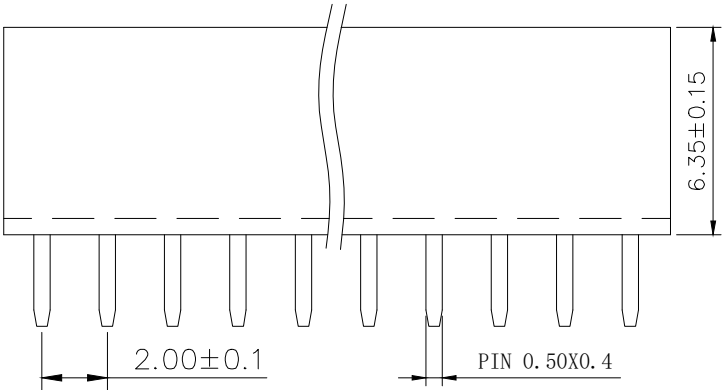
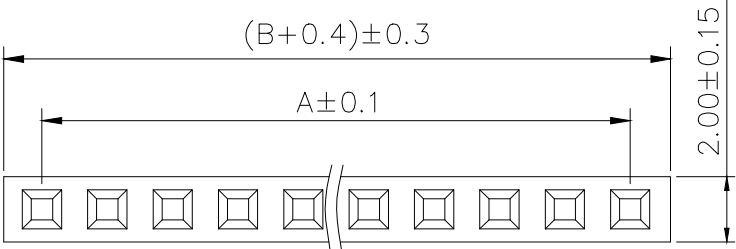

UNLESS OTHERWISE SPECIFIED TOLERANCE  
 X :  $\pm 0.30$  X° :  $\pm 5^\circ$   
 X.X :  $\pm 0.25$  X.X° :  $\pm 1^\circ$   
 X.XX :  $\pm 0.20$  X.XX° :  $\pm 0.5^\circ$

DRAWN NAME: 2.0FH H6.35 1xnPin 180度 Y型 PC2.8 6T  
 SIZE A4 SCALE N:1 PROUCT NO. BX-PM2.0-1-40PY  
 REV A UNIT mm PROJECT PAGE 1/1

CHECKED: / / APPROVED: / /

THESE DRAWINGS AND SPECIFICATIONS ARE THE PROPERTY OF SHENAHEN YIXINYING TECHNOLOGY CO., LTD AND SHALL NOT BE REPRODUCED, COPIED OR USED IN ANY MANNER WITHOUT THE PRIOR WRITTEN CONSENT OF SHENAHEN YIXINYING TECHNOLOGY CO., LTD

| No. of | DIM. A | DIM. B | No. of | DIM. A | DIM. B | No. of | DIM. A | DIM. B | No. of | DIM. A | DIM. B |
|--------|--------|--------|--------|--------|--------|--------|--------|--------|--------|--------|--------|
| 1      | 0.00   | 2.00   | 11     | 20.00  | 22.00  | 21     | 40.00  | 42.00  | 31     | 60.00  | 62.00  |
| 2      | 2.00   | 4.00   | 12     | 22.00  | 24.00  | 22     | 42.00  | 44.00  | 32     | 62.00  | 64.00  |
| 3      | 4.00   | 6.00   | 13     | 24.00  | 26.00  | 23     | 44.00  | 46.00  | 33     | 64.00  | 66.00  |
| 4      | 6.00   | 8.00   | 14     | 26.00  | 28.00  | 24     | 46.00  | 48.00  | 34     | 66.00  | 68.00  |
| 5      | 8.00   | 10.00  | 15     | 28.00  | 30.00  | 25     | 48.00  | 50.00  | 35     | 68.00  | 70.00  |
| 6      | 10.00  | 12.00  | 16     | 30.00  | 32.00  | 26     | 50.00  | 52.00  | 36     | 70.00  | 72.00  |
| 7      | 12.00  | 14.00  | 17     | 32.00  | 34.00  | 27     | 52.00  | 54.00  | 37     | 72.00  | 74.00  |
| 8      | 14.00  | 16.00  | 18     | 34.00  | 36.00  | 28     | 54.00  | 56.00  | 38     | 74.00  | 76.00  |
| 9      | 16.00  | 18.00  | 19     | 36.00  | 38.00  | 29     | 56.00  | 58.00  | 39     | 76.00  | 78.00  |
| 10     | 18.00  | 20.00  | 20     | 38.00  | 40.00  | 30     | 58.00  | 60.00  | 40     | 78.00  | 80.00  |

## X-ON Electronics

Largest Supplier of Electrical and Electronic Components

*Click to view similar products for [Headers & Wire Housings](#) category:*

*Click to view products by [Bossie](#) manufacturer:*

Other Similar products are found below :

[0015917161](#) [0022155065](#) [57102-F02-18ULF](#) [58102-G61-06LF](#) [582553-1](#) [01.001.5753.1](#) [0050291907](#) [02.125.8002.8](#) [609-3404](#) [61062-3](#)  
[CSU011177004](#) [622-0430](#) [622-3653LF](#) [63453-116](#) [636-1030](#) [636-1427](#) [636-3427](#) [636-4007](#) [641938-9](#) [65495-038](#) [65692-001LF](#) [65781-018](#)  
[65781-047](#) [65817-010LF](#) [65817-015LF](#) [67095-007LF](#) [67601157](#) [68631-112](#) [68645-018](#) [699319-000](#) [70.362.1628.0](#) [70-4210](#) [70-4226B](#) [70-](#)  
[4853B](#) [71.350.2428.0](#) [733-134](#) [733-162](#) [760-3052](#) [MHR-64-VUAL](#) [80.063.4001.1](#) [800-90-001-10-001000](#) [801-43-002-10-013000](#)  
[801-43-006-10-002000](#) [803-43-024-10-001000](#) [803-93-012-10-001000](#) [8-1437020-4](#) [819-22-004-30-001101](#) [820-22-006-30-001101](#)  
[820-22-008-30-001101](#) [821-22-002-10-001101](#)