

### Features

- Fast Switching Speed
- For General Purpose Switching Applications
- Surface Mount Package Ideally Suited for Automatic Insertion.
- High Conductance

### Package

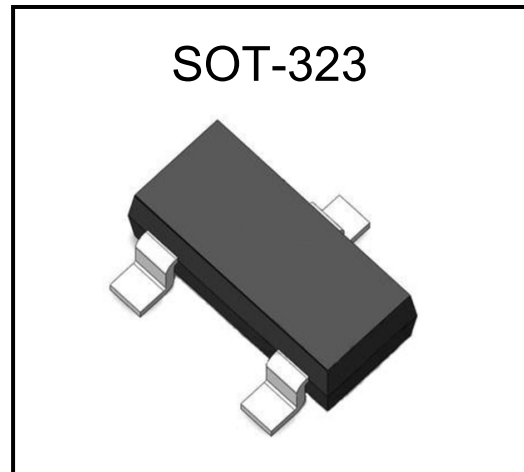

### Marking & Internal Wiring

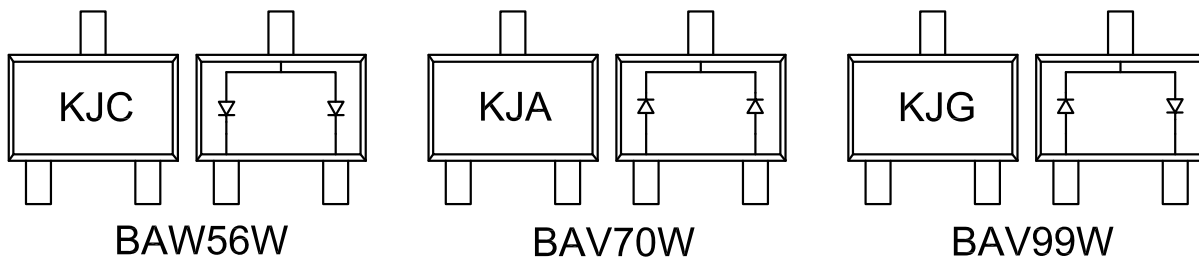

### Ordering information

Order code	Package	Marking	Base qty	Delivery mode
BAW56W	SOT-323	KJP	3K	Tape and reel
BAV70W	SOT-323	KJA	3K	Tape and reel
BAV99W	SOT-323	KJG	3K	Tape and reel

### Maximum Ratings @T<sub>A</sub>=25°C unless otherwise noted

Symbol	Parameter	Value	Unit
V <sub>RRM</sub>	Peak Repetitive Peak Reverse Voltage	70	V
V <sub>RWM</sub>	Working Peak Reverse Voltage	71	V
I <sub>O</sub>	Average Rectified Output Current	200	mA
I <sub>FSM</sub>	Non-Repetitive Peak Forward Surge Current @t=8.3ms	2.0	A
P <sub>d</sub>	Power Dissipation	225	mW
R <sub>θJA</sub>	Thermal Resistance Junction to Ambient	550	°C/W
T <sub>J</sub>	Operation Junction Temperature Range	-40 to 125	°C
T <sub>STG</sub>	Storage Temperature Range	-55 to 150	°C



# BAW56W / BAV70W / BAV99W

Fast Switching Diode

Electrical Characteristics @ $T_A=25^{\circ}\text{C}$  unless otherwise noted

Symbol	Parameter	Test Conditions	Limits		Unit
			Min.	Max.	
$V_{BR}$	Reverse Breakdown Voltage	$I_R=100\mu\text{A}$	70	–	V
$I_R$	Reverse Leakage Current	$V_R=70\text{V}$	–	2.5	$\mu\text{A}$
		$V_R=20\text{V}$	–	25	nA
$V_F$	Forward Voltage	$I_F=1\text{mA}$	–	0.715	V
		$I_F=10\text{mA}$	–	0.855	
		$I_F=50\text{mA}$	–	1	
		$I_F=150\text{mA}$	–	1.25	
$C_D$	Diode capacitance	$V_R=0\text{V}, f=1\text{MHz}$	–	1.5	PF
$T_{RR}$	Reverse Recovery Time	$I_F=I_R=10\text{mA}, I_{rr}=0.1I_R,$ $R_L=100\Omega$	–	6	nS





**BAW56W / BAV70W / BAV99W**

Fast Switching Diode

Typical Performance Characteristics ( $T_J = 25^\circ\text{C}$ , unless otherwise noted)

Figure 1: Forward Characteristics

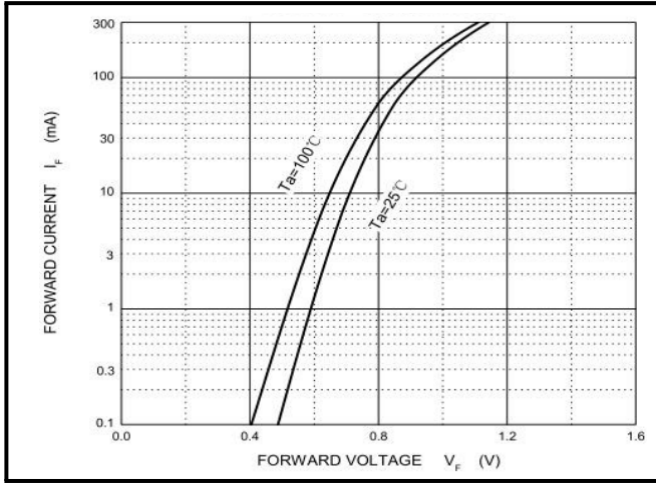

Figure 2: Reverse Characteristics

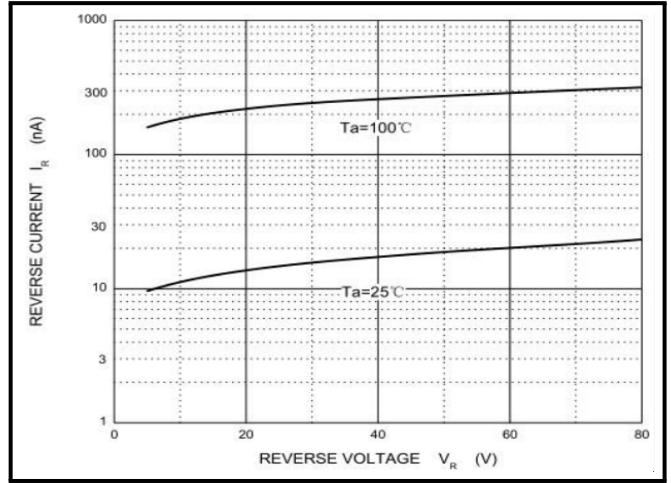

Figure 3: Capacitance Characteristics

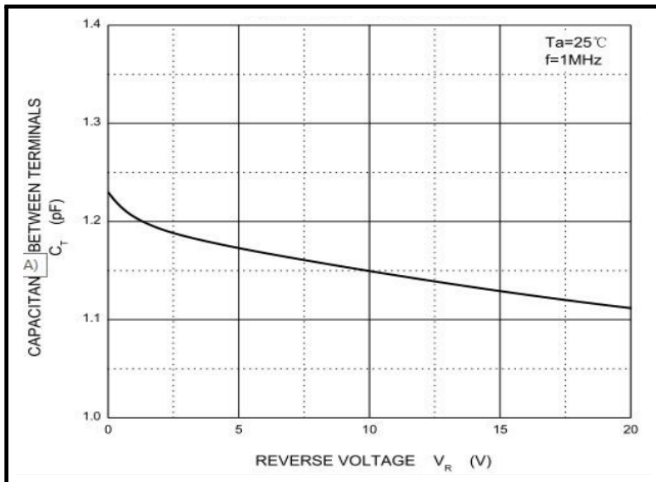
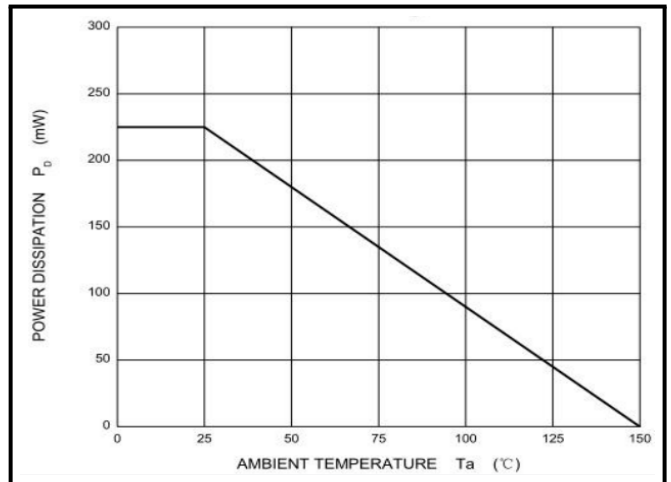
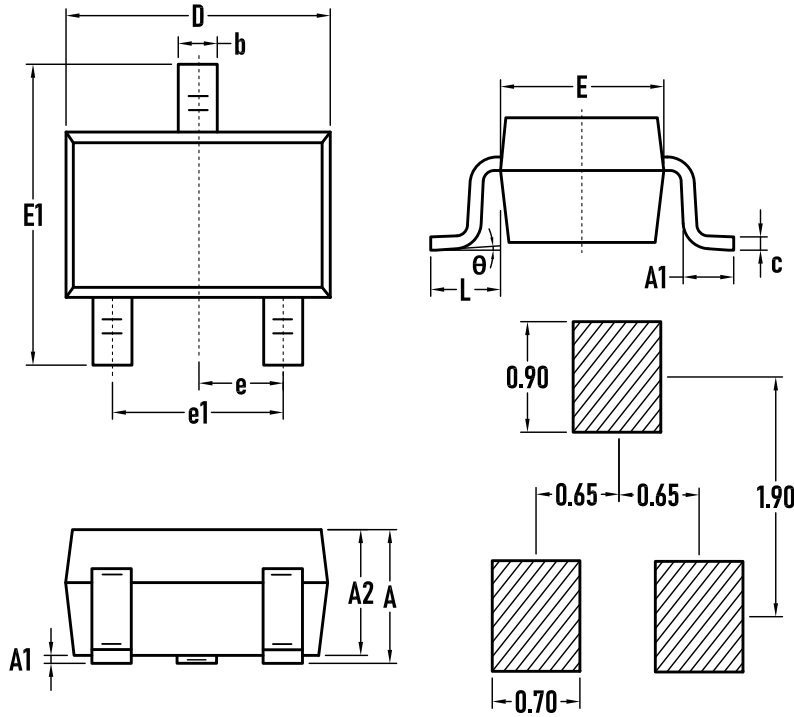

Figure 4: Power Derating Curve



Outline Drawing - SOT-323



SYMBOL	MILLIMETER		
	MIN.	Typ.	MAX.
A	0.90	1.00	1.10
A1	0.00	0.05	0.10
A2	0.90	0.95	1.00
b	0.20	0.30	0.40
c	0.08	0.12	0.15
D	2.00	2.10	2.20
E	2.15	2.30	2.45
E1	1.15	1.25	1.35
e	0.650Typ.		
e1	1.20	1.30	1.40
L	0.26	0.36	0.46
θ	0	4°	8°



## X-ON Electronics

Largest Supplier of Electrical and Electronic Components

*Click to view similar products for [Diodes - General Purpose, Power, Switching category](#):*

*Click to view products by [Bourne manufacturer](#):*

Other Similar products are found below :

[MMBD3004S-13-F](#) [1N3611](#) [NTE156A](#) [NTE6244](#) [1SS400CST2RA](#) [SDAA13](#) [SHN2D02FUTW1T1G](#) [1N4449](#) [1N456A](#) [1N914BTR](#)  
[D291S45T](#) [BAS 16-02L E6327](#) [BAS 16-02V H6327](#) [BAS 21U E6327](#) [BAS 28 E6327](#) [BAW56DWQ-7-F](#) [BAW56M3T5G](#) [BAW75-TAP](#)  
[MM230L-CAA](#) [IDW40E65D1](#) [JAN1N3600](#) [JAN1N4454UR-1](#) [SMMSD4148T3G](#) [BYW95B/A52A](#) [NSVDAN222T1G](#) [CDSZC01100-HF](#)  
[BAV70HDW-7](#) [BAS28-7](#) [JANTX1N6640](#) [BAW56HDW-13](#) [BAS28 TR](#) [VS-HFA04SD60STR-M3](#) [1SS388-TP](#) [BAV99TQ-13-F](#)  
[BAV99HDW-13](#) [1N4004](#) [MMDB30-E28X](#) [LS4148](#) [IDV15E65D2](#) [W0503RH200S0L](#) [W0503SH200S0L](#) [M0268SJ200NLF](#)  
[M0268RJ200NLF](#) [S3MBF](#) [US1J](#) [DAN217U-TP](#) [SHV-06JNS-Q](#) [IDW30C65D1](#) [IDW80C65D1](#) [VS-HFA30TA60CSR-M3](#)