

# Shielded, SMT Power Inductors

## Special Features

- High current capacity
- Magnetic shielded for low radiation
- Ferrite bobbin core
- Low core loss for high frequency power application
- Compact size
- Large terminal surface for good PCB bonding
- Operating temperature -30 to +100°C
- Current to cause maximum 25% of inductance drop, or 40°C temperature rise
- Tape & reel packaged 500/reel

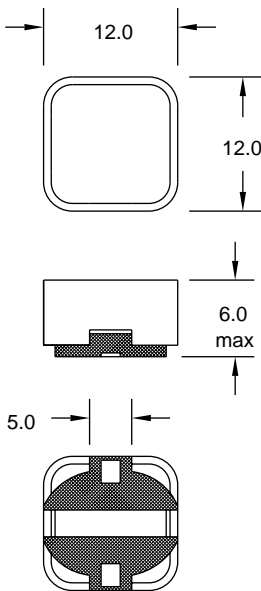

Dim: mm  
Tol: -/+0.3

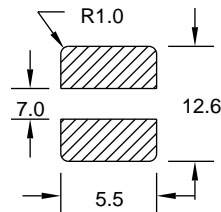

Pad Layout

PM125SH Series			
Part Number	L (μH) ±20% @ 1KHz	DCR (Ω) Max.	I, DC (A)
PM125SH-100M	10	0.025	4.0
PM125SH-120M	12	0.027	3.5
PM125SH-150M	15	0.030	3.3
PM125SH-180M	18	0.034	3.0
PM125SH-220M	22	0.036	2.8
PM125SH-270M	27	0.051	2.3
PM125SH-330M	33	0.057	2.1
PM125SH-390M	39	0.068	2.0
PM125SH-470M	47	0.075	1.8
PM125SH-560M	56	0.11	1.7
PM125SH-680M	68	0.12	1.5
PM125SH-820M	82	0.14	1.4
PM125SH-101M	100	0.16	1.3
PM125SH-121M	120	0.17	1.1
PM125SH-151M	150	0.23	1.0
PM125SH-181M	180	0.29	0.90
PM125SH-221M	220	0.40	0.80
PM125SH-271M	270	0.46	0.75
PM125SH-331M	330	0.51	0.68
PM125SH-391M	390	0.69	0.65
PM125SH-471M	470	0.77	0.58
PM125SH-561M	560	0.86	0.54
PM125SH-681M	680	1.20	0.48
PM125SH-821M	820	1.34	0.43
PM125SH-102M	1000	1.53	0.40

**J.W. Miller**  
M A G N E T I C S

306 E. Alondra Blvd., Gardena, CA 90247-1059 • (310) 515-1720 • FAX (310) 515-1962

[www.jwmiller.com](http://www.jwmiller.com)

## X-ON Electronics

Largest Supplier of Electrical and Electronic Components

*Click to view similar products for [Fixed Inductors](#) category:*

*Click to view products by [Bourns](#) manufacturer:*

Other Similar products are found below :

[CR43NP-680KC](#) [CR54NP-820KC](#) [CR54NP-8R5MC](#) [CTX32CT-100](#) [70F224AI](#) [MGDQ4-00004-P](#) [MHL1ECTTP18NJ](#) [MHL1JCTTD12NJ](#)  
[PE-51506NL](#) [PE-53601NL](#) [PE-53602NL](#) [PE-53630NL](#) [PE-53824SNLT](#) [PE-92100NL](#) [PG0434.801NLT](#) [PG0936.113NLT](#) [9310-16](#) [PM06-2N7](#) [PM06-39NJ](#) [A01TK](#) [1206CS-471XJ](#) [HC2-2R2TR](#) [HC2LP-R47-R](#) [HC3-2R2-R](#) [1206CS-151XG](#) [RCH664NP-140L](#) [RCH664NP-4R7M](#)  
[RCH8011NP-221L](#) [RCP1317NP-332L](#) [RCP1317NP-391L](#) [RCR1010NP-470M](#) [RCR110DNP-331L](#) [DH2280-4R7M](#) [DS1608C-106](#) [ASPI-4020HI-R10M-T](#) [B10TJ](#) [B82477P4333M](#) [B82498B3101J000](#) [B82498B3680J000](#) [ELJ-RE27NJF2](#) [1812CS-153XJ](#) [1812CS-183XJ](#) [1812CS-223XJ](#) [1812LS-104XJ](#) [1812LS-105XJ](#) [1812LS-124XJ](#) [1812LS-154XJ](#) [1812LS-223XJ](#) [1812LS-224XJ](#) [1812LS-563XJ](#)