

SW-581

INDUSTRIAL GIGABIT SFP MEDIA CONVERTER (SFP module not included)

- Cost-effective connectivity - economical way to integrate devices into a fibre optic network
- Plug and play integration - simple, targeted setup
- Allows for extended range and reliability of fibre optics
- Easy transition - bridge legacy devices and newer fibre optic infrastructure
- Industrial temperature range: -40°C to +80°C / -40°F to +176°F - works in extreme conditions
- Jumbo Frame support up to 9K frames
- Integral DIN mount
- SFP Port Power Overcurrent protection

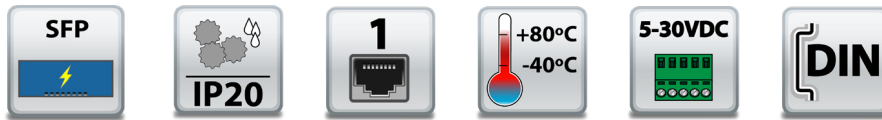

Scalability: combine with other switches in the range to create a comprehensive and future-proof network solution

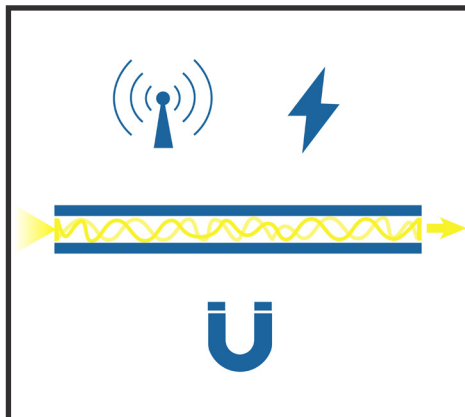

Fibre cables are immune to any electrical/magnetic interference, and require no cumbersome isolation devices to guard against high EMI/RFI or lightning strikes

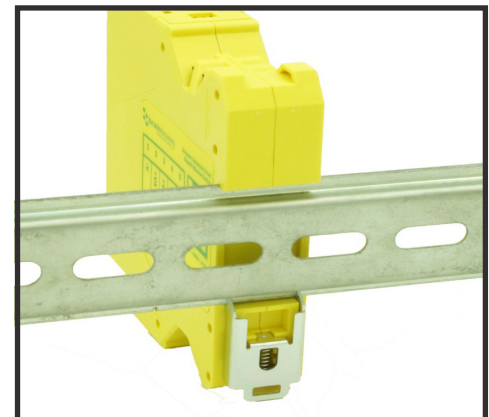

Integral DIN mount and slim design takes up minimal cabinet space

SW-581
INDUSTRIAL GIGABIT SFP MEDIA CONVERTER

Jumbo Frame support up to 9k frames

All Ethernet ports are Auto MDI/MDIX supporting straight through or crossover Ethernet cables

Integral DIN mount with ground

Automatic detection of data transmission speed: 10 or 100 or 1000 Mbps

SFP Power Current Overprotection



-40°C to +80°C/-40°F to +176°F temperature range

Non-conducting polyamide case

Compact case - all round small profile

Power consumption is optimised based on the status of the link device

Dual redundant power input: +5VDC to +30VDC

Easy Wire Removable screw terminal block

Connectors

| | |
|-----------------|-----------------------------------------------------------------------------------------------------------|
| Screw Terminals | 3.5mm pitch, #22 - #14, 0.5mm ² -2.5mm ² pin power supply |
| Wire Thickness | 0.150 inch, 3.81mm, 20 pins, 12+8 screw terminals, #26 - #16 AWG, 0.14mm ² -1.3mm ² |

Power Supply

| | |
|--------------------|-------------------------------------------------------------|
| Power Consumption | 3.3 W |
| Power Supply input | Unregulated +5V to +30Volts DC, reverse polarity protection |
| Isolation | 1500VRMS Magnetic Isolation from Twisted Pair Ethernet |

Environmental

| | |
|---------------------------|--------------------------------|
| Operating Temperature | -40°C to +80°C/-40°F to +176°F |
| Storage Temperature | -40°C to +80°C/-40°F to +176°F |
| Ambient Relative Humidity | 5 to 95% (non-condensing) |

SFP/Power LED:

Power on: Green
 SFP plugged in: Amber
 SFP activity: Amber Flashing
 SFP Error/Incompatible: Green/Amber Flashing

Magjack LEDs:

Link/Activity
 Solid: Connection established
 Flashing: Data communication

Speed

Yellow: 1000Mbps
 Green: 100Mbps

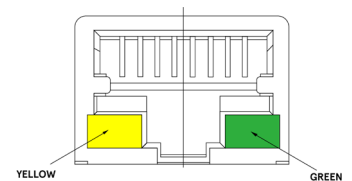

Ethernet 1 x RJ45 jack, 10/100/1000Mbps autosensing, crossover auto sensing (Auto MDIX), 1 x SFP 1000BASE-X Port

Protection 1,500 Volts magnetic isolation between ports

Housing IP-20 rated non-conducting polyamide case

SW-581

INDUSTRIAL GIGABIT SFP MEDIA CONVERTER

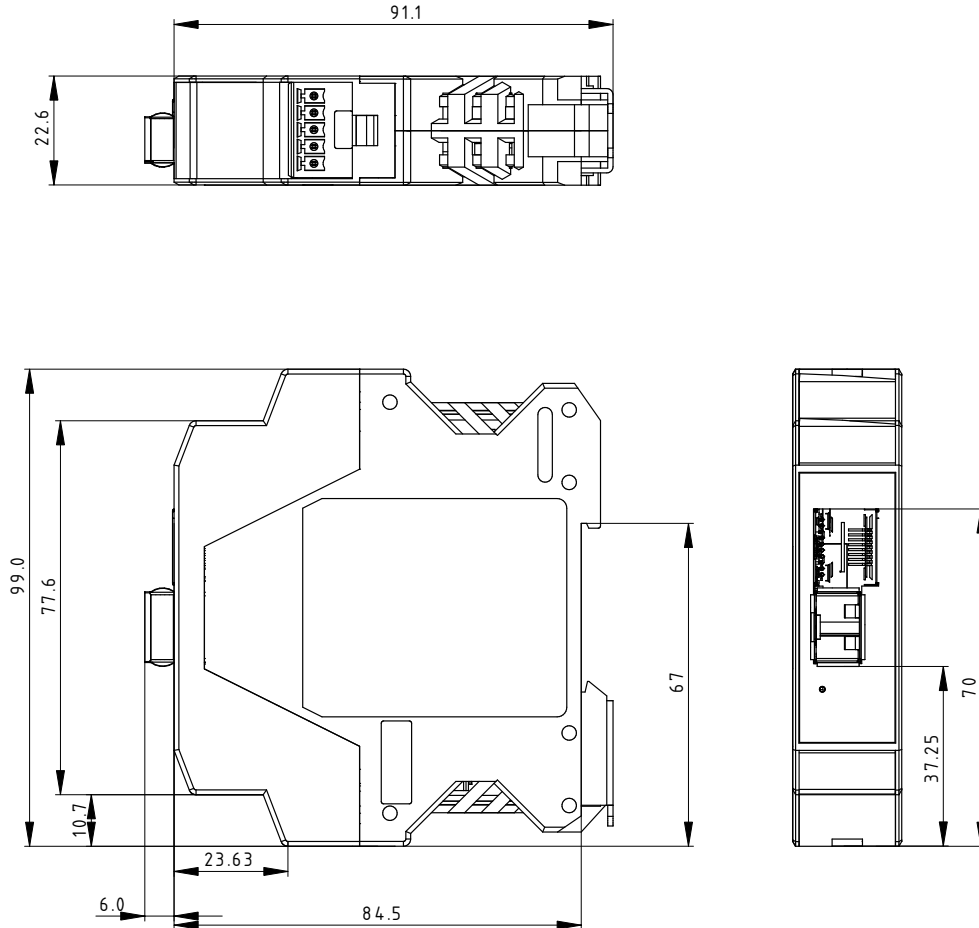
Power Terminal Pin Outs

| PIN | FUNCTION |
|-----|------------------|
| 1 | -V |
| 2 | +VA |
| 3 | +VB |
| 4 | -V |
| 5 | Functional Earth |

Ethernet Ports x1 Pin Outs

| PIN | FUNCTION |
|-----|----------|
| 1 | TxRxA+ |
| 2 | TxRxA- |
| 3 | TxRxB+ |
| 4 | TxRxC+ |
| 5 | TxRxC- |
| 6 | TxRxB- |
| 7 | TxRxD+ |
| 8 | TxRxD- |

Lifetime Warranty and Support:

We can help with every aspect of your project, from getting you up and running to custom application.

SW-581

INDUSTRIAL GIGABIT SFP MEDIA CONVERTER

Packaging Information

| | |
|---------------------|----------------------------------------|
| Packaging | Quick Start Guide |
| Device | Industrial Gigabit SFP Media Converter |
| Packaged Weight | 0.2045kg, 0.45lbs |
| Packaged Dims | 160x135x49 mm, 6.3x5.3x1.9 inches |
| GTIN Universal Code | 837324005042 |

Approvals

| | |
|--------------------|----------------------------------------------------------------------------------------------------|
| Industry Approvals | Microsoft Certified Gold Partner, WEEE, RoHS, AEO (C-TPAT), CE, UKCA, METL Complies with UL62368-1 |
|--------------------|----------------------------------------------------------------------------------------------------|

Product Support

| | |
|----------|-----------------------------------------------------------------------------------------------------------------------------------|
| Warranty | Lifetime - online registration required |
| Support | Lifetime web, email and phone support from fully qualified, friendly staff who work in and alongside the Product Development Team |

Additional Information

| | |
|--------------|----------------------------------------------------------------------------------------------------------|
| OEM option | Available for bulk buy OEM |
| Made In | Manufactured in Great Britain (GB) by Brainboxes |
| Customisable | Brainboxes operate a 'Perfect Fit Custom Design' policy for volume users. More info:sales@brainboxes.com |



PW-600

Power supply with connectors for UK, USA, EU and AUS mains socket. 'Tails' are suitable for connecting to screw terminal blocks.



PW-650

Power supply with USB connector and prewired screw terminal block. Suitable for use with 5V USB ports.



SW Range

Switch products available in a range of formats and specifications.

www.brainboxes.com

X-ON Electronics

Largest Supplier of Electrical and Electronic Components

Click to view similar products for [Media Converters](#) category:

Click to view products by [Brainboxes](#) manufacturer:

Other Similar products are found below :

[CF-020010-264](#) [RSM3485PCT](#) [CAN-BUS-XL2515](#) [CTM1051KAT](#) [TD322D485H-A](#) [CTM1051KT](#) [TD322DCAN](#) [TD301D485H](#)
[CTM8251KD](#) [CTM8251KAT](#) [RSM3485IDHT](#) [RSM3485CT](#) [CTM8251KT](#) [RSM485IDHT](#) [CTM1051T](#) [TD501D485H-E](#) [RSM485ECHT](#)
[TD501DCANH3](#) [TD501DCAN](#) [CTM8251AT](#) [TD301D485H-A](#) [TD301DCAN](#) [TD522DCAN](#) [TD321D485H-A](#) [RSM485PHT](#) [RSM485PCT](#)
[TD522D485H-A](#) [CTM8251KAD](#) [TD501D485H](#) [RSM3485IQHT](#) [CTM1051AMG](#) [CTM1051MG](#) [RSM485LECHT](#) [SC1510R](#) [CSM300](#)
[CTM8251AT](#) [TD302DCAN](#) [TD301MCAN](#) [CTM1051M](#) [TD301MCANFD](#) [TD301DCAN](#) [CTM1051](#) [CTM1051T](#) [TD322DCAN](#)
[TD301DCANH3](#) [TD522DCAN](#) [CTM1051AT](#) [CTM1051AMG](#) [CTM8251T](#) [CTM1051KT](#)