

## 445MU Nylon Cable Chain with opening frames

### Inner height (D) 45 mm

Chain with side-bands and holding pin. Openable outside / inside radius mounted on all the links. Internal separation available and customizable.

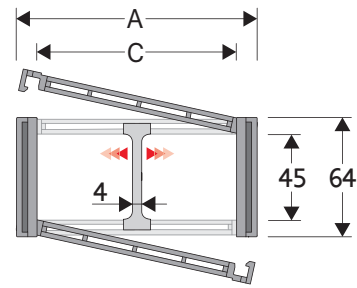

| Separator             |                   |
|-----------------------|-------------------|
| - Unassembled         | Part.no S445UF    |
| - Assembled*          | Part.no S445UFMCI |
| - Assembled**         | Part.no S445UFMCE |
| Strong-hold separator |                   |
| for C > 200 mm        |                   |
| - Unassembled         | Part.no S445SH    |
| - Assembled           | Part.no S445SHMC  |
| Pin                   |                   |
|                       | Part.no PG445     |

\* for chain opening outer radius  
\*\* for chain opening inner radius

### Technical characteristics when self-supported

|              |                     |
|--------------|---------------------|
| Speed        | 10 m/s              |
| Acceleration | 50 m/s <sup>2</sup> |

For higher requirements please consult our technical dept.

| A   | B  | C   | D  | R                               | Weight/m | Chain          |
|-----|----|-----|----|---------------------------------|----------|----------------|
| mm  | mm | mm  | mm | mm                              | kg       | Part Number    |
| 72  | 64 | 50  | 45 | 075-100-125-150-175-200-250-300 | 1,64     | 445MU050 □□□ * |
| 83  | 64 | 61  | 45 | 075-100-125-150-175-200-250-300 | 1,64     | 445MU061 □□□ * |
| 97  | 64 | 75  | 45 | 075-100-125-150-175-200-250-300 | 1,76     | 445MU075 □□□ * |
| 103 | 64 | 81  | 45 | 075-100-125-150-175-200-250-300 | 1,79     | 445MU081 □□□ * |
| 107 | 64 | 85  | 45 | 075-100-125-150-175-200-250-300 | 1,82     | 445MU085 □□□ * |
| 117 | 64 | 95  | 45 | 075-100-125-150-175-200-250-300 | 1,86     | 445MU095 □□□ * |
| 122 | 64 | 100 | 45 | 075-100-125-150-175-200-250-300 | 1,87     | 445MU100 □□□ * |
| 129 | 64 | 107 | 45 | 075-100-125-150-175-200-250-300 | 1,90     | 445MU107 □□□ * |
| 139 | 64 | 117 | 45 | 075-100-125-150-175-200-250-300 | 1,93     | 445MU117 □□□ * |
| 147 | 64 | 125 | 45 | 075-100-125-150-175-200-250-300 | 2,01     | 445MU125 □□□ * |
| 158 | 64 | 136 | 45 | 075-100-125-150-175-200-250-300 | 2,07     | 445MU136 □□□ * |
| 172 | 64 | 150 | 45 | 075-100-125-150-175-200-250-300 | 2,13     | 445MU150 □□□ * |
| 197 | 64 | 175 | 45 | 075-100-125-150-175-200-250-300 | 2,25     | 445MU175 □□□ * |
| 222 | 64 | 200 | 45 | 075-100-125-150-175-200-250-300 | 2,39     | 445MU200 □□□ * |
| 233 | 64 | 211 | 45 | 075-100-125-150-175-200-250-300 | 2,44     | 445MU211 □□□ * |
| 247 | 64 | 225 | 45 | 075-100-125-150-175-200-250-300 | 2,52     | 445MU225 □□□ * |
| 274 | 64 | 252 | 45 | 075-100-125-150-175-200-250-300 | 2,66     | 445MU252 □□□ * |
| 283 | 64 | 261 | 45 | 075-100-125-150-175-200-250-300 | 2,70     | 445MU261 □□□ * |
| 308 | 64 | 286 | 45 | 075-100-125-150-175-200-250-300 | 2,81     | 445MU286 □□□ * |
| 334 | 64 | 312 | 45 | 075-100-125-150-175-200-250-300 | 2,92     | 445MU312 □□□ * |
| 356 | 64 | 334 | 45 | 075-100-125-150-175-200-250-300 | 3,05     | 445MU334 □□□ * |
| 384 | 64 | 362 | 45 | 075-100-125-150-175-200-250-300 | 3,18     | 445MU362 □□□ * |

\*Complete the code by inserting the value of the radius (R): Ex. 445MU050 □ □ □ □ □

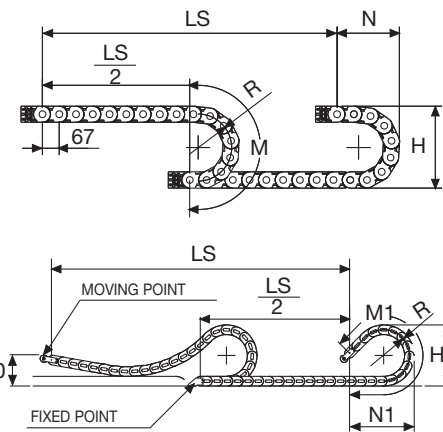

For sliding applications, technical data can slightly change according to frequency, added weight and environment.

Length of chain (L)  
Half travel distance ( $\frac{LS}{2}$ )  
plus length of curve (M) or (M1)

$$L = \frac{LS}{2} + M \text{ or } M1$$

| R   | H   | N   | M    | N1   | M1   |
|-----|-----|-----|------|------|------|
| mm  | mm  | mm  | mm   | mm   | mm   |
| 075 | 214 | 180 | 370  | 225  | 465  |
| 100 | 264 | 200 | 450  | 340  | 740  |
| 125 | 314 | 225 | 530  | 460  | 1020 |
| 150 | 364 | 250 | 605  | 580  | 1300 |
| 175 | 414 | 275 | 685  | 700  | 1575 |
| 200 | 464 | 300 | 765  | 820  | 1855 |
| 250 | 564 | 350 | 920  | 1055 | 2410 |
| 300 | 664 | 400 | 1080 | 1295 | 2970 |

**SLIDING VERSION**  
to be ordered with pivoting end brackets set

### Self-Supporting Capacity Diagram

The maximum length of the self-supporting capacity ( $\frac{LS}{2}$ ) in relationship to the weight of the cables and hoses contained per linear metre.

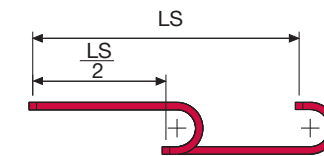
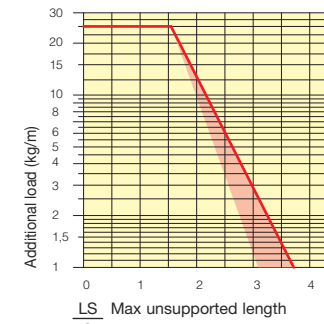

The red marking in the diagram area considers the difference of weight between various widths of chain.

For applications with  $\frac{LS}{2}$  and weights not included in the area of the diagram showing self-supporting capacity, verify the possible use of support rollers (see page 30).

### End Brackets

The end brackets set allows the two ends of the chain to be attached to the equipment. Set complete with tie-wrap clamps available on request.

#### Nylon Type

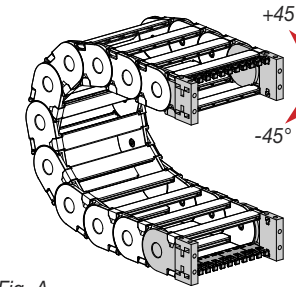

Fig. A  
The chain can be fixed frontally, inner or outer radius. (Fig A)

#### Nylon Type

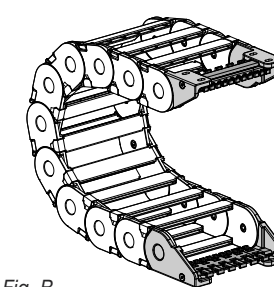
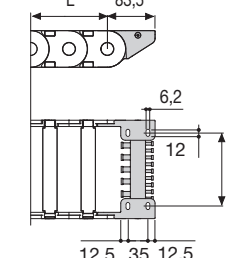
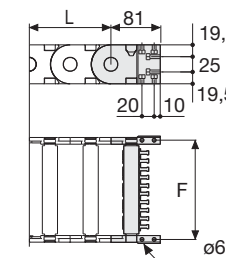

Fig. B  
Chain fixed outside the radius. (Fig B)  
See end brackets mounting variations page 31.



| Chain Type | F mm |
|------------|------|
| 445MU050   | 63   |
| 445MU061   | 74   |
| 445MU075   | 88   |
| 445MU081   | 94   |
| 445MU085   | 98   |
| 445MU095   | 108  |
| 445MU100   | 113  |
| 445MU107   | 120  |
| 445MU117   | 130  |
| 445MU125   | 138  |
| 445MU136   | 149  |
| 445MU150   | 163  |
| 445MU175   | 188  |
| 445MU200   | 213  |
| 445MU211   | 224  |
| 445MU225   | 238  |
| 445MU252   | 265  |
| 445MU261   | 274  |
| 445MU286   | 299  |
| 445MU312   | 325  |
| 445MU334   | 347  |
| 445MU362   | 375  |

#### Nylon Type Part Numbers

|                          |               |
|--------------------------|---------------|
| Complete Set Assembled   | AN445M □□□*KM |
| Complete Set Unassembled | AN445M □□□*K  |

#### Tie-wrap Clamp Part Numbers

|                          |                |
|--------------------------|----------------|
| Complete Set Assembled   | CFC445M □□□*KM |
| Complete Set Unassembled | CFC445M □□□*K  |

| Chain Type | F mm |
|------------|------|
| 445MU050   | 28   |
| 445MU061   | 39   |
| 445MU075   | 53   |
| 445MU081   | 59   |
| 445MU085   | 63   |
| 445MU095   | 73   |
| 445MU100   | 78   |
| 445MU107   | 85   |
| 445MU117   | 95   |
| 445MU125   | 103  |
| 445MU136   | 114  |
| 445MU150   | 128  |
| 445MU175   | 153  |
| 445MU200   | 178  |
| 445MU211   | 189  |
| 445MU225   | 203  |
| 445MU252   | 230  |
| 445MU261   | 239  |
| 445MU286   | 264  |
| 445MU312   | 290  |
| 445MU334   | 312  |
| 445MU362   | 340  |

#### Nylon Type Part Numbers

|                          |               |
|--------------------------|---------------|
| Complete Set Assembled   | AN445KM □**** |
| Complete Set Unassembled | AN445K □****  |

#### Tie-wrap Clamp Part Numbers

|                          |                |
|--------------------------|----------------|
| Complete Set Assembled   | SFCT445 □□□*KM |
| Complete Set Unassembled | SFCT445 □□□*K  |

\*\*\*\*1=Pos.1; 2=Pos.2; 3=Pos.3  
5=Pos.5; 6=Pos.6

## 445MU Nylon Cable Chain with opening frames



**END-BRACKETS for SLIDING**  
1- Different fixing combinations.  
2- Aluminum drawn with combs. cable gland mounted either on the fixed point or on the moving point.  
3- Space created for nut housing.

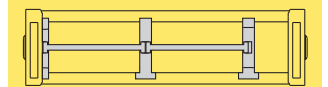

Separation System page. 196

### Bright Zinc Plated Steel Type\*\*

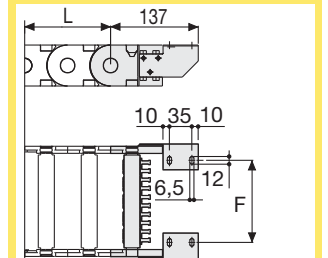
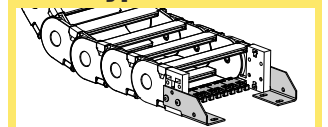

F = A-44

### Bright Zinc Plated Steel Type Part Numbers

|                          |                  |
|--------------------------|------------------|
| Complete Set Assembled   | A445M □□□*KM □** |
| Complete Set Unassembled | A445M □□□*K □**  |

### Tie-wrap Clamp Part Numbers

|                          |                |
|--------------------------|----------------|
| Complete Set Assembled   | CFC445M □□□*KM |
| Complete Set Unassembled | CFC445M □□□*K  |

\* Inner width (C)  
\*\* 1=Pos.1; 2=Pos.2; 3=Pos.3  
\*\*\* Available on request in stainless steel

## X-ON Electronics

Largest Supplier of Electrical and Electronic Components

*Click to view similar products for [Cable Mounting & Accessories](#) category:*

*Click to view products by [Brevetti](#) manufacturer:*

Other Similar products are found below :

[HP-4N](#) [582603-1](#) [009333-000](#) [727844N003](#) [809090N001](#) [8109](#) [843188-000](#) [843459N001](#) [843460N003](#) [8666](#) [967279N002](#) [GPQC1/0](#) [DB-11](#) [1300830208](#) [1300840039](#) [1300900026](#) [1300990052](#) [1301740005](#) [1301800121](#) [1301800416](#) [1300830184](#) [1300990149](#) [1301580036](#) [1301720103](#) [1301720135](#) [1301720152](#) [1301720157](#) [1301740009](#) [1301770011](#) [1301850553](#) [1301860939](#) [1302000074](#) [1302264431](#) [1337706-2](#) [APA18-AK](#) [MTX6UTPSRC-C](#) [1-787307-1](#) [185491N001](#) [HP-6N](#) [C-202-C](#) [202C221-13-0](#) [OMTM-S10-C0](#) [205339-4](#) [CA7308-000](#) [8S23-75FR-CS8184](#) [2684](#) [9648](#) [3089](#) [988382-000](#) [A0270164](#)