

# Serie Medium

## 300A Nylon Cable Chain with opening frames

### Inner height (D) 18 mm

Single link construction with anti-friction single-pin.

Frames opening from inner radius.

Vertical separators available.

The wide frames on out radius offer good protection, when operating horizontally.

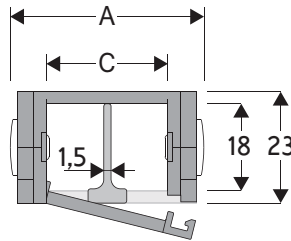

### Separator

|               |                 |
|---------------|-----------------|
| - Unassembled | Part.no S300A   |
| - Assembled   | Part.no S300AMC |

### Pin

Part.no PG300A

### Technical characteristics when self-supported

|              |                     |
|--------------|---------------------|
| Speed        | 10 m/s              |
| Acceleration | 50 m/s <sup>2</sup> |

For higher requirements please consult our technical dept.

| A  | B  | C  | D  | R               | Weight/m | Chain         |
|----|----|----|----|-----------------|----------|---------------|
| mm | mm | mm | mm | mm              | kg       | Part Number   |
| 27 | 23 | 15 | 18 | 040-060-080-120 | 0,41     | 300A015 □□□ * |
| 37 | 23 | 25 | 18 | 040-060-080-120 | 0,45     | 300A025 □□□ * |
| 62 | 23 | 50 | 18 | 040-060-080-120 | 0,55     | 300A050 □□□ * |
| 87 | 23 | 75 | 18 | 040-060-080-120 | 0,65     | 300A075 □□□ * |

\*Complete the code by inserting the value of the radius (R): Ex. 300A015 □ □ □ □

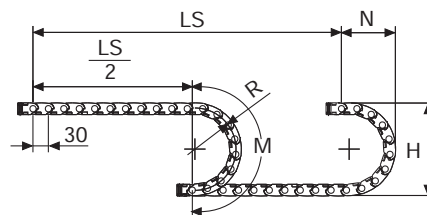

| R   | H   | N   | M   |
|-----|-----|-----|-----|
| mm  | mm  | mm  | mm  |
| 040 | 103 | 85  | 185 |
| 060 | 143 | 105 | 250 |
| 080 | 183 | 125 | 315 |
| 120 | 263 | 165 | 440 |

Length of chain (L)

Half travel distance ( $\frac{LS}{2}$ )  
plus length of curve (M)

$$L = \frac{LS}{2} + M$$



### Self-Supporting Capacity Diagram

The maximum length of the self-supporting capacity ( $\frac{LS}{2}$ ) in relationship to the weight of the cables and hoses contained per linear metre.

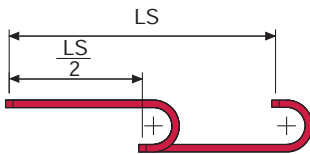
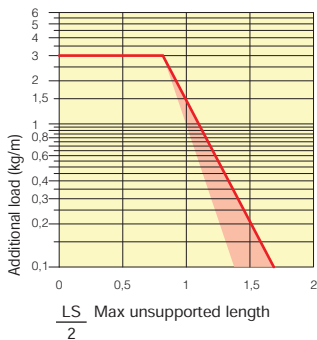

The red marking in the diagram area considers the difference of weight between various widths of chain.

For applications with  $\frac{LS}{2}$  and weights not included in the area of the diagram showing self-supporting capacity, verify the possible use of support rollers (see page 30).

### End Brackets

The end brackets set allows the two ends of the chain to be attached to the equipment. Set complete with tiewrap clamps available on request.

#### Nylon Type

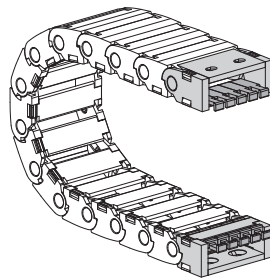

Fig. A Chain fixed outside the radius. (Fig A)

#### Bright Zinc Plated Steel Type\*\*\*

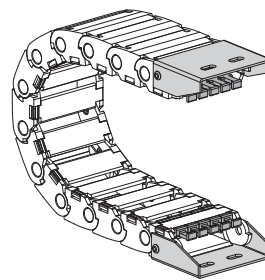
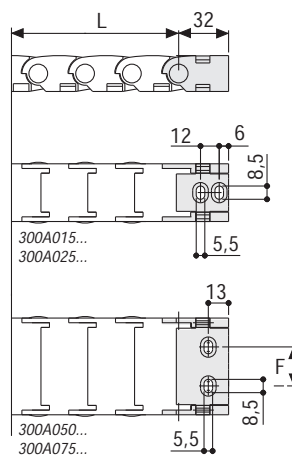

Fig. B Chain fixed outside the radius. (Fig B)  
See end brackets mounting variations page 31.



| Chain Type | F mm |
|------------|------|
| 300A050    | 25   |
| 300A075    | 50   |

#### Nylon Type Part Numbers

| Complete Set Assembled Chain Type | End Brackets Set |
|-----------------------------------|------------------|
| 300A...                           | AN300A□□□*KM     |

| Complete Set Unassembled Chain Type | End Brackets Set |
|-------------------------------------|------------------|
| 300A...                             | AN300A□□□*K      |

| Tiewrap Clamp Part Number |
|---------------------------|
| Assembl. CFC300□□□*KM     |
| Unassembl. CFC300□□□*K    |

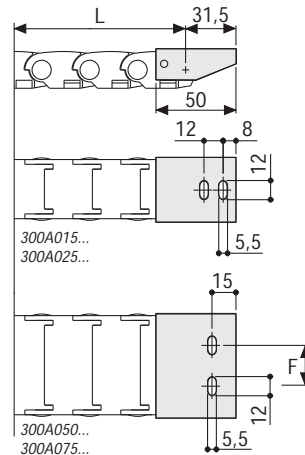

| Chain Type | F mm |
|------------|------|
| 300A050    | 25   |
| 300A075    | 50   |

#### Bright Zinc Plated Steel Type Part Numbers

| Complete Set Assembled Chain Type | End Brackets Set |
|-----------------------------------|------------------|
| 300A...                           | A300A□□□*KM      |

| Complete Set Unassembled Chain Type | End Brackets Set |
|-------------------------------------|------------------|
| 300A...                             | A300A□□□*K       |

| Tiewrap Clamp Part Number |
|---------------------------|
| Assembl. CFC300□□□*KM     |
| Unassembl. CFC300□□□*K    |

\* Inner width (C)  
\*\*\* Available on request in stainless steel

### Serie Medium

## 300A

Nylon Cable Chain with opening frames



How to open the cover.

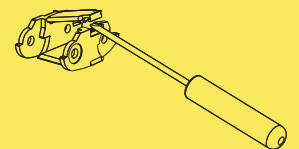
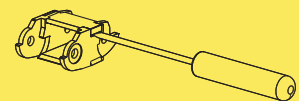

Special tool to remove the connecting pivots:  
Part Number PZ010.



For further information please consult Brevetti Stendalto's Technical Office

## X-ON Electronics

Largest Supplier of Electrical and Electronic Components

*Click to view similar products for [Control Switches](#) category:*

*Click to view products by [Brevetti](#) manufacturer:*

Other Similar products are found below :

[80887-99](#) [80932-99](#) [86855-00](#) [88814-30](#) [1424293-1](#) [HW4S-2TC10](#) [89721-12](#) [89804-08](#) [SSN](#) [RL01801](#) [ASD2L20N-LVO](#) [50051857-17](#)  
[50099156-001-05](#) [51.155R-15200](#) [50058920-26](#) [CP-FA51](#) [CP-FA49](#) [ACCU-SC/L-3000](#) [PP9M](#) [PP87G](#) [PP86GA](#) [PP71G](#) [PP70G](#) [PP6G](#)  
[PP62G](#) [PP58BL](#) [PP56G](#) [PP86GB](#) [PP77GA](#) [PP76G](#) [PP4M](#) [PP47G](#) [PP46G](#) [PP41M](#) [PP40G](#) [PP32G](#) [RD-20](#) [PP23M](#) [PP12G](#) [PORTAPRO](#)  
[POM-2708](#) [PNB-2005](#) [3057.0012](#) [CV-075](#) [CV-140SB](#) [CV-150](#) [CV-150S](#) [214X20XK](#) [CV-180](#) [CV-200MB](#)