

# HLMP-1050

## T-1 (3mm) Right Angle Mount Housing



### Data Sheet

#### Description

The HLMP-1050 is a black plastic right angle housing which mates with Avago Technologies high dome T-1 lamps. The leads should be prebent 90° as shown prior to snapping into the right angle housing. The housing material is high temperature nylon capable of withstanding temperatures up to +150°C.

#### Features

- Fits Any Agilent High Dome T-1 LED Lamp
- Snap-In Fit Makes Mounting Simple
- High Contrast Black Plastic
- May Be Ordered with Mounted T-1 Lamp as an Option.
- Housing meets UL94V-0 Flammability Rating

#### Physical Dimensions

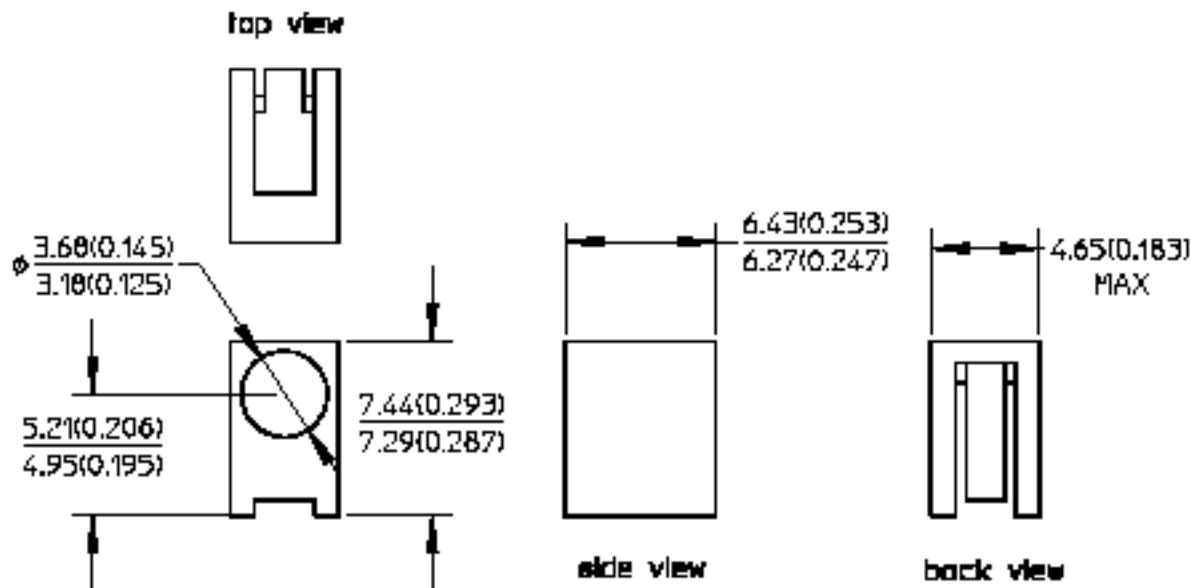

Option No.	Cathode Lead Length	Anode Lead Length	
A1	16.0 (0.630)	1.27 (0.050)	Unsheared Uneven Leads
A2	3.43 (0.135) Min.	3.43 (0.135) Min.	Sheared Even Leads

For product information and a complete list of distributors, please go to our web site: [www.avagotech.com](http://www.avagotech.com)

Avago, Avago Technologies, and the A logo are trademarks of Avago Technologies, Limited in the United States and other countries. Data subject to change. Copyright © 2007 Avago Technologies Limited. All rights reserved. 5989-0518EN - March 21, 2007

## X-ON Electronics

Largest Supplier of Electrical and Electronic Components

*Click to view similar products for [LED Mounting Hardware](#) category:*

*Click to view products by [Broadcom](#) manufacturer:*

Other Similar products are found below :

[00624250](#) [00624750](#) [M2200](#) [7047](#) [990-4901-010](#) [990-8115-001](#) [CMP22](#) [M16-T1](#) [C-101](#) [L2K-L4GD](#) [L2K-L5XL](#) [LDN51-125SL/BT](#)  
[00624500](#) [7046](#) [7056](#) [SN3486](#) [26-0053](#) [TC4-R-](#) [SLQ16](#) [LM6-2](#) [LM12-1](#) [LM10-1](#) [CM00624375](#) [CM00624900](#) [RNG132](#) [FIX-LEDH-10.5](#)  
[FIX-LEDH-11](#) [FIX-LEDH-11.5](#) [FIX-LEDH-12](#) [FIX-LEDH-14](#) [FIX-LEDH-17](#) [FIX-LEDH-18](#) [FIX-LEDH-4](#) [FIX-LEDH-4.5](#) [FIX-LEDH-7.5](#)  
[FIX-LEDH-9.5](#) [FIX-LEDS-1.5](#) [FIX-LEDS-2](#) [FIX-LEDS-3.5](#) [FIX-LEDT-11](#) [FIX-LEDT-20](#) [FIX-LEDT-26](#) [FIX-LEDT-5](#) [FIX-LEDT-9](#)  
[SQLEDS2-4-26](#) [7382](#) [CNXDX4624](#) [CNXDX4608](#) [CNXDF4608](#) [4740](#)